

**PARALLEL ARM INSTALLATION  
CLOSER MOUNTED ON DOOR ON PUSH SIDE**

This drawing shown is RIGHT HAND DOOR, For LEFT HAND DOOR should be install in symmetry

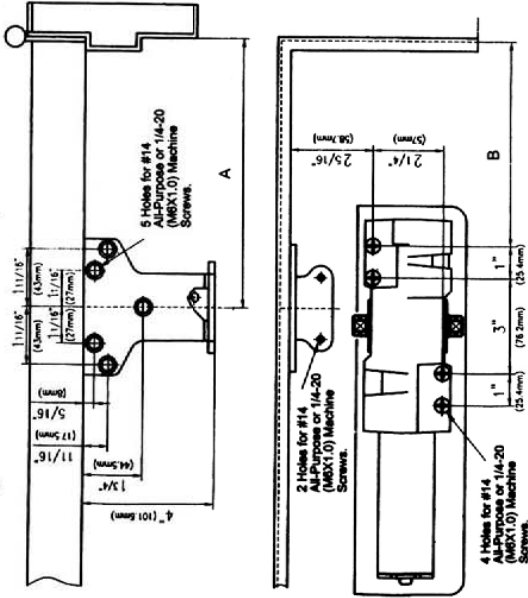

**INSTALLATION DIMENSIONS**

| OPENING   | "A"              | "B"              |
|-----------|------------------|------------------|
| TO 100"   | 9-7/16"<br>(240) | 8-1/4"<br>(210)  |
| TO 120"   | 9-5/8"<br>(220)  | 7-5/16"<br>(185) |
| OVER 140" | 7-7/8"<br>(200)  | 6-1/2"<br>(165)  |

- Before installation, turn Back Check selector valve (found on the opposite side of closer from back check screw side) ALL THE WAY IN (CLOCKWISE).
  - Adjust spring power to match door width as indicated by chart on page 1.
  - Mount closer on door as dimensions shown. Top and bottom pins, if pins are used, locate closer and parallel bracket from CENTERLINE OF DOOR.
  - Adjust top and bottom pins on 1/2" shaft. Turn screw in top arm about 30° and parallel bracket on top shaft. Insert screw into top of shaft and tighten.
  - Attach parallel bracket on frame as dimensions shown.
  - Attach rod and shoe to parallel bracket as shown.
  - Insert rod in forearm, and then insert main arm to closer parallel to door. Then insert forearm out screw and tighten.
- (IF HOLD OPEN ARM IS USED, THE NUT IS ON THE TOP FOR RH DOOR AND BOTTOM FOR LH DOOR)

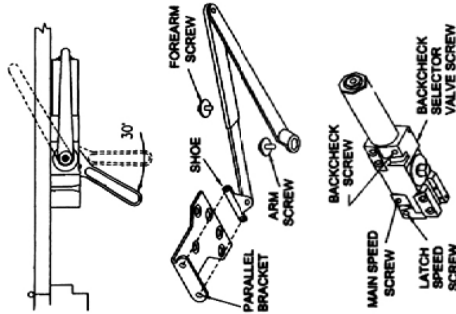

**COVER**  
Please insert in proper cabinet, then push cover against door. Tighten both cover screw securely.

**HOLD OPEN ADJUSTMENT** (when hold open arm is used)  
Loosen adjusting nut, open door to desired hold open position and tighten nut. Do not permit door to swing beyond hold open setting.

**International®  
door closers**

**DOOR CLOSER  
MODEL: 44CI  
INSTALLATION INSTRUCTION**

**STANDARD MOUNT  
(PULL SIDE)**

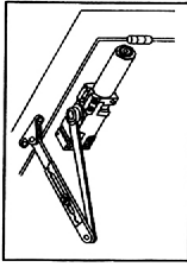

**TOP JAMB MOUNT  
(PUSH SIDE)**

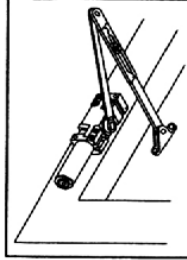

**PARALLEL MOUNT  
(PUSH SIDE)**

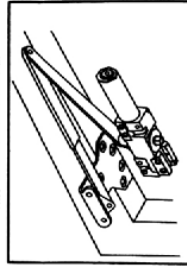

| MAXIMUM DOOR WIDTH | FULL TURNS REQUIRED |                |
|--------------------|---------------------|----------------|
|                    | EXTERIOR DOORS      | INTERIOR DOORS |
| 5 lb-ft            | 5 TURNS C.C.W.      | 5 TURNS C.C.W. |
| 8.5 lb-ft          | 34" (864)           | 2 TURNS C.C.W. |
| 30" (762)          | 38" (962)           | 0 TURNS        |
| 36" (914)          | 48" (1219)          | 5 TURNS C.W.   |
| 42" (1067)         | 64" (1372)          | 10 TURNS C.W.  |
| 48" (1219)         | 80" (1524)          | 15 TURNS C.W.  |

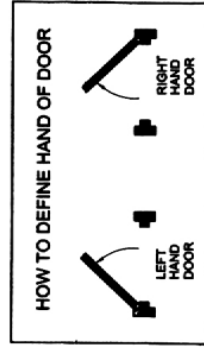

**CONTROL RANGE**

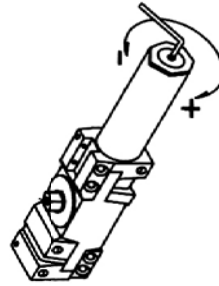
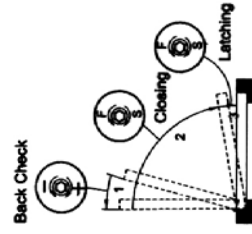

**Spring Power  
Adjustment**

## STANDARD INSTALLATION CLOSER MOUNTED ON DOOR ON PULL SIDE

This drawing shown is LEFT HAND DOOR, For RIGHT HAND DOOR should be install in symmetry.

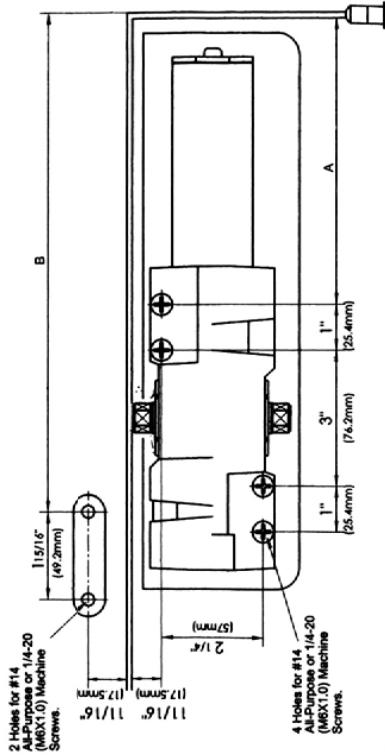

| OPENING        | 'A'   | 'B'          |
|----------------|-------|--------------|
| TO 7'-5 7/16\" | (185) | 11-13 1/16\" |
| TO 100\"       | (300) |              |
| TO 6-1 1/4\"   | (159) | 10-13 1/16\" |
| TO 130\"       | (275) |              |

1. Adjust spring power to match door width as indicated by chart on page 1.
2. Mount closer on door as dimension shown. Tube and toward hinge. If pivots are used, locate closer and shoe from CENTERLINE OF PIVOT. (For offset pivots, increase the marked dimensions by 1/8")
3. Place main arm on top of shaft, 100% to closer body, insert arm screw into top of shaft and tighten.
4. Attach shoe to frame as shown. (If more latching power is required, rotate shoe 180°)
5. Open door and insert rod in forearm.
6. With forearm at right angle to door (90°), insert forearm set screw and tighten. (IF HOLD OPEN ARM IS USED, THE NUT IS ON THE TOP FOR RH DOOR AND BOTTOM FOR LH DOOR)

### REGULATION:

A Normal closing time from 90° open position to door stop position is 4-6 secs, evenly divided between main swing speed and latch swing speed. Use socket key (furnished) to adjust speed. To slow main speed of door, turn regulating screw nearest shaft clockwise. To slow latch speed, turn regulating screw nearest latch clockwise.

### BACK CHECK

To increase back-check force, turn regulating screw nearest hinge clockwise. DO NOT USE ABRUPT BACKCHECK OR EXPECT DOOR CLOSER TO ACT AS A DOOR STOP.

### COVER

Place insert in proper cutout, then push cover against door. Tighten both cover screw securely.

### HOLD OPEN ADJUSTMENT (when hold open arm is used)

Loose adjusting nut, open door to desired hold open position and tighten nut. Do not permit door to swing beyond hold open setting.

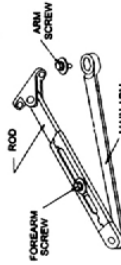
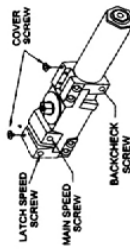
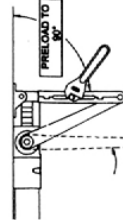

## TOP JAMB INSTALLATION CLOSER MOUNTED TOP JAMB ON PUSH SIDE OF DOOR

This drawing shown is RIGHT HAND DOOR.  
For LEFT HAND DOOR should be install in symmetry.

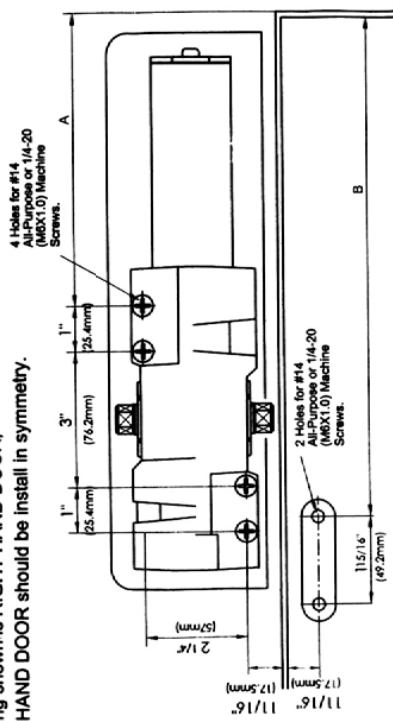

| OPENING        | 'A'   | 'B'          |
|----------------|-------|--------------|
| TO 7'-5 7/16\" | (185) | 11-13 1/16\" |
| TO 100\"       | (300) |              |
| TO 6-1 1/4\"   | (159) | 10-13 1/16\" |
| TO 130\"       | (275) |              |

1. Adjust spring power to match door width as indicated by chart on page 1.
2. Mount closer on frame as dimension shown. Tube and toward hinge. If pivots are used, locate closer and shoe from CENTERLINE OF PIVOT. (For offset pivots, increase the marked dimensions by 1/8")
3. Place main arm on top of shaft, 100% to closer body, insert arm screw into top of shaft and tighten.
4. Attach shoe to door as shown. (If more latching power is required, rotate shoe 180°)
5. Open door and insert rod in forearm--for reveal 2 5/8" through 4 13/16" use long rod. For inserts 4 7/8" to 8" use FOREARM EXTENDER (ROD)--available from dealer.
6. With forearm at right angle to door (90°), insert forearm set screw and tighten. (IF HOLD OPEN ARM IS USED, THE NUT IS ON THE BOTTOM FOR RH DOOR AND TOP FOR LH DOOR)

### REGULATION:

A Normal closing time from 90° open position to door stop position is 4-6 secs, evenly divided between main swing speed and latch swing speed. Use socket key (furnished) to adjust speed. To slow main speed of door, turn regulating screw nearest shaft clockwise. To slow latch speed, turn regulating screw nearest latch clockwise.

### BACK CHECK

To increase back-check force, turn regulating screw nearest hinge clockwise. DO NOT USE ABRUPT BACKCHECK OR EXPECT DOOR CLOSER TO ACT AS A DOOR STOP.

### COVER

Place insert in proper cutout, then push cover against frame. Tighten both cover screw securely.

### HOLD OPEN ADJUSTMENT (when hold open arm is used)

Loose adjusting nut, open door to desired hold open position and tighten nut. Do not permit door to swing beyond hold open setting.

