

# 6700-B-AB SERIES, ASYLUM TRIM ROUND KNOB INSTALLATION FOR MORTISE LOCK

**NOTES**

1. TRIM MUST BE MOUNTED VERTICALLY.
2. VISION LITE MUST BE AT LEAST 6" FROM CENTERLINE OF TRIM.
3. PREP DOOR PER OTHER MANUFACTURER'S MORTISE LOCK TEMPLATE.
4. MORTISE LOCK NOT PROVIDED.

| ITEM | QTY | PART DESCRIPTION                  |
|------|-----|-----------------------------------|
| 1A   | 1   | "B" ASYLUM TRIM ASSEMBLY          |
| 2A   | 1   | "B" ASYLUM TRIM ASSEMBLY          |
| 2B   | 1   | ADAPTER PLATE                     |
| 2C   | 1   | ASYLUM COVER                      |
| 3    | 8   | 8-32 x 1/4 PIN TORX FLAT HD. M.S. |
| 4    | 8   | 8-32 x 3/16 PHIL. FLAT HD. M.S.   |
| 5    | 2   | 10-32 x 1/2" FHMS                 |
| 6    | 1   | MORTISE LOCK BY OTHERS            |
| 7    | 1   | TRIM PLATE                        |
| 8    | 2   | 12-24 x 3/4" PH. F.H. COM. SCW.   |
| 9    | 2   | 8-32 x 1/4" FHMS                  |

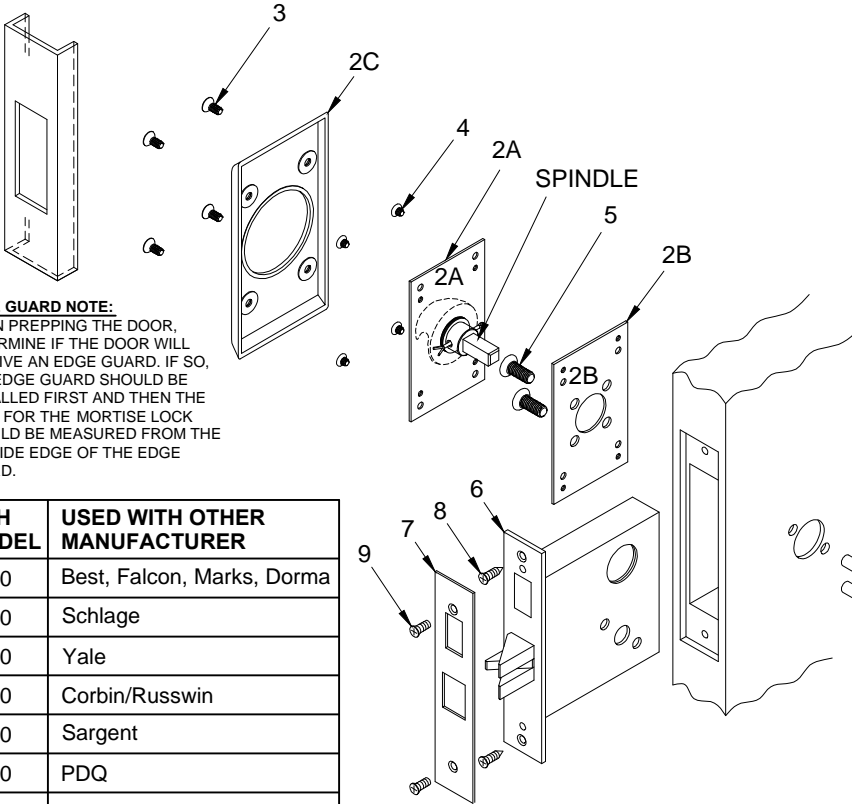

**EDGE GUARD NOTE:**  
WHEN PREPPING THE DOOR, DETERMINE IF THE DOOR WILL RECEIVE AN EDGE GUARD. IF SO, THE EDGE GUARD SHOULD BE INSTALLED FIRST AND THEN THE PREP FOR THE MORTISE LOCK SHOULD BE MEASURED FROM THE OUTSIDE EDGE OF THE EDGE GUARD.

| ABH MODEL | USED WITH OTHER MANUFACTURER |
|-----------|------------------------------|
| 6710      | Best, Falcon, Marks, Dorma   |
| 6720      | Schlage                      |
| 6730      | Yale                         |
| 6740      | Corbin/Russwin               |
| 6750      | Sargent                      |
| 6760      | PDQ                          |
| 6770      | Arrow                        |

Brand names are trademarks or registered trademarks of their respective companies

**INSTALLATION INSTRUCTIONS:**

1. Prep for lock body according to mortise lock manufacturer installation. Install mortise lock (item 6) using (2) 12-24 screws (item 8). Then mount the face plate (item 7) using (2) 8-32 screws (item 9).
2. A) Place the pre-assembled asylum trim assembly 1A on the side of the door that will match the diagonal mortise lock mounting through holes.  
 B) Place the adapter plate 2B centered with pre-assembled asylum trim assembly 1A while inserting the (2) mounting screws (item 5).  
 C) After tightening the mounting screws (item 5) test lock and asylum trim assembly 1A for proper latch retraction and knob operation. If the latch does not extend / retract or if trim knob is binding, loosen 10-32 screws (item 5) and adjust alignment for proper operation and re-tighten.  
 D) Place the asylum trim assembly 2A on the door so that spindle engages with the mortise lock and fasten with (4) 8-32 screws (item 4). Test the knob for latch retraction. If latch does not extend loosen both 10-32 screws (item 5) to readjust alignment and re-tighten.  
 E) Place the asylum cover (item 2C) on the asylum trim assembly and screw together with (4) 8-32 screws (item 3).

PATENT No. 6,196,599 & 5,730,478



® www.abhmfg.com  
 E-mail: abhinfo@abhmfg.com  
 Architectural Builders Hardware Mfg., Inc.  
 1222 Ardmore Ave., Itasca, IL 60143  
 630.875.9900; FAX 800.9FAXABH (932.9224)

© 2017 ABH Mfg., Inc.  
 printed in USA

6700-B-AB  
 PAGE 1 OF 1  
 ISSUED 02-03-17

6700-B-AB-00.DWG