

# Installation Instructions

**SARGENT**  
**ASSA ABLOY**

## 7800 & 8200 Series Mortise Lock

Used with VN1 Escutcheon Trim and V Series Indicators

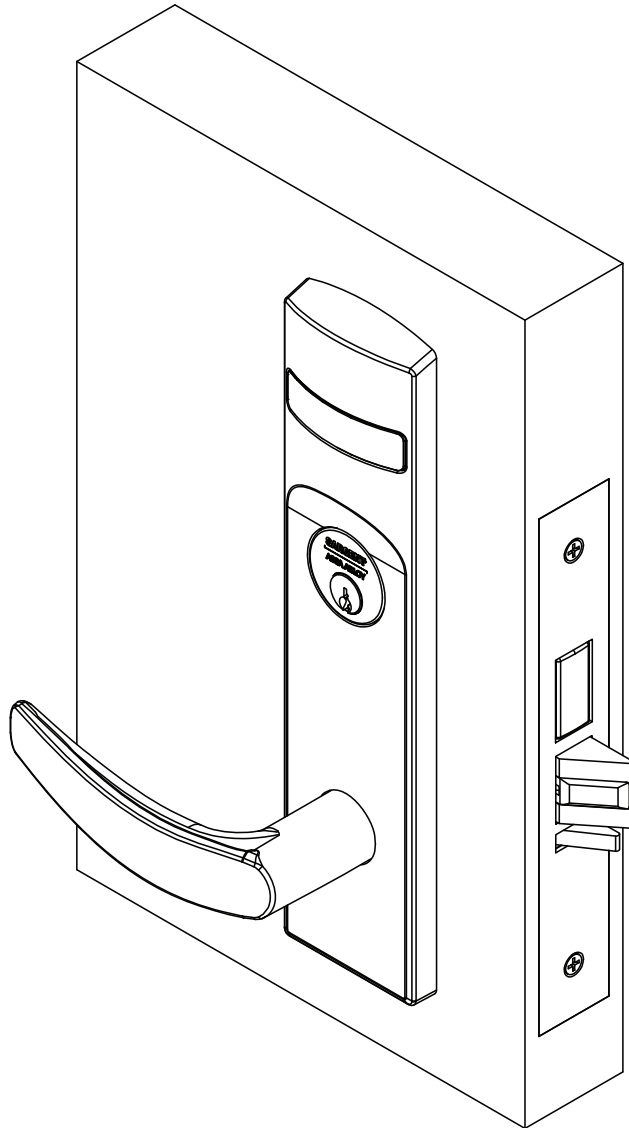

**⚠ WARNING**

Attention Installer: Improper installation may result in damage to the product and void the factory warranty.

1-800-727-5477 • [www.sargentlock.com](http://www.sargentlock.com)

Copyright © 2019, 2020, 2021, 2023, SARGENT Manufacturing Company. All rights reserved. Reproduction in whole or in part without the express written permission of SARGENT Manufacturing Company is prohibited. Patent pending and/or patent [www.assaabloydss.com/](http://www.assaabloydss.com/) patents.

A8260E 3/23

Experience a safer  
and more open world

# 7800 and 8200 Series Mortise Lock

Used with VN1 Escutcheon Trim and V Series Indicators

## Installation Instructions

### 1 Tools Required



#2 & #3 Phillips head screwdrivers



Flat blade screwdriver



1/8" Allen Wrench



3/8" Drill bit



T-20 Torx Screw with Tamper Pin Driver

### 2 Indicator Variants

Depending on function and option ordered, indicators are provided in the following variations, these instructions detail how to install with cylinder, however other variations follow similar instructions. (Figure 1)

Contact factory for any questions.

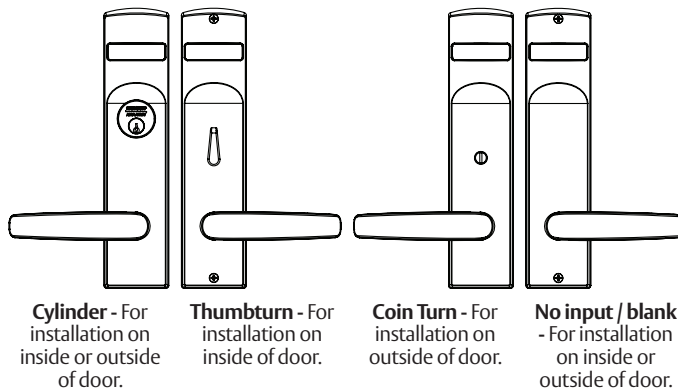

**Cylinder** - For installation on inside or outside of door.

**Thumbturn** - For installation on inside of door.

**Coin Turn** - For installation on outside of door.

**No input / blank** - For installation on inside or outside of door.

Figure 1

### 3 Lock set configuration

To set function of multi-function lock or to re-hand, see instructions on lock body.

# 7800 and 8200 Series Mortise Lock



Used with VN1 Escutcheon Trim and V Series Indicators

## Installation Instructions

### 4 Rehanding indicator (if required)

Indicator spindle cams MUST be oriented correctly per lock function and door mounting location. Verify hand and bevel of door. (Figure 2)

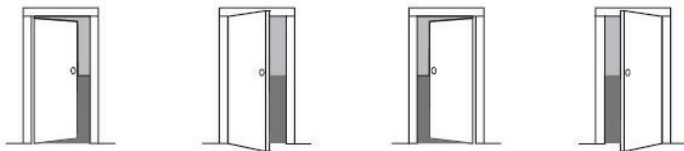

<b>LH</b> Left Hand Hinges Left Open Inward	<b>LHRB</b> Left Hand Reverse Bevel Hinges Left Open Outward	<b>RH</b> Right Hand Hinges Right Open Inward	<b>RHRB</b> Right Hand Reverse Bevel Hinges Right Open Outward
------------------------------------------------------	--------------------------------------------------------------------------	--------------------------------------------------------	----------------------------------------------------------------------------

Figure 2



Scan this QR code for the Sargent Indicator Handing Charts

Spindle Cam Position for Locks with Deadbolt (\*and 56 function)

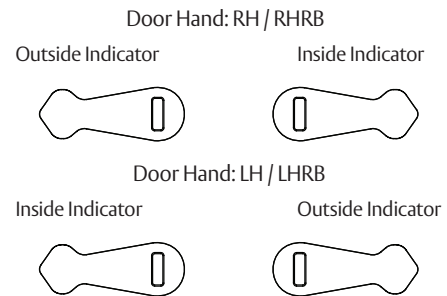

Spindle Cam Position for Locks without Deadbolt (\*except 56 function)

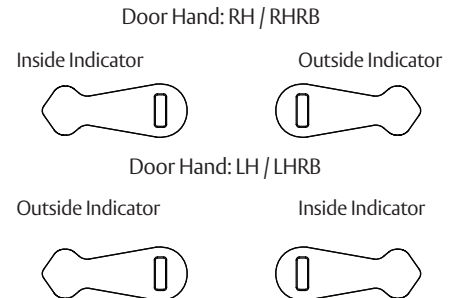

Figure 3

Stand outside of locked door when determining door hand.

Next, verify inside and/or outside indicators are handed correctly, using Spindle Cam Position chart. (Figure 3)

If they are handed correctly, skip to Step 5 “Prepare Door”.

If they are not handed correctly:

1. Remove indicator back plate by pulling out from top slot, then remove spindle cam from assembly. (Figure 4)
2. Position spindle cam in correct direction for door hand. (Figure 3)

**Important:**

- For thumbturn indicators, make sure thumbturn is positioned in 12 o’clock direction as shown. (Figure 5)
3. Slide spindle cam post into the correct slot of the display slide. (Figure 4)
  4. Re-seat back plate into original position.
  5. Return indicator to vacant/unlocked position for installation.

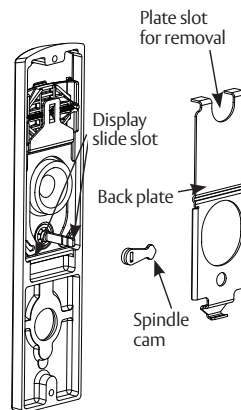

Figure 4

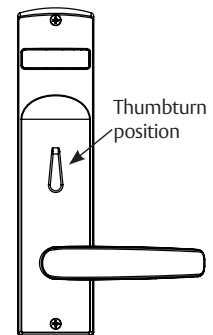

Figure 5

# 7800 and 8200 Series Mortise Lock



Used with VN1 Escutcheon Trim and V Series Indicators

## Installation Instructions

### 5 Installation

#### a Prepare Door

Prepare door for function holes, size, and location according to A8258 door marker template, if not already prepped.

#### b Install Lock

1. Verify strike location according to template. Clean out door pocket and door edge of debris.
2. Ensure handing of lock matches handing of door. Slide lock into door. (Figure 6)
3. Temporarily hand tighten two (2) lock screws (#12 x 1-1/4" wood screws, or #12-24 x 1/2" machine screws).

#### Notes:

- Keep door open until installation is complete.

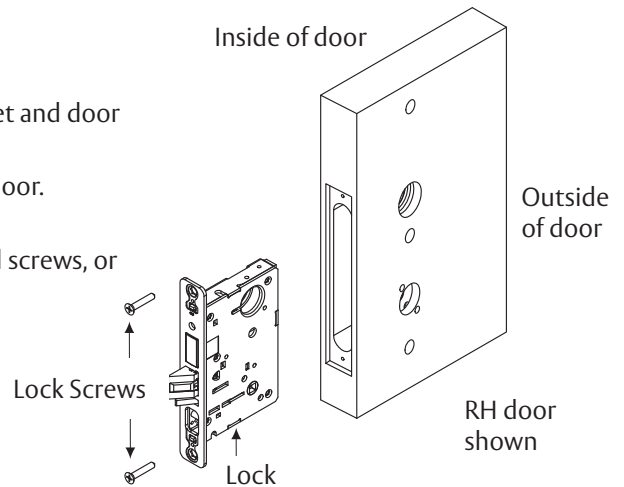

Figure 6

#### c Install Outside Trim

1. Verify lock is in unlocked state (control hub slot should be vertical). Also, verify indicator is in vacant/unlocked position.
2. Align trim posts with diagonal holes in door, be sure lever is horizontal. Slide outside escutcheon assembly through lock body from outside door face. (Figure 7)

#### Note:

If indicator is used on outside, align indicator spindle with control hub.

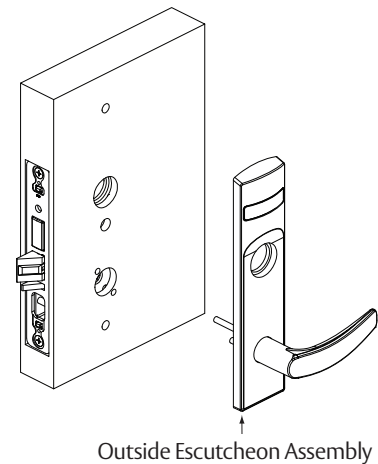

Figure 7

# 7800 and 8200 Series Mortise Lock



Used with VN1 Escutcheon Trim and V Series Indicators

## Installation Instructions

### 5 Installation, continued

#### d Install Inside Trim

1. Slide spindle into lockbody hub. (Figure 8)
2. Slide adapter and plate assembly over spindle.
3. Secure with two (2) #8-32 x 5/8" screws.
4. For Studio Collection levers only, use trim bushing over adapter plate.
5. Verify lock is in unlocked state (turn outside lever to ensure).  
Also, Verify indicator is in vacant/unlocked position.
6. Align escutcheon over adapter and install inside escutcheon assembly onto inside door face.

**Note:**

- If indicator is used on inside, align indicator spindle with control hub.
7. Through-bolt inside escutcheon to outside escutcheon with two (2) #8-32 x 2-1/4" screws.
  8. Install inside lever on adapter plate. Secure with set screw.

**Note:**

Screw heads should be visible on inside escutcheon.

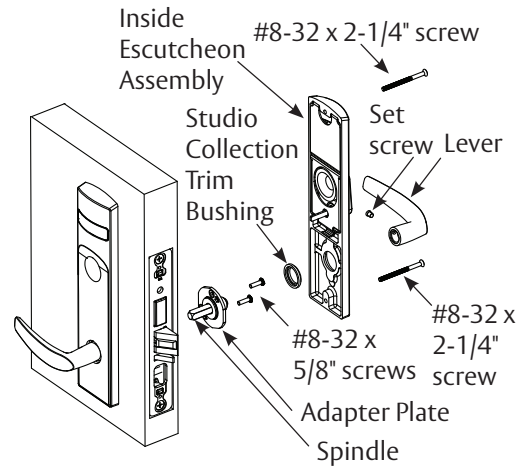

Figure 8

#### e Install Cylinder

1. Thread cylinder into lock until flush with escutcheon surface. (Figure 9)
  - Pull key slightly out of cylinder to help thread into lock body.
2. Tighten cylinder clamp screw with #1 Phillips screwdriver.
  - Check operation and adjust cylinder if necessary.

**Notes:**

- SARGENT logo must be horizontal and on top. (Figure 10)

Key and cylinder must be rotated as shown.

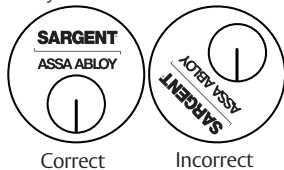

Figure 10

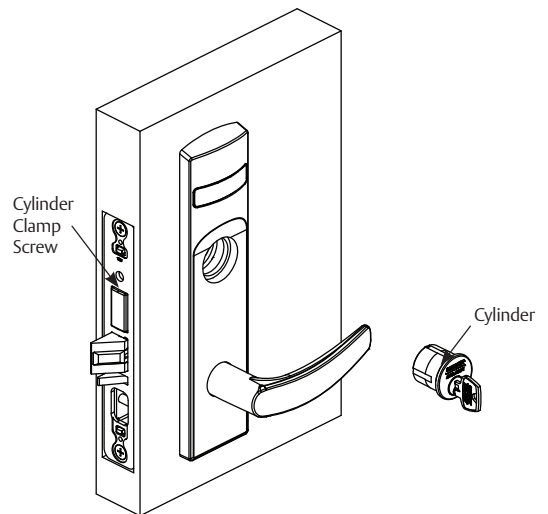

Figure 9

- If double cylinder function is used, repeat steps 1 and 2 for second cylinder.
- Removable Core or Interchangeable Core cylinders require a control key (key stamped with C) to remove and install the core. This is not provided standard. It must be requested separately. If requesting 1-bitted control key, specify 113511 cut.

# 7800 and 8200 Series Mortise Lock

**SARGENT**

**ASSA ABLOY**

Used with VN1 Escutcheon Trim and V Series Indicators

## Installation Instructions

### f Install Outside Front

1. Tighten the two (2) lock screws completely. (Figure 11)
2. Attach outside front with two (2) flat head screws #8-32 x 1/4".

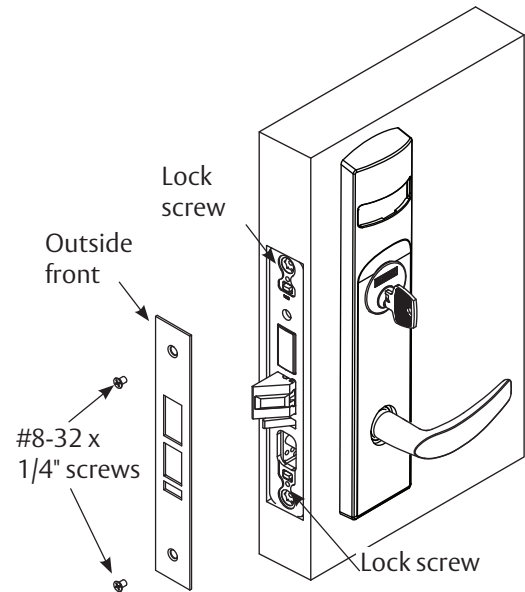

Figure 11

### g Perform Functional Check

DO NOT FORCE if resistance is encountered during functional check. Refer back to Rehanding Indicator (if required) section to ensure correct handing. Rehand if necessary.

1. Insert key into cylinder (if present) and rotate:
  - Ensure there is no friction against lock case or any other obstructions.
2. Check key retracts latch:
  - Key should rotate freely.
3. Throw deadbolt (if present):
  - Check key retracts both deadbolt and latch.
4. Test levers:
  - Confirm latch and deadbolt (if installed) retract.
5. Verify indicator displays correct status when locked and unlocked.

# 7800 and 8200 Series Mortise Lock

**SARGENT**

**ASSA ABLOY**

Used with VN1 Escutcheon Trim and V Series Indicators

## Installation Instructions

### 6 Indicator Parts List

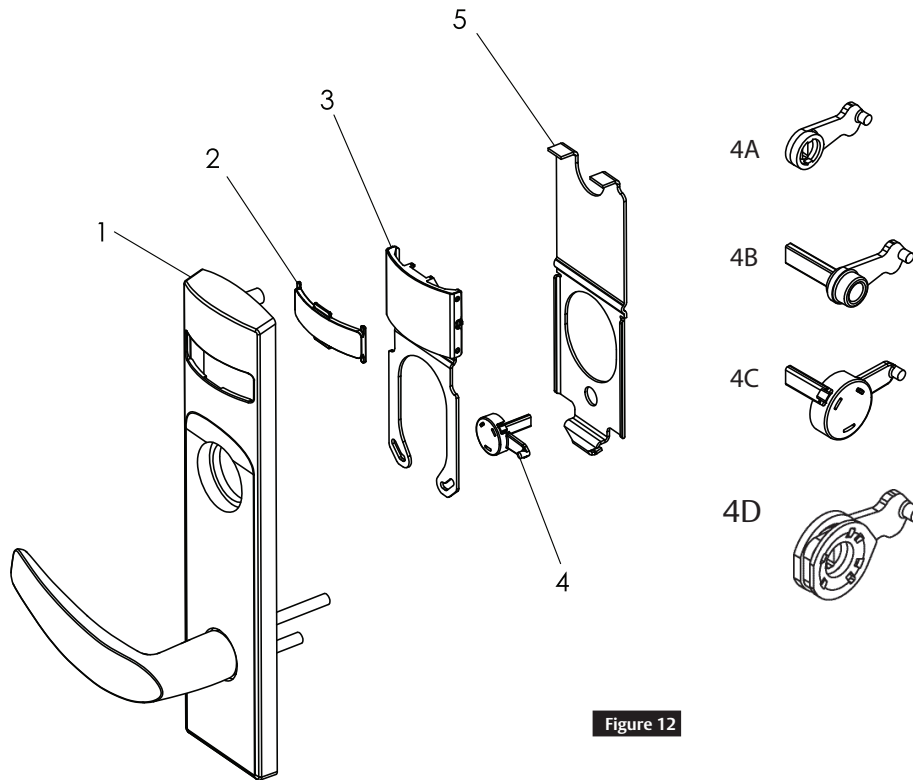

Figure 12

Figure 12	Description	Part Number	Req.
1	VN1 Indicator Escutcheon	Consult Factory	1
2	Indicator Window	81-0811	1
3	Indicator Display Assembly - Green Unlocked / Red Locked	82-5602	1
	Indicator Display Assembly - Green Vacant / Red Occupied	82-5603	
	Indicator Display Assembly - Green Unlocked Icon / Red Locked Icon	82-5604	
	Indicator Display Assembly - White Unlocked / Red Locked	82-5605	
	Indicator Display Assembly - White Vacant / Red Occupied	82-5606	
	Indicator Display Assembly - White Unlocked Icon / Red Locked Icon	82-5607	
	Indicator Display Assembly - Green Ouvert / Red Fermé	82-5684	
	Indicator Display Assembly - Green Libre / Red Occupée	82-5685	
4A	Indicator Spindle Cam - Thumbturn / Coin Turn	81-0745	1
4B	Indicator Spindle Cam - Cylinder / No Input / Blank	81-0756*	1
4C	Indicator Spindle Cam - 05, 37, 38, 59 Functions	82-5577*	1
4D	Indicator Spindle Cam - 05 (Inside)	82-5673	1
5	Indicator Backing Plate	81-0748	1
6	VN1 Escutcheon Screw Pack (Not shown)	82-5587 x finish*	1
7	Door Marker Template (Not shown)	A8258	1

\* These parts are for 1-3/4" standard thickness doors. For other thicknesses, please contact factory.

**Note:**

Reference 8200 Series parts manual for all lock body parts.

 **WARNING**

This product can expose you to lead which is known to the state of California to cause cancer and birth defects or other reproductive harm. For more information go to [www.P65warnings.ca.gov](http://www.P65warnings.ca.gov).

1-800-727-5477 • [www.sargentlock.com](http://www.sargentlock.com)

Copyright © 2019, 2020, 2021, 2023, SARGENT Manufacturing Company. All rights reserved. Reproduction in whole or in part without the express written permission of SARGENT Manufacturing Company is prohibited. Patent pending and/or patent [www.assaabloydss.com/patents](http://www.assaabloydss.com/patents).

A8260E 3/23

Experience a safer  
and more open world