

**A505 - "TW" or "EZ" OPTION, CONCEALED ELECTRIFICATION, FULL CONCEALED, DUAL EDGE GUARD, STAINLESS STEEL HINGE**

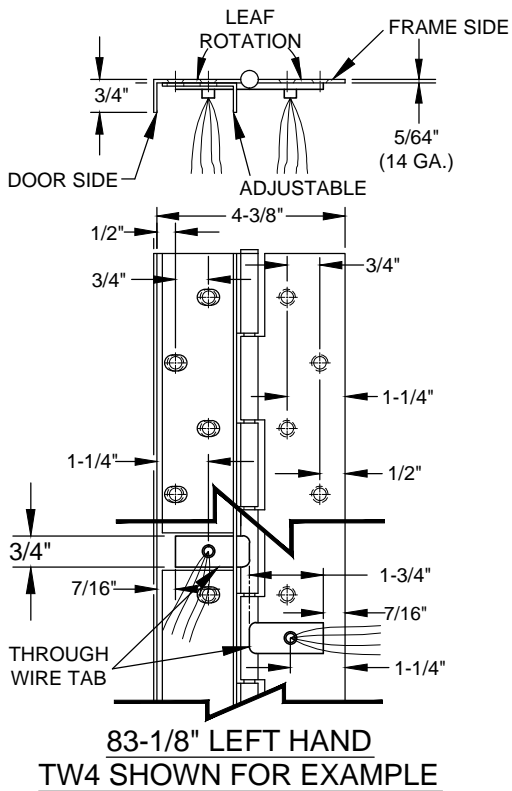

- NOTES:**
- HINGES CUT TO CUSTOM LENGTH ARE CUT FROM BOTTOM OF HINGE.
  - SPECIFY HANDING WHEN ORDERING.
  - SPECIFY WIRE CONFIGURATION WHEN ORDERING, TEMPLATE REMAINS THE SAME.
    - CT4
    - CT8
    - CT12
    - CT4 x EZ \*
    - CT8 x EZ \*
    - CT12 x EZ \*
  - IF "M" OPTION (MOVEABLE PANEL) IS CHOSEN, TEMPLATE REMAINS THE SAME.
  - 30 AWG WIRES, APPROX. 4" LONG PER SIDE, RATED 2 AMP CONTINUOUS LOW VOLTAGE.
  - THRU WIRE LOCATION DIMENSIONS +/- 1/16".

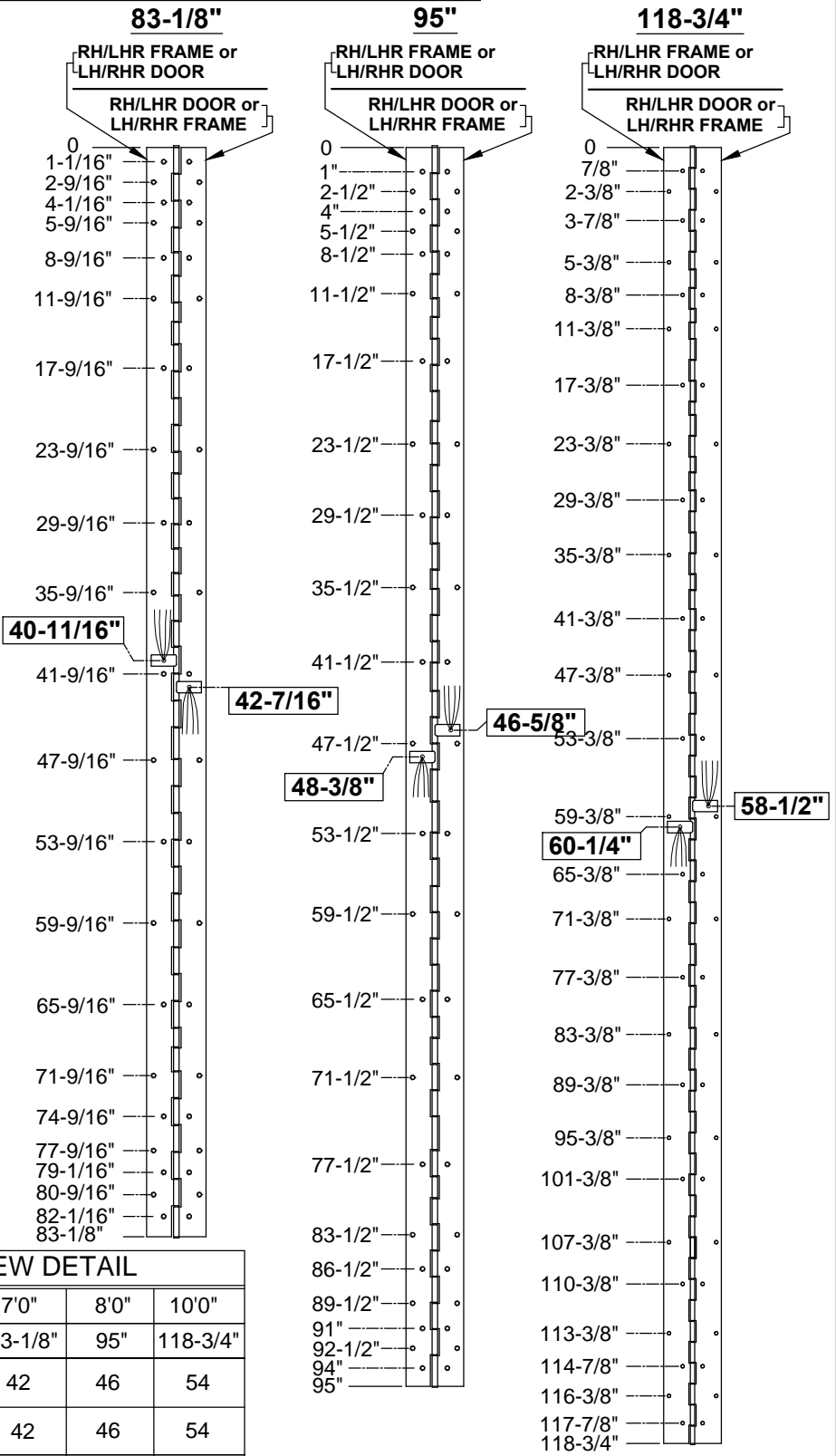

STANDARD HINGE SIZES & SCREW DETAIL			
NOMINAL DOOR HEIGHT	7'0"	8'0"	10'0"
ACTUAL HINGE HEIGHT	83-1/8"	95"	118-3/4"
10-24 x 7/8" PHILLIPS FLAT HEAD, UNDERCUT, SELF-DRILLING MACHINE SCREW	42	46	54
#10 x 1-1/4" PHILLIPS FLAT HEAD, UNDERCUT, SHEET METAL SCREW	42	46	54
*AS* ADJUSTABLE STUDS & 10-32 x 3/4" PHILLIPS FLAT HEAD, UNDERCUT, MACHINE SCREW	21	23	54

THIS DRAWING IS NOT TO SCALE.

A505-TW or EZ OPTION, CONCEALED ELECTRIFICATION-1-01.DWG



www.abhmfg.com  
 E-mail: abhinfo@abhmfg.com  
 Architectural Builders Hardware Mfg., Inc.  
 1222 Ardmore Ave., Itasca, IL 60143  
 630.875.9900; FAX 800.9FAXABH (932.9224)

**A505 - "TW" or "EZ" OPTION  
 CONCEALED ELECTRIFICATION**

© 2018 ABH Mfg., Inc.  
 printed in USA

PAGE 1 OF 2  
 REVISED 02-17-17

**A505 - "TW" or "EZ" OPTION, CONCEALED ELECTRIFICATION, FULL CONCEALED, DUAL EDGE GUARD, STAINLESS STEEL HINGE**

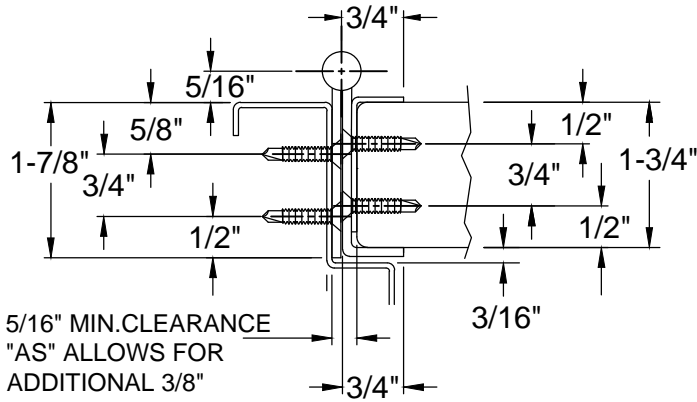

**CLOSED POSITION**  
( WIRES NOT SHOWN)

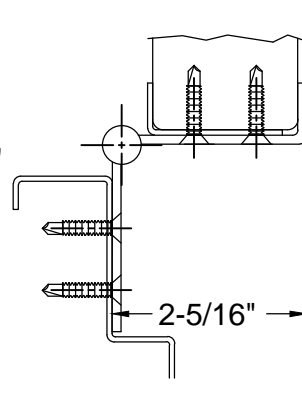

**90° OPEN POSITION**  
( WIRES NOT SHOWN)

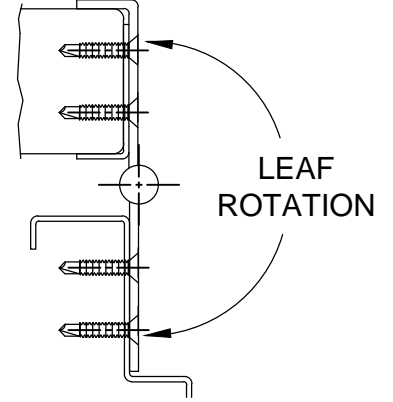

**180° OPEN POSITION**  
( WIRES NOT SHOWN)

**EZ CONNECT OPTION**

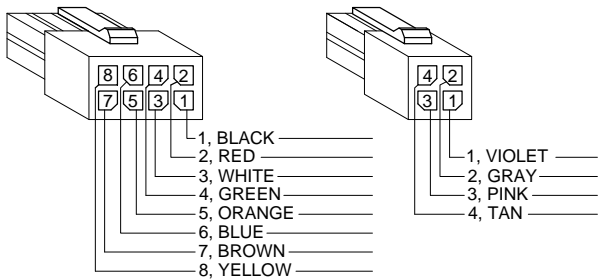

- 1, BLACK
- 2, RED
- 3, WHITE
- 4, GREEN
- 5, ORANGE
- 6, BLUE
- 7, BROWN
- 8, YELLOW
- 1, VIOLET
- 2, GRAY
- 3, PINK
- 4, TAN

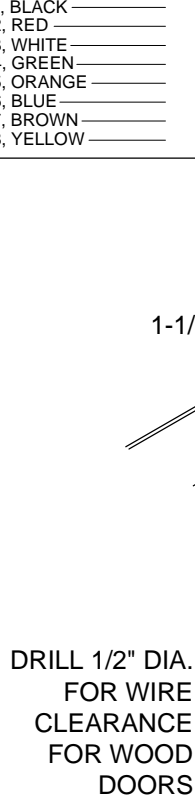

**83-1/8" LEFT HAND**  
**SHOWN FOR EXAMPLE**

A505-TW or EZ OPTION, CONCEALED ELECTRIFICATION-2-01.DWG



www.abhmfg.com  
E-mail: abhinfo@abhmfg.com  
Architectural Builders Hardware Mfg., Inc.  
1222 Ardmore Ave., Itasca, IL 60143  
630.875.9900; FAX 800.9FAXABH (932.9224)

**A505 - "TW" or "EZ" OPTION**  
**CONCEALED ELECTRIFICATION**

© 2018 ABH Mfg., Inc.  
printed in USA

PAGE 2 OF 2  
REVISED 02-17-17