

# A563 FULL SURFACE SELF-CLOSING HINGE, FLUSH MOUNT

## 6"x5" SQ. CORNER

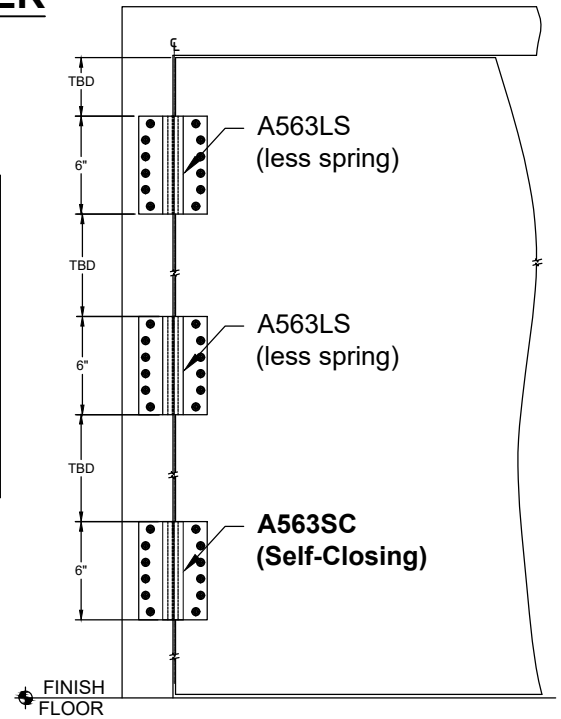

**Front view of Door  
Hinge Location for example**

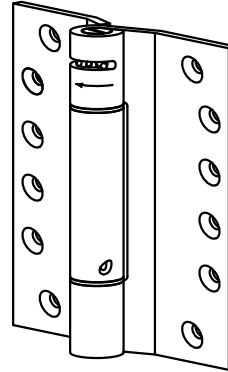
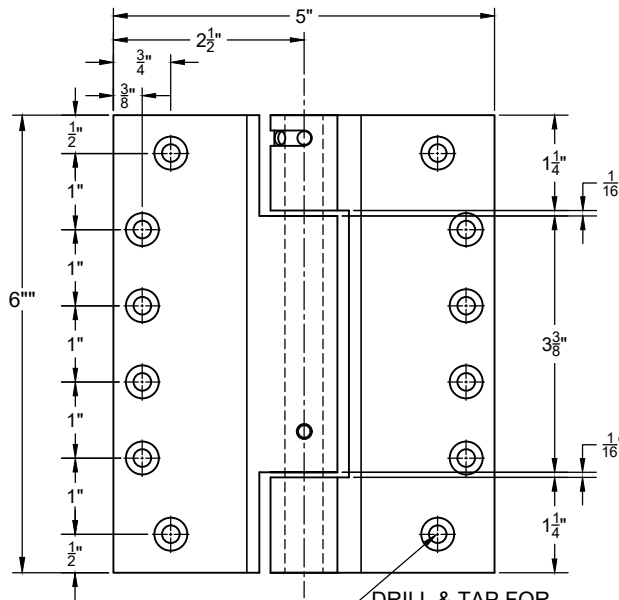
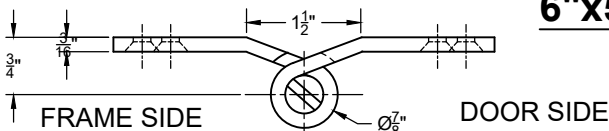
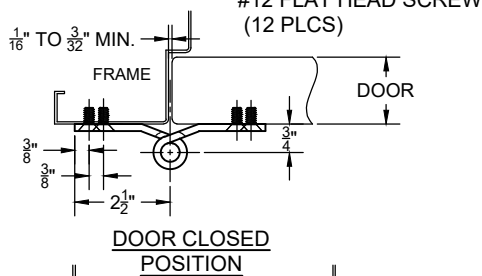

**DOOR CLOSED POSITION**

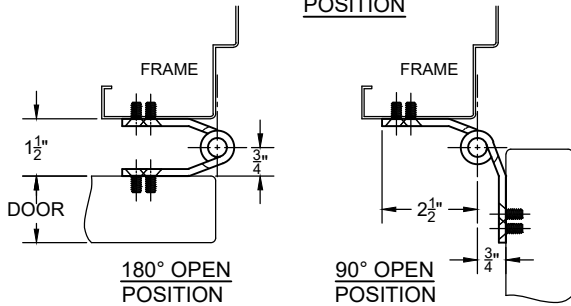

**180° OPEN POSITION**

**90° OPEN POSITION**

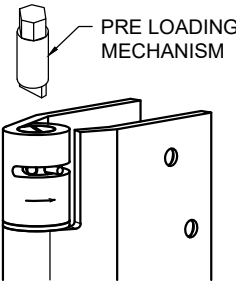

**Diagram-A**

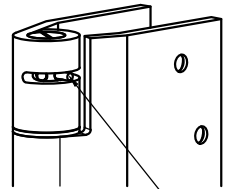

**Diagram-B**

### NOTES:

1. SELF-CLOSING SPRING HINGES ARE DESIGNED TO BE INSTALLED "FULL SURFACE, FLUSH MOUNT".
2. CLOSING POWER IS ADJUSTABLE UP OR DOWN.
4. HINGES ARE NON-HANDED.
5. 1/32" TOLERANCE ON ALL PARTS
6. DO NOT SCALE DRAWING

### INSTALLATION:

1. INSTALL THE HINGE IN DOOR & FRAME.
2. TO SET SPRING TENSION, INSERT PRE-LOADING MECHANISM TO TOP OF HINGE & ROTATE CLOCK WISE. (Diagram-A)
3. INSERT LOCKING PIN ONCE DESIRED TENSION ACHIEVED. (Diagram-B)
4. MORE THAN THREE HOLES TURN ARE NOT RECOMMENDED TO AVOID DAMAGE THE SPRING.

SCREW DETAIL	
QTY.	DESCRIPTION
12	12-24 x 3/4" PHILLIPS FLAT HEAD MACHINE SCREW, S.S.
12	#12 x 1-1/2" PHILLIPS FLAT HEAD SHEET METAL SCREW

**ABH**  
MANUFACTURING INC.

www.abhmfg.com  
E-mail: abhinfo@abhmfg.com  
Architectural Builders Hardware Mfg., Inc.  
1222 Ardmore Ave., Itasca, IL 60143  
630.875.9900; FAX 800.9FAXABH (932.9224)

A563 FULL SURFACE SELF CLOSING HINGE.DWG

**A563 FULL SURFACE  
SELF-CLOSING HINGE**

© 2020 ABH Mfg., Inc.  
printed in USA

ISSUED 04-24-20