

# A563LS(Less Spring) FULL MORTISE MOUNT 6"x5" SQ. CORNER

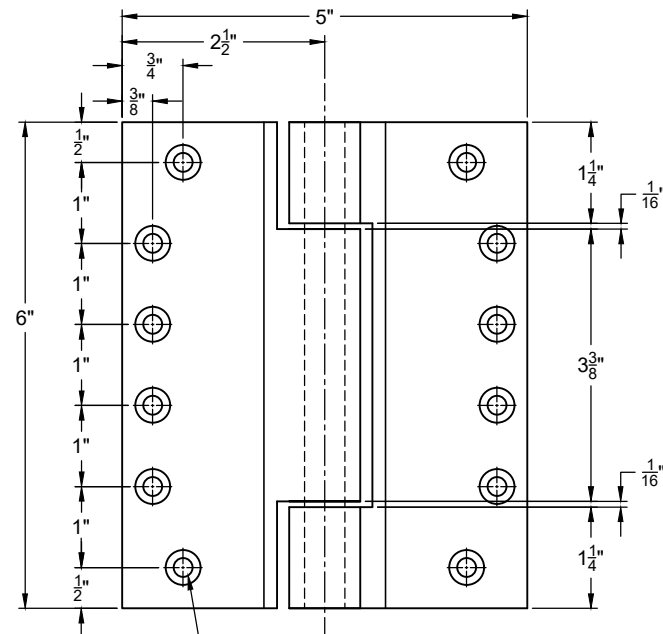

DRILL & TAP  
FOR #12 FLAT  
HEAD SCREW  
(12 PLCS)

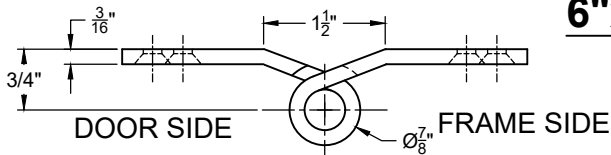
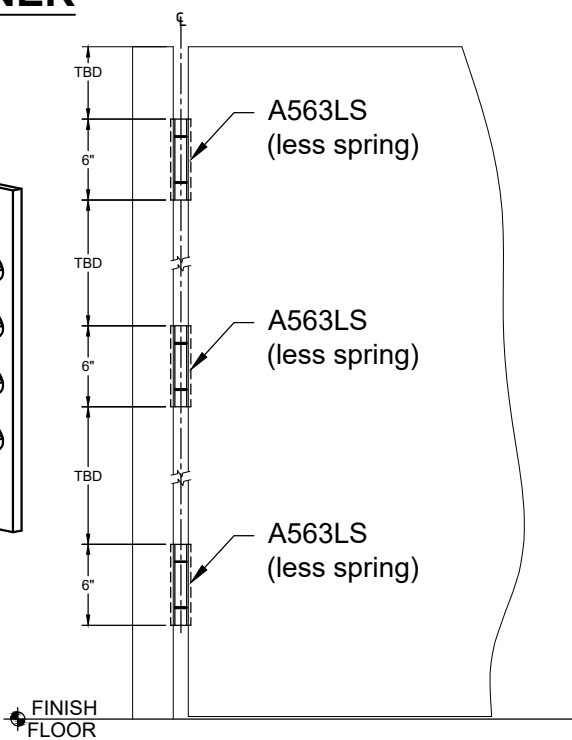
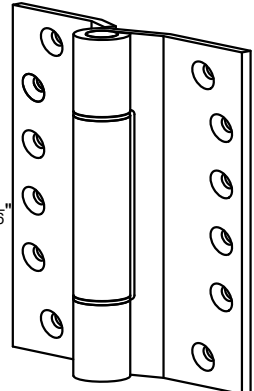
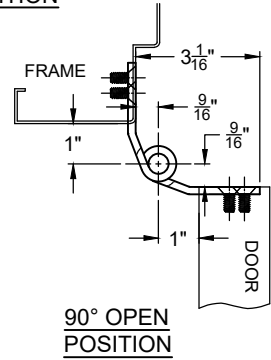
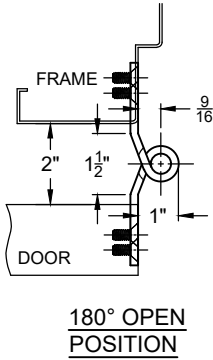
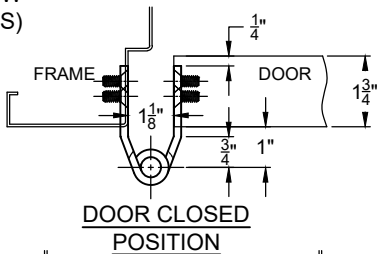

**Front view of Door  
Hinge Location for example**

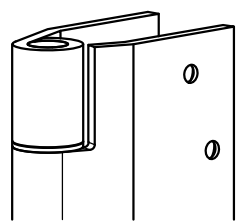

**Diagram-A**

**NOTES:**

1. HINGES ARE DESIGNED TO BE INSTALLED "FULL MORTISE".
2. CAN BE USED ON HOLLOW METAL OR WOOD FRAMES AND DOORS.
3. HINGES ARE NON-HANDED.
4. 1/32" TOLERANCE ON ALL PARTS
5. DO NOT SCALE DRAWING.
6. DIAGRAM-A SHOWS HINGE IN OPEN POSITION.

SCREW DETAIL	
QTY.	DESCRIPTION
12	12-24 x 3/4" PHILLIPS FLAT HEAD MACHINE SCREW, S.S.
12	#12 x 1-1/2" PHILLIPS FLAT HEAD SHEET METAL SCREW

A563LS(Less Spring) FULL MORTISE SELF-CLOSING HINGE.DWG



[www.abhmfg.com](http://www.abhmfg.com)  
 E-mail: [abhinfo@abhmfg.com](mailto:abhinfo@abhmfg.com)  
 Architectural Builders Hardware Mfg., Inc.  
 1222 Ardmore Ave., Itasca, IL 60143  
 630.875.9900; FAX 800.9FAXABH (932.9224)

**A563LS (Less Spring)**  
 FULL MORTISE SELF-CLOSING HINGE

© 2020 ABH Mfg., Inc.  
 printed in USA

ISSUED 04-29-20