

DOOR OUTSIDE FACE

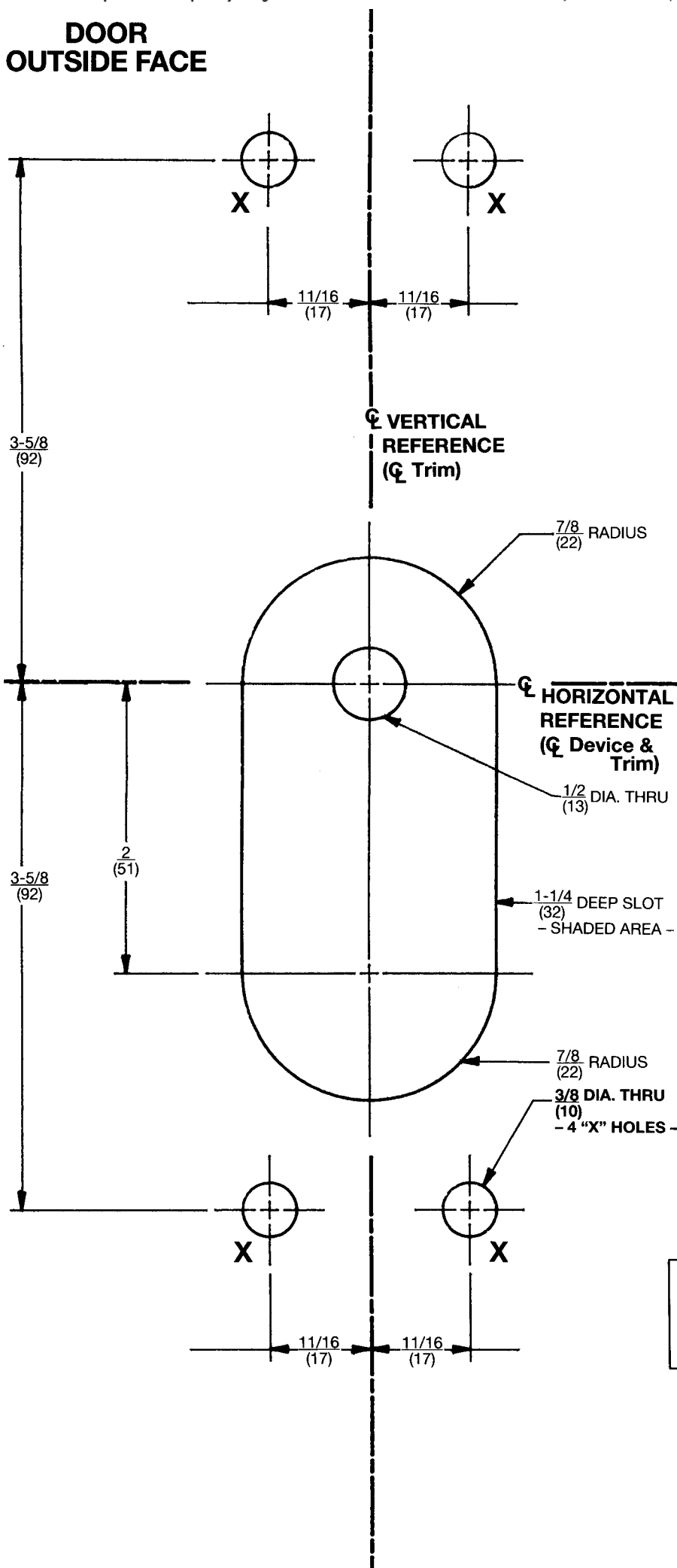

Installation Instruction

1. Check box contents. See other side for components.
2. After marking door inside face for device loc (Device Instructions), carry "Vertical Reference Centerline" from inside door face. Follow steps 2a. and 2b. below.

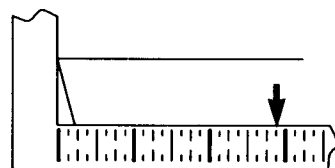

2a. MEASURE INSIDE LINE LOCATION.

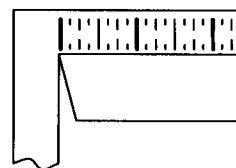

2b. CARRY DIMENS TO OUTSIDE FACE.

3. Carry "Horizontal Reference Centerline" from inside to outside door face.
4. Align trim template and tape to door outside face.
CAUTION: Office copiers and facsimile machines may change the size of a drawing and make the template inaccurate to use as a door marker. If this is not the original template packed with the trim, use only the dimensions written on the template to locate the holes on the door (do not use the template as a door marker).
5. Spot holes and prepare door for trim.
6. Mount trim to door. Fasten finger tight only 2 screws and washers seating on door, as shown in Figure 1.
7. Cut trim tailpiece as shown in Figure 2.
8. Seat device so that trim tailpiece penetrates slot, as shown in Figure 1. Continue as shown in device instructions.

CUT LINE



Figure 1

(2) Screws and washers bolt trim to door (holes "B").

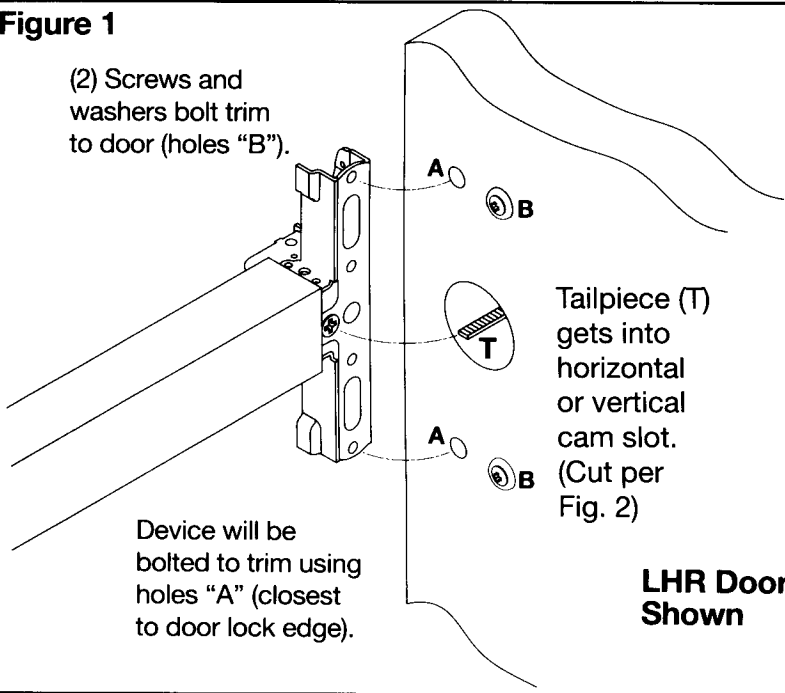

Device will be bolted to trim using holes "A" (closest to door lock edge).

Tailpiece (T) gets into horizontal or vertical cam slot. (Cut per Fig. 2)

LHR Door Shown

Figure 2

Trim must be unlocked (tailpiece fully extended).

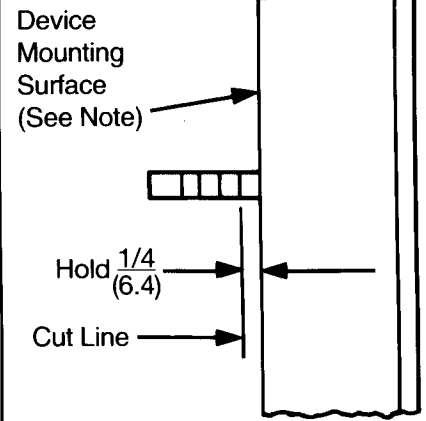

NOTE: Measure from device seat (door face or shim surface).

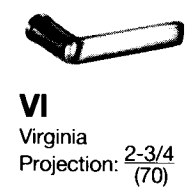
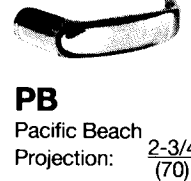
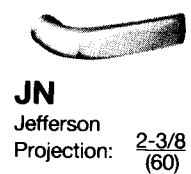
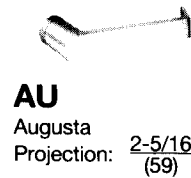
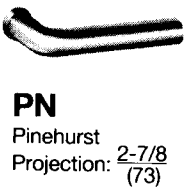
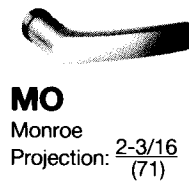
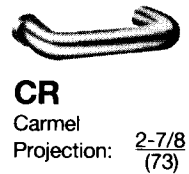
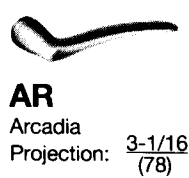
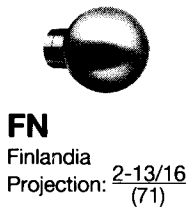
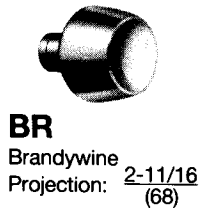

Passage Function

(Knob or Lever always active).

Non Handed

Handed (RHR or LHR)

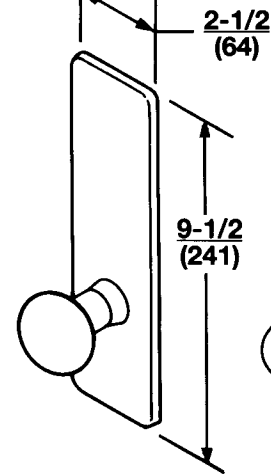

**524
524F**

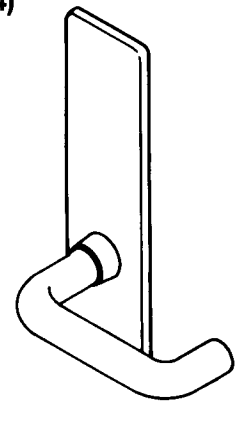

**528
528F**

Dimensions given in inches (mm).

**Yale® 524(F) & 528(F)
Series Trim
Installation Template**

524(F) & 528(F) TRIM COMPONENTS

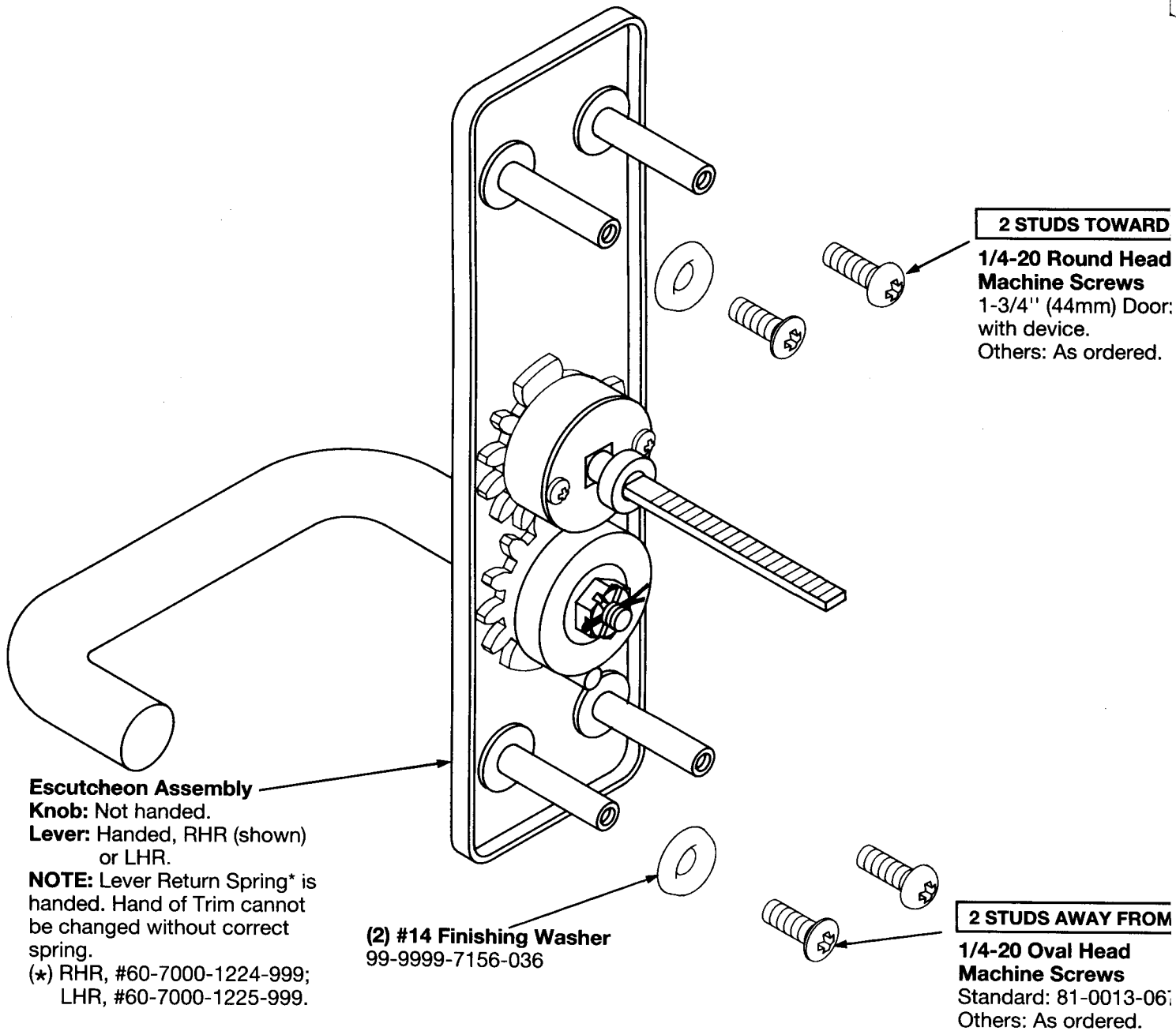

Note: 528(F) illustrated. 524(F) identical, except that actuator is a knob and trim is non-handed.

LOCK EDGE

Packed

LOCK EDGE

0-036