

# DOOR OUTSIDE FACE

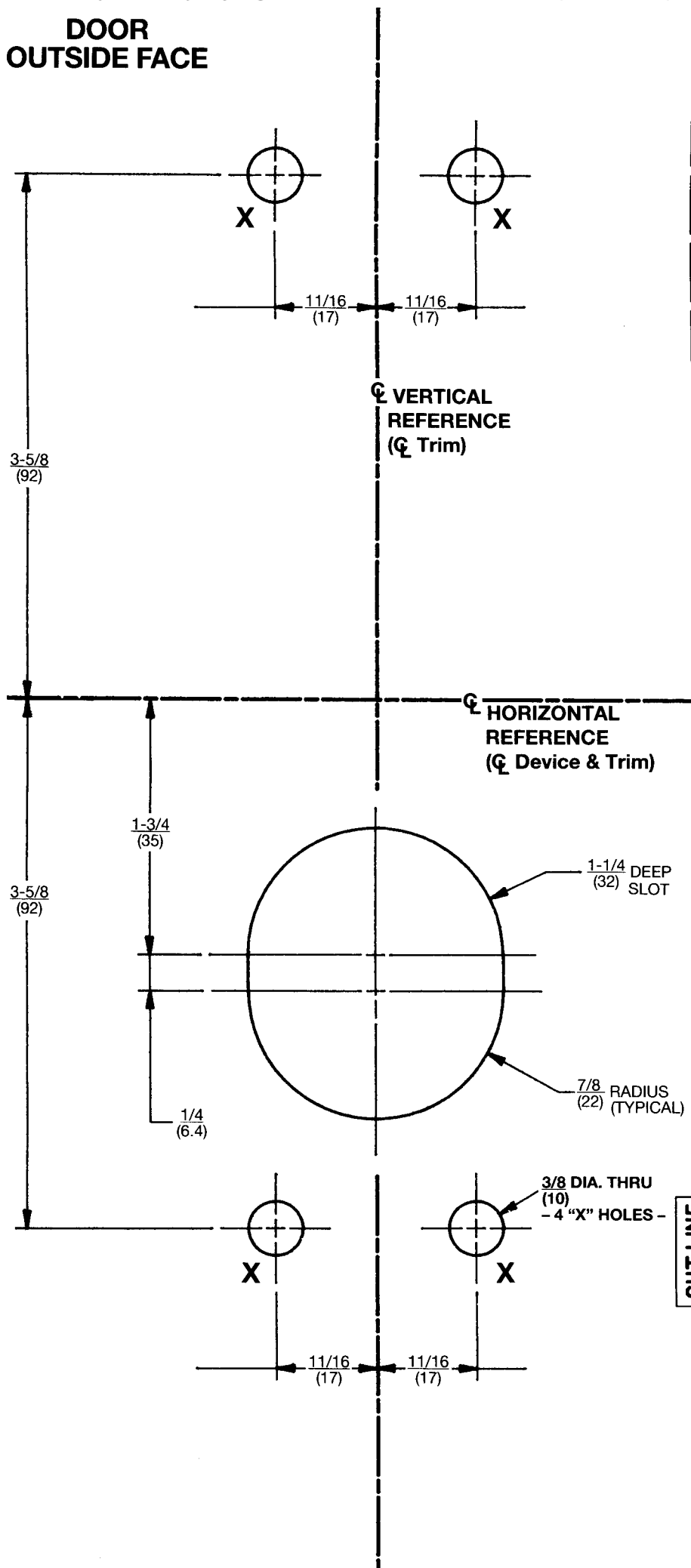

# Installation Instruction

1. Check box contents. See other side for components and hand of product.
2. After marking door inside face for device location (Device Instructions), carry "Vertical Reference Centerline" from inside door face. Follow steps 2a. and 2b. below.

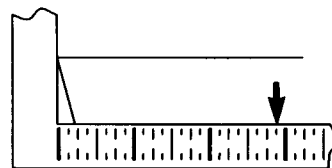

2a. MEASURE INSIDE LINE LOCATION.

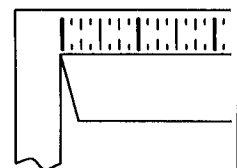

2b. CARRY DIMENSIONS TO OUTSIDE FACE.

3. Carry "Horizontal Reference Centerline" from inside to outside door face.
4. Align trim template and tape to door outside face.  
**CAUTION:** Office copiers and facsimile machines may change the size of a drawing and make the template inaccurate to use as a door marker. If this is not the original template packed with the trim, use only the dimensions written on the template to locate the holes on the door (do not use the template as a door marker).
5. Spot holes and prepare door for trim.
6. Mount trim to door. Fasten finger tight only 2 screws and washers seating on door, as shown in Figure 1.
7. Continue as shown in device instructions.

# Yale® 525(F) & 529(F) Series Trim Installation Template

Dimensions given in inches (mm)

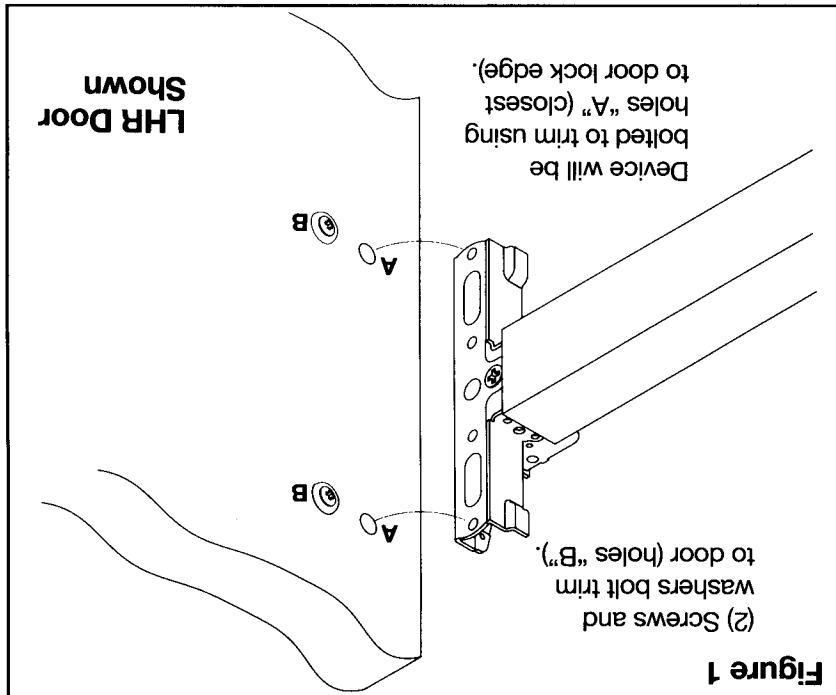
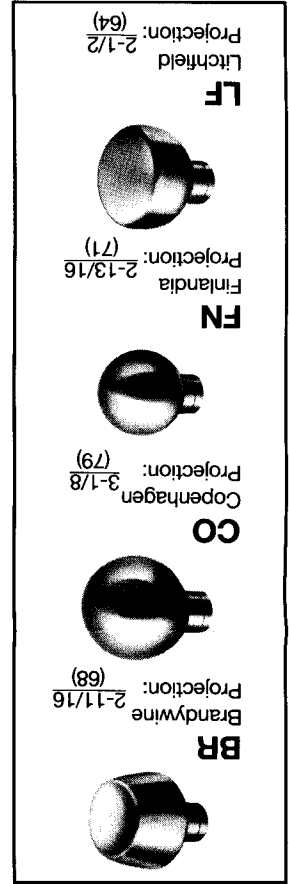
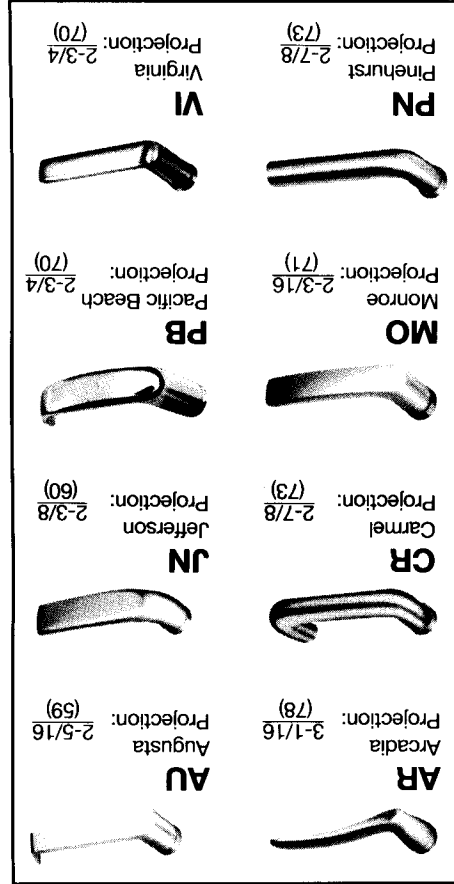
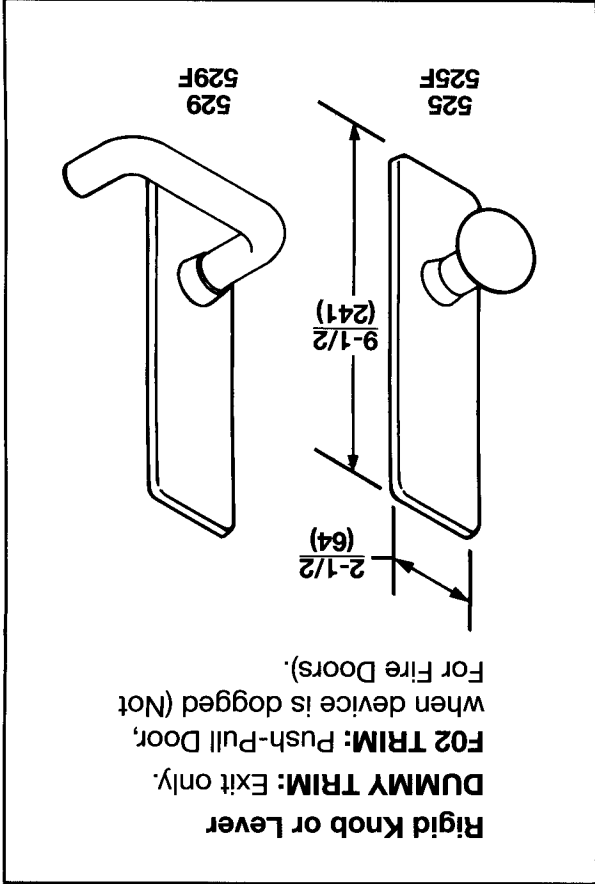

NS

om

de

ay

e

les

ker)

with

Show

LOCATION

ance

steps

FACE

SION OVER

# 525F & 529(F) TRIM COMPONENTS

## Escutcheon Assembly

**Knob:** Not handed.

**Lever:** Reversible, RHR (shown) or LHR.

**TO CHANGE HANDS:** Remove cotter pin, nut, spacer, hub and gear. Revolve lever 1/2 turn, lock in place with gear center teeth engaging welded post. Reassemble hub, spacer, nut and cotter pin.

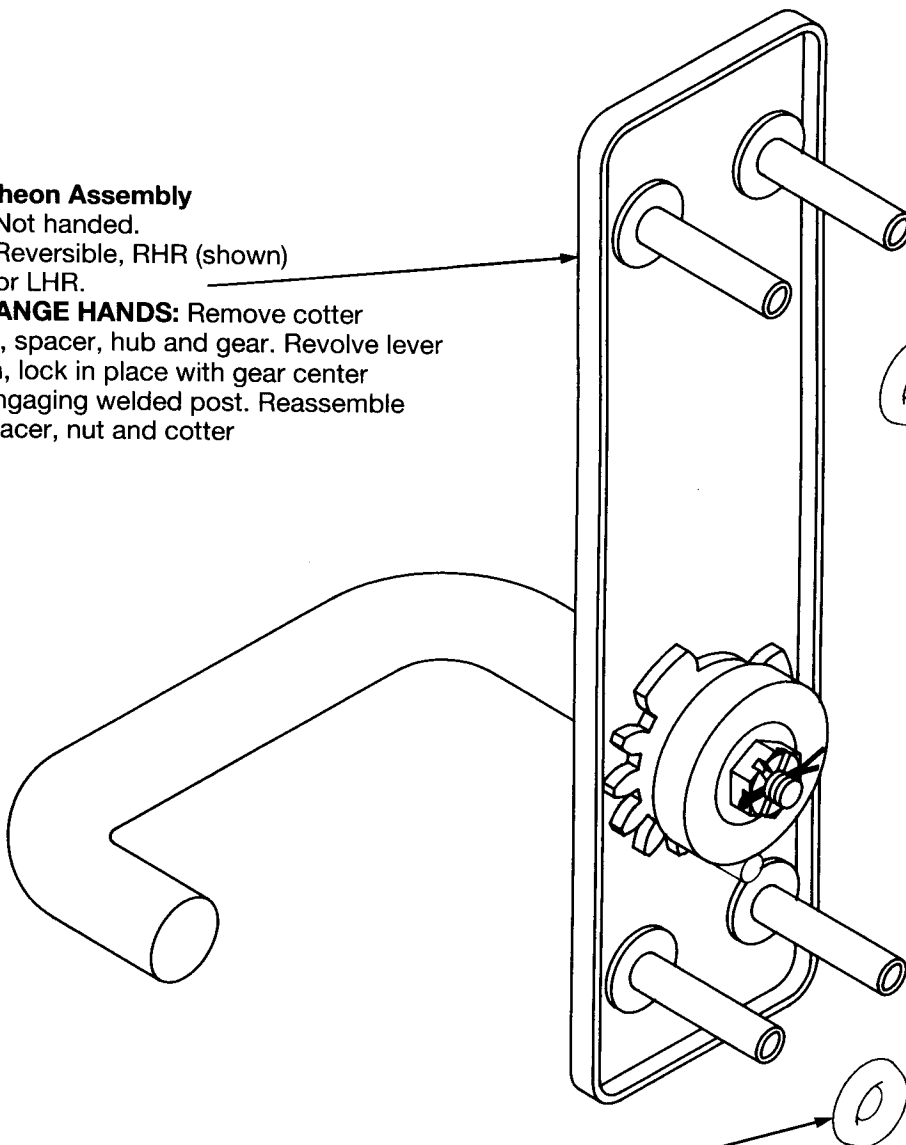

(2) #14 Finishing Washer  
99-9999-7156-036

2 STUDS TOWARD L

1/4-20 Round Head  
Machine Screws  
1-3/4" (44mm) Door: P  
with device.  
Others: As ordered.

2 STUDS AWAY FRO

1/4-20 Oval Head  
Machine Screws  
Standard: 81-0013-0  
Others: As ordered.

**Note:** 529(F) illustrated. 525(F) identical, except that actuator is a knob and trim is non-handed.

CK EDGE

cked

LOCK EDGE

70-036