

DOOR OUTSIDE FACE

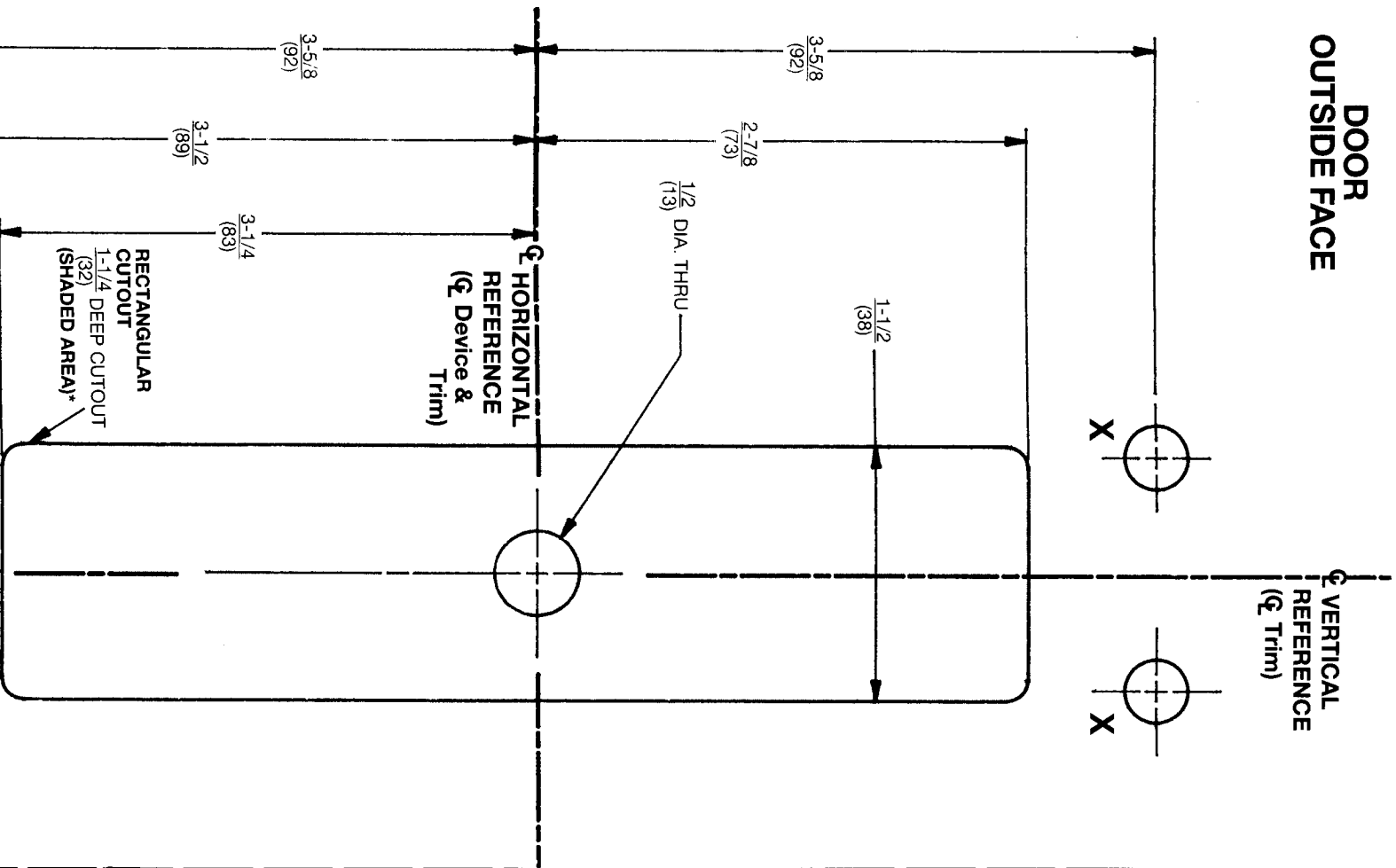

Installation Instructions

1. Assemble trim. See other side for components and instructions.
2. After marking door inside face for device location (Device Instructions), carry "Vertical Reference Centerline" from inside door face. Follow steps 2a. and 2b., in Figure 2 below.
3. Carry "Horizontal Reference Centerline" from inside to outside door face.
4. Align trim template and tape to door outside face.
CAUTION: Office copiers and facsimile machines may change the size of a drawing and make the template inaccurate to use as a door marker. If this is not the original template packed with the trim, use only the dimensions written on the template to locate the holes on the door (do not use the template as a door marker).
5. Spot holes and prepare door for trim.
6. Mount trim to door. Fasten finger tight only with 2 screws and washers seating on door, as shown in Figure 1, plus one engaged to pull bottom stud.
7. With trim unlocked (tailpiece turning when thumbpiece is depressed) cut trim tailpiece as shown in Figure 3.
8. Seat device so that trim tailpiece penetrates cam slot, as shown in Figure 1. Continue as shown in device instructions.

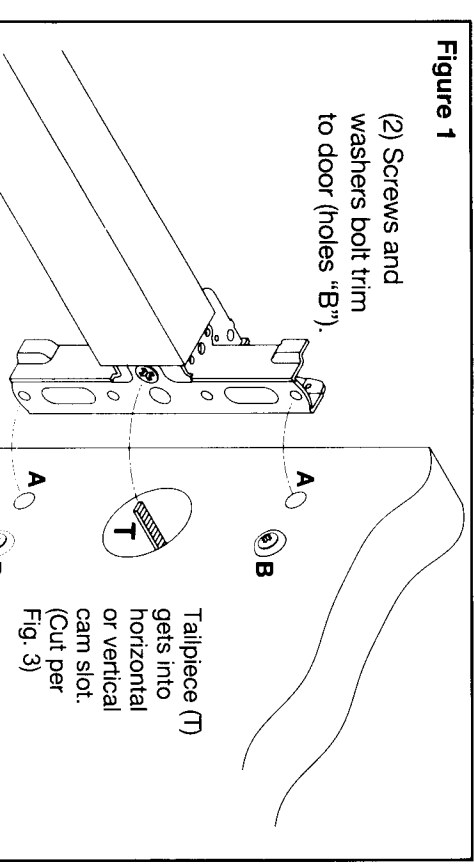

Figure 1
 (2) Screws and washers bolt trim to door (holes "B").
 Tailpiece (T) gets into horizontal or vertical cam slot. (Cut per Fig. 3)

Device will be bolted to trim using holes "A" (closest to door lock edge).

LHR Door Shown

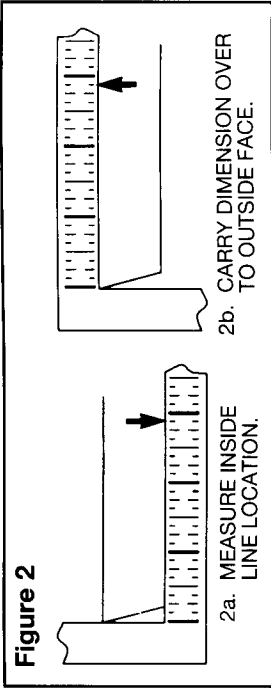

Figure 2

2b. CARRY DIMENSION OVER TO OUTSIDE FACE.

2a. MEASURE INSIDE LINE LOCATION.

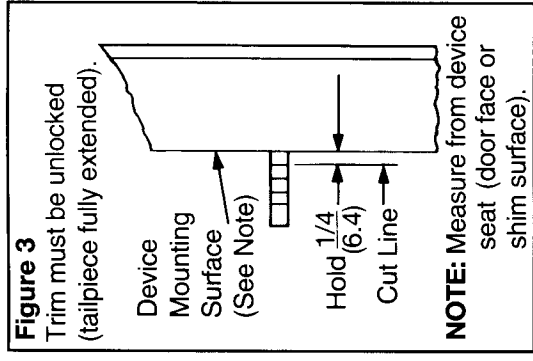
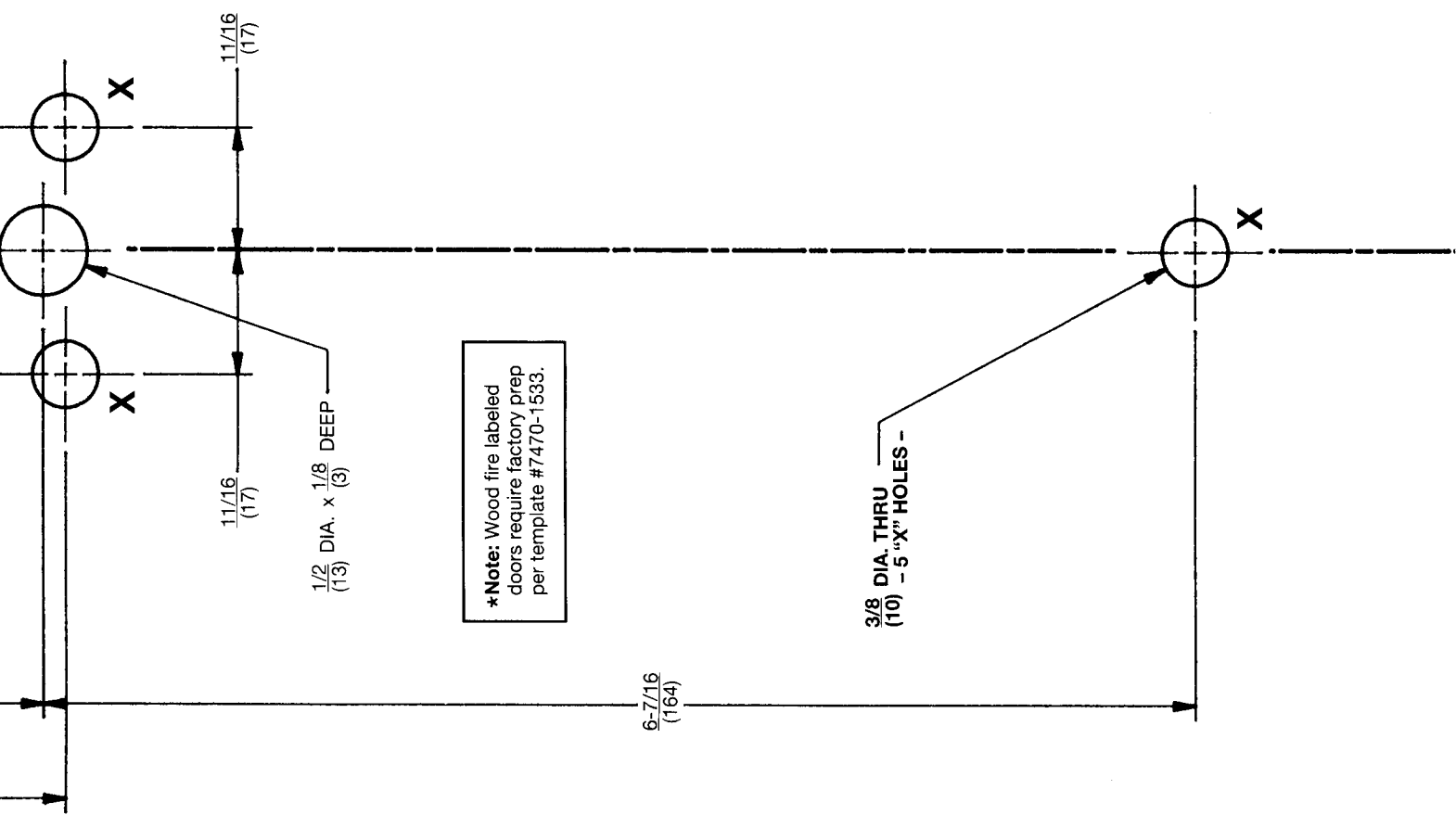

Figure 3
Trim must be unlocked (tailpiece fully extended).

NOTE: Measure from device seat (door face or shim surface).

Dimensions given in inches (mm).



***Note:** Wood fire labeled doors require factory prep per template #7470-1533.

3/8 DIA. THRU (10) - 5 "X" HOLES -

CUT LINE

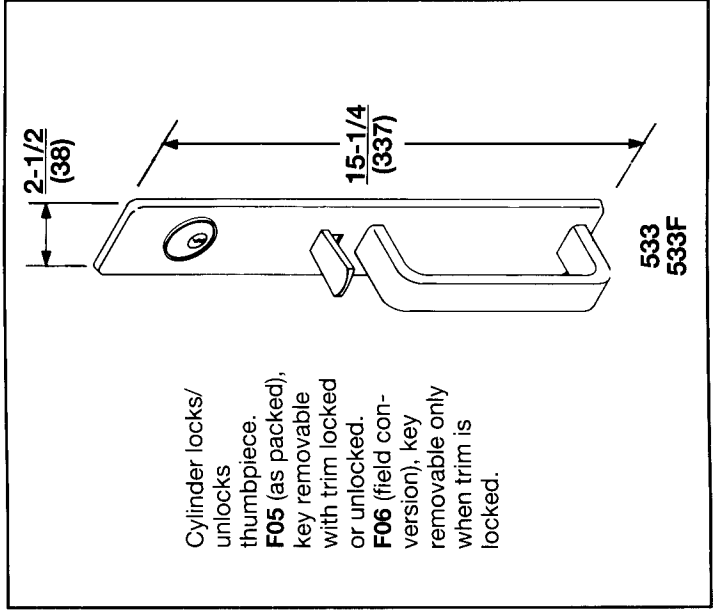

Cylinder locks/unlocks thumbpiece. **F05** (as packed), key removable with trim locked or unlocked. **F06** (field conversion), key removable only when trim is locked.

Yale® 533(F) Series Trim Installation Template

533(F) Trim Assembly Instructions

1. Check cylinder components. See "Cylinder Applications" chart. Non-standard cylinder rings and mounting screws must be supplied with optional cylinders.
2. Assemble cylinder. Insert Cylinder Housing prongs into Escutcheon matching notches. Pass Cylinder tailpiece thru Cylinder Ring and Cylinder Housing slot in cam. Bolt Cylinder seated in Cylinder Ring recess (DO NOT OVERTIGHTEN SCREWS).
3. Check cylinder action. Cylinder must freely rotate tailpiece into lock (cam pushing locking lever down) and unlock (shown) positions. When locking lever is engaged, it depresses the Trim spindle. The thumbpiece handle is, thus, disengaged from the spindle.
4. Cut cylinder tailpiece. Correct length is 1/16" to 3/16" (2 to 5mm) beyond Cylinder Housing cam.
5. Determine trim function.
 - F05:** As shipped. Key locks/unlocks thumbpiece handle.
 - Key removable in lock and unlock positions.
 - F06:** Field move Function Screw to hole in Cylinder Housing under cam tip. Key locks/unlocks thumbpiece handle. Key removable ONLY in lock position.

Rim Cylinder

(May be supplied by others.)
Standard: 1109 6-Pin, with 2 keys.

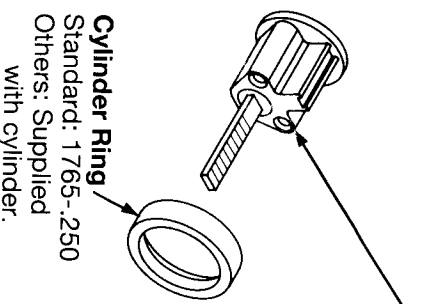

Cylinder Ring
Standard: 1765-.250
Others: Supplied with cylinder.

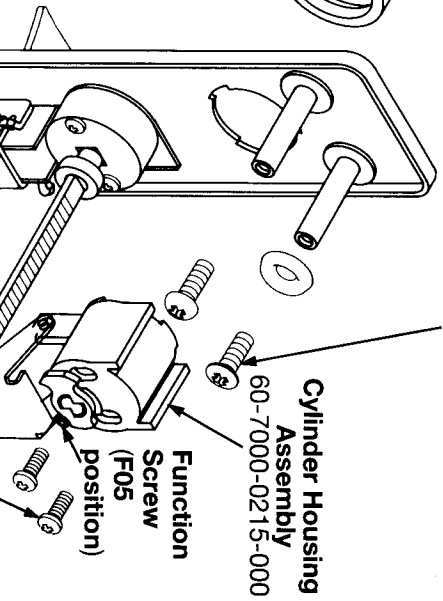

2 STUDS AWAY FROM LOCK EDGE*
1/4-20 Oval Head Machine Screws
Standard: 81-0013-0670-036
Others: As ordered.

Cylinder Housing Assembly
60-7000-0215-000

Function Screw (F05 position)

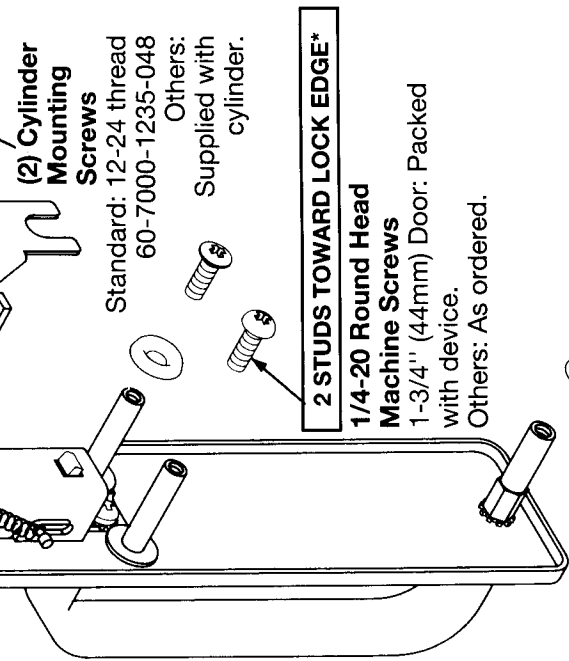

*Shown for LHR door.

CYLINDER APPLICATIONS		
YALE CYLINDER	CYLINDER RING	CYLINDER MOUNTING SCREWS
6-PIN, 1109 (STD.), 5109	1765-.250 (STD.)	60-7000-1235-048 (STD.)
7-PIN, 1109, 5109	1765-.406	34-2311-8738-048
6-PIN, 1709 (CMK)	1765-.656	10-1193-1018-048
7-PIN, 1709 (CMK)	1765-.750	60-7000-1235-048
6-PIN, 1193 (RC)	1765-.437	
7-PIN, 1193 (RC)	1765-.656	
6-PIN, U5109 (HS)	1766	
7-PIN, U5109 (HS)		