

Lock Body (cover removed) LHR Shown

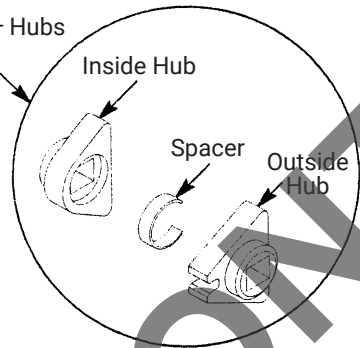

Position Hubs As Shown For RHR Operation



Right Hand Reverse:
Hinges on right, opens outward. For handed locks, Specify **RHR**.



Left Hand Reverse:
Hinges on left, opens outward. For handed locks, Specify **LHR**.



Right Hand:
Hinges on right, opens inward. For handed locks, Specify **RH**.



Left Hand:
Hinges on left, opens inward. For handed locks, Specify **LH**.

You have a RHR lockset. It will work on a RHR door as noted above.
If you have a different door installation, you will need to change the hand of your lock as follows:

To change from RHR to LHR

1. Remove cover from lock.
2. Turn latchbolt over (180° degrees).
3. Turn both hubs over together (180° degrees).
4. Replace cover.

To change from RHR to LH

1. Remove cover from lock.
2. Turn both hubs over together (180° degrees).
3. Replace cover.

To change from RHR to RH

1. Remove cover from lock.
2. Turn latchbolt over (180° degrees).
3. Replace cover.

Disassembly

1. Remove three (3) cover screws.
2. Remove cover
3. Reverse components according to chart:

To Change Lockset Hand		Reverse Following As Required	
From	To	Hub	Latchbolt
LHR	RHR	X	X
LHR	RH	X	
LHR	LH		X

Reassembly

4. Replace cover and 3 cover screws.
5. Set lock bevel to match door bevel and tighten both base front screws.

NOTE : When replacing cover do not force down with screws, if cover is not fully seated check all interlocking components.

WARNING

This product can expose you to lead which is known to the state of California to cause cancer and birth defects or other reproductive harm. For more information go to www.P65warnings.ca.gov.

WARNING

Attention Installer: Any retrofit or other field modification to a fire rated opening can potentially impact the fire rating of the opening, and ASSA ABLOY makes no representations or warranties concerning what such impact may be in any specific situation. When retrofitting any portion of an existing fire-rated opening, or specifying and installing a new fire-rated opening, please consult with a code specialist or local code official (Authority Having Jurisdiction) to ensure compliance with all applicable codes and ratings.

Experience a safer and more open world

Copyright © 1984, 2024, ASSA ABLOY ACCENTRA™ Access and Egress Hardware Group, Inc. All rights reserved. Reproduction in whole or in part without the express written permission of ASSA ABLOY Access and Egress Hardware Group, Inc. is prohibited.

**8722 Mortise Lock
How To Change Hands
Installation Instructions**

1-855-557-5078, Ext. 2 www.accentra-assaabloy.com

**Template Number:
80-9086-0010-010**

Date: 04/24

Sheet: 1 of 1

ACCENTRA
ASSA ABLOY