

CA542F & CA544F

Trim

Installation Instructions

ACCENTRA

ASSA ABLOY

For use with all ASSA ABLOY ACCENTRA™
7100, 2100 and 1800 Series Exit Devices
(Wood and Metal Doors)

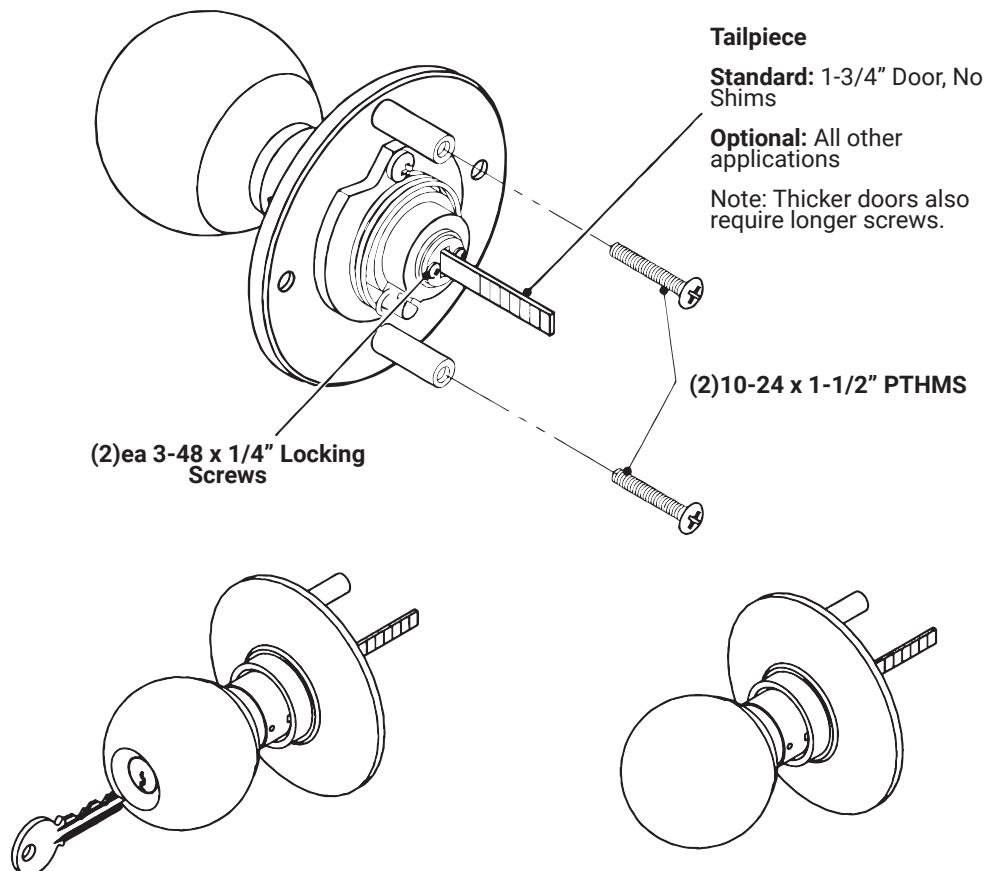

Tailpiece

Standard: 1-3/4" Door, No Shims

Optional: All other applications

Note: Thicker doors also require longer screws.

(2)ea 3-48 x 1/4" Locking Screws

(2)10-24 x 1-1/2" PTHMS

CA542F

F08: Key locks/unlocks knob. Key removable with door locked and unlocked.

To Lock Trim: Turn key clockwise 1/2 turn.

To Unlock Trim: Turn Key counterclockwise 1/4 turn. Return to key removal position and Lockwashers

CA544F

Passage function: Knob always active.

F02: (Not for fire exit) Pull door to pass, when device is dogged (field cut tailpiece off).

WARNING

This product can expose you to lead which is known to the state of California to cause cancer and birth defects or other reproductive harm. For more information go to www.P65warnings.ca.gov.

WARNING

Attention Installer: Any retrofit or other field modification to a fire rated opening can potentially impact the fire rating of the opening, and ASSA ABLOY makes no representations or warranties concerning what such impact may be in any specific situation. When retrofitting any portion of an existing fire-rated opening, or specifying and installing a new fire-rated opening, please consult with a code specialist or local code official (Authority Having Jurisdiction) to ensure compliance with all applicable codes and ratings.

1-855-557-5078 Ext. 2 • www.accentra-assaabloy.com

80-8470-0542-000 04/24

Installation Instruction

1. Check box contents. (See other side for box components and keying instructions).
2. Carry "Vertical Reference Centerline" to outside door face. Follow steps A and B, below.

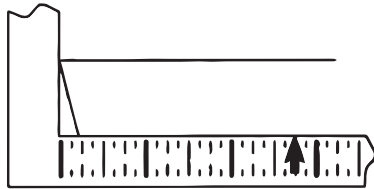

A. MEASURE INSIDE LINE LOCATION.

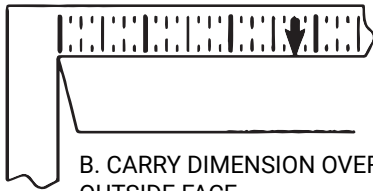

B. CARRY DIMENSION OVER TO OUTSIDE FACE.

3. Carry "Horizontal Reference Centerline" from inside to outside door face.

4. Align trim template and tape to door, outside face. CAUTION: Office copiers and facsimile machines may change the size of a drawing and make the template inaccurate to use as a door marker. If this is not the original template packed with the trim, use only the dimensions written on the template to locate the holes on the door (do not use the template as a door marker).
5. Spot holes and prepare door for trim.
6. Mount trim to door. Fasten finger tight with 2 #10-24 x 1-1/2 PTH machine screws supplied (See Figure 1).
7. With trim in place, cut trim tailpiece as shown in Figure 2.
8. Seat device so that trim tailpiece penetrates cam slot, as shown in Figure 1. Continue as shown in device instructions.

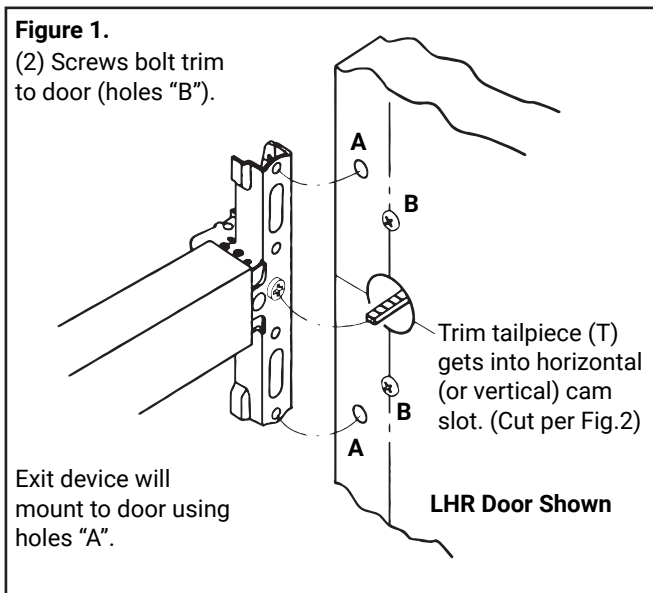

Trim for RHR or Lhr door, as packed.

STOCK DOORS:

Installation shows preparation for exit device trim. Stock door with ANSI/BHMA A156.115 preparation, for cylindrical lock with 2-3/4 (70) backset, may be used as substitute, when Trim is used with rim or SVR device.

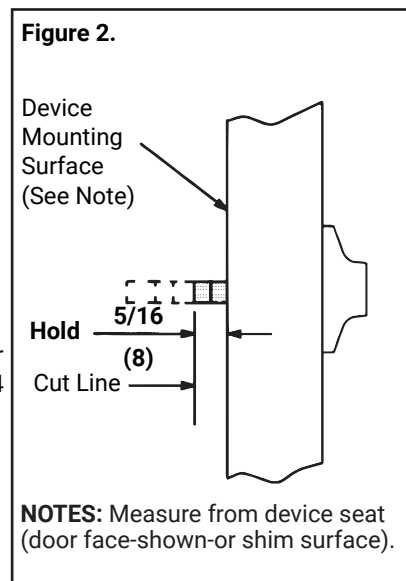

CA542F & CA544F

Trim Installation Instructions

ACCENTRA

ASSA ABLOY

DOOR
OUTSIDE FACE

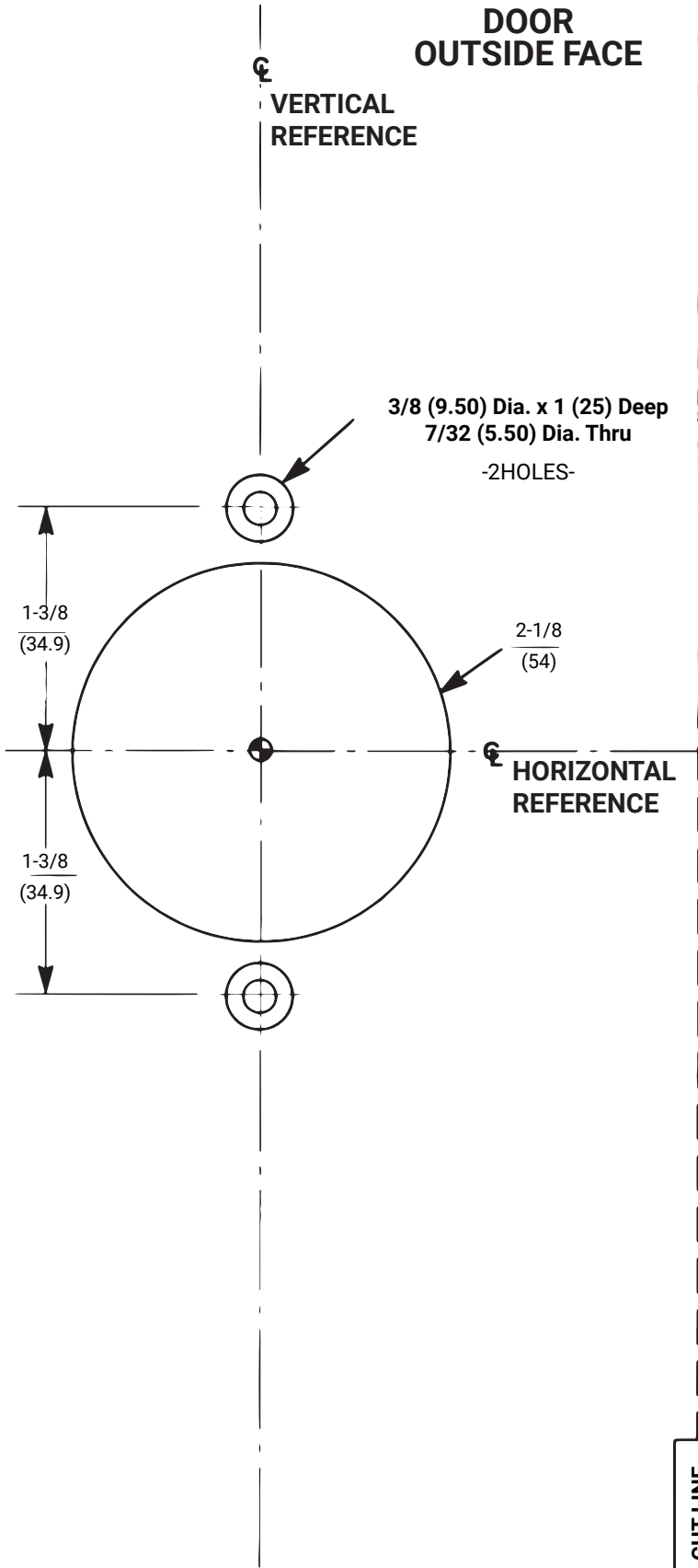

1-855-557-5078 Ext. 2 • www.accentra-assaabloy.com

Copyright © 2013, 2024, ASSA ABLOY ACCENTRA™ Access and Egress Hardware Group, Inc. All rights reserved. Reproduction in whole or in part without the express written permission of ASSA ABLOY Access and Egress Hardware Group, Inc. is prohibited.

80-8470-0542-000 04/24

Experience a safer
and more open world

Cylinders

Each CA542F Standard Trim is supplied with one ASSA ABLOY ACCENTRA™ 1801 6-pin random keyed cylinder and (2) R bow keys. This knob can also fit any ASSA ABLOY ACCENTRA™ 5801 6-pin High Security cylinder. For using ASSA ABLOY ACCENTRA™ 1801A or 5801A 7-pin cylinders, a trim with CA 7-pin knob is required. Removable core cylinders are not available with this trim. To rekey or exchange any of these cylinders, follow steps A, B and C shown below.

A. Knob Handle Removal

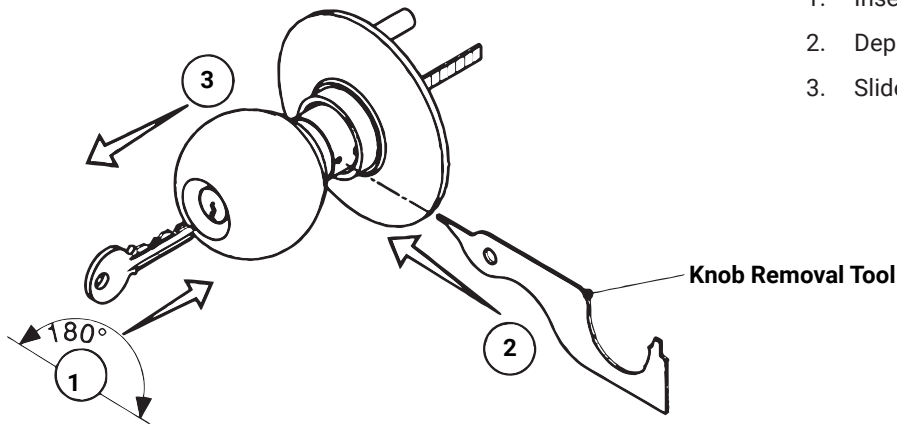

1. Insert Key & rotate clockwise 180°.
2. Depress retainer with tool supplied.
3. Slide knob off trim.

B. Cylinder Removal/Exchange

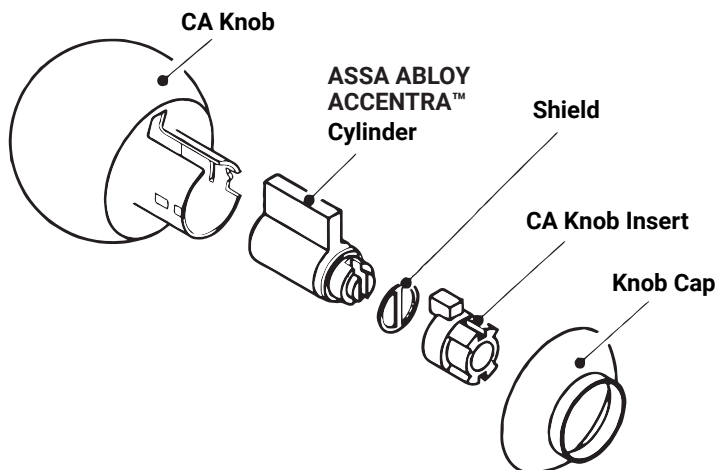

1. Tap Knob Shank against hard surface, to loosen Knob Cap.
 2. Slide Knob Cap, Insert, Shield and Cylinder off.
- (Reverse steps to reassemble)

NOTE: Six pin cylinder components shown. Seven pin knob assembly uses different components, though appearance and assembly are similar.

C. Knob Assembly

1. Looking into the Spindle cavity, position Drive Bar correctly. See detail at right.
2. Insert Key into knob Cylinder. Rotate Key 180°.
3. Slide Knob onto Spindle (Retainer catch on same side as Knob Shank slot). Knob is in place when positive Retainer engagement is apparent.

