



ADDENDUM DL2700LD BATTERY CONNECTIONS

The inside lock housing cover, pictured below, has three connectors:

- Connect the battery pack plug to its mate located on the housing cover.
- Connect the other housing cover plug to its mate located inside the lock housing.
- Connect the Lightbar black plug on the housing cover shown below to its mate inside the lock housing ("two white wires" connected to "two white wires")

Note: The lock may beep upon supplying power, and the internal clock may need to be reset (if equipped).

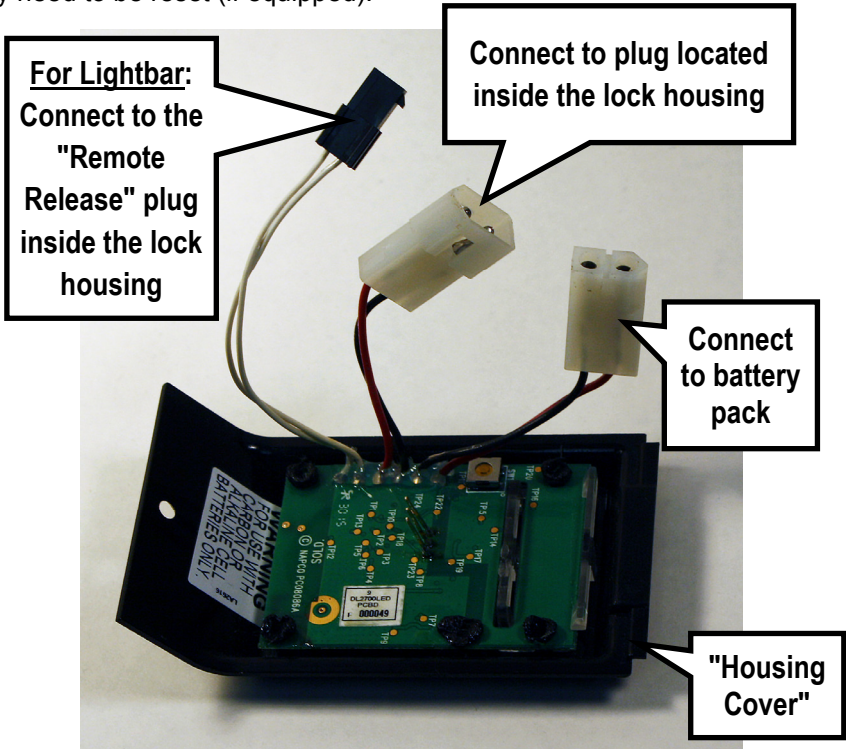

345 Bayview Avenue, Amityville, New York 11701
For Sales and Repairs 1-800-ALA-LOCK
For Technical Service 1-800-645-9440
or visit us at <http://tech.napcosecurity.com/>

(Note: Technical Service is for security professionals only)
Publicly traded on NASDAQ Symbol: NSSC