

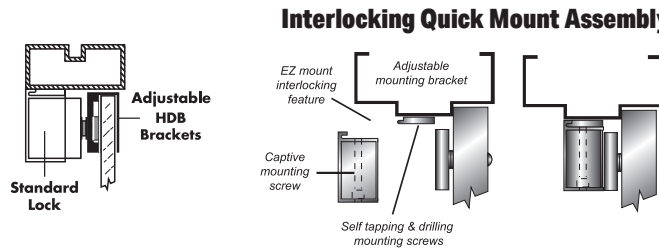
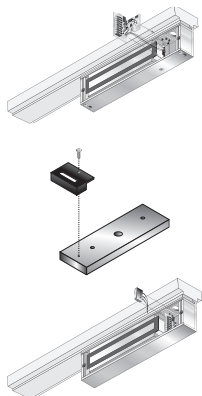

**SPECIFY GLASS DOOR MOUNTING KIT**          
Distributor Discount Code **GK** [List](#)

- Field adjustable for 1/2", 5/8" and 3/4" all glass Herculite doors

**Kits for 1511, 1571, 1581****HDB1** Single **200.00****Kits for 1512, 1572, 1582****HDB2** Double, 2 single kits **400.00**[Add to List](#)**Anodized Finishes****V** 628 Aluminum (std) **N/C****Y** Black Anodized**Single Double****89.00 177.00****Powder Coat Finishes** (a coating electrostatically applied to form a hard finish, that is tougher than conventional paint)**X** Dark Bronze Powder Coat Painted **C** Brass Powder Coat Painted**89.00 177.00****Plated Finishes - Special order, no cancellation, no returns****P** 625 Bright Chrome**Q** 626 Dull Chrome**112.00 222.00****Vertical Housing EMLock****GK LIST****Vertical Housings** - Side jamb mount, provides 2,400 or 3,300 lbs. of holding force.**1572VV82** Vertical Housing for 1572 EMLock, 82" length, for 84" opening - INCLUDES EMLock **1,662.00****1512VV82** Vertical Housing for 1512 EMLock, 82" length, for 84" opening - INCLUDES EMLock **1,722.00**

Custom Length (1512 or 1572)

[Add to List](#)**CV** Custom length - any length OVER 82". Specify exact length**1,248.00****Field Installed Modular Upgrade Kits**

Ordered separately for field upgrade without removing the lock from the frame

**EZ-T-10** Adjustable Timer Input Module: Specify (1) for single or double EmLocks® (not available with 1580 series) **72.00****EZ-A** Anti-Tamper Switch Module: Indicates cover plate removal. **56.00****EZ-D-10** 1510, 1570 Door Position Sensor Module: Specify (2) for double EMLocks® **45.00****EZ-D-80** 1580 Door Position Sensor Module: Specify (2) for double EmLocks® **45.00****Reusable Heavy Duty Drill Fixture**Distributor Discount Code **G LIST****1511-DF** Heavy duty drill fixture for 1571 and 1511 **167.00****1581-DF** Heavy duty drill fixture for 1580 **167.00**