

BHL Freewheeling Trim Retrofit

For Trim purchased prior to August 2019

8200 Series

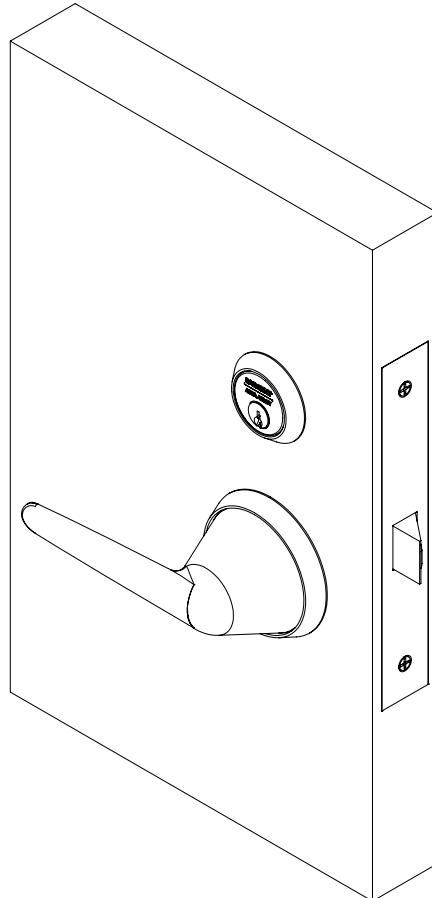

⚠ WARNING

This product can expose you to lead which is known to the state of California to cause cancer and birth defects or other reproductive harm. For more information go to www.P65warnings.ca.gov.

TOC	Table of Contents
1	Tools Required3
2	Package Contents3
3	Assembly.....3
a	Prepare Spring Cartridges3
b	Assemble Spring Cartridges into BHL Levers.....4
c	Rose Handing4
d	Assemble Outside Adapter Plate and Rose5
4	Installation5
a	Install Adapter Clutch.....5
b	Install Outside Lever Assembly.....5
c	Install Outside Trim6
d	Install Inside Adapter Plate Assembly6
e	Install Inside BHL Rose Assembly.....7
f	Install Inside Lever Assembly.....7

Attention Installer

Please read these instructions carefully to prevent missing important steps.

Notes

- Improper installation may result in damage to lock and void factory warranty.
- Other product brand names may be trademarks or registered trademarks of their respective owners and are mentioned for reference only.

1

Tools Required

- Phillips Screwdriver (# 2)
- Torx Tamper Resistant Driver (T-20)
- Torx Tamper Resistant Driver (T-10)
- Hex Key Driver 5/64"

2

Package Contents

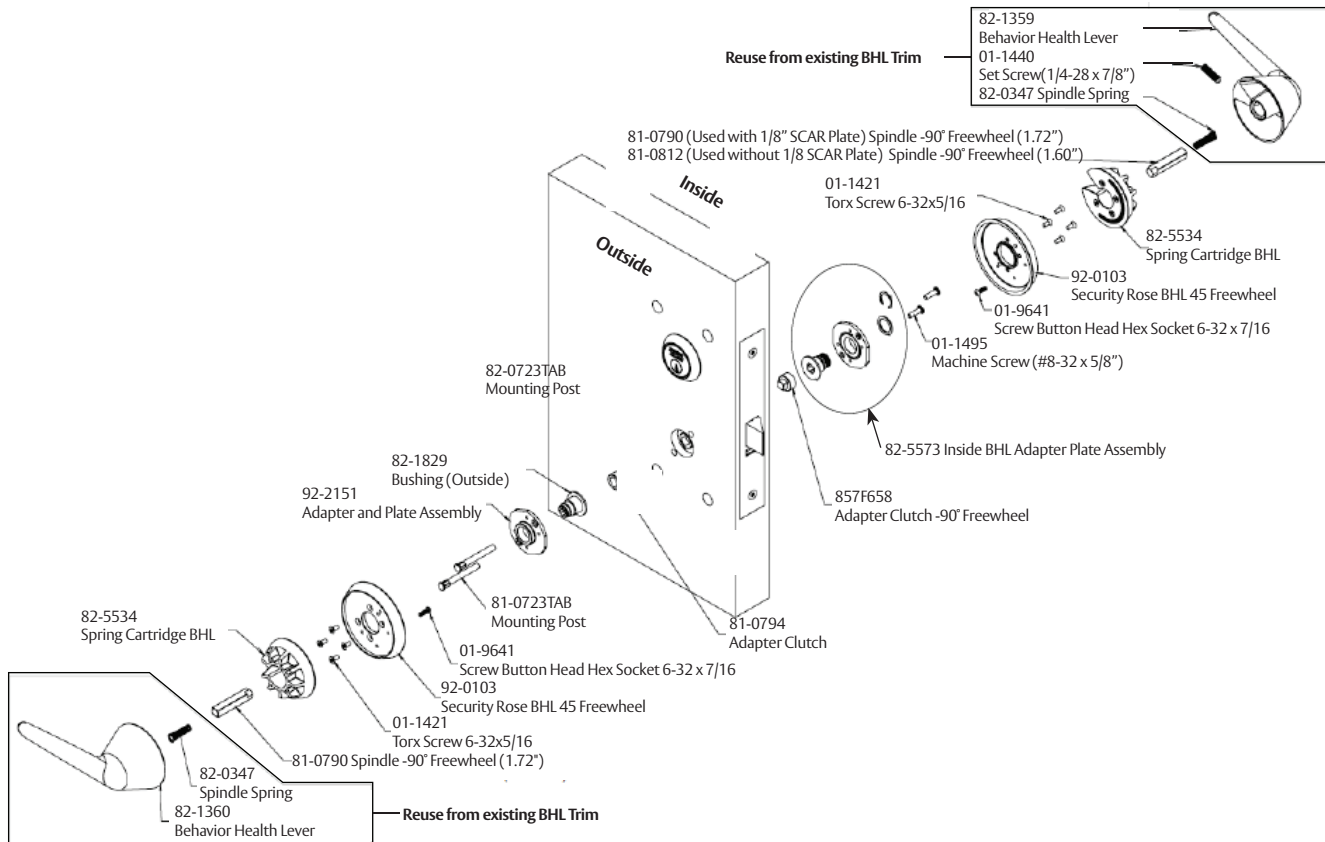

Figure 1

3

Assembly

a

Prepare Spring Cartridges

Remove clear adhesive tape liners from spring cartridges before use. (Figure 2)



Figure 2

3

Assembly (cont.)

b

Assemble Spring Cartridges into BHL Levers

Press spring cartridge assemblies into levers so that top of spring cartridge is flush or slightly below flush to lever's top surface. (Figure 3)

Note

Clean lever surface with rubbing alcohol prior to installing spring cartridge.

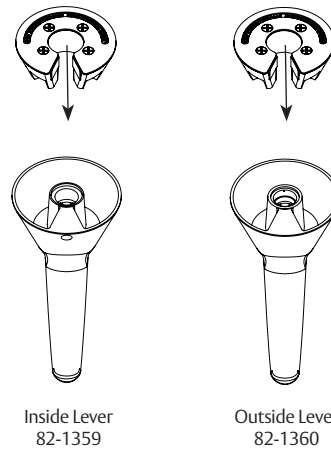

Finished Lever Assembly

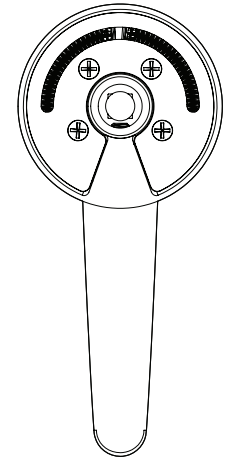

Figure 3

c

Rose Handing

- Review following figures that illustrate left and right roses. (Figure 4)

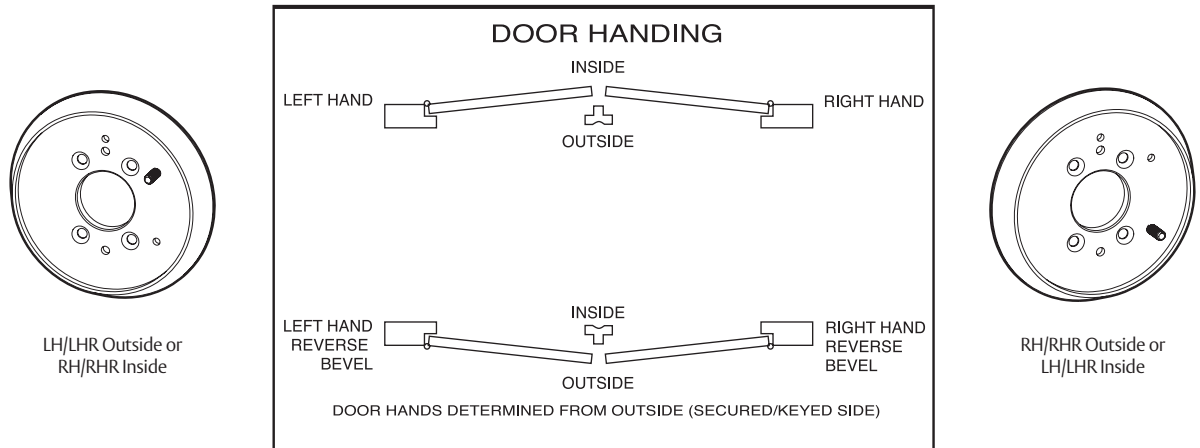

Figure 4

- Install button head screw into each rose. Use a 5/64" hex key to tighten screw firmly to rose. (Figure 5)

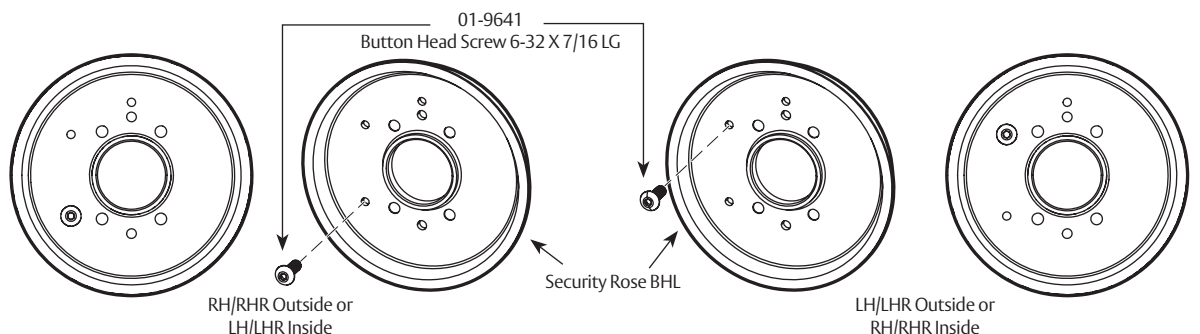

Figure 5

Installation Instructions

3

Assembly (cont.)

d

Assemble Outside Adapter Plate and Rose

- Insert two (2) mounting posts into adapter plate. (Figure 6)
- Install rose using four (4) security torx screws.

Note:

Tighten screws evenly.

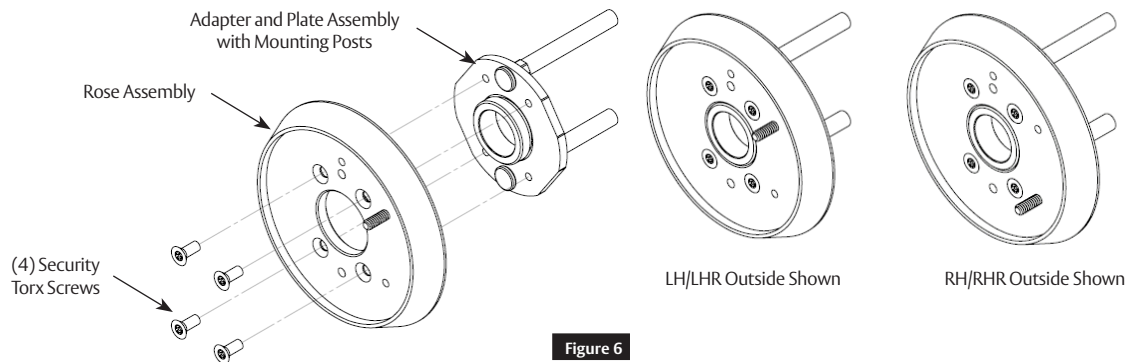

Figure 6

4

Installation

a

Install Adapter Clutch

Install adapter clutch into mortise lock hub. (Figure 7)

Note:

Adapter clutch is oriented toward latchbolt as shown.

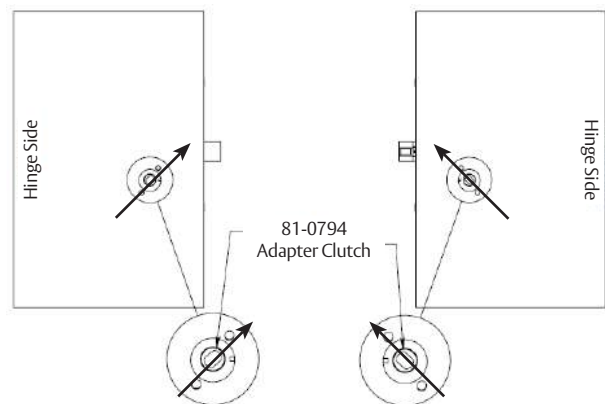

Figure 7

b

Install Outside Lever Assembly

Use outside bushing and spindle to connect rose/adapter plate assembly to outside lever assembly. (Figure 8)

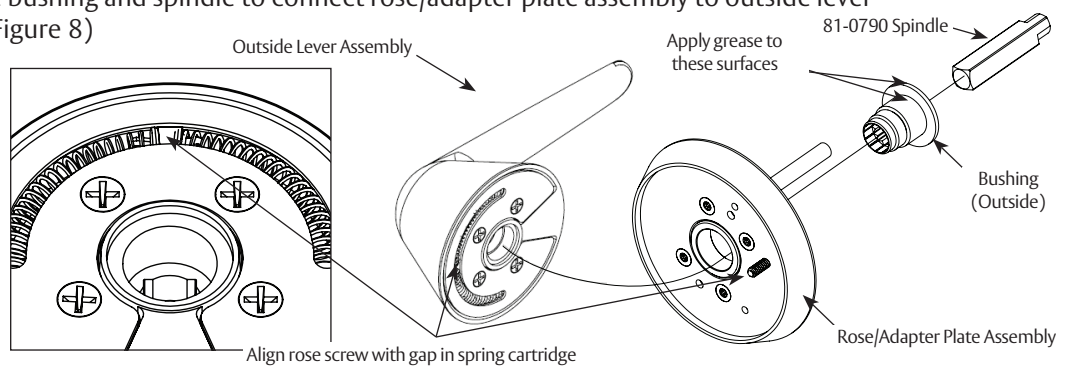

Figure 8

4

Installation (cont.)

b

Install Outside Lever Assembly (cont.)

- Insert spindle into bushing; ensure that spindle is inserted no more than $\frac{3}{4}$ " deep.
- Use spindle to rotate bushing clockwise into outside lever hole.
- Fully tighten bushing, then unthread bushing just enough to allow spindle to be inserted into lever, keeping bushing as tight as possible.
- Once assembled, spindle orientation should be as shown. (Figure 9)

Note:

Longer spindle used on outside

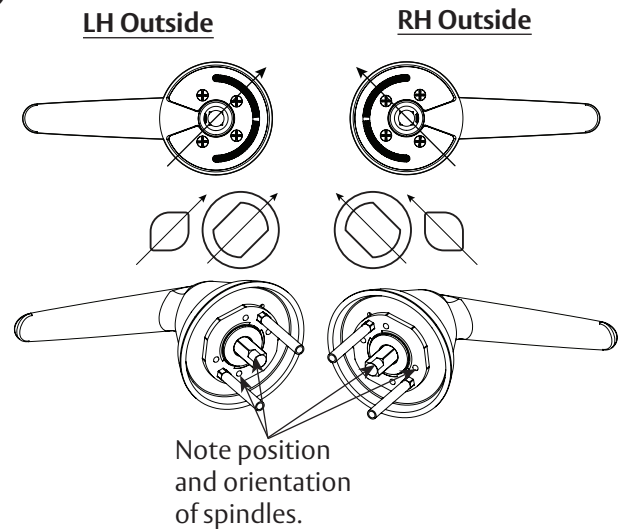

Figure 9

c

Install Outside Trim

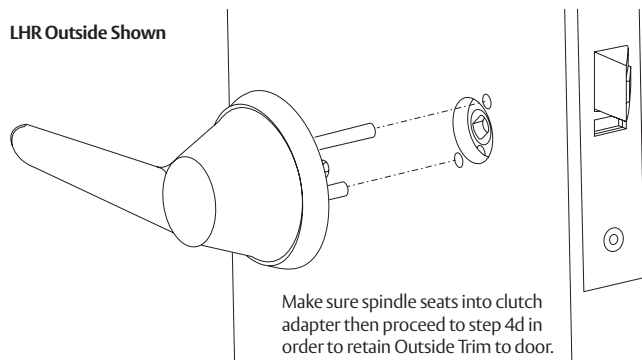

Figure 10

d

Install Inside Adapter Plate Assembly

Install inside adapter plate assembly using two (2) machine screws. (Figure 11)

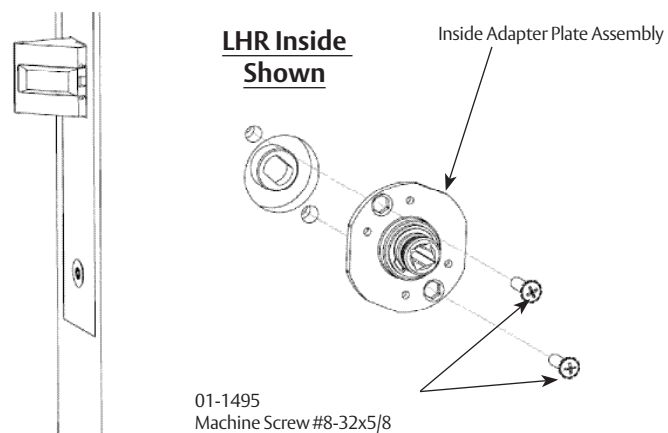

Figure 11

4

Installation (cont.)

e

Install Inside BHL Rose Assembly

Attach inside rose assembly to inside adapter plate using four (4) security Torx screws. Tighten screws evenly. (Figure 12)

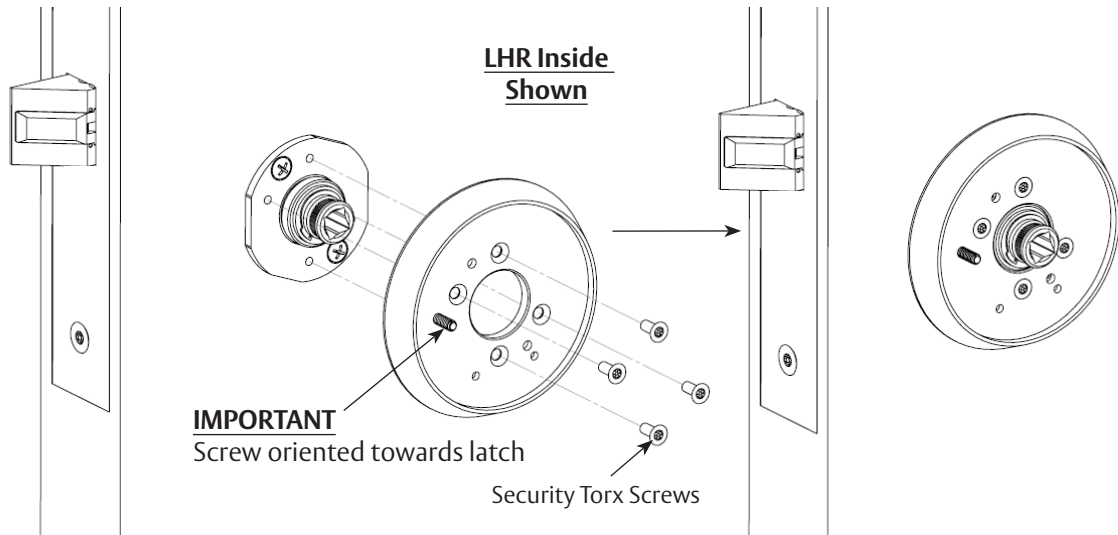

Figure 12

f

Install Inside Lever Assembly

- Install inside Spindle. (Figure 13)
- Install inside BHL lever assembly to inside adapter plate assembly using security torx set screw.

IMPORTANT

- Line up rose screw with gap on spring cartridge.
- Make sure machined end of spindle seats into clutch adapter before assembling lever onto rose. (Figure 13)

Note

- Inside of LHR shown.
- Shorter spindle used on inside.

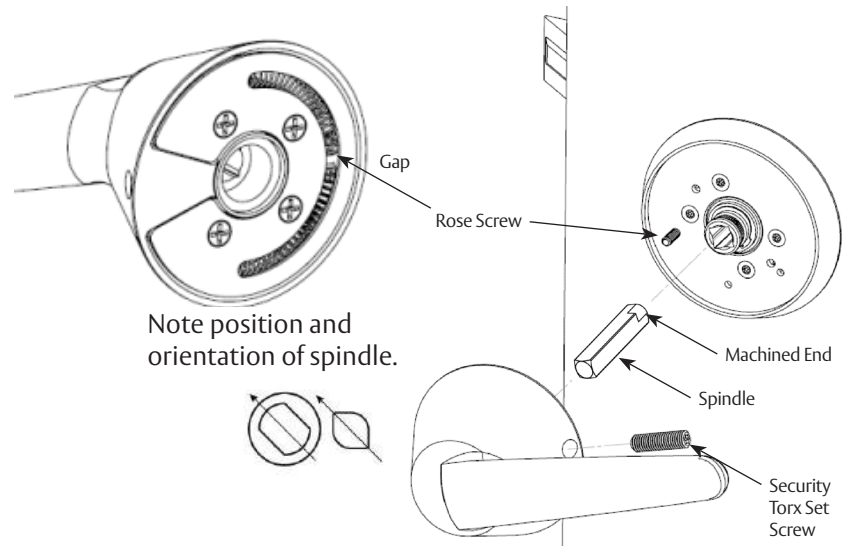

Figure 13

The ASSA ABLOY Group is the global leader in access solutions. Every day, we help billions of people experience a more open world.

ASSA ABLOY Opening Solutions leads the development within door openings and products for access solutions in homes, businesses and institutions. Our offering includes doors, frames, door and window hardware, locks, perimeter fencing, access control and service.

SARGENT
ASSA ABLOY

SARGENT Manufacturing Company
100 Sargent Drive
New Haven, CT 06511 USA
800-727-5477
www.sargentlock.com

Founded in the early 1800s, SARGENT® is a market leader in locksets, cylinders, door closers, exit devices, electro-mechanical products and access control systems for new construction, renovation, and replacement applications. The company's customer base includes commercial construction, institutional, and industrial markets.

Copyright © 2019, SARGENT Manufacturing Company. All rights reserved. Reproduction in whole or in part without the express written permission of SARGENT Manufacturing Company is prohibited.

A8259A
07/19