

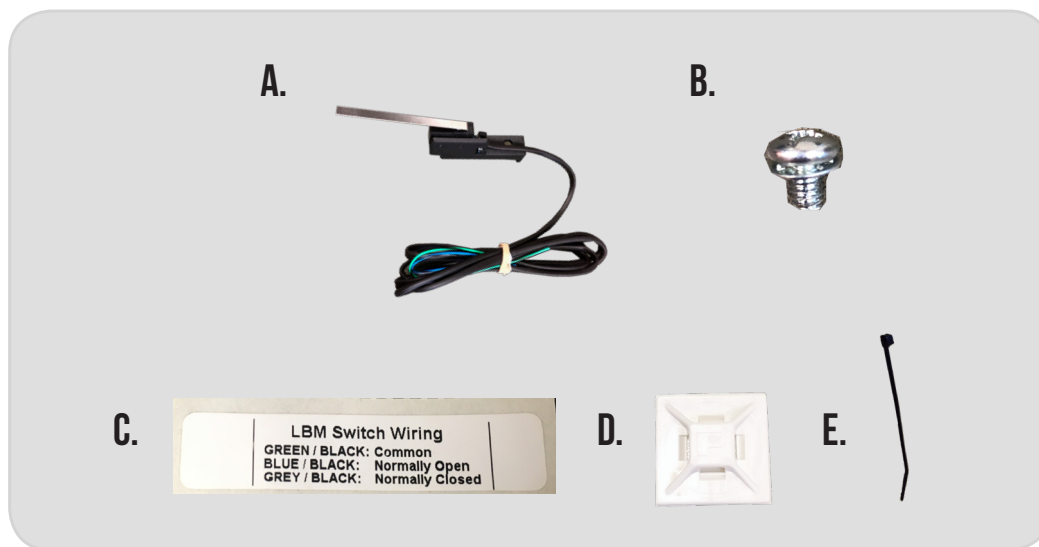

CALLBMKIT77-ED

INSERT INSTRUCTIONS

THE CALLBMKIT77-ED IS A FIELD INSTALLABLE LATCHBOLT MONITOR KIT FOR THE CAL ROYAL 7700 SERIES.



KIT INCLUDES

- A. LBM Switch
- B. Set of finished phillips screws
- C. LBM Label
- D. Wire holder
- E. 1- Push & go connector
- E. 1- Zip Tie

TOOLS REQUIRED

Cordless Drill or Phillips Screwdriver

SPECIFICATIONS

GREEN/BLACK-COMMON
 BLUE/BLACK-NORMALLY OPEN
 GRAY/BLACK-NORMALLY CLOSED
 .5A 24VAC/DC

INSTALLATION INSTRUCTIONS



1. REMOVE HEAD COVER



2. REMOVE PHILLIPS HEAD SCREW SECURING BASERAIL TO EXIT DEVICE HOUSING

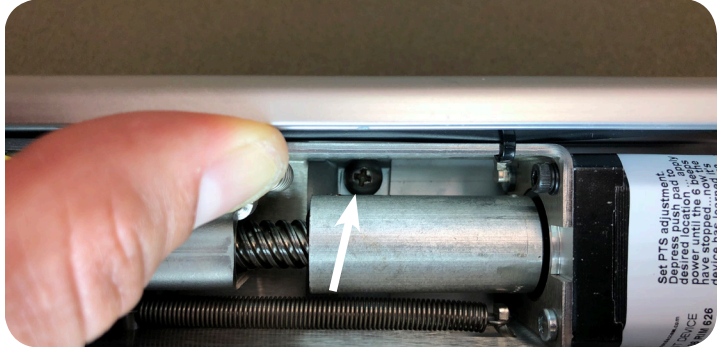

3. SLIDE OFF THE BASERAIL AND PUSH PAD HALF WAY TO REVEAL THE HEAD ASSEMBLY

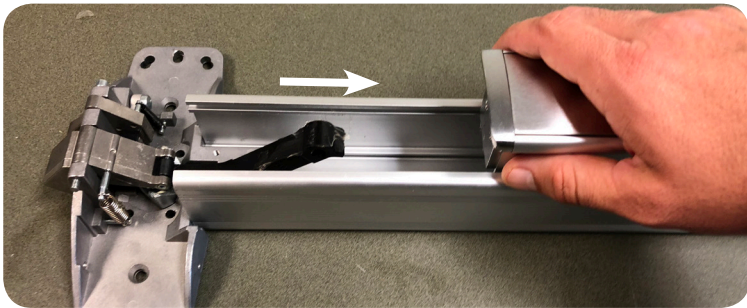

4. PUT THE SWITCH ON THE LEFT SIDE OF THE HEAD AND MAKE SURE THE SWITCH ARM IS UNDERNEATH THE PIN ATTACHED TO THE RIM LATCH

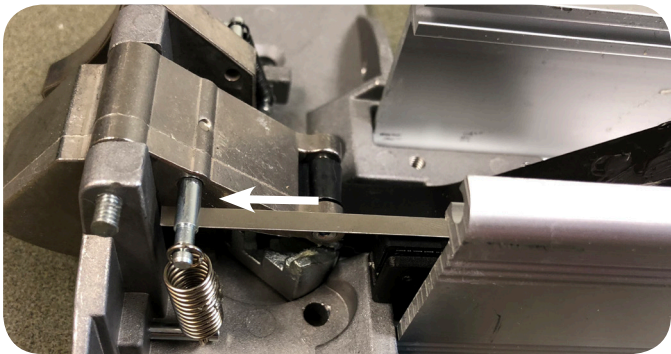

5. INSERT THE LBM SWITCH BY INSTALLING THE SCREW PROVIDED

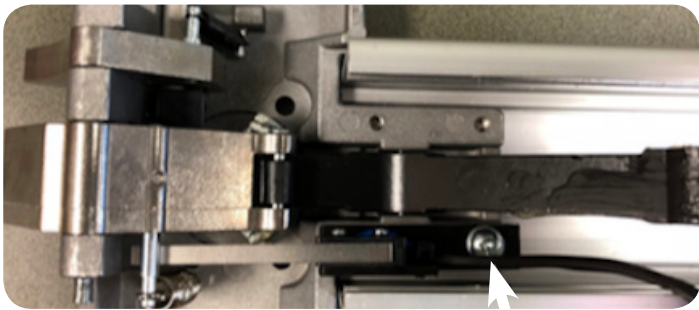

6. FISH THE LBM WIRES THROUGH THE BASERAIL TO THE BACK OF THE DEVICE AND SLIDE THE PUSH PAD BACK TO THE CORRECT POSITION.

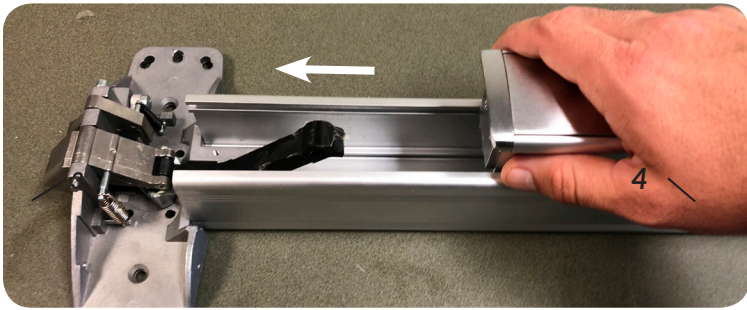

INSTALLATION INSTRUCTIONS



- 7. ONCE THE PUSH PAD IS IN THE CORRECT POSITION, REINSTALL THE SCREW TO SECURE IT TO THE EXIT DEVICE HOUSING**

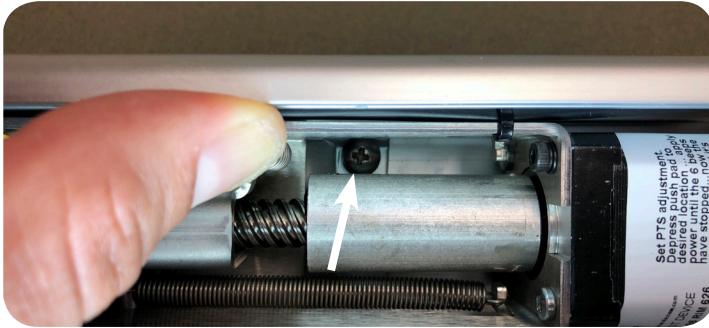

- 8. PULL THE SLACK OUT THE LBM WIRES AND APPLY STICKY PAD WITH ZIP TIE THE BACK OF THE DEVICE HOLDING THE WIRES SECURELY**

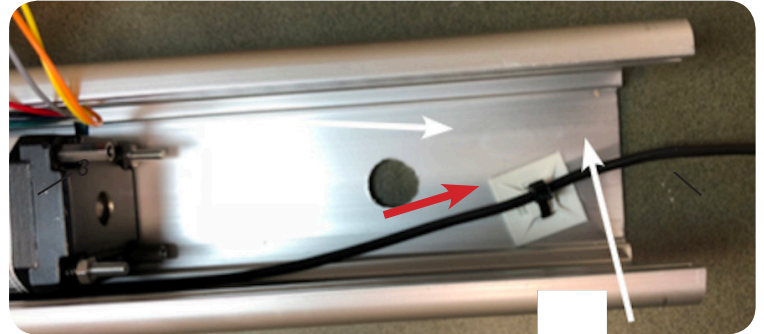

- 9. NOW WIRE UP YOUR LBM SWITCH AND DEPRESS THE PUSH PAD TO TEST!**