



PD27REXKIT-M-ED

INSERT INSTRUCTIONS

The PD27REXKIT-M-ED is a field-installable Request to Exit switch for:

- MLRK1-PD27
- MLRK1-PDQ63 (PDQ 6300/6400 series)
- PD27/PD27F Series Exit Devices
- PD29/PD29F Series Exit Devices

A.



B.



C.



D.



E.

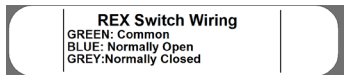

KIT INCLUDES

- A. 60811-R-S-A - (x1) REX Switch
- B. 40047 - (x2) Philips Head Screws
- C. 40054 - (x2) Plastic Washers
- D. 40060 - (x1) Zip Tie
- E. 20015 - (x1) REX Label

TOOLS REQUIRED

Phillips Screwdriver

SPECIFICATIONS

- Single Pole - Double Throw (SPDT)
- Rating: 2.0A @ 24VAC
- Configuration: Green - Common (C)
Blue - Normally Open (NO)
Gray - Normally Closed (NC)

REX INSTALLATION INSTRUCTIONS



1. Locate (2) **Pre Tapped Screw Holes** on **Motor Kit Assembly**.



2. Using (2) **Philips Screws** and (2) **Plastic Washers** provided, mount **Switch** to **Motor Assembly**, **Switch Arm** should be facing down and rest on the **Black Allen Screw**, wires will run to rear of **Motor**.

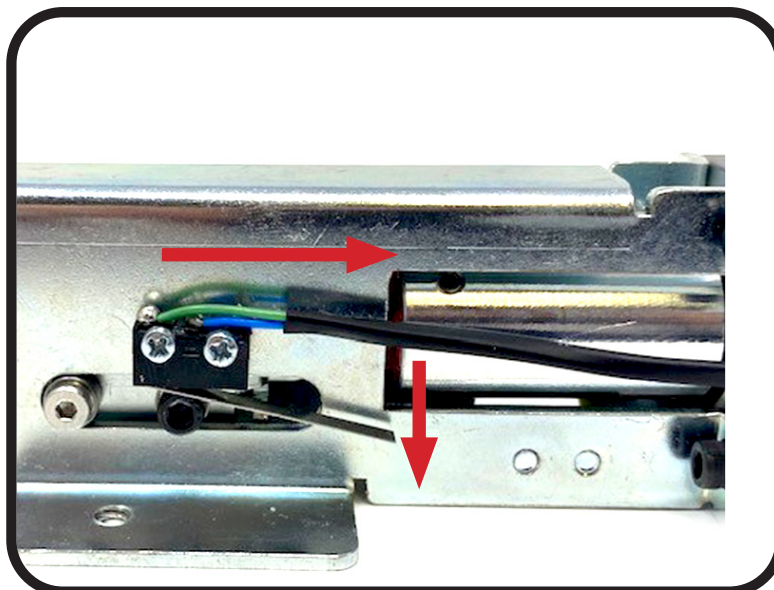

REX INSTALLATION INSTRUCTIONS



3. Ensure that **Switch** is triggering correctly by pulling and pushing on **Retraction Arm**.

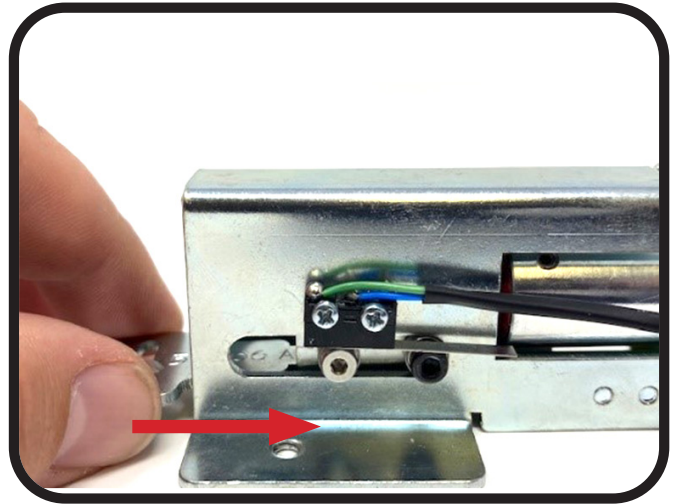
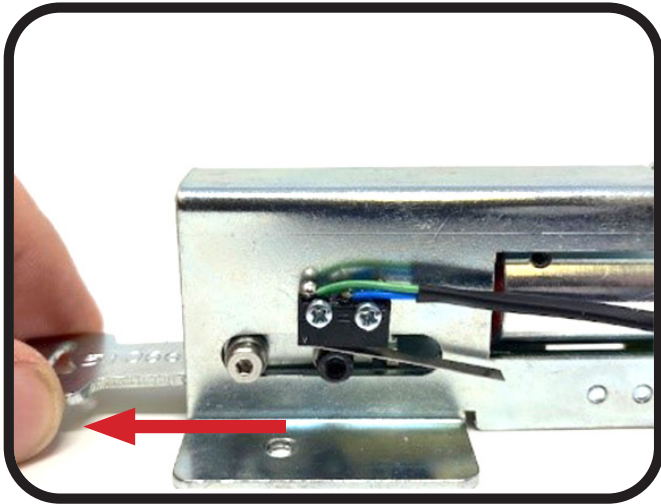

4. Run remaining wire towards rear of **Motor** using the **Zip Tie** provided, and connect wires to **Motor Post**.

