



INSTALLATION INSTRUCTIONS

Backset: 2³/₄" (69.9mm)

FOR 1¹/₄" (31.6mm), 1³/₈" (34.9mm), 1¹/₂" (38.1mm),
1³/₄" (44.5mm) DOORS

NOTICE: For proper installation and operation, doors and frames should be adequately reinforced.

1 Prepare Door . . .

MARK CENTERS OF 1" (25.4mm) HOLE AND FRONT PLATE MTG. HOLES

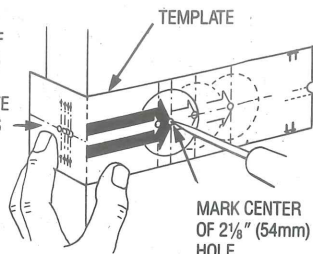

A Mark centerline at proper height on face and across edge of door. Fold template over high side of door edge at desired height. Using punch or nail, mark center of 2¹/₈" (54mm) hole on door face. Mark center of 1" (25.4mm) hole and front plate mounting holes (2) on door edge.

FRONT PLATE HOLE CENTERS

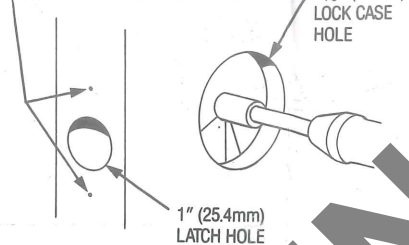

B Bore lock case hole from one side of door until point of bit emerges, and complete from opposite side to avoid splintering. Drill latch hole through into lock case hole.

FRONT PLATE SCRIBE OUTLINE

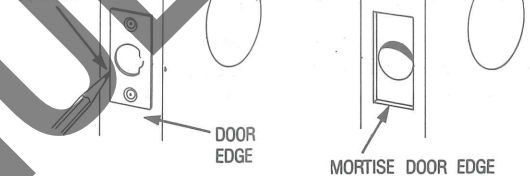

C Place front plate on door edge, align with mounting hole centers and scribe outline of plate on door. Mortise ⁵/₃₂" (4mm) deep for front plate.

2 Install Latch . . .

Insert latch in door.

For 3³/₄" (95.3mm) or 5" (127mm) backset latch extension: Engage latch and extension, and assemble with tube before installing latch.

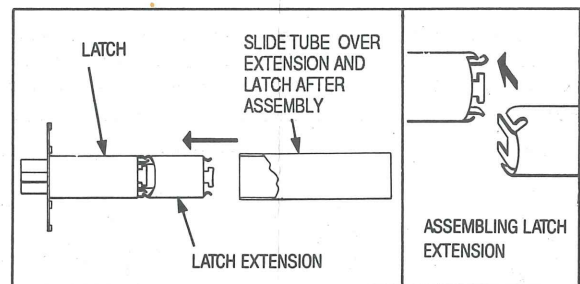
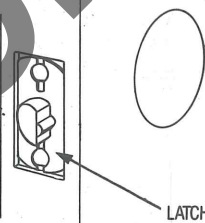

3 Remove Inside Knob . . .

Using tool supplied, depress knob retainer and remove knob, inside rose and mounting plate. Depress retaining spring and remove inside rose from mounting plate.

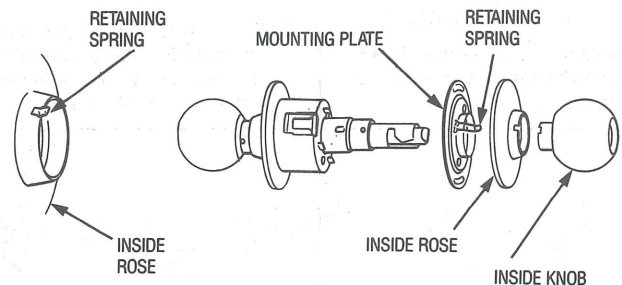
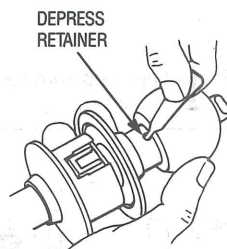

4 Adjust Lockset for Door Thickness . . .

Rotate outside rose to obtain proper distance to center of latch retractor slot, as measured with end of template.

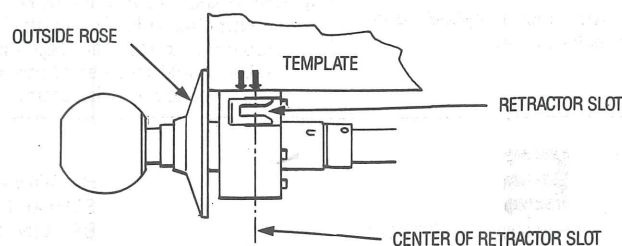

5 Install Lock and Front Plate . . .

A Insert lock in lockcase hole from outside of door, **engaging retractor with latch bolt tail** as shown. Assemble mounting plate to lockcase with two flat head machine screws. Using outside knob, check for free bolt action, and then tighten screws securely.

B Install front plate with two combination screws.

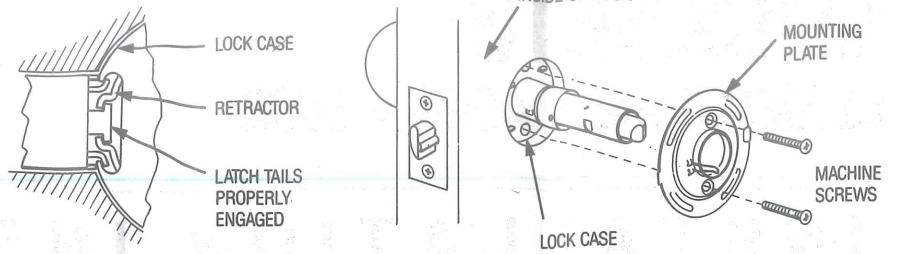

6 Install Inside Rose . . .

Align with lug and retaining spring on mounting plate, and snap into place.

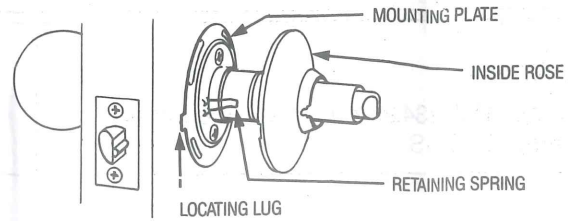

7 Assemble Inside Knob . . .

Align detent in knob shank with slot in spindle and slide knob on until retainer snaps into place. Pull on knob to make sure it will not pull off.

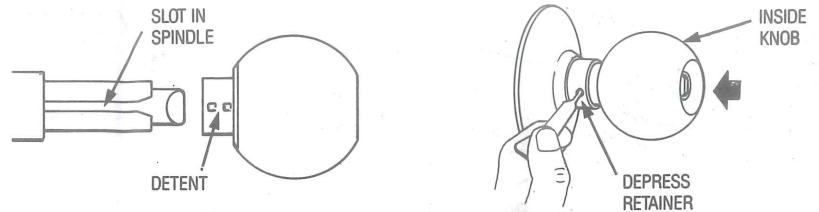

8 Install Strike Plate . . .

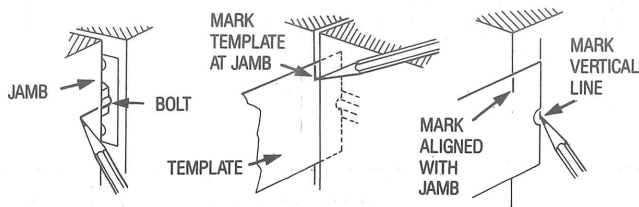

A Close door until latch bolt is depressed by jamb and mark jamb at bolt center. Hold notched end of template against bolt, close door and mark template at jamb edge. Mark vertical line on jamb.

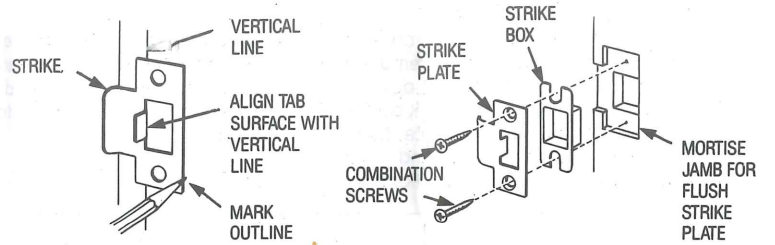

B *Locate strike plate on vertical and bolt center lines and mark outline of plate on jamb. Mortise jamb for strike box (if furnished) and strike plate. Install strike with two flat-head, combination screws and tighten securely.

Proper Hand of Lock

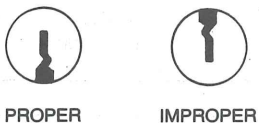

KEY SLOT POSITIONS

Key slot should always be positioned so that key inserts "cut-side-up"

To Change Hand of Lock . . .

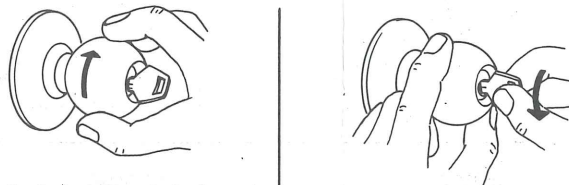

1 Fully insert key, unlock and turn outside knob approx. 45° to the right to align retainer with hole in knob shank.

2 Holding knob, turn key approx. 45° to the left.

To Re-key Lock . . .

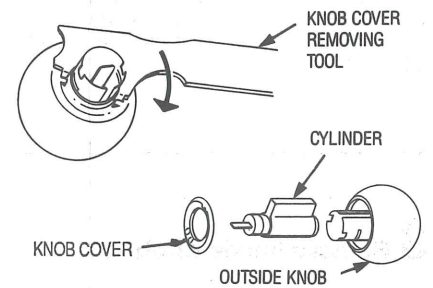

- 1 Remove outside knob as in steps 1 through "3" in "To Change Hand . . ."
- 2 Using knob cover removing tool (if furnished) or similar tool, loosen knob cover and slide cover and cylinder out of knob.
- 3 After re-keying, slide cylinder back into knob. Align tab on cover with slot in knob shank, and slide cover onto knob. Tighten cover with knob tool.
- 4 Reassemble knob on spindle as in step 4 in "To Change Hand . . .", with key slot in proper position.

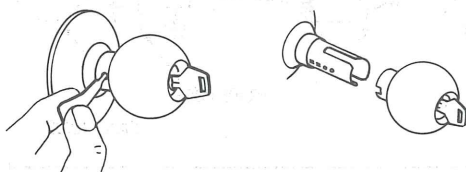

3 Depress retainer with tool supplied, and remove knob (with lock cylinder).

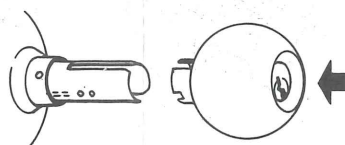

4 Rotate knob 180° to invert key slot. Align cylinder pin chamber in knob with slot in spindle and slide knob on up to retainer. Depress retainer and slide knob on until retainer snaps into place. Pull on knob to make sure it is secure.

*Note: Mounting holes in strike and front plate must be aligned.



HARDWARE GROUP

HARDWARE DIVISION
EMHART HARDWARE GROUP
BERLIN, CT 06037 U.S.A.

EMHART

FORM NO. FM86