

# Installation Instructions

## Ref. 43/47/37 Rev. A (5/98)

### Grade 2 key-in-Lever/knob

**IMPORTANT:** The accuracy of the door preparation is critical for the proper functioning and security of this lock. Misalignment can cause premature wear and tear and a lessening of security.

Lock & Cylinder Installation is critical (section 7 & 8) if installation instructions are not followed this may result in damage to the lock and void the factory warranty.

#### 1. Mark door.

Mark horizontal line across edge of door. 38" (965mm) is the usual height above the floor. Fold template over edge of door, centering on horizontal line. Mark centers of holes at proper backset.

**Note:** Be sure to verify backset before marking & drilling door.

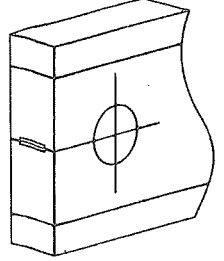

#### 2. Drill door.

**A.** 2-1/8" (54mm) hole thru door. Cut notches as shown on template. See Note.

**Note:** Dummy trim requires 1/4" (6.4mm) hole on center line only.

**B.** Drill 1" (25mm) hole in edge of door. Cut out for latch front 5/32" (4mm) deep. 1-1/8" (29mm) wide or 1" (25mm) wide x 2-1/4" (57mm) high. Check latch unit for proper width front.

**Note:** To avoid splintering wood doors, drill holes from both sides

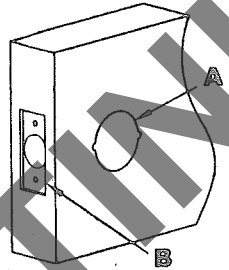

#### 3. Install fire cup.

**A.** Insert cup with large open end toward outside of door.

**Note:** Failure to use the fire cup, and UL marked latch will invalidate UL Listing.

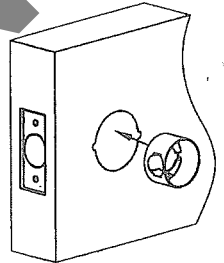

#### 4. Install latch unit.

Insert latch unit in door. (Be sure bevel edge of bolt faces strike plate). Attach with two screws supplied.

**Note:** Preprepped door with 1" hole requires latch sleeve.

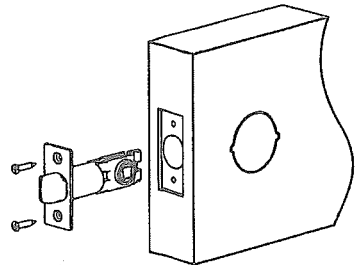

#### 5. Install strike.

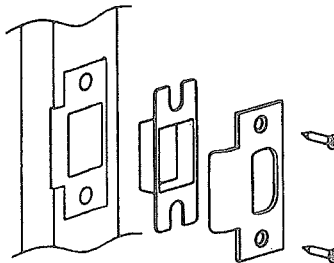

## 6. Disassemble lock.

- A. Remove inside lever or knob and rose (depress the retainer button on the neck of the inside assembly with screwdriver.)
- B. Pull knob or lever away from inside rose support.

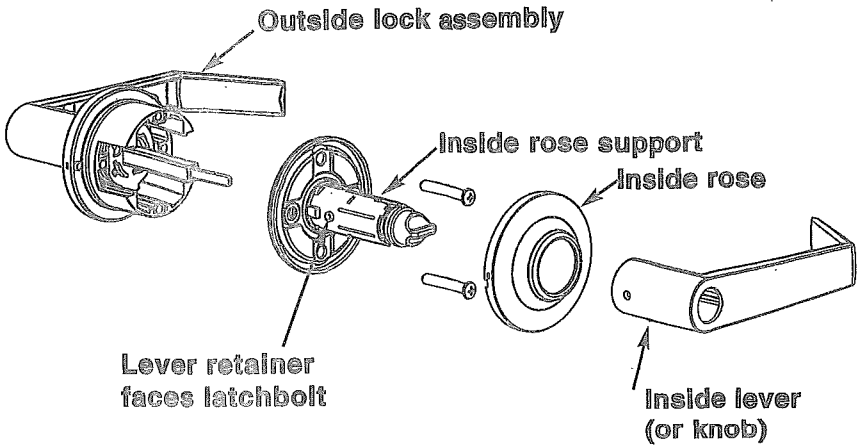

## 7. Install outside knob or lever.

- A. Insert outside knob or lever with square spindle into latch

**Warning:** locking bar shaft must be in horizontal position as in drawing.

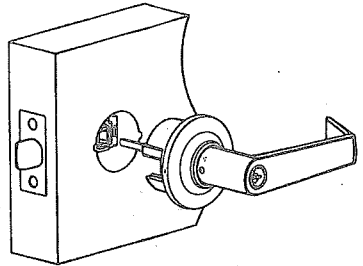

## 8. Installation of cylinder.

- A. Depress retainer button in outside lever and remove lever. If cylinder is already installed it must be unlocked to depress retainer button (insert key and rotate 90 degrees to unlock).
- B. For knobs only slip collar onto shaft and align small hole with retainer button.
- C. Insert cylinder into outside lever or knob shaft. For storeroom function first rotate key 90°.
- D. Slip knob or lever onto shaft and align small hole with retainer button. Depress retainer button and push knob or lever into position.

## 9. Install inside assembly.

- A. Slip inside assembly over locking bar (turn button must be in vertical position).
- B. Insert screws through inside mounting plate and tighten evenly until secure.  
**Note:** Retainer pin and lever must be located toward the jamb of the door.
- C. Slip knob or lever onto shaft aligning small hole with retainer button. Depress retainer button and push knob or lever into position.

### Notes:

#### Storeroom Function

- \* Latchbolt operated by inside lever, key in outside lever.
- \* Outside lever always locked. Rotate key 90° clockwise to unlock lever. Lever retracts latchbolt, rotate key to relock.

#### Classroom Function

- \* Either lever operates latchbolt (except when outside lever is locked by key).
- \* Rotate key 360° counterclockwise to unlock lever. Rotate 360° to relock lever.
- \* Inside lever always active.