

# DC5200 Cam Action Door Closer

The DC5200 is designed to make doors easy to open while maintaining enough force to close doors securely. The single closer and track assembly can support up to four mounting positions and has a unique adjustable arm to simplify installation.



Experience a safer  
and more open world



Ideal for applications where both security and accessibility are a priority.

## ADDITIONAL FEATURES

- Adjustable spring size 1 through 6
- Door weight: 250 lbs.
- Non-handed
- Cast aluminum body
- Forward facing valves
- 30-year warranty



Corbin Russwin DC5200



### Security

The DC5200 provides reliable closing where safety is a priority, without sacrificing convenience.



### Accessibility

Comfortable opening eases everyone's passage through frequently-used doors.

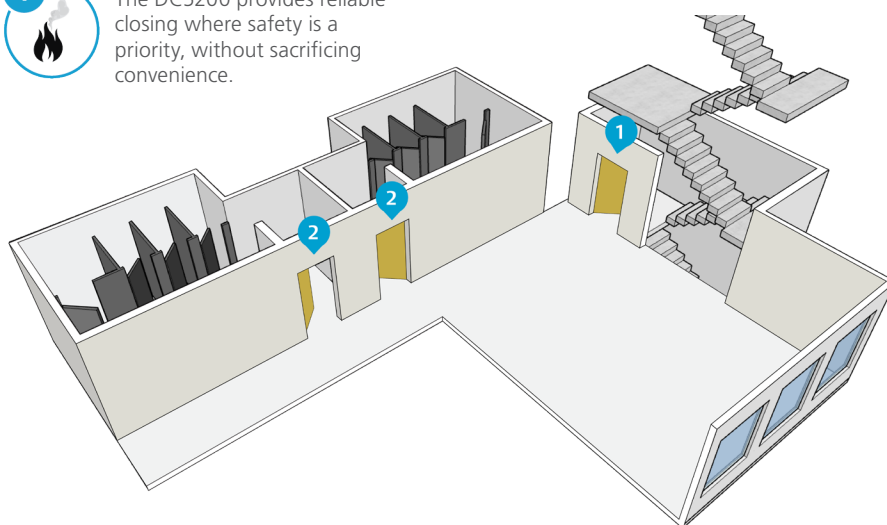

Corbin Russwin  
225 Episcopal Road, Berlin, CT 06037  
Phone 800-543-3658  
Fax 800-447-6714  
[www.corbinrusswin.com](http://www.corbinrusswin.com)

ASSA ABLOY Door Security Solutions Canada  
160 Four Valley Drive, Vaughan, Ontario, Canada L4K 4T9  
Phone: 800-461-3007  
Fax: 800-461-8989  
[www.assaabloydss.ca](http://www.assaabloydss.ca)

The ASSA ABLOY Group is the global leader in access solutions. Every day we help people feel safe, secure and experience a more open world.