

Wood Door and Frame Preparation

1 Mark Door and Frame

- Using a square, draw a horizontal line on edge and inside surface of the door at the desired height above floor. 46" is recommended. Also mark door frame at this same height.
- Using installation template, mark location of cross bore at proper backset. Mark edge of door for edge bore at proper centerline location. (See Figure 1.)

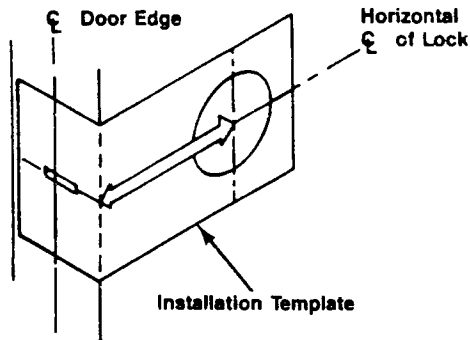

Figure 1

- To determine location of vertical centerline of strike, take half of door thickness (measured from door stop or silencer). Using strike as template, mark outline. Mark location of two attaching screws. (See Figure 2.)

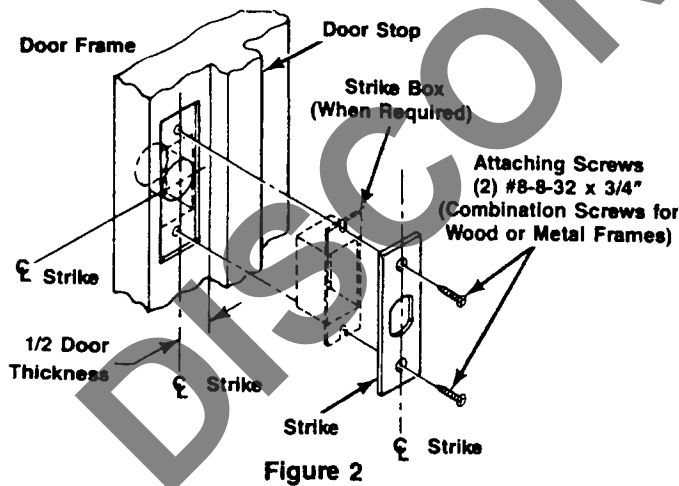

Figure 2

2 Mortise and Drill Door and Frame.

- Drill holes as directed on installation template. Drill cross bore first, (drill from both sides of door to avoid splintering the wood.) Drill edge bore 3-3/4" deep for deadbolt tail clearance.
- Insert deadbolt unit into hole in edge of door. Using the front trim as a template, mark outline. Mark location of two attaching screws. Remove deadbolt.
- Drill pilot holes for two attaching screws, then mortise door edge 5/32" deep for front trim. (See Figure 3.)

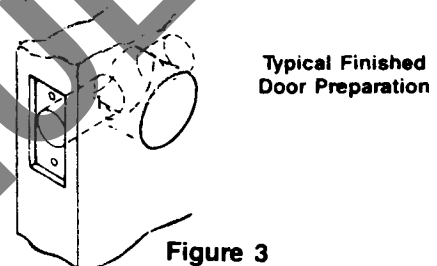

Figure 3

- For strike, drill 1" diameter hole x 1" deep at center point of strike. Drill pilot holes for attaching screws. Mortise jamb for strike. (See Figure 4 for strike thickness. If strike box is supplied, mortise jamb to receive it.)

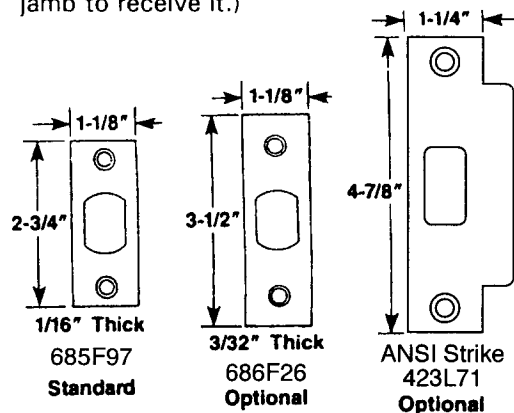

Figure 4

IMPORTANT: The accuracy of the door preparation is critical for the proper functioning of this cylindrical deadbolt lock. Misalignment can cause premature wear and a lessening of security.

Attention Installer

Installation of cylindrical deadbolts must be through Bolted in all doors. If installation instructions are not Followed, this may result in damage to the deadbolt And void the factory warranty.

**Corbin
Russwin**

In U.S.:
Corbin Russwin, Inc.
225 Episcopal Road, Berlin, CT 06037 USA
Phone: 860-225-7411 Fax: 860-828-7266

In Canada:
Yale-Corbin Canada LTD.
3160 Orlando Drive, Mississauga, Ontario, Canada L4V1R5
Phone: 905-672-6220 Fax: 905-672-9022

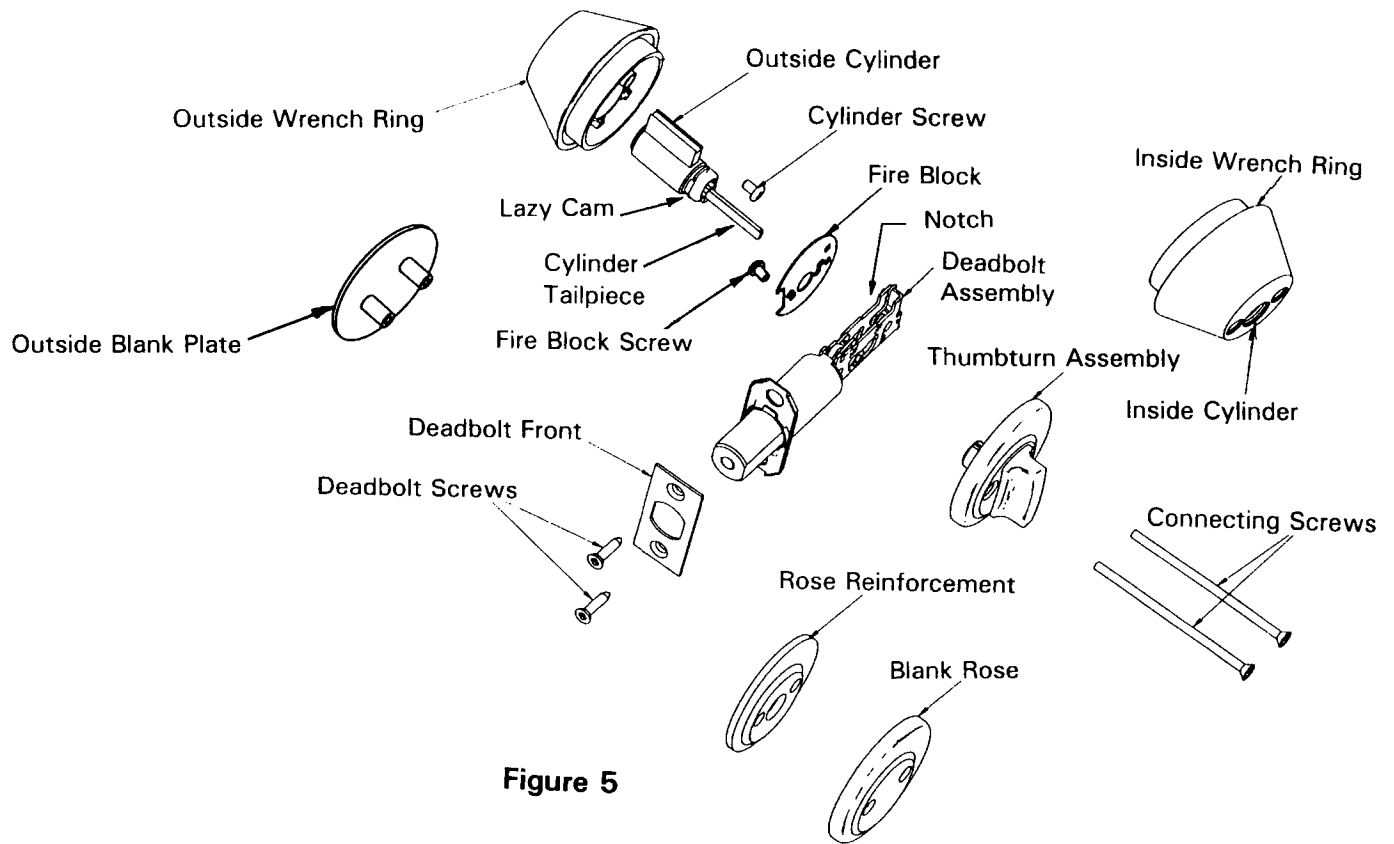

Figure 5

DL 2100 & DL 3100 SERIES

Deadbolt Installation

SEE REVERSE SIDE FOR DL 3100 IC CORE SERIES

1 INSTALL DEADBOLT

- a) Insert deadbolt unit into hole in door edge. (Make sure notched area is up. See Figure 5.) Fasten deadbolt to door with two attaching screws.
- b) For fire rated installations, remove screw from deadbolt tail and use to install Fire Block.
- c) **IMPORTANT:** Using screwdriver, rotate slot in hub to horizontal position to retract deadbolt.
- c) For outside cylinder function, go to next step. If outside blank plate is used, go to step 2b.

2 INSTALL CYLINDER(S). DO NOT insert keys in cylinder(s) at this time.

- a) Insert **OUTSIDE** cylinder into backside of the **OUTSIDE** Wrench Ring (No mounting holes in face) and secure with Cylinder Screw, if required. Holding the assembly horizontally ("Corbin" on wrench ring face is upright) rotate the cylinder tailpiece to the horizontal position. Insert outside assembly into door with cylinder tailpiece going through slot in hub of deadbolt tail.
- b) For installation of inside cylinder function, see step 2c; for inside thumbturn function, see step 2d; and for blank rose, see step 2e.

- c) Insert **INSIDE** cylinder into backside of the **INSIDE** Wrench Ring (Two mounting holes in face) and secure with Cylinder Screw, if required. Holding the assembly horizontally ("Corbin" on wrench ring face is upright) rotate lazy cam to the horizontal position. Align the lazy cam with the cylinder tailpiece from outside cylinder and slide assembly up to surface of door. Go to step 2e.

- d) Rotate thumbturn so that the word "LOCKED" is covered. Align slotted hole on back of thumbturn with cylinder tailpiece from outside cylinder. Slide assembly up to surface of door.

- e) Insert the two connecting screws through the inside wrench ring or rose, through the deadbolt tail and thread into the back of the outside wrench ring or plate. Tighten to provide a snug fit of both cylinder assemblies to the door.

- f) **IMPORTANT:** At this point operate deadbolt from both sides of door to check installation. **DO NOT FORCE.** If binding occurs, recheck the door preparation and complete installation procedure.

- g) When deadbolt operates smoothly, tighten both connecting screws securely.

3 INSTALL STRIKE

- a) Attach strike to jamb using two attaching screws.

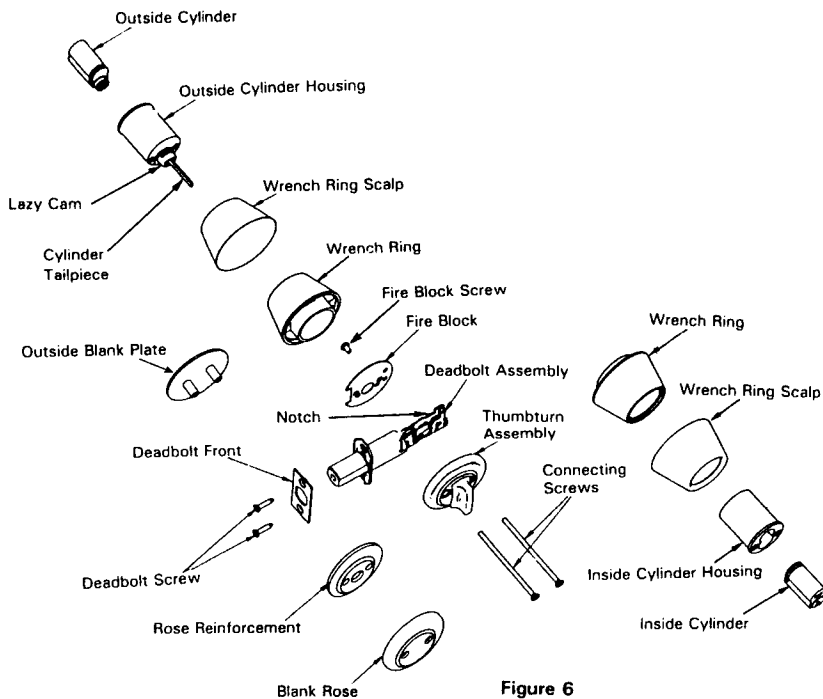
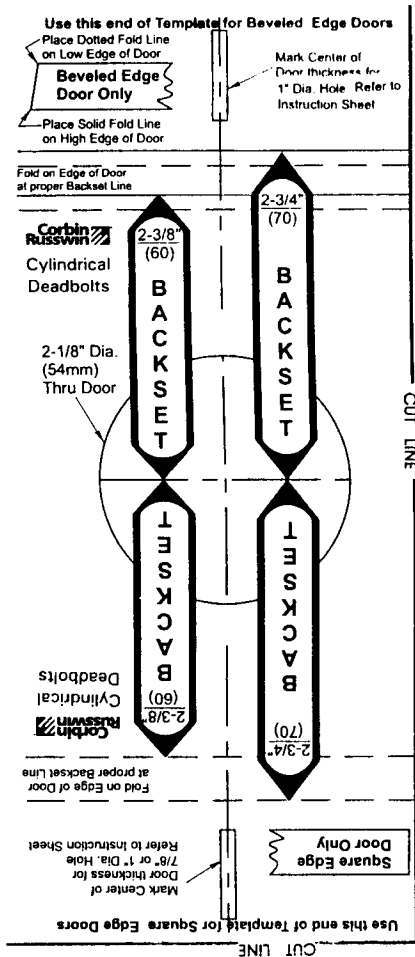

Figure 6

DL 3100 IC CORE SERIES Deadlock Installation

1 INSTALL DEADBOLT

- Insert deadbolt unit into hole in door edge. (Make sure notched area is up. See Figure 6) Fasten deadbolt to door with two attaching screws.
- For fire rated installations, remove screw from deadbolt tail and use to install Fire Block.
- IMPORTANT:** Using screwdriver, rotate slot in hub to horizontal position to retract deadbolt.
- For outside cylinder function, go to next step. If outside blank plate is used, go to step 2b.

2 INSTALL CYLINDER(S). DO NOT insert keys in cylinder(s) at this time.

- Insert **OUTSIDE** Cylinder Assembly (No mounting holes in face) into Wrench Ring and Scalp Assy. Holding the assembly horizontally (1/8" slot on wrench ring face is upright) rotate the cylinder tailpiece to the horizontal position. Insert outside assembly into door with the cylinder tailpiece going through slot in hub of deadbolt tail.
- For installation of inside cylinder function, see step 2c; for inside thumbturn function, see step 2d; and for blank rose, see step 2e.

- Insert **INSIDE** cylinder (Two mounting holes in face) into Wrench Ring and Scalp Assembly, if required. Holding the assembly horizontally (1/8" slot on wrench ring face is upright) rotate lazy cam to the horizontal position. Align the lazy cam with the cylinder tailpiece from outside cylinder and slide assembly up to surface of door. Go to step 2e.
- Rotate thumbturn so that the word "LOCKED" is covered. Align slotted hole on back of thumbturn with cylinder tailpiece from outside cylinder. Slide assembly up to surface of door.
- Insert the two connecting screws through the inside wrench ring or rose, through the deadbolt tail and thread into the back of the outside wrench ring or plate. Tighten to provide a snug fit of both cylinder assemblies to the door.
- IMPORTANT:** At this point operate deadbolt from both sides of door to check installation. **DO NOT FORCE.** If binding occurs, recheck the door preparation and complete installer procedure.
- When deadbolt operates smoothly, tighten both connecting screws securely.

3 INSTALL STRIKE

- Attach strike to jamb using two attaching screws.

TAILPIECE PART NUMBERS BY LENGTH

Part Number	Decimal	Fraction
686F208	1.340	1-11/32"
689F848	1.160	1-5/32"
689F858	1.410	1-13/32"
689F868	1.660	1-11/16"
689F878	1.022	1-1/32"
689F828	1.586	1-19/32"
689F888	0.785	25/32"
689F898	1.277	1-9/32"

TAILPIECE LENGTH APPLICATIONS CHART

List Numbers	1-3/8" Door	1-3/4" Door	2" Door	2-1/4" Door
DL 2113/DL 2117	1-11/32"	1-11/32"	1-11/16"	1-11/16"
DL 3113 C6/DL 3117 C6	N/A	1-11/32"	1-11/32"	1-11/16"
DL 2112	25/32"	1-5/32"	1-13/32"	1-11/16"
DL 3112 C6	N/A	25/32"	1-1/32"	1-9/32"
DL 2111	25/32"	1-5/32"	1-13/32"	1-11/16"
DL 3111 C6	N/A	1-5/32"	1-11/32"	1-11/32"
DL 2160	1-19/32"	1-19/32"	1-19/32"	1-19/32"

**Corbin
Russwin**

In U.S.:
 Corbin Russwin, Inc.
 225 Episcopal Road, Berlin, CT 06037 USA
 Phone: 860-225-7411 Fax: 860-828-7266

In Canada:
 Yale-Corbin Canada LTD.
 3160 Orlando Drive, Mississauga, Ontario, Canada L4V1R5
 Phone: 905-672-6220 Fax: 905-672-9022