

ED3400/ED3400A Series

Exit Devices

Surface Vertical Rod

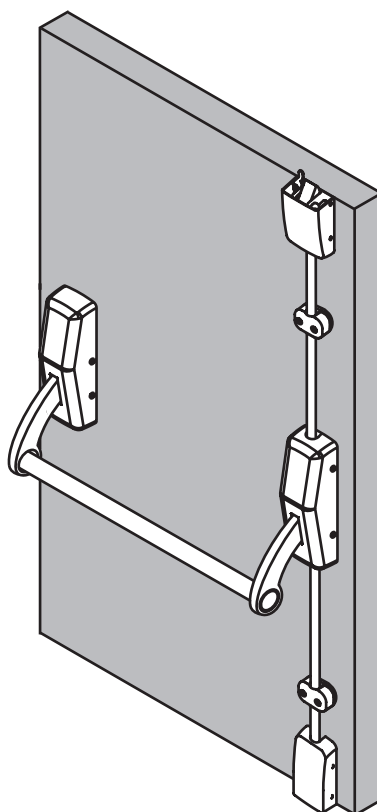

⚠ WARNING

This product can expose you to lead which is known to the state of California to cause cancer and birth defects or other reproductive harm. For more information go to www.P65warnings.ca.gov.

TOC	Table of Contents
1	Tools Required3
2	Package Contents3
3	Installation4
a	Template4
b	Active Case5
c	Chassis5
d	Inactive Case6
e	Outside Trim6
f	Top Latch and Rod7
g	Mount Bottom Rod Assembly.....7
h	Adjustment8
i	Top Strike8
j	Mount Bottom Strike9
k	Covers..... 10
l	Rod Guides 11
m	Crossbar..... 11
n	Top Latch Trigger 11

Installation Instructions

1

Tools Required

- Measuring tape
- Power drill
- Drill bits: 3/32", 1/4", 11/32", 3/8" and #25
- Taps: #10-24
- Screwdrivers: Phillips #2 and Phillips #3

2

Package Contents

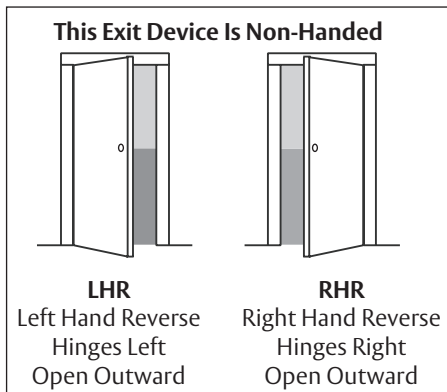

Figure 1

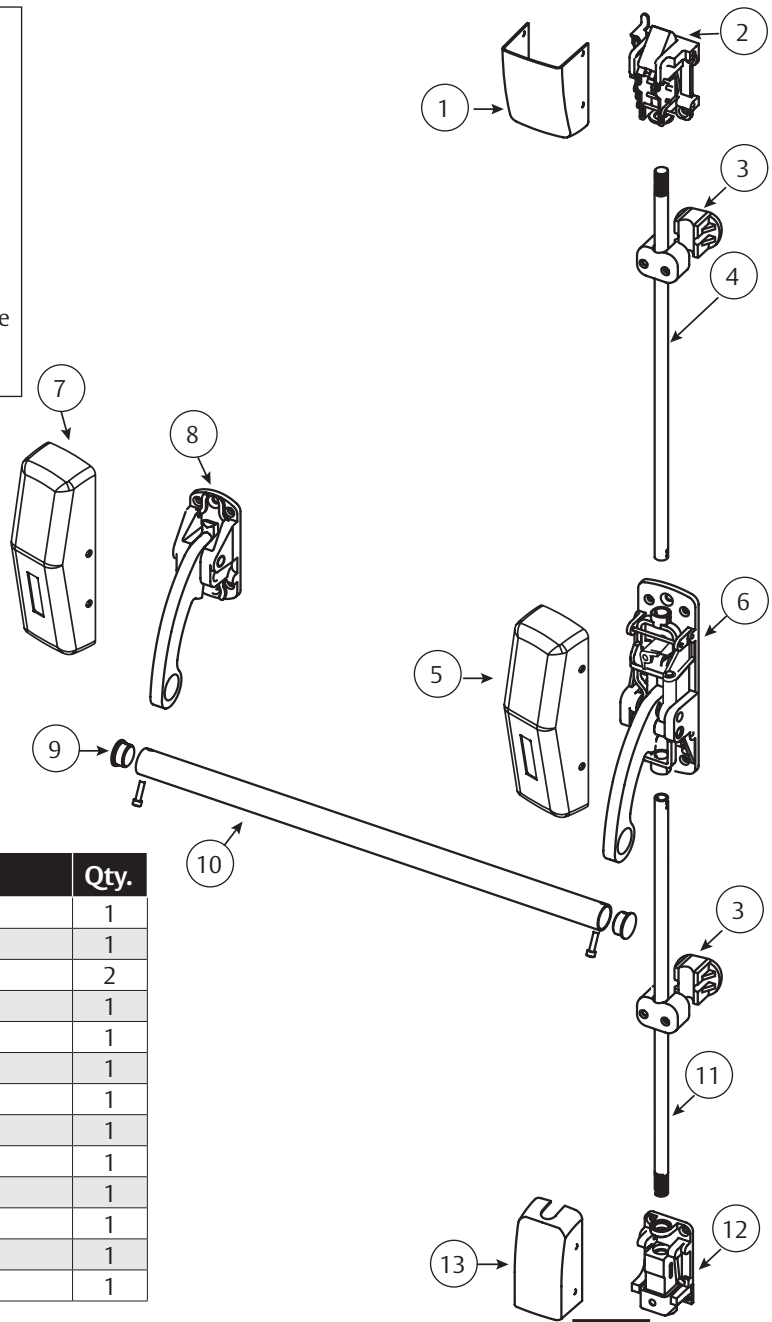

Figure 2

Figure 2	Part Description	Qty.
1	Top Latch Cover	1
2	Top Latch Chassis	1
3	Rod Guide	2
4	Top Rod	1
5	Active Case Cover	1
6	Active Case Chassis	1
7	Inactive Case Cover	1
8	Inactive Case Chassis	1
9	Cross Bar Plug	1
10	Cross Bar	1
11	Bottom Rod	1
12	Bottom Latch Chassis	1
13	Bottom Latch Cover	1

3

Installation

a

Template

1. Mark the vertical centerline on inside of door as follows:
 - If stile is 4-1/2" wide or greater, measure 2-3/4" from doorstop.
 - If stile is less than 4-1/2" wide, make A equal to 1/2 the width of the exposed lock stile (when door is closed against stop).
2. Measure 37-5/8" above finished floor and draw horizontal line for active case template.
3. Align template (T31207) for active case with centerline and tape.
4. Using crossbar hole centers for measuring, draw vertical centerline of inactive case.
5. Measure 38-5/8" above finished floor and draw horizontal line for inactive case template (1" higher than the active case).
6. Align template (T31206) for inactive case with centerline and tape.
7. Position top strike template (T31209) into place.
8. Center punch mounting holes for active and inactive case, and top strike.
9. Drill and tap holes in door, per templates.

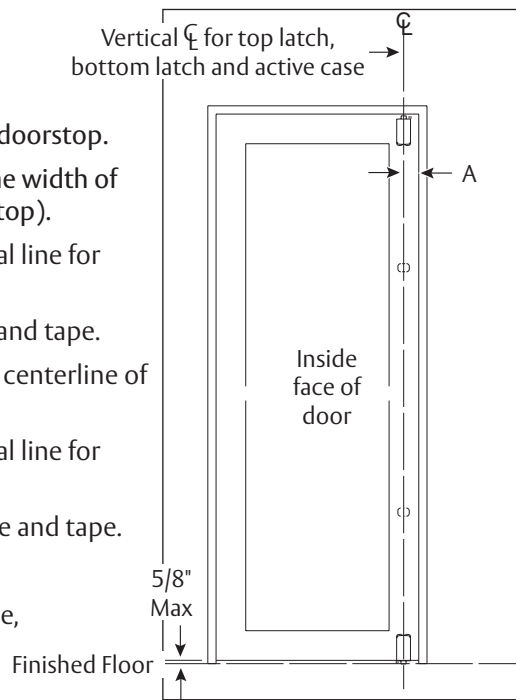

Figure 3

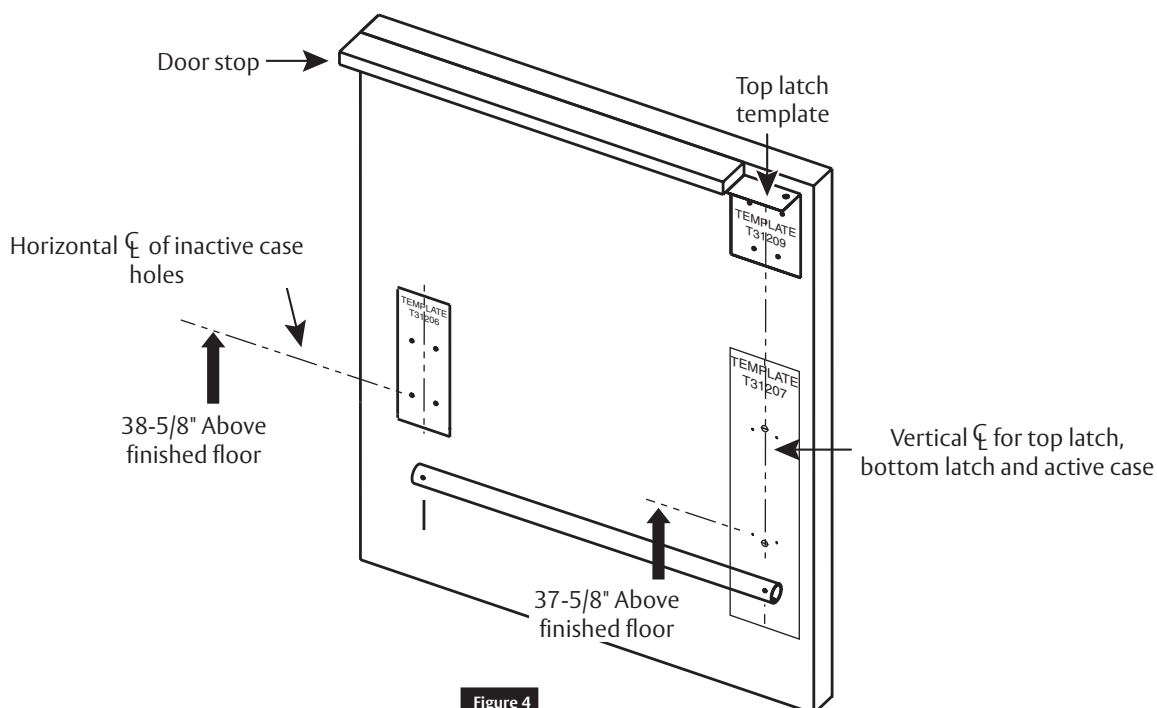

Figure 4

3

Installation (cont.)

b

Active Case

1. Remove cover from active case chassis.
2. Mount chassis to door as indicated in Figure 5 and Figure 6.
3. If installing a cylinder function, ensure hub pin is in correct position. (Step 3c)

Hinge side

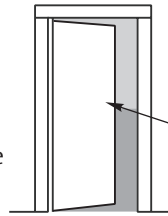

Figure 5

Active case side
(away from door hinge)

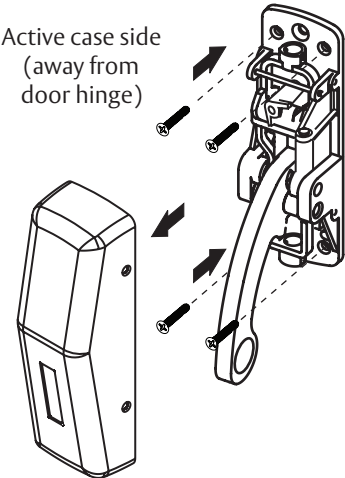

Figure 6

Note

Active case is larger than inactive case.

Active case mounting screws - Actual size



Wood: #10 x 1-1/4"
Phillips flat head
(Total = 4)

Active case mounting screws - Actual size



Metal: #10-24 x 3/4"
Phillips flat under cut
(Total = 4)

Figure 7

c

Chassis

For ED3457A (Nightlatch) long end of pin faces down. Cylinder turns 180° in both directions. (Figure 8)

For ED3455A/ED3455AT (Classroom) long end of pin faces up. Cylinder turns 360° to the left or right. (Figure 9)

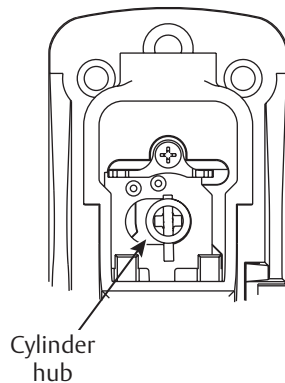

Figure 8

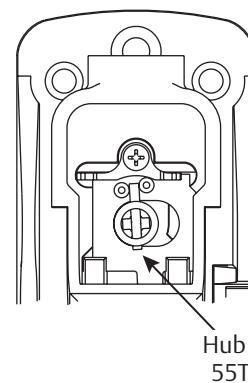

Figure 9

3

Installation (cont.)

d

Inactive Case

1. Remove cover from inactive case chassis.
2. Mount chassis to door as indicated in Figure 10 and Figure 11.

Note

Active case is larger than inactive case.

Inactive case mounting screws - Actual size



Wood: #10 x 1-1/4"
Phillips flat head
(Total = 4)

Inactive case mounting screws - Actual size

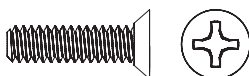

Metal: #10-24 x 3/4"
Phillips flat under cut
(Total = 4)

Figure 12

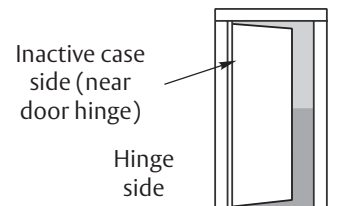

Figure 10

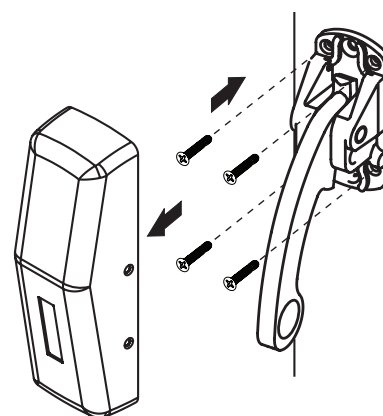

Figure 11

e

Outside Trim

1. Thread cylinder into outside trim (if applicable).
2. Slide through-bolt screws through inside chassis and door.
3. Align outside trim with exposed through-bolt screws and secure.

Outside trim mounting screws - Actual size



1/4 -20 x 2-3/8"
Phillips Flat Head
(Total = 2)

Cylinder mounting screws - Actual size



#10-24 x 2"
Phillips Oval Head
Machine Screw
(Total = 2)

Figure 14

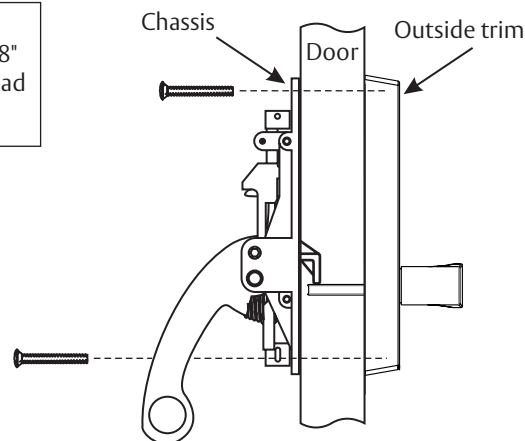

Figure 13

3

Installation (cont.)

f

Top Latch and Rod

1. Remove cover.
2. Screw top rod into top latch chassis halfway. (Figure 15)
3. Confirm crossbar arm is NOT in dogged position.
4. Remove top rod pin from active chassis and slide top rod into active chassis. (Figure 16)
5. Attach top latch chassis to door with screws according to template.

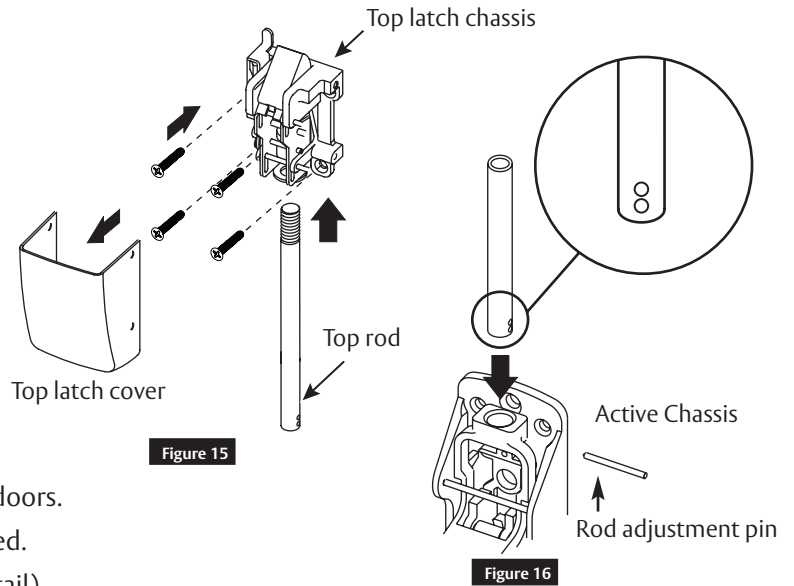

Note

Use through-bolt screws for fire rated doors.

6. Ensure top latch bolt is fully extended.
7. Rotate rod until upper hole (see detail) aligns with hole in active chassis and insert rod adjustment pin.

g

Mount Bottom Rod Assembly

1. Remove cover.
2. Position bottom case on door, centered on vertical center line. Raise or lower to achieve gap indicated for strike application. (Figure 18)
3. Mark and center punch mounting holes for bottom latch.
4. Drill and tap mounting holes.
5. Screw bottom rod into bottom latch chassis until finger tight.

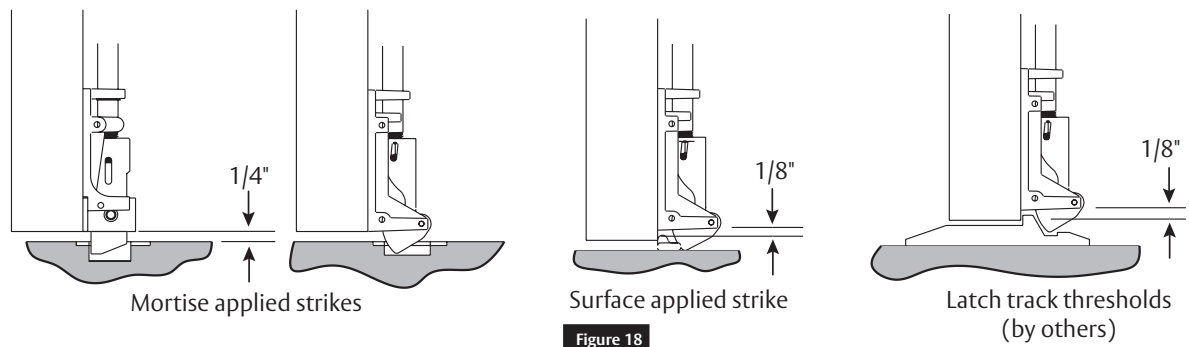
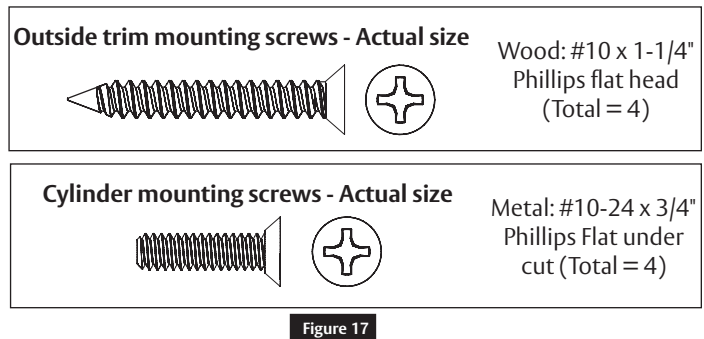

3

Installation (cont.)

g

Mount Bottom Rod Assembly (cont.)

6. Confirm crossbar arm is NOT in dogged position.
7. Remove bottom rod pin from active chassis and slide bottom rod into active chassis.
8. Attach bottom latch chassis to door.

Note

Use through-bolt screws for fire rated doors.

9. Ensure bottom latch bolt is fully extended.
10. Rotate rod until middle hole aligns with hole in active chassis and insert rod adjustment pin.

h

Adjustment

1. Depress crossbar arm to verify top latch goes into holdback.
2. If latch does not go into holdback, pull out the adjustment pin. Rotate top rod counterclockwise one complete turn, reinsert pin and test again. Continue this step until holdback is achieved.

Notes

- If there is minimal thread engagement with top latch chassis, use lower hole in rod to secure to active chassis.
- If rod is rotated too far into top latch, engagement with top strike will not occur or will be minimal. Rotate rod counterclockwise for additional engagement.

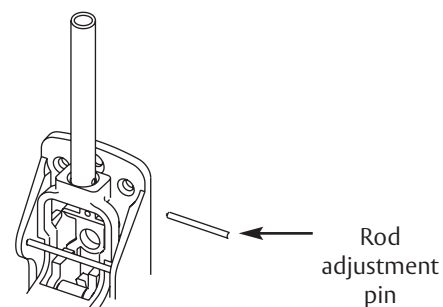

Figure 19

i

Top Strike

1. Align top strike with holes on doorstop of frame and secure.

Note

Align thick end of strike closest to door.

2. Close door and verify engagement of top strike and latch.

Top strike mounting screws - Actual size	
	Wood: #12 x 1-1/2" Phillips Flat Head (Total = 2)
Top strike mounting screws - Actual size	
	Metal: #12-24 x 1" Phillips Flat Head (Total = 2)
Top strike mounting screws - Actual size	
	Metal: #10-24 x 3/4" Phillips Round Head (Total = 2)

Figure 21

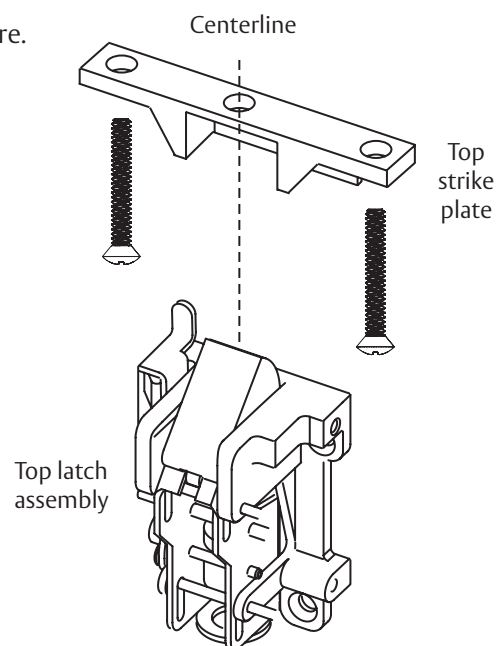

Figure 20

3

Installation (cont.)

j

Mount Bottom Strike

Mark and install according to appropriate template and the following information. For surface -applied strikes:

1. Transfer vertical centerline to floor or threshold and mark.
2. Center strike on the marked line.
3. Mark mounting holes. (If using Flush Bottom Strike (S03), mark mounting holes and outline of strike.)
4. Drill holes for screws.
5. Mount strike with screws provided.
6. Tighten screws.

Surface Projecting Bottom Strike Mounting Screws Actual Size

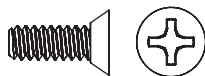

Metal: #12-24 x 1/2"
Phillips Flat Head
(Total = 2)

Surface Projecting Bottom Strike Mounting Screws Actual Size



Wood: #12 x 1"
Phillips Flat Head
(Total = 2)

Flush Bottom Strike Mounting Screws - Actual Size



1/4 -20 x 2" Phillips
Flat Head (Total = 2)

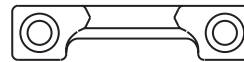

Surface Projecting
Bottom Strike

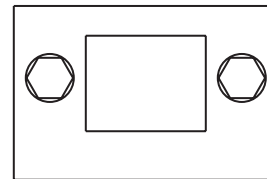

Flush Bottom Strike
(S03)

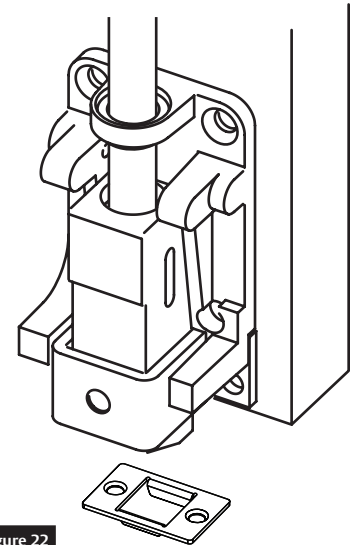

Figure 22

Figure 23

3

Installation (cont.)

k

Covers

1. Attach covers to both case chassis and latch chassis.
2. Tighten all screws.

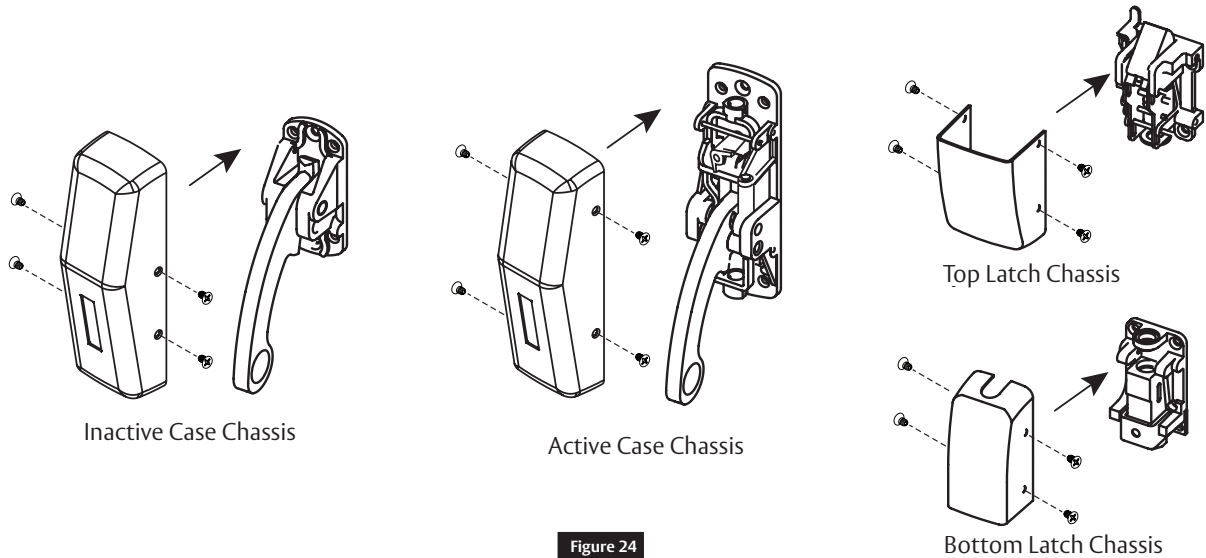

Figure 24





Latch Chassis Screws - Actual Size	
	 #8-32 x 5/16" Phillips Oval Head (Total = 8)
Case Chassis Screws - Actual Size	
	 #8-32 x 7/32" Phillips Oval Head (Total = 8)

Figure 25

3

Installation (cont.)

I

Rod Guides

1. Insert top and bottom rod guides at center of each rod and secure.
2. Test to confirm that rods move smoothly in rod guide and do not bind. If not, loosen screws slightly.

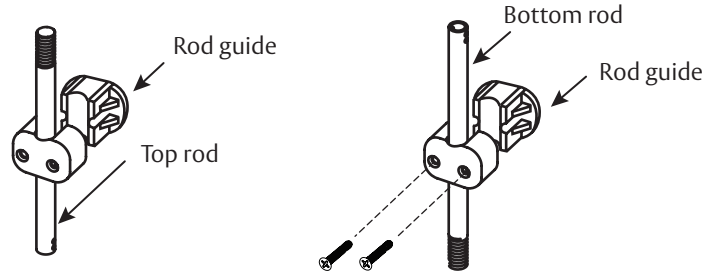

Figure 26

Rod Guide Mounting Screws - Actual Size



#10-24 x 1-1/4"
Phillips Oval
Head (Total = 4)

Rod Guide Mounting Screws - Actual Size



Wood: #8 x 1-3/4"
Phillips Oval Head
Screw (Total = 4)

Figure 27

m

Crossbar

1. Slide crossbar into active chassis arm.
2. Slide crossbar into inactive chassis arm.
3. Insert plugs and secure to bar with locking screws.
4. Depress the crossbar to confirm the latchbolts retract and the top latch goes into latch holdback.
5. Test top latch trigger to confirm rods drop when door closes.

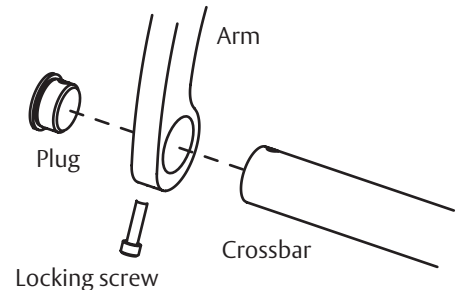

Figure 28

Crossbar Mounting Screws - Actual Size



#10-24 x 3/4" Socket Head
Cap Screw (Total = 2)

Figure 29

n

Top Latch Trigger

Press down on top latch trigger to confirm latchbolt and rods retract.

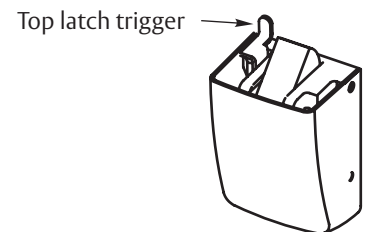

Figure 30

The ASSA ABLOY Group is the global leader in access solutions. Every day, we help billions of people experience a more open world.

ASSA ABLOY Opening Solutions leads the development within door openings and products for access solutions in homes, businesses and institutions. Our offering includes doors, frames, door and window hardware, locks, perimeter fencing, access control and service.



Corbin Russwin, Inc.
225 Episcopal Road
Berlin, CT 06037 USA
Phone: 800-543-3658
Fax: 800-447-6714
www.corbinrusswin.com

Corbin Russwin is a brand associated with ASSA ABLOY Access and Egress Hardware Group, Inc., an ASSA ABLOY Group company. Copyright © 2020 ASSA ABLOY Access and Egress Hardware Group, Inc. All rights reserved. Reproduction in whole or in part without the express written permission of ASSA ABLOY Access and Egress Hardware Group, Inc. is prohibited.

For installation assistance contact Corbin Russwin
1-800-543-3658 • techsupport.corbinrusswin@assaabloy.com

FM361 04/20