

# Storm Resistant

## **FE6700 Series Storm Shutter Multi-Point Latching System**

The Corbin Russwin FE6700 Series is a robust three-point locking system engineered to help save lives by securing the community shelter window openings. Extra heavy-duty steel components secure the shutter to the frame – at the top, bottom and center latch points – fortifying the opening to withstand extreme wind speeds and flying debris. UL Classified for both FEMA P-320 (2014), FEMA P-361 (2015) and ICC 500 (2014), the FE6700 Series provides peace of mind when a tornado approaches.



# FE6700 Series

## Storm Shutter Multi-Point Latching System

### APPLICATIONS

- Community Shelters and Safe Rooms
- Corporate Campuses
- K-12 Schools
- Healthcare Facilities
- Government Facilities

### FEATURES AND BENEFITS

- Three point auto deadlocking system
- UL Classified to FEMA P-320 (2014), P-361 (2015) and ICC 500 (2014)
- Recommended for In swing applications
- Available for shutters sized 2' 8" x 3' 0" up to 4' x 6' 8".
- Heavy duty escutcheons standard
- Fully Integrated - part of a complete ASSA ABLOY severe windstorm solution utilizing Ceco and Curries StormPro® shutters and frames and McKinney StormPro® and Markar hinges.
- Fortified with high tensile alloy Holo-Krome® fasteners
- All three latching points are activated automatically when the shutter is closed

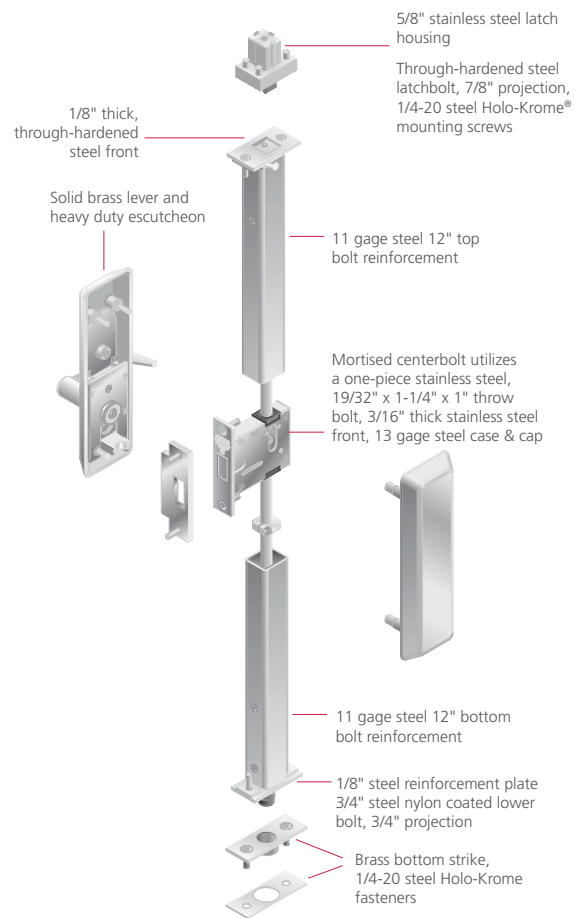

Corbin Russwin Architectural Hardware  
225 Episcopal Road, Berlin, CT 06037  
Phone 800-543-3658  
Fax 800-447-6714  
[www.corbinrusswin.com](http://www.corbinrusswin.com)

ASSA ABLOY Door Security Solutions Canada  
160 Four Valley Drive, Vaughan, Ontario, Canada L4K 4T9  
Phone: 800-461-3007  
Fax: 905-738-2478  
[www.assaabloy.ca](http://www.assaabloy.ca)

ASSA ABLOY is the global leader in door opening solutions, dedicated to satisfying end-user needs for security, safety and convenience.