



## 60 SERIES

## 61 SERIES (Top Rod Only)

### Concealed Vertical Rod Device - Narrow Stile Aluminum Door

The 60 and 61 Series concealed vertical rod exit device is super-heavy-duty panic and fire exit hardware for use on all types of narrow stile aluminum doors without a mullion. The patented mounting plate system ensures the easiest and most accurate installation of panic hardware available.

Note: For Top Rod Only -  
Specify 61 Series

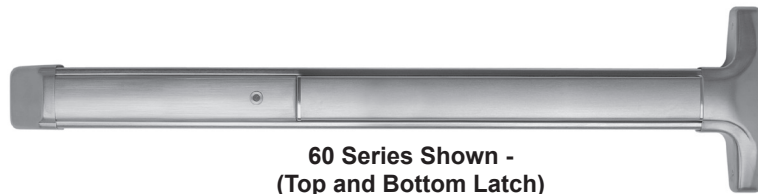

60 Series Shown -  
(Top and Bottom Latch)

ANSI 156.3 - 2008  
Grade 1  
Type 6

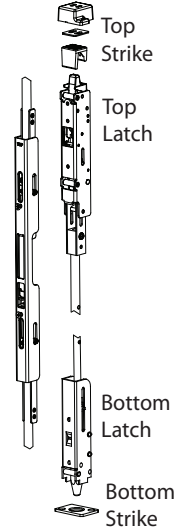

#### Also Available:

- 62/63 CVR Narrow Stile H.M. Door
- 70/71 CVR Wide Stile Wood Door
- 80/81 CVR Wide Stile H.M. Door
- 82/83 CVR Wide Stile Alum. Door

### Benefits

- Tough and durable design for years of trouble-free service in high-use, high-abuse environments
- Minimal door prep saves time and money
- Heavy duty angled end cap deflects damage away from device
- Fast and easy installation saves time and money
- Except for 03R, outside trims are easily changed or rekeyed without removing device from door

### Features

- 6-position multi-step action in top latch keeps top and bottom bolts retracted until door closes and provides more consistent re-latching and security to door
- Top strike fully adjustable both vertically and to accommodate a variety of varying weather strip thicknesses
- Top strike both secures the door and re-engages the latchbolts
- Patented deadlocking of top (60 and 61 Series) and bottom bolt (60 Series) assemblies
- Durable steel bottom drop bolt (60 Series)
- Rods are easily adjustable with rods installed in door
- Handed - field reversible
- Field sizeable
- 1/8 turn dogging

### Mechanical Options

- F - 3-Hour Fire Rated without astragal up to 10 foot (steel) door
  - AM - Anti-Microbial Coating
  - HD - Hex Dogging (Std.)
  - CD - Cylinder Dogging
  - SLR - Silencer
  - 24 - Fits 24" Door Width
  - 30 - Fits 30" Door Width
  - 36 - Fits 36" Door Width (Std.)
  - 48 - Fits 48" Door Width
  - EC1 - Heavy duty angled end cap (standard on 630, 606, 612, 613, 605, 611 & 629 finishes only)
  - EC2 - Flush end cap (standard on 628, 693 & 695 finishes only), specify when used on 2" - 3-1/2" stiles
- For full list of available mechanical options, see 60 Series How To Order page

### Electrical Options

- Exit Alarm (EA)
- Electric Dogging (ED)
- Electric Latch Retraction (ER)
- Delayed Egress Self-Contained (EE)
- Request to Exit (EX)
- Request to Exit for High Voltage (EXV)
- Electric Delayed Egress with Latch Retraction (EE ER)

Refer to Electrified Options section for more information

### Accessories

- SSK - Security Torx Screw Kit

## Technical Information

- Door Thickness - Fits standard 1-3/4" - 2 1/4" (for other door thicknesses contact factory)
- Door Stile - Fits minimum 2"
- For 2" - 3-1/2" door stiles, specify EC2
- Door Types - Aluminum/ Aluminum Channel FRP
- Fasteners - Machine and sheet metal screws supplied standard
- Rail is heavy ribbed aluminum extrusion

## Finishes

605 / US3	Polished Brass	628 / US28	Satin Aluminum	693 / SPBLK	Black, painted
606 / US4	Brushed Brass	629 / US32	Polished Stainless Steel	695 / SP313	Dark Bronze, painted
611 / US9	Polished Bronze				
612 / US10	Brushed Bronze	630 / US32D	Brushed Stainless Steel		
613 / US10B	Oil Rubbed Bronze				

## Top & Bottom Latch Door Prep for 60 & 61 Series

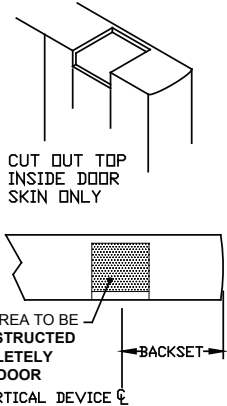

LATCH MOUNTING TOP & BOTTOM

## Top Latch Installation for 60 & 61 Series

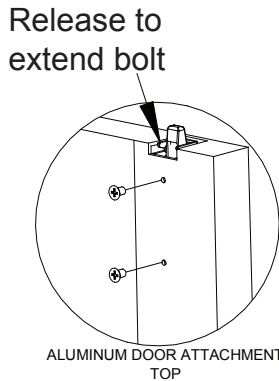

## Top Strike Installation for 60 & 61 Series

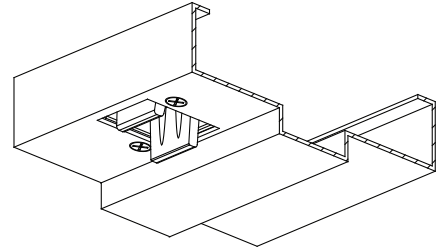

## Bottom Latch Installation for 61 Series only

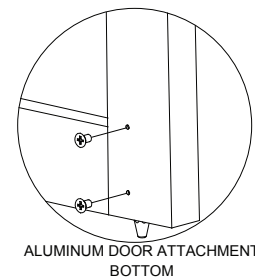

## Dimensions

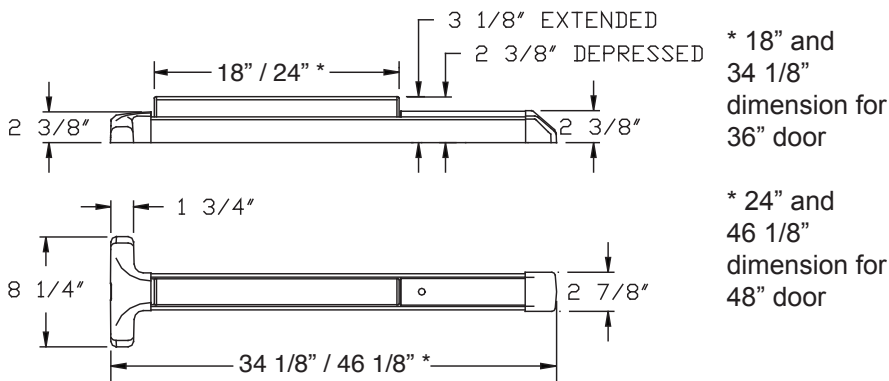

## Listings and Approvals



UL Listed Panic Hardware



ULC 97, Standard 7-2 and UL 10B/UL 10C for positive pressure



UL Listed Fire Exit Hardware 8'x10' pairs of doors



ANSI/BHMA certified A156.3



Meets ADA requirements



Meets NFPA 80 & 101 for Life Safety

For detailed fire listings, visit [www.detex.com/PROVEN](http://www.detex.com/PROVEN)

Cancer & Reproductive Harm - [www.detex.com/prop65](http://www.detex.com/prop65)

## Detex Limited Warranty

10 Year Mechanical/3 year Electrical Limited Manufacturer's Warranty

*Where Trust is Built™*  
**DETEX®**  
*Life Safety and Security Door Hardware*

Detex Corporation  
 302 Detex Drive  
 New Braunfels, Texas 78130-3045 USA  
 PH. (830) 629-2900  
 (800) 729-3839  
 FAX (800) 653-3839  
<http://www.detex.com>  
 USA Sales:  
[marketing@detex.com](mailto:marketing@detex.com)  
 International Sales:  
[export@detex.com](mailto:export@detex.com)