

SPECIFY GLASS DOOR MOUNTING KIT

--	--	--	--	--	--

Distributor Discount Code **GK** [List](#)

- Field adjustable for 1/2", 5/8" and 3/4" all glass Herculite doors

Kits for 1511, 1571, 1581
HDB1 Single **200.00**
Kits for 1512, 1572, 1582
HDB2 Double, 2 single kits **400.00**
[Add to List](#)**Anodized Finishes**

V 628 Aluminum (std) N/C	Y Black Anodized	Single	Double
		89.00	177.00

Powder Coat Finishes *(a coating electrostatically applied to form a hard finish, that is tougher than conventional paint)*

X Dark Bronze Powder Coat Painted	C Brass Powder Coat Painted	89.00	177.00
--	------------------------------------	--------------	---------------

Plated Finishes - Special order, no cancellation, no returns

P 625 Bright Chrome	Q 626 Dull Chrome	112.00	222.00
----------------------------	--------------------------	---------------	---------------

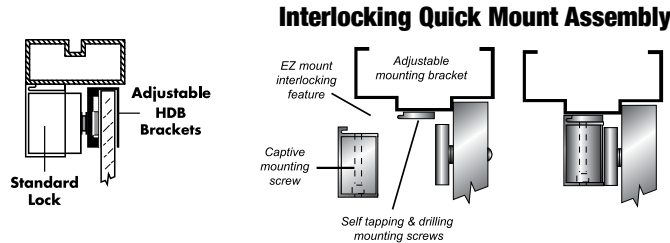
**Vertical Housing EMLock****GK LIST****Vertical Housings** - Side jamb mount, provides 2,400 or 3,300 lbs. of holding force.

1572VV82 Vertical Housing for 1572 EMLock, 82" length, for 84" opening - INCLUDES EMLock	1,662.00
---	-----------------

1512VV82 Vertical Housing for 1512 EMLock, 82" length, for 84" opening - INCLUDES EMLock	1,722.00
---	-----------------

See page 8 for special finish designation and finish price

Custom Length (1512 or 1572)	Add to List
------------------------------	-----------------------------

CV Custom length - any length OVER 82". Specify exact length	1,248.00
---	-----------------

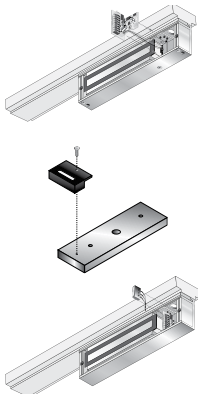
Field Installed Modular Upgrade Kits

Ordered separately for field upgrade without removing the lock from the frame

EZ-T-10 Adjustable Timer Input Module: 72.00	EZ-A Anti-Tamper Switch Module: 56.00
--	---

Specify (1) for single or double EmLocks® (not available with 1580 series)

Indicates cover plate removal.

EZ-D-10 1510, 1570 Door Position Sensor Module: 45.00	EZ-D-80 1580 Door Position Sensor Module: 45.00
---	---

Specify (2) for double EMLocks®

Reusable Heavy Duty Drill FixtureDistributor Discount Code **G LIST**

1511-DF	Heavy duty drill fixture for 1571 and 1511	167.00
----------------	--	---------------

1581-DF	Heavy duty drill fixture for 1580	167.00
----------------	-----------------------------------	---------------