

Installation Guide

LISCIO

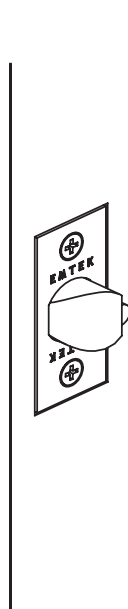

ELECTRONIC KEYPAD LEVERSET WITH
BLUETOOTH PROGRAMMING

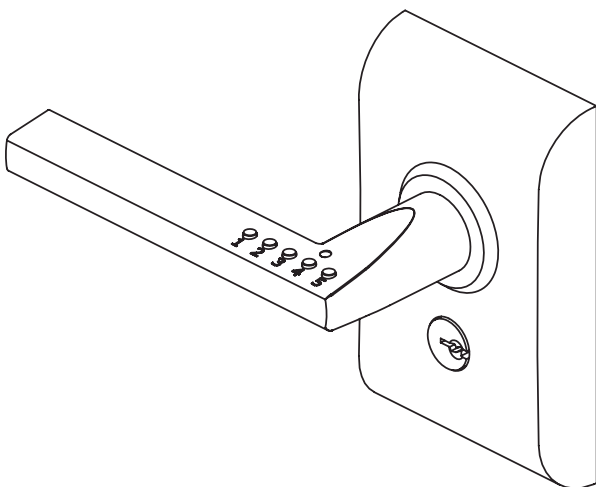

What's in the Box

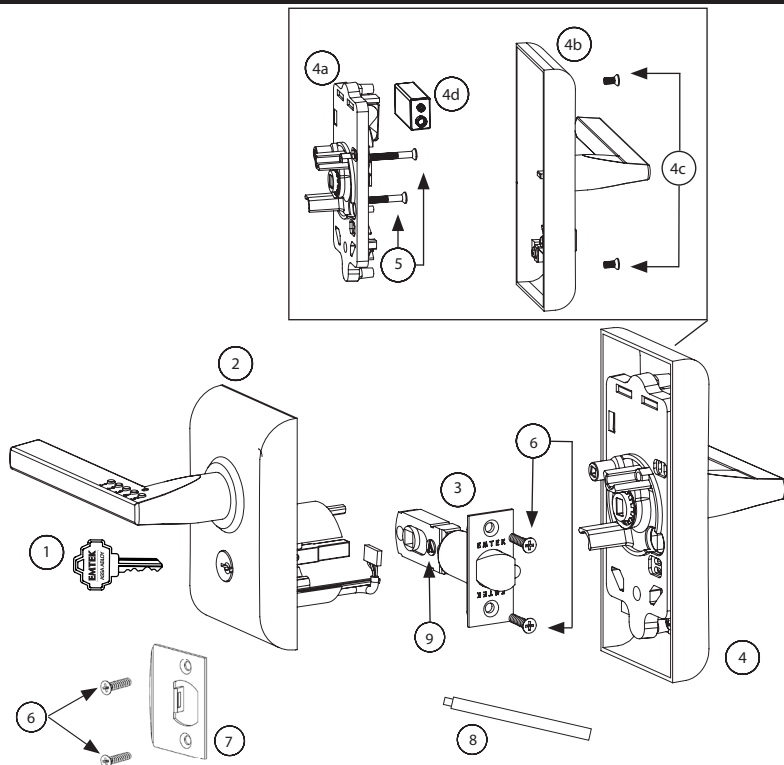

ITEM NO.	DESCRIPTION	QTY.
1	Key	2
2	Outside Trim Plate Assembly	1
3	Adjustable Latch for 2 3/8" or 2 3/4" Backset	1
4	Inside Trim Plate Assembly	1
4a	Inside Chassis	1
4b	Inside Trim Plate	1
4c	#8-32 x 1/8" Flat Head Machine Screw	2
4d	9V Alkaline Battery	1
5	#8-32 x 1 1/2" Flat Head Machine Screw	2
6	#8 x 3/4" Wood Screw	4
7	Strike Plate	1
8	Plastic Extender	1
9	Plastic Latch Pin	1

Preparation

1. Confirm Handing

HANDING OF DOOR IS ALWAYS DETERMINED FROM THE OUTSIDE

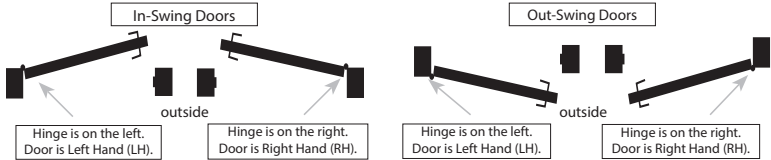

2. Door Prep

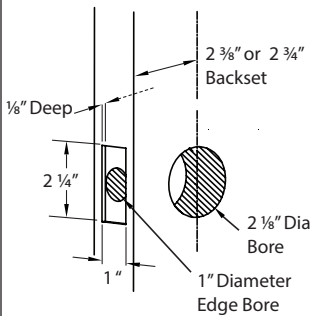

3. Door Jamb Prep

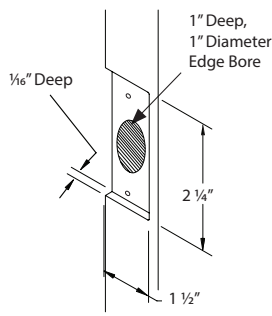

4. Install Strike Plate

Fasten Strike Plate using two #8 x 3/4" Wood Screws (item #6).

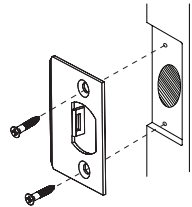

IMPORTANT!

CHECK LATCH HUB POSITION BEFORE INSTALLING

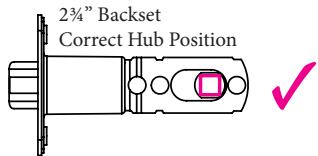
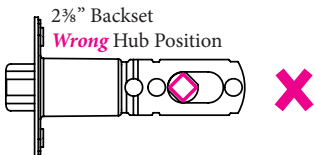
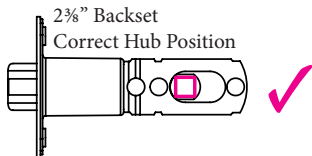

How to Install

1. Install Adjustable Latch

Fasten Adjustable Latch using two #8 x 3/4" Wood Screws (item #6).



Scan QR code for installation video

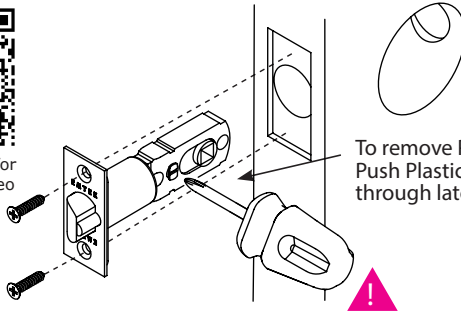

To remove Pin:
Push Plastic Latch Pin (item #9)
through latch with screwdriver.

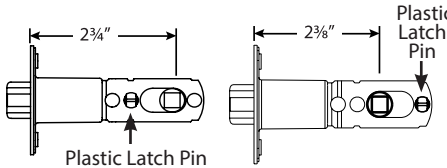

The Adjustable Latch is factory shipped with a 2 3/4" backset position. Remove pin and slide spindle hub forward for a 2 3/8" backset, then reinsert the pin in the hole at the back of the latch as shown.

2. Remove Screws from Inside Trim Plate

Use a Phillips head screwdriver to remove screws (item #4c) shown below and detach Inside Trim Plate from the Inside Chassis.



REMOVE INSIDE CHASSIS FROM TRIM PLATE BEFORE INSTALLING THE OUTSIDE TRIM. THUMBTURN MUST BE IN NEUTRAL POSITION.

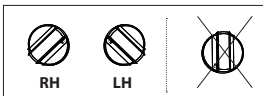

See Page 3 for Handling Information.

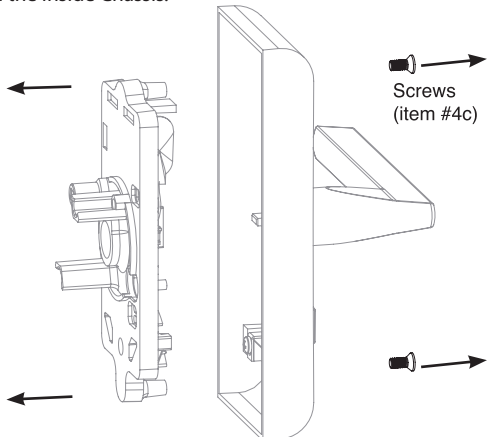

3. Install Outside Trim Plate Assembly

Step 1: While holding Outside Trim Plate Assembly, Press the Plastic Extender (item #8) into end of Spindle Shaft.

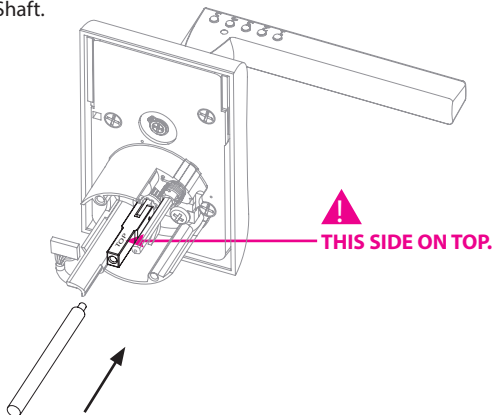

Step 2: Position the Outside Trim Plate Assembly through the bore hole.

!
**ONCE POSITIONED,
OUTSIDE TRIM PLATE
ASSEMBLY REQUIRES
SUPPORT.**

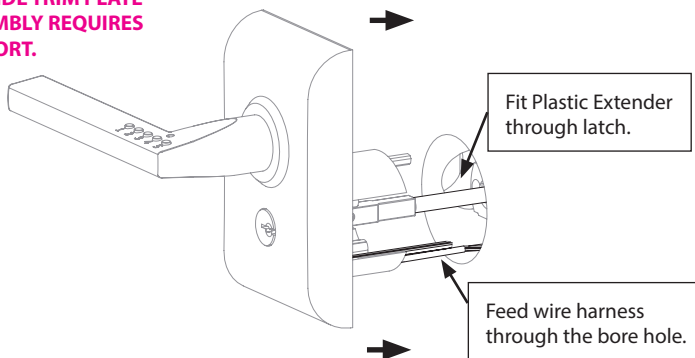

Step 3: With the Outside Trim Plate Assembly flush to the door, **REMOVE** the Plastic Extender.

4. Install Inside Chassis

Step 1: Confirm the position of Cam Link.



**CAM LINK MUST
REMAIN IN
THE CORRECT
POSITION DURING
INSTALLATION.**

For Right Hand Locks:

Turn to right position.

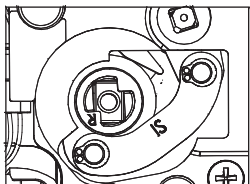

For Left Hand Locks:

Turn to left position.

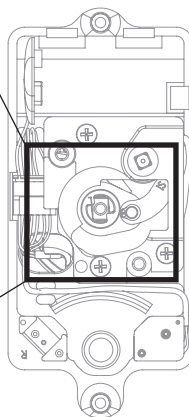
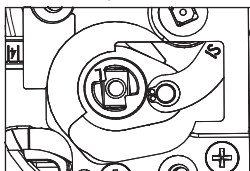

Step 2: Feed the Wire Harness through Inside Chassis.

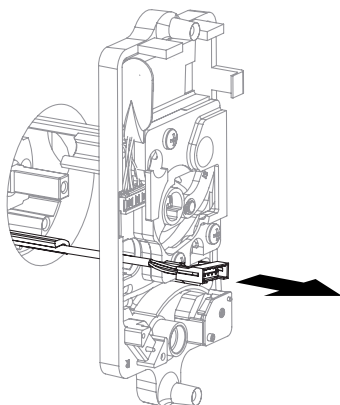

Step 3: Fasten Inside Chassis using two #8-32 x 1½" Flat Head Machine Screw (item #5).



CHECK ALIGNMENT BEFORE FULLY TIGHTENING SCREWS.

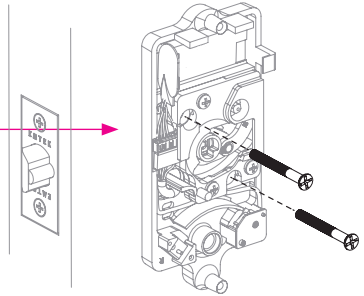

Step 4: Connect Wire Harness (A) and tuck Connectors as shown (B).

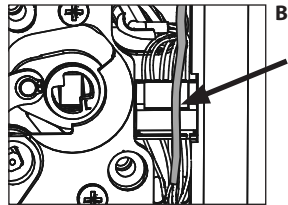
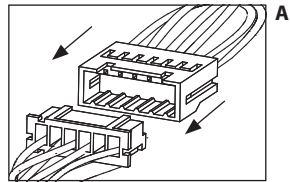
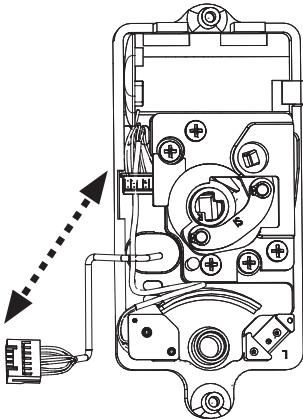

Step 5: Install Battery.

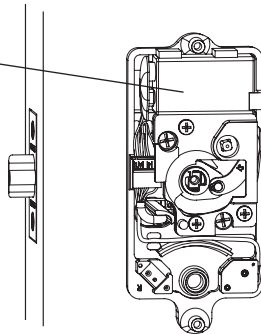
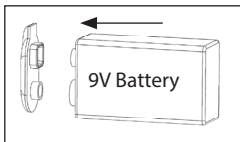

For optimal performance, always use a good quality battery.

5. Install Inside Trim Plate

Fasten Inside Trim Plate using two #8-32 x 3/8" Flat Head Machine Screws (item #4c).



USER CODES ARE LOCATED ON THE INSIDE TRIM PLATE & ON USER MANUAL.

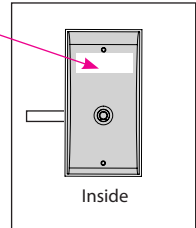

Scan QR code for installation video

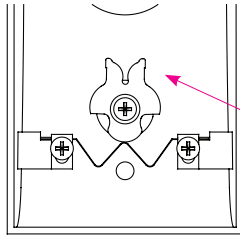

Correct position for installation. Thumbcam must be positioned as shown (Neutral Position)*

*Neutral position is required for installation and removal of the Inside Trim Plate Assembly.

