

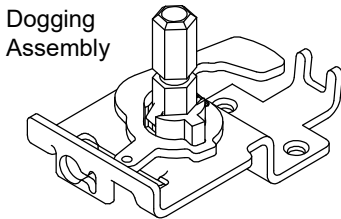

# INSTALLATION INSTRUCTIONS

## LR100FAK FALCON (Dor-O-Matic) ELECTRIC LATCH RETRACTION KIT MODELS: 1690 & 1790

Remove Push Bar. Remove Dogging Assembly. Slide the ELR unit into the device base. Align the first set of two holes over the two base unit holes and attach with the two #10-32 flat head screws supplied. Attach the Linkage to the device as shown. Re-attach the Push Bar.



Dogging Assembly

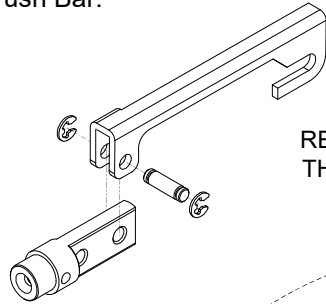

Retraction Arm

Clevis

ATTACH THE RETRACTION ARM TO THE FRONT HOLE ON THE CLEVIS AS SHOWN

**ELECTRICAL DATA**  
24VDC @ 1A  
RED (+) BLK (-)  
PATENT #8,851,530

Use supplied mounting plate to secure 36" devices

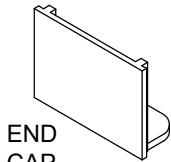
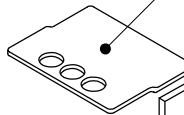

END CAP

#10-32 Flat Head Screws Supplied

Mark & drill hole

Mount to existing holes

Push Bar Spring Box

Linkage

DRILL .250 DIAMETER HOLE THROUGH END CAP & UNIT BASE FOR WIRE RUN

Align holes with Base and attach with #10-32 flat head screws.

Linkage

**Retrofit Installation Note:** 42" or 48" exit devices that have been modified to fit a 36" or smaller opening, may not have the required space to fit the standard E. L. R. assembly. Always verify the distance from the end of the touchpad to the end rail, and if necessary, consult with the factory for appropriate selection.

When retrofitting to existing vertical rod devices, adjustment of the rods is required for proper operation of the Electric Latch Retractor. Once the unit is properly installed, energize it so the push pad is dogged down, then reconnect the vertical rods to the device and make the proper adjustments.

Any suggestions or comments to this instruction or product are welcome. Please contact us through our website or email [engineer@sdsecurity.com](mailto:engineer@sdsecurity.com)

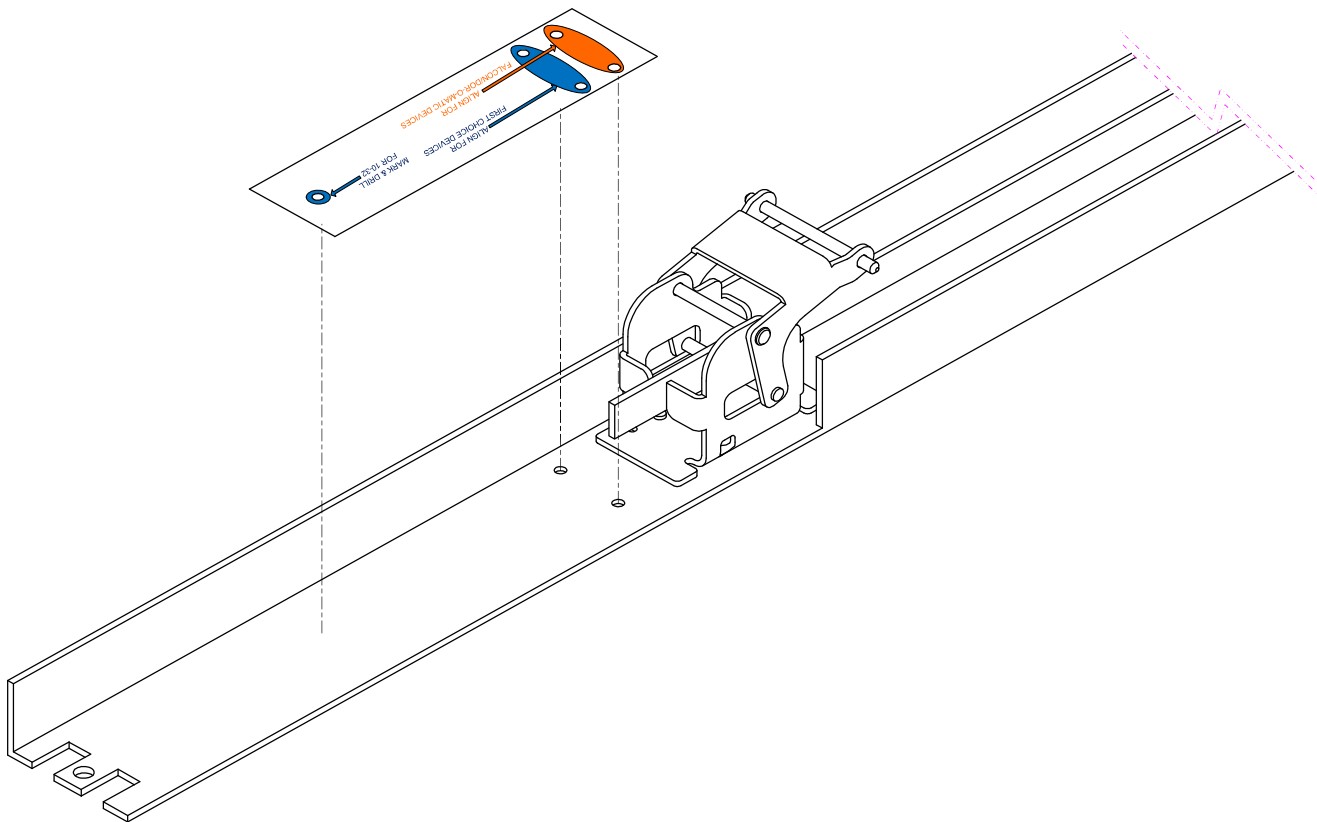
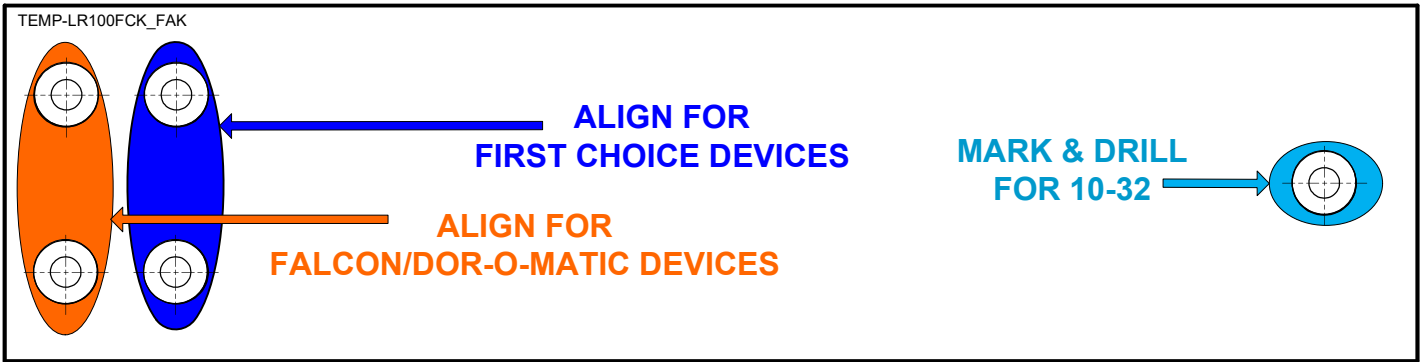

USE TEMPLATE WHEN DEVICES ARE LONGER THAN 36" FOR ADDED STABILITY OF KIT.

ALIGN TEMPLATE TO EXISTING HOLES, FALCON/DOR-O-MATIC or FIRST CHOICE. MARK AND DRILL 1 HOLE FOR 10-32 FLT HD