

SDC Security Door Controls

801 Avenida Acaso, Camarillo, Ca. 93012 • (805) 494-0622 •
www.sdcsecurity.com • E-mail: service@sdsecurity.com

LRFA1R INSTALLATION INSTRUCTIONS FALCON (DOR-O-MATIC) REX SWITCH KIT MODELS: 1690 & 1790

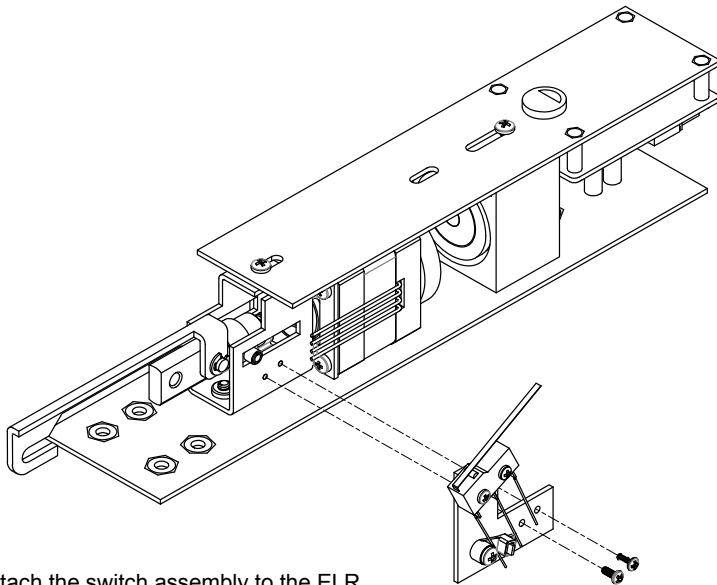

Attach the switch assembly to the ELR unit with the supplied screws as shown.

WIRING DATA

WHT = COM

YEL = N/C

ORG = N/O

5AMP @ 125VAC
RESISTIVE

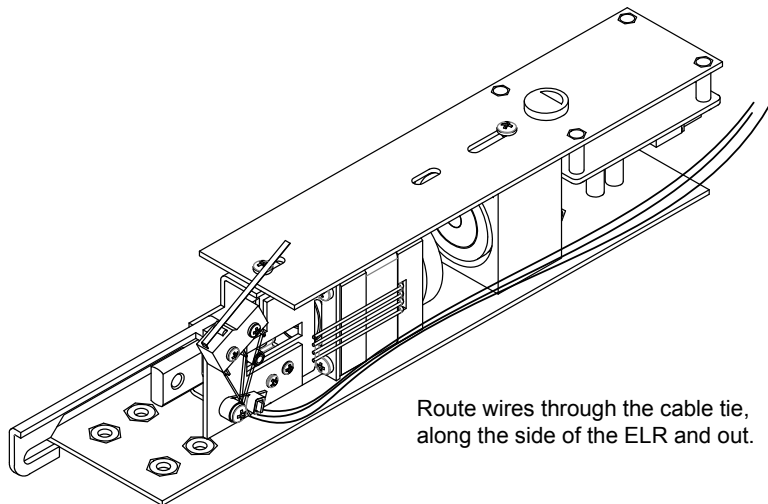

Route wires through the cable tie, along the side of the ELR and out.