



# L3 SERIES Lever Trim Devices



**The attractive solution to complex access control issues encountered in today's design environment.**

Available in true anodized finishes and compatible with both the L3600 Concealed Vertical Rod and L3700 Rim Latching Exit Devices, this trim will provide years of durable service even in high traffic conditions.

Using the L3 Levers allows the exit devices to remain in a latched condition at all times while providing improved security and the perfect solution to problems associated with wind and stack pressures.

The L3 Series offers multiple options for controlling access.

### Unrestricted Passage Function

**M3**, when set to the unlocked position, the lever is operable and the door can be opened at any time.

### Controlled Access Function

**M1**, The lever operation is restricted to key entry only and cannot be left in an unlocked condition

### Latching Only

**M2**, The lever is operable and cannot be locked against entry.

### Inactive

**M0**, The lever acts as a pull only and inoperable.

### Electric Control

**EL**, The lever can be unlocked remotely using low voltage (24VDC) and low amperage (.5 amp) circuitry easily integrated with other building systems.

### Please See Handing Diagram

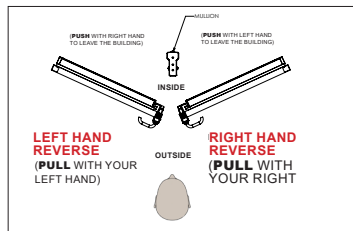

1222 Ardmore Avenue,  
Itasca, IL 60143

All our exit devices have a lead time before shipping.

For current lead times please call us at:

**(800) 793-4544**

Click below to email us at [sales@fcbp.com](mailto:sales@fcbp.com)



**Simple to Operate and Designed for Easy Application**

## SPECIFICATIONS

Lever trim shall be First Choice Building Products' Series L3 suitable for mounting on 2" narrow stile doors and provided in anodized finishes on all exposed surfaces.

The lever handle shall be round with reinforced steel attachment to the lever body. Lever shall have available options for passage, controlled or electronic function. The lever shall provide for universal mounting pattern independent of exit device function or handing.

## HOW TO ORDER

**EXAMPLE: L3ABB-CC-DD  
(L3610-M1-28)**

### Identify Model of Exit Device:

#### Exit Device

L3600

L3700

#### A = Exit Device Type:

6 = CVR

7 = Rim Latch

#### B = Choose Door Handing:

10 = LHRB (From outside, Pull with Left Hand/From Inside Push with Right Hand)

20 = RHRB (From outside, Pull with Right Hand/From Inside Push with Left Hand)

13 = LHRB with Key Cylinder

23 = RHRB with Key Cylinder

#### C = Locking Functions:

M0 = Inactive (Dummy)

M1\* = Night Latch/Storeroom (Key always Required)

M2 = Passage (Always Active)

M3\* = Hold-Back/Classroom

EL\* = Electric (Lever Released by Signal or Key)

(\* Key Cylinder for these locking functions only)

#### D = Finish:

28 = CL/Clear

13 = BR/Dark Bronze

35 = BL/Anodized Black