

# 1250 & 1450 SERIES SURFACE MOUNTED CLOSERS

## PRODUCT SELECTION GUIDE

Surface mounted 1250 & 1450 Series LCN closers feature a modern slim line design for easy installation on narrow head frames and top rails. This guide is based on the desired mounting of the closer.

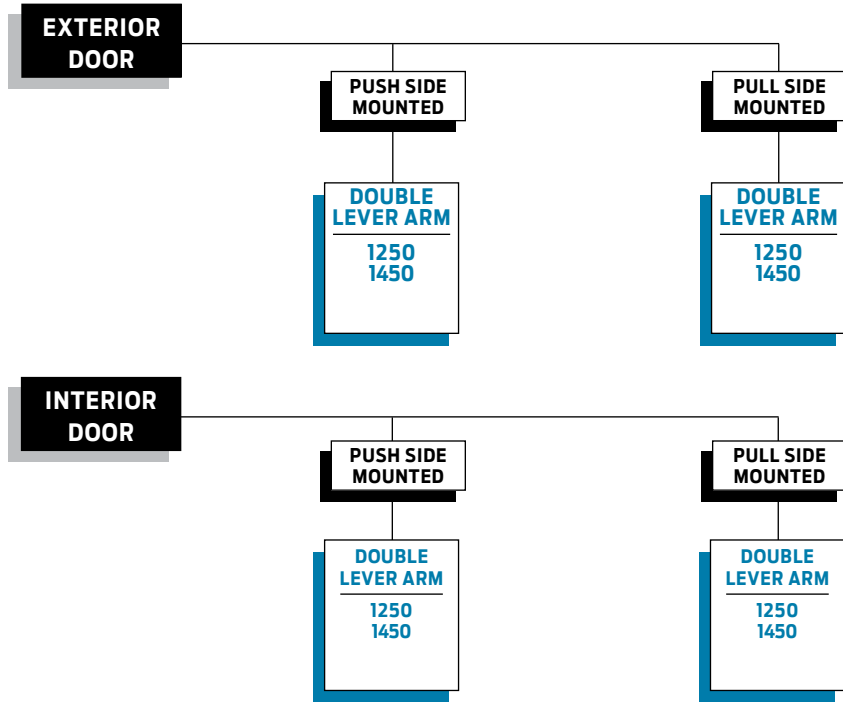

## PRODUCT COMPARISON

This chart shows a basic comparison of LCN 1000 Series closers. Refer to the specific closer chapter for complete details.

	MOUNTING					FINISH			COVER		CYLINDER		*ARM FUNCTION								
	HINGE (PULL SIDE)	TOP JAMB (PULL)	TOP JAMB (PUSH)	PARALLEL ARM	STOP FACE	PAINT	POWDER COAT	PLATED	PLASTIC	METAL	NON-HANDED	NON-SIZED	ACCESSIBILITY	DELAYED ACTION	REGULAR (DOUBLE)	STANDARD (SINGLE)	HEAVY DUTY	HOLD-OPEN	EDA/HEDA	CUSH/HCUSH	SCUSH/SHCUSH
1250	●	○	●	●	○	●	●	○	●	○	●	●	♿	○	180°	○	○	180°	180°	110°	110°
1450	●	○	●	●	○	●	●	●	●	●	●	●	♿	●	180°	○	○	180°	180°	110°	110°

● AVAILABLE  
○ NOT AVAILABLE

♿ Closer available with less than 5.0 lbs. opening force on 36" door.

\* Maximum opening/hold-open point with standard template. See individual closer series for degrees of opening per installation.

# 1250 & 1450 SERIES SURFACE MOUNTED CLOSERS

## APPLICATIONS

- For aluminum, hollow metal, or wood swinging doors and frames.
- Can be used with hinge or pivot mounted door.
- Mounts on 1-3/4" transom without adapter plates.
- Adapter plates and other installation accessories available for unusual conditions.

## FEATURES COMMON TO 1000 SERIES

- 1000 series closers mount three ways. Closers with regular or hold-open arm mount hinge side or top jamb. Parallel arm, closers include - 62PA SHOE required for parallel arm mount.
- Non-handed for right and left swinging doors.
- Closers to meet ADA reduced opening force requirements.
- Adjustable hydraulic backcheck cushions opening swing prior to 90°.
- Separate regulation of general closing speed and latching speed.
- Joints in arm and shoe adapt to uneven trim.
- Reversible shoe to boost latching power on double lever arms.

## DESIGN ASSISTANCE

LCN has been providing reliable solutions to unique door control problems for over 85 years. Design and specification assistance are only a phone call away.

Contact LCN for assistance or technical information at **877-671-7011** or FAX **800-248-1460 (Order Entry)**, Fax **815-879-1495** for Product Support.

## WARRANTY

15 year limited warranty (1250 series) and 25 year limited warranty (1450 series) on cast aluminum. See General Information Section for complete warranty details.

## SPECIFICATIONS

Refer to "SPECIFICATIONS" section for suggested architectural specifications.

## MATERIALS

- High strength **cast aluminum** cylinder.
- **Forged steel** main arm for all EDA, Cush, and SCUSH.
- Heat treated pinion.
- **All weather fluid** for cast aluminum performs to -30 degrees.
- **High efficiency, full complement**, low friction bearings.
- Tamper resistant regulating screws.
- Full rack and pinion hydraulic action.

## FINISHES

- Painted finishes on cast aluminum.
- Available in six standard or a wide selection of optional custom powder coat finishes to blend with door and frame.
- LCN's powder coat finish surpasses 100 hours of salt spray which is over four times the ANSI standard for corrosion resistance.
- For installations where a higher level of corrosion resistance is required, LCN offers an optional special rust inhibiting (SRI) pre-treatment. Closers that combine the exclusive LCN powder coat finish and the SRI pre-treatment exceed the ANSI standard for corrosion resistance even further.
- Plated finishes are available as an option to accent door and frame for the 1450 Series closers.

## LISTINGS & APPROVALS

UL listed for self-closing doors without hold-open under "SWINGING DOOR CLOSERS" (GVEV). Tested and certified under ANSI Standard A156.4 grade one. Consult factory for details.

## POSITIVE PRESSURE

LCN closers have been certified for three hours by UL to be in compliance with UBC 7-2 (1997) and UL 10 C. Contact LCN for specific details on door closer fire ratings.

## FASTENERS

1250 and 1450 series closers are shipped with: A universal screw pack to include self reaming and tapping screws (SRT), machine screws and wood screws. Standard LCN thru bolts (TB) can be installed on 1-3/4" (44 mm) thick doors with 1/4-20 machine screws. Optional thru bolt (TB) sizes are available for 1-5/8" (41 mm) or 1-3/8" (35 mm) door thickness, but this must be specified when ordering.

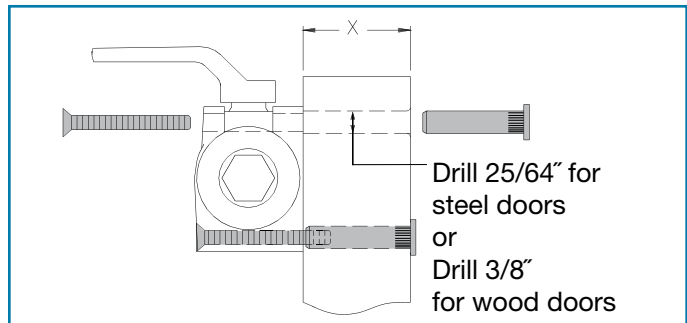

Note 1: For Thru Bolts, specify door thickness if other than 1-3/4" (44 mm). Represented in diagram as dimension "X".

Note 2: Phillips head, metric machine screws are available, please specify.

Note 3: LCN recommends the use of wood screws in wood door applications.

## MAINTENANCE

Closers mounted according to LCN installation instructions require no periodic maintenance.

# 1250 SERIES

## FEATURES

**CLOSER MOUNTS**  
**\*HINGE (PULL) SIDE**  
**TOP JAMB (PUSH SIDE)**  
**PARALLEL ARM (PUSH SIDE)**

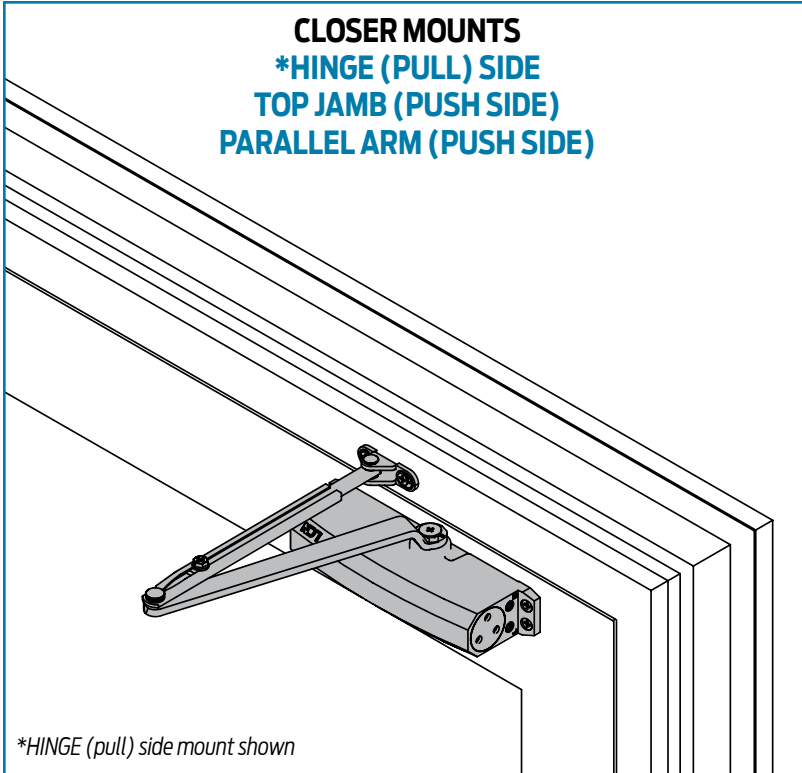

\*HINGE (pull) side mount shown

The 1250 Series cast aluminum closer is designed for low-frequency and low abusive traffic areas. This cast aluminum closer is ideal for aluminum storefronts, interior offices and many other applications. Combining dependable operation, low maintenance and a patented stylish look - with or without the optional slim line cover. And with the most common hole pattern in the industry, the 1250 Series is the perfect choice for easy aftermarket replacement.

- Standard 1250 Series closer shipped with tri-pack arms: regular, parallel and top jamb, universal screw pack: self-reaming and tapping: 1-3/4" thru bolts; machine screws and wood screws. Optional Torx security and long thru bolts.
- Non-sized (1-5) cylinder is adjustable for interior doors to 4'6" and exterior doors to 3'6".
- Closer mounts hinge side, top jamb and parallel arm on either right or left swinging doors.
- Mounts to most common commercial footprint (3/4" x 9-1/16").
- Closer meets ADA requirements. See 1250 Series page 10 for chart.
- Optional SRI primer for installations in corrosive conditions.
- Optional slim line plastic cover.
- Tested and certified under ANSI Standard A156.4, grade one.

- Cast Aluminum
- All weather fluid
- Non-handed
- Peel-n-stick templates for fast and accurate installation
- UL and cUL listed
- Adjustable spring size 1-5
- 15 Year Warranty
- Patent pending design

MOUNTING					FINISH			COVER		CYLINDER		*ARM FUNCTION								
HINGE (PULL) SIDE	TOP JAMB (PULL)	TOP JAMB (PUSH)	PARALLEL ARM	STOP FACE	PAINT	POWDER COAT	PLATED	PLASTIC	METAL	NON-HANDED	NON-SIZED	ACCESSIBILITY	DELAYED ACTION	REGULAR (DOUBLE)	STANDARD (SINGLE)	HEAVY DUTY	HOLD-OPEN	EDA/HEDA	CUSH/HOUSH	SCUSH/SHOUSH
●	○	●	●	○	●	●	○	●	○	●	●	○	○	180°	○	○	180°	180°	110°	110°

● AVAILABLE  
 ○ NOT AVAILABLE

♿ Closer available with less than 5.0 lbs. opening force on 36" door.

\* Maximum opening/hold-open point with standard template, when conditions allow.

# 1250 SERIES

## MOUNTING DETAILS

### HINGE (PULL) SIDE MOUNTING

#### MAXIMUM OPENING

To 100°

Ⓐ = 6-11/16" (170mm)

Ⓑ = 12-7/16" (316 mm)

or 101° to 120°

Ⓐ = 5-11/16" (144mm)

Ⓑ = 11-7/16" (291 mm)

or \*121° to 180°

Ⓐ = 3-3/16" (81mm)

Ⓑ = 8-15/16" (227 mm)

Hold-open points up to maximum opening with hold-open arm.

\*Frame and trim permitting.

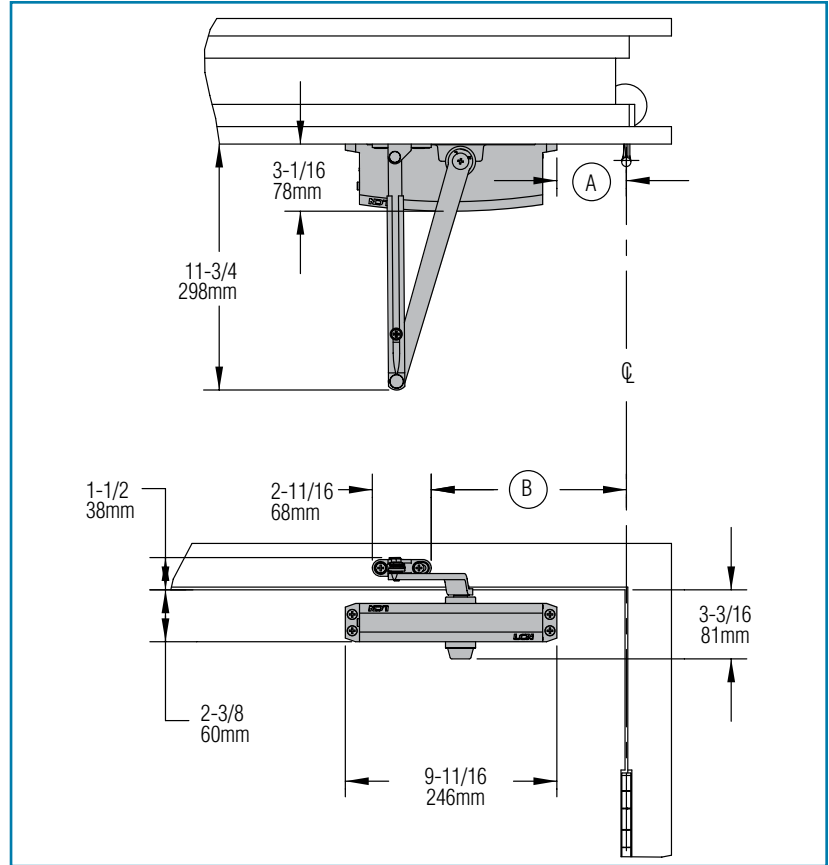

The 'A' dimension refers to the edge of the closer body to the center line of pivot or hinge.

The 'B' dimension refers to the edge of the closer shoe bracket to the center line of pivot or hinge.

- **Butt Hinges** should not exceed 5" (127 mm) in width.
- **Auxiliary Stop** is recommended at hold-open point or where a door cannot swing 180°.
- **Reveal** should not exceed 3/4" (19 mm) for regular arm or 1/2" (13 mm) for hold-open arm.
- **Top Rail** less than 2-3/8" (60mm) requires PLATE, 1250-18.
- **Clearance** of 3-1/16" (78mm) behind door required for installation.

#### Options

- Hold-open arm.
- Slim Line cover (SLIM).

#### Special Templates

Customized installation templates or products may be available to solve unusual applications. Contact LCN Product Support for assistance.

# 1250 SERIES

## MOUNTING DETAILS

### TOP JAMB (PUSH SIDE) MOUNTING

#### MAXIMUM OPENING

To 100°

Ⓐ = 7-3/16" (183mm)

Ⓑ = 12-15/16" (329 mm)

or 101° to 120°

Ⓐ = 5-11/16" (144mm)

Ⓑ = 11-7/16" (291 mm)

or \*121° to 180°

Ⓐ = 3-3/16" (81mm)

Ⓑ = 8-15/16" (227 mm)

Hold-open points up to maximum opening with hold-open arm.

\*Frame and trim permitting.

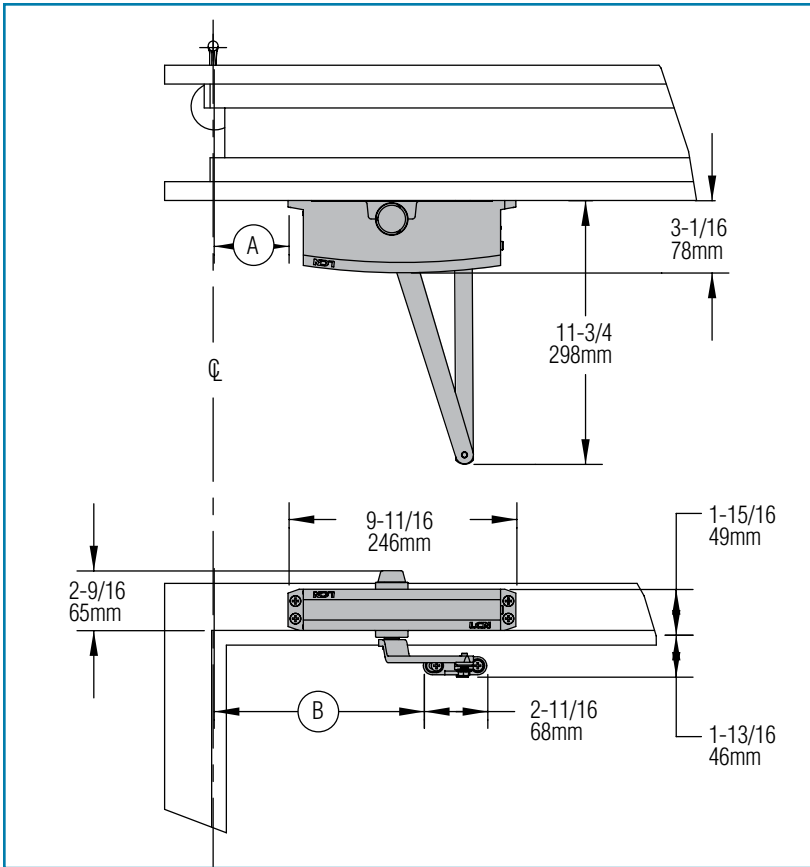

The 'A' dimension refers to the edge of the closer body to the center line of pivot or hinge.

The 'B' dimension refers to the edge of the closer shoe bracket to the center line of pivot or hinge.

- **Butt Hinges** should not exceed 5" (127 mm) in width.
- **Auxiliary Stop** is recommended at hold-open point or where a door cannot swing 180°.
- **Reveal**

Arm Type	Reveal	Max. Opening
Regular	0" to 5"	180°
Long	4" to 8"	165°
Hold-Open	0" to 2-3/4"	180°
Long Hold-Open	2" to 6-1/2"	180°

- **Top Rail** requires 1-3/4" (44 mm) minimum. 2-1/2" (64 mm) minimum with closer on PLATE, 1250-18.
- **Head Frame** less than 1-3/4" (44 mm) requires PLATE, 1250-18. For flush ceiling condition with 2" (51 mm) headframe, use PLATE, 1250-18. (Plate requires 1-3/8" (35 mm) minimum.)

#### Options

- Long arm, hold-open arm.
- Long hold-open arm.
- Slim Line cover (SLIM).

#### Special Templates

Customized installation templates or products may be available to solve unusual applications. Contact LCN Product Support for assistance.

# 1250 SERIES

## PARALLEL ARM (PUSH SIDE) MOUNTING

Optional mounting requires PA SHOE, 1250-62PA for REGULAR or HOLD-OPEN arms. 1250 Parallel arm closer includes 1250-201 FIFTH HOLE SPACER to support PA SHOE.

### MAXIMUM OPENING

Regular or hold-open arm can be templated to 100°

Ⓐ = 7-5/16" (186mm)

Ⓑ = 8-5/8" (219 mm)

or 101° to 130°

Ⓐ = 5-13/16" (148mm)

Ⓑ = 7-1/8" (181 mm)

or \*131° to 180°

Ⓐ = 3-13/16" (97mm)

Ⓑ = 5-1/8" (130 mm)

Hold-open points up to maximum opening with hold-open arm.

\*Frame and trim permitting.

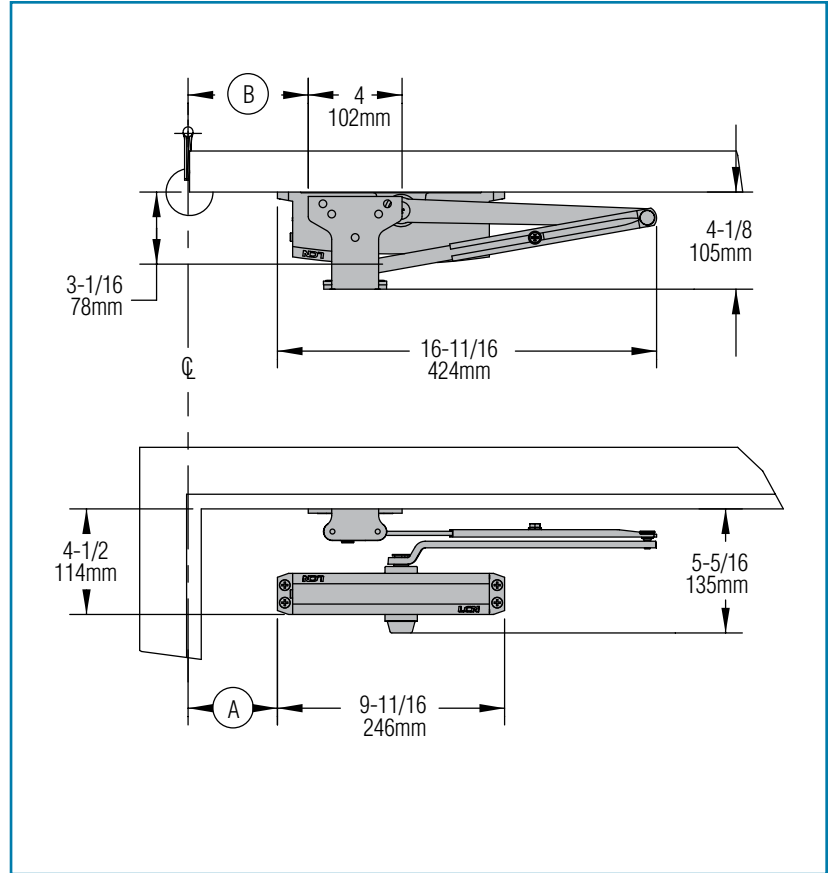

The 'A' dimension refers to the edge of the closer body to the center line of pivot or hinge.

The 'B' dimension refers to the edge of the closer shoe bracket to the center line of pivot or hinge.

## 1250 REGULAR OR HOLD-OPEN MOUNT

- **Butt Hinges** should not exceed 5" (127 mm) in width.
- **Auxiliary Stop** is recommended at hold-open point, where a door cannot swing 180°, or where CUSH-N-STOP arm is not used.
- **Clearance** for 1250-62PA shoe is 4-1/8" (105mm) from door face.
- **Top Rail** less than 4-1/2" (114mm) measured from the stop requires PLATE, 1250-18PA.
- **Stop Width** minimum 1" (25 mm).
- **Blade Stop** clearance, requires 1/2" (13 mm) BLADE STOP SPACER, 1250-61.
- **Auxiliary Shoe**, 1250-62A allows installation of regular arm with overhead holder/stop.

### Options

- Slim Line cover (SLIM).
- Hold-open PA, HEDA, EDA, CUSH, HCUSH, SCUSH, SHCUSH arm.

### Special Templates

Customized installation templates or products may be available to solve unusual applications. Contact LCN Product Support for assistance.

# 1250 SERIES

## 1250 EDA MOUNT

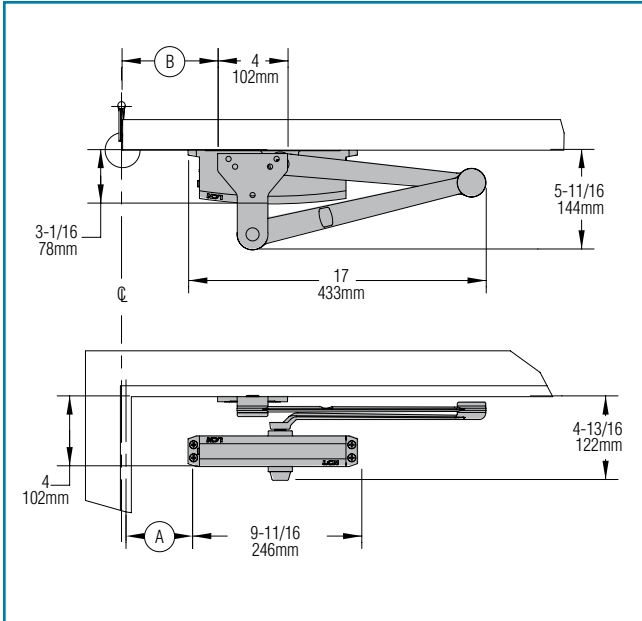

## 1250 EDA OR CUSH-N-STOP MOUNTING

1250 closers ordered with EDA, CUSH or SPRING CUSH arms include 1250-201 FIFTH HOLE SPACER to support the shoe.

### MAXIMUM OPENING

EDA template allows 180°. Hold-open point up to maximum opening.

100°

(A) = 7-5/16" (186mm)

(B) = 9" (229mm)

or 130°

(A) = 5-13/16" (148mm)

(B) = 7-1/2" (191mm)

or 180°

(A) = 3-13/16" (97 mm)

(B) = 5-1/2" (140 mm)

## 1250 CUSH /SCUSH MOUNT

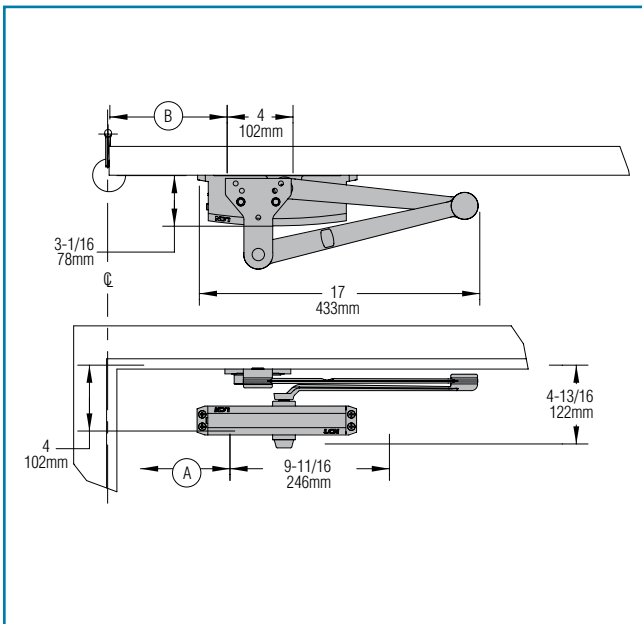

CUSH arms can be templated for maximum opening/hold-open point at 85°

(A) = 8-13/16" (224 mm)

(B) = 10-1/2" (267 mm)

90°

(A) = 8-1/16" (205 mm)

(B) = 9-3/4" (248 mm)

95°

(A) = 7-5/16" (186 mm)

(B) = 9" (229 mm)

100°

(A) = 6-11/16" (170 mm)

(B) = 8-3/8" (213 mm)

or 105°

(A) = 6-1/16" (154 mm)

(B) = 7-3/4" (197 mm)

or 110°

(A) = 5-7/16" (138 mm)

(B) = 7-1/8" (181 mm)

The 'A' dimension refers to the edge of the closer body to the center line of pivot or hinge.

The 'B' dimension refers to the edge of the closer shoe bracket to the center line of pivot or hinge.

- **Clearance** for 1250-62EDA or CUSH shoe is 5-11/16" (144mm) from door face.
- **Head Frame** flush or rabbeted requires CUSH FLUSH PANEL ADAPTER, 1250-419.
- **EDA or CUSH ARM** requires soffit SHOE SUPPORT, 1250-30 for fifth screw anchorage where reveal is less than 2-3/4" (70mm).
- **Spring CUSH** hold open points are approximately 5° less than dead stop point.

# 1250 SERIES

## CYLINDERS

### CYLINDER, 1250-3071

Standard, non-handed cast aluminum cylinder assembly.

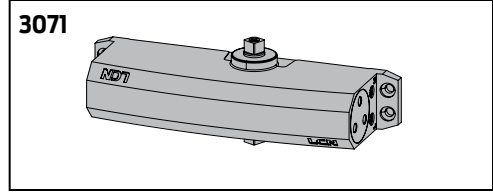

## ARMS

### REGULAR ARM, 1250-3077

Non-handed arm mounts hinge side or top jamb. Parallel Arm includes PA SHOE, 1250-62PA required for parallel arm mounting.

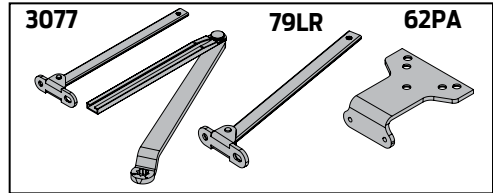

### PA SHOE, 1250-62PA

Required for parallel arm mounting.

### LONG ARM, 1250-3077L

Optional, non-handed arm includes LONG ROD AND SHOE, 1250-79LR for top jamb mount with deep reveals.

### HOLD-OPEN ARM, 1250-3049

Optional, non-handed arm mounts hinge side, top jamb or parallel arm (62PA required). Hold-open adjustable at shoe.

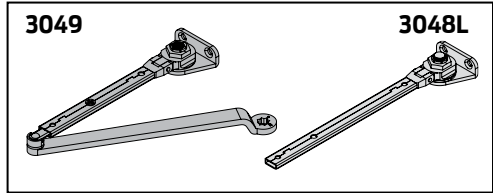

### LONG HOLD-OPEN ARM, 1250-3049L

Optional non-handed arm includes LONG HEAD AND TUBE, 1250-3048L for top jamb mount with deep reveals.

### EXTRA DUTY ARM, 1250-3077EDA, 1250-3077EDA/G,

Optional, non-handed parallel arm features solid forged steel main and forearm for potentially abusive installations. Optional 1250-3077EDA/G for blade stop clearance.

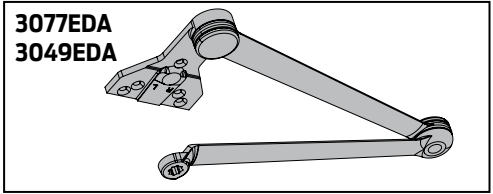

### HEDA ARM, 1250-3049EDA

Optional handed arm, provides hold-open function adjustable at shoe.

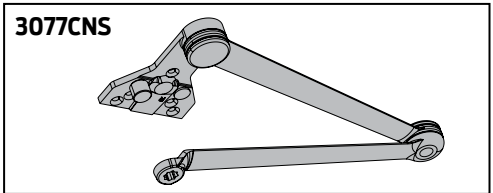

### CUSH-N-STOP® ARM, 1250-3077CNS

Optional, non-handed parallel arm features solid forged steel main arm and forearm with stop in soffit shoe.

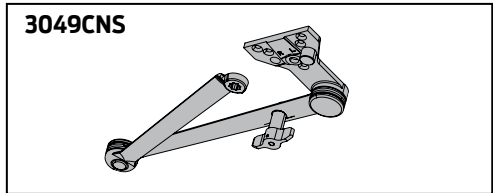

### HCUSH ARM, 1250-3049CNS

Optional non-handed arm, provides hold-open function with templated stop/hold-open points. Handle controls hold-open function.

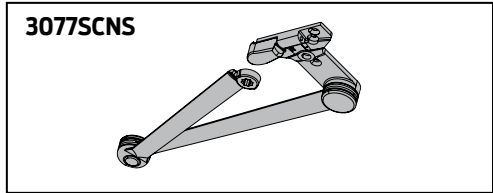

### Spring Cush Arm, 1250-3077SCNS

Optional, non-handed parallel arm for abusive applications features solid forged steel main arm and forearm with spring loaded stop in the soffit shoe. Spring CUSH Arm hold open points are approximately 5° less than dead stop point.

### Spring HCush Arm, 1250-3049SCNS

Optional, non-handed parallel arm for abusive applications features solid forged steel main arm and forearm with spring loaded stop in the soffit shoe. Handle controls hold-open function.

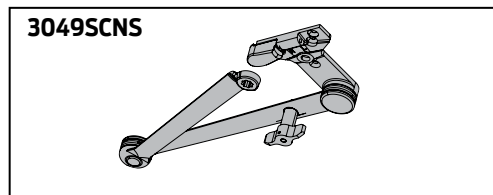



# 1250 SERIES

## ACCESSORIES

### COVER

#### COVER, 1250-72

Optional, non-handed, slim line plastic cover.

### INSTALLATION ACCESSORIES

#### PLATE, 1250-18

Required for hinge side mount where top rail is less than 2-3/8" (60mm).

Required for top jamb mounting where head frame is less than 1-3/4" (44 mm) or flush ceiling condition exists.

Plate requires minimum 1-1/2" (38 mm) minimum top rail or 1-1/4" (32 mm) head frame.

#### PLATE, 1250-18PA

Required for parallel arm mounting where top rail is less than 4-1/2" (114mm), measured from the stop.

Plate requires 1-3/4" (44 mm) minimum top rail.

#### CUSH SHOE SUPPORT, 1250-30

Provide anchorage for fifth screw used with CUSH arms where reveal is less than 2-3/4" (70mm).

#### BLADE STOP SPACER, 1250-61

Lowers parallel arm shoe to clear 1/2" (13 mm) blade stop.

#### AUXILIARY SHOE, 1250-62A

Requires a top rail of 7-1/8" (181mm). Optional shoe replaces -62PA for parallel arm mounting of regular arm with overhead holder/stop.

#### FLUSH PANEL ADAPTER, 1250-419

Provides horizontal mounting surface for PA, EDA or CUSH shoe on single rabbeted or flush frame.

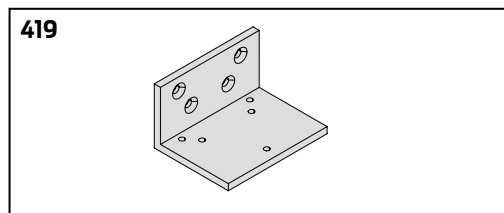
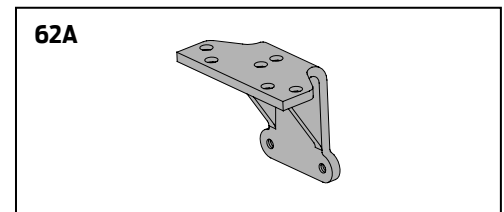
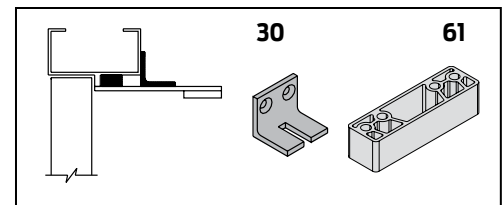
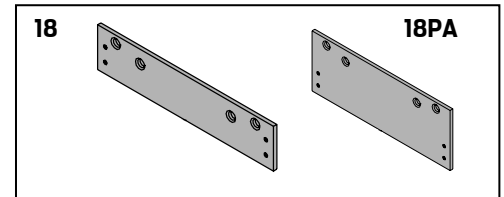
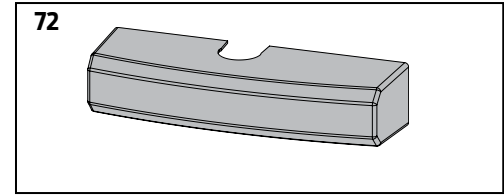

# 1250 SERIES

## TABLE OF SIZES

Select closer based on width of door.  
The spring power of a 1250 cylinder is field adjustable from size 1 through size 5 and is shipped adjusted to size 3.

### EXTERIOR (and VESTIBULE) DOOR WIDTH

	24" 610mm	30" 762mm	36" 914mm	42" 1067mm
		size 3	size 4	size 5
*1250				
Minimum Door Width				

### INTERIOR DOOR WIDTH

	24" 610mm	34" 864mm	38" 965mm	48" 1219mm	54" 1372mm
		size 2	size 3	size 4	size 5
*1250					
Minimum Door Width					

\* Adjustable Size 1 thru 5

Indicates recommended range of door width for closer size.

## REDUCED OPENING FORCE 1250 CLOSERS

**CAUTION!** Any manual door closer, including those certified by BHMA to conform to ANSI Standard A156.4, that is selected, installed and adjusted based on ADA or other reduced opening force requirements may not provide sufficient power to reliably close and latch a door.

Refer to POWER OPERATORS section for information on systems that meet reduced opening force requirements without affecting closing power.

	DOOR WIDTH	36"	42"	48"
	8.5* lbs.	1250	1250	1250
	5.0* lbs.	1250	1250	1250

\* Maximum opening force.

## HOW-TO-ORDER 1250 SERIES CLOSERS

### 1. SELECT FINISH

- Standard Powder Coat \_\_\_\_\_  
Aluminum, Dark Bronze, Statuary,  
Light Bronze, Black, Brass.

### Closer will be shipped with:

- STANDARD CYLINDER
  - STANDARD COVER
  - TRI PACK ARM
  - UNIVERSAL SCREW PACK
- unless options listed below are selected.*

## CLOSER OPTIONS

### COVER

- Slim line cover (SLIM)

### FINISH

- Custom RAL\_\_\_\_
- SRI primer

### ARM

#### SCUSH / HCUSH

- Regular w/62PA (Rw/PA)
- Long (LONG)
- Regular w/62A (R/62A)
- Hold-Open w/62PA (Hw/PA)
- Long Hold-Open (HLONG)
- HEDA (specify right or left hand),
- Cush-N-Stop (CUSH)
- HCush (HCUSH)
- Spring CUSH (SCUSH)
- Spring HCUSH (SHCUSH)
- EDA

### SPECIAL TEMPLATE

- ST- \_\_\_\_\_

### OPTIONAL SCREW PACKS

- TORX Machine Screw (TORX)
  - TB\* & TORX Machine Screw (TBTORX)
- \* Specify door thickness if other than 1-3/4".

### MEETS BUY AMERICAN ACT

- BAA

### INSTALLATION ACCESSORIES

- Plate, 1250-18
- Plate, 1250-18PA
- CUSH Shoe Support, 1250-30
- Blade Stop Spacer, 1250-61
- Auxiliary Shoe, 1250-62A
- PA Flush Panel Adapter, 1250-419

# 1450 SERIES

## FEATURES

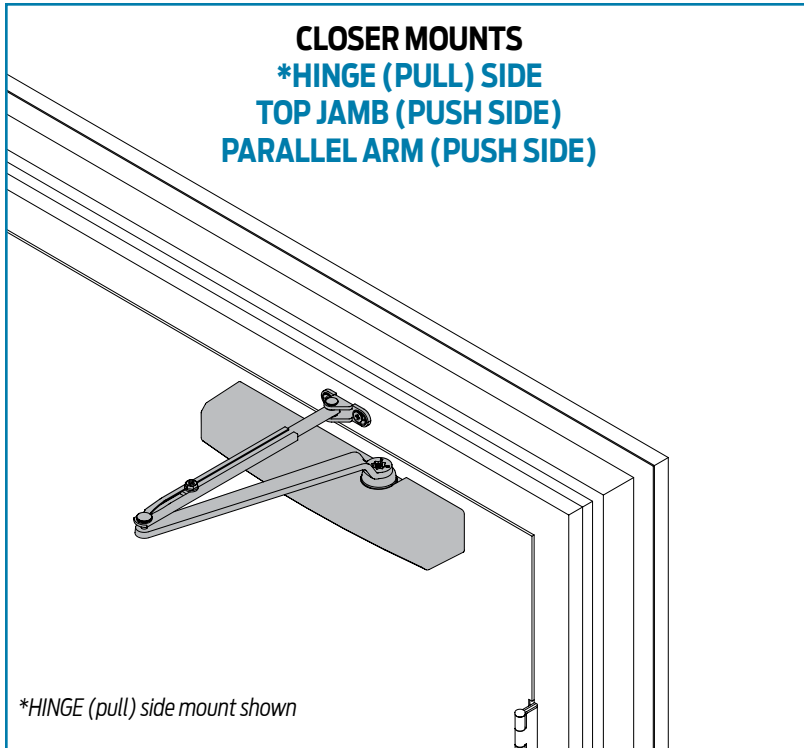

The 1450 Series cast aluminum closer was specially designed to deliver consistent, dependable, long-term performance in frequently-used, low-abusive traffic areas. The patented design, featuring the industry's most common hole pattern, is an excellent choice for a range of applications - from aftermarket replacement to aluminum store fronts, to new construction projects - anywhere quality, reliability and value are important.

- Standard 1450 series closer shipped with tri-pack arms; regular, parallel and top jamb arms, slim line plastic cover and universal screw pack: self-reaming and tapping; 1 3/4" thru bolts; machine screws and wood screws.
- Cover options include; Standard (plastic slim line), optional full metal cover or full plastic cover.
- Non-sized (1-6) cylinder is adjustable for interior doors to 5'0" and exterior doors to 4'0".
- Closer mounts hinge side, top jamb and parallel arm on either right or left swinging doors.
- Closer meets ADA requirements. See 1450 Series page 18.
- Optional plated finish full metal cover, arm and fasteners.
- Tested and certified under ANSI Standard A156.4, grade one.
- Optional SRI primer for installations in corrosive conditions.

- Cast Aluminum
- All weather fluid
- Non-handed
- Peel-n-stick templates for fast and accurate installation
- UL and cUL listed
- Adjustable spring size 1-6
- 25 Year Warranty
- Patent pending design

MOUNTING					FINISH			COVER		CYLINDER				*ARM FUNCTION					
HINGE (PULL) SIDE	TOP JAMB (PULL)	TOP JAMB (PUSH)	PARALLEL ARM	STOP FACE	PAINT	POWDER COAT	PLATED	PLASTIC	METAL	NON-HANDED	NON-SIZED	ACCESSIBILITY	DELAYED ACTION	REGULAR (DOUBLE)	STANDARD (SINGLE)	HOLD-OPEN*	EDA/HEDA*	CUSH/HCUSH	SCUSH/SHCUSH
●	○	●	●	○	●	●	●	●	●	●	○	●	●	180°	○	180°	180°	110°	110°

● AVAILABLE  
○ NOT AVAILABLE

♿ Closer available with less than 5.0 lbs. opening force on 36" door.

\* Maximum opening/hold-open point with standard template; when conditions allow.

# 1450 SERIES

## HINGE (PULL) SIDE MOUNTING

### MAXIMUM OPENING

100°

Ⓐ = 7" (102 mm)

Ⓑ = 12-3/8" (314 mm)

100° to 130°

Ⓐ = 5-1/2" (140 mm)

Ⓑ = 10-7/8" (276 mm)

130° to 180°

Ⓐ = 4" (102 mm)

Ⓑ = 9-3/8" (238 mm)

Hold-open points up to maximum opening with hold-open arm.

*\*Frame and trim permitting.*

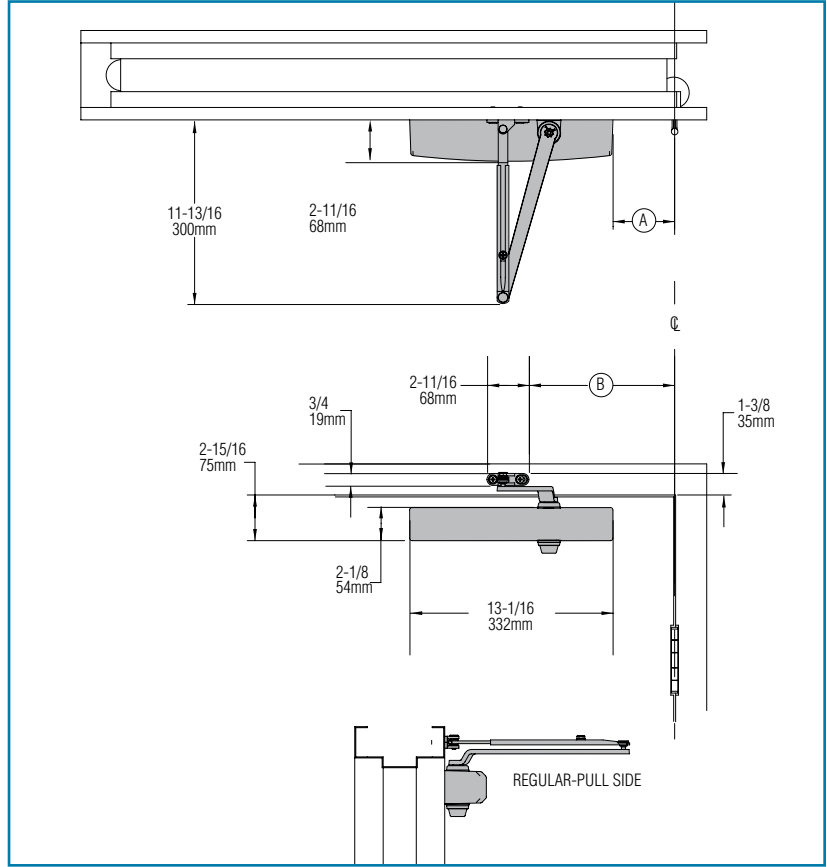

The 'A' dimension refers to the edge of the closer body to the center line of pivot or hinge.  
The 'B' dimension refers to the edge of the closer shoe bracket to the center line of pivot or hinge.

### Options

- Delayed action cylinder.
- Hold-open arm.
- Full metal cover. (MC)
- Full plastic cover. (FC)

### Special Templates

Customized installation templates or products may be available to solve unusual applications. Contact LCN Product Support for assistance.

- **Butt Hinges** should not exceed 5" (127 mm) in width.
- **Auxiliary Stop** is recommended at hold-open point or where a door cannot swing 180°.
- **Reveal** should not exceed 3/4" (19 mm) for regular arm or 1/2" (13 mm) for hold-open arm.
- **Top Rail** less than 2-1/2" (64 mm) requires PLATE, 1450-18. With Full cover, use PLATE, 1450-18FC. Plate requires 1-1/2" (38 mm) minimum.
- **Clearance** of 2-3/8" (60 mm) behind door required for installation.
- **Delayed Action**

Maximum Opening	Delayed Action Release
100°	62°
130°	66°
180°	73°

# 1450 SERIES

## TOP JAMB (PUSH SIDE) MOUNTING

### MAXIMUM OPENING

100°

Ⓐ = 7" (102 mm)

Ⓑ = 12-3/8" (314 mm)

100° to 130°

Ⓐ = 5-1/2" (140 mm)

Ⓑ = 10-7/8" (276 mm)

130° to 180°

Ⓐ = 4" (102 mm)

Ⓑ = 9-3/8" (238 mm)

Hold-open points up to maximum opening with hold-open arm.

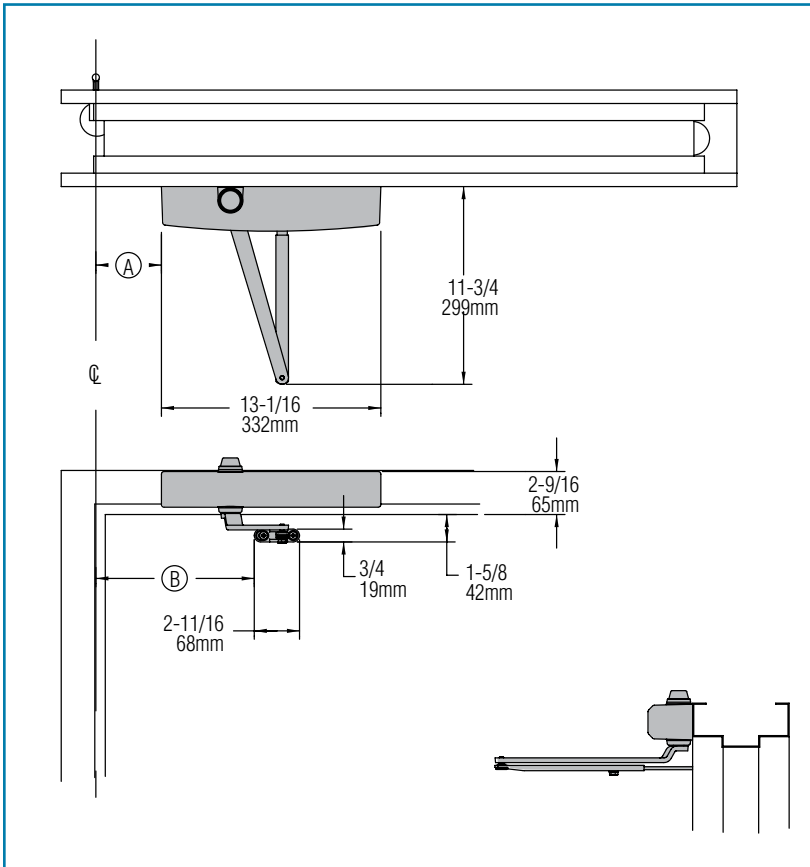

The 'A' dimension refers to the edge of the closer body to the center line of pivot or hinge.

The 'B' dimension refers to the edge of the closer shoe bracket to the center line of pivot or hinge.

- **Butt Hinges** should not exceed 5" (127 mm) in width.
- **Auxiliary Stop** is recommended at hold-open point or where a door cannot swing 180°.
- **Reveal**

Arm Type	Reveal	Max. Opening
Regular Arm	5"	Up to 170°
Regular Arm	3-3/4"	Up to 180°
Long Arm	8"	Up to 155°
Hold Open Arm	2-3/4"	Up to 180°
Long Hold-Open Arm	4-7/8"	Up to 140°

- **Top Rail** requires 2-1/8" (54 mm) minimum. 3-3/8" (86 mm) minimum with closer on PLATE, 1450-18.
- **Head Frame** less than 1-3/4" (44 mm) requires PLATE, 1450-18. For flush ceiling condition with 1-3/4" (45 mm) headframe, use PLATE, 1450-18.
- **Delayed Action**

Maximum Opening	Delayed Action Release
100°	74°
130°	83°
180°	90°

### Options

- Delayed action cylinder.
- Long arm, hold-open arm, long hold-open arm.
- Full metal cover. (MC)
- Full plastic cover. (FC)

### Special Templates

Customized installation templates or products may be available to solve unusual applications. Contact LCN Product Support for assistance.

# 1450 SERIES

## MOUNTING DETAILS

### PARALLEL ARM (PUSH SIDE) MOUNTING

Optional mounting requires PA SHOE, 1450-62PA for REGULAR or HOLD-OPEN arms. 1450 closer includes 1450-201 FIFTH HOLE SPACER to support PA SHOE.

### MAXIMUM OPENING

To 120°

Ⓐ = 3-3/16" (81 mm)

Ⓑ = 8-7/8" (225 mm)

120° to 180°

Ⓐ = 11/16" (17 mm)

Ⓑ = 6-3/8" (162 mm)

Hold-open points up to maximum opening with hold-open arm.

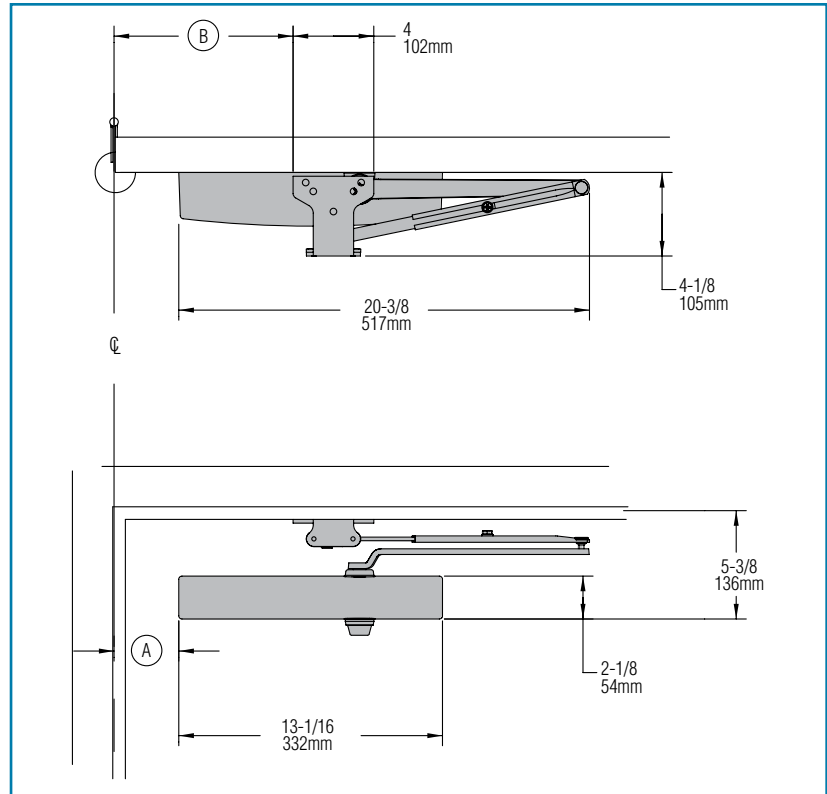

The 'A' dimension refers to the edge of the closer body to the center line of pivot or hinge.

The 'B' dimension refers to the edge of the closer shoe bracket to the center line of pivot or hinge.

### Options

- Delayed action cylinder.
- Hold-open, EDA, HEDA, CUSH, HCUSH, SPRING CUSH, or SPRING HCUSH arms.
- Full metal cover. (MC)
- Full plastic cover. (FC)

### Special Templates

Customized installation templates or products may be available to solve unusual applications. Contact LCN Product Support for assistance.

## 1450 REGULAR OR HOLD-OPEN MOUNT

- **Butt Hinges** should not exceed 5" (127 mm) in width.
- **Auxiliary Stop** is recommended at hold-open point, where a door cannot swing 180°, or where CUSH-N-STOP arm is not used.
- **Clearance** for 1450-62PA shoe is 4-1/8" (105 mm) from door face.
- **Top Rail** less than 5-1/4" (133 mm) measured from the soffit requires plate. Plates require 1-1/4" (32 mm) minimum.

Cover	Minimum Top Rail (measured from soffit)	Plate Required
Plastic	3-1/2" (89 mm)	1450-18
	2-1/4" (57 mm)	1450-18PA
Metal	3-1/2" (89 mm)	1450-18FC
	2-1/4" (57 mm)	1450-18PAFC

- **Head Frame** flush or single rabbeted requires PA SHOE ADAPTER, 1450-418.
- **Stop Width** minimum 1" (25 mm).
- **Blade Stop** clearance, requires 1/2" (13 mm) BLADE STOP SPACER, 1450-61.
- **Auxiliary Shoe**, 1450-62A allows installation of regular arm with overhead holder/stop.
- **Delayed Action**

Maximum Opening	Delayed Action Release
120°	65°
180°	73°

# 1450 SERIES

## 1450 EDA / HEDA MOUNT

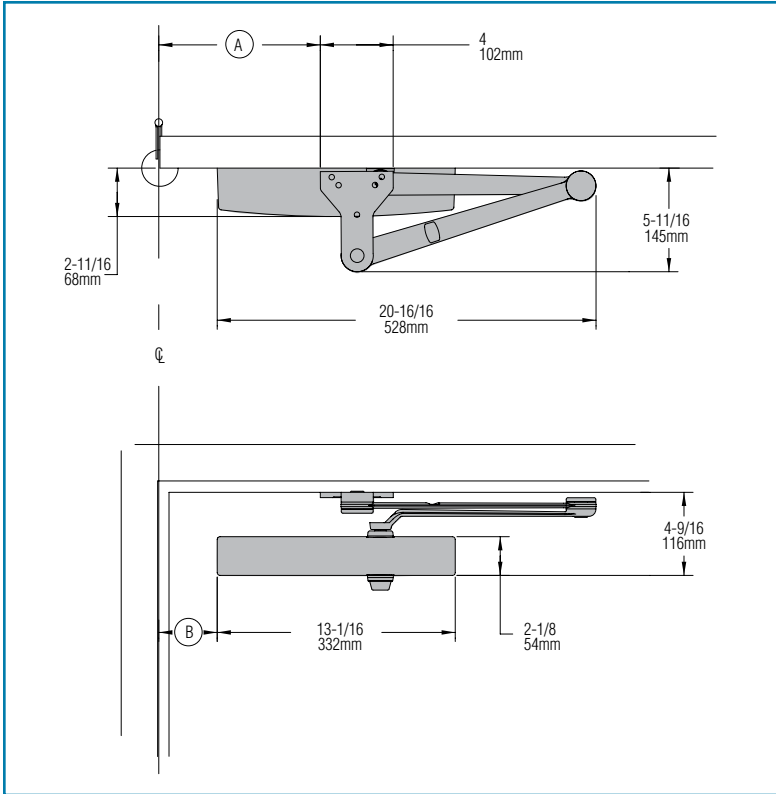

## 1450 EDA OR CUSH-N-STOP MOUNTING

1450 closers ordered with EDA, CUSH or SPRING CUSH arms include 1450-201 FIFTH HOLE SPACER to support the shoe.

### MAXIMUM OPENING

EDA template allows 110°. Hold-open point up to maximum opening.

120°,

Ⓐ = 8-7/8" (225 mm)

Ⓑ = 3-3/16" (81 mm)

over 120°.

Ⓐ = 6-3/8" (162 mm)

Ⓑ = 11/16" (17 mm)

CUSH arms can be templated for maximum opening/hold-open point at:

85°,

Ⓐ = 10-3/8" (279 mm)

Ⓑ = 4-15/16" (140 mm)

90°,

Ⓐ = 9-5/8" (244 mm)

Ⓑ = 4-3/16" (106 mm)

95°,

Ⓐ = 8-7/8" (225 mm)

Ⓑ = 3-7/16" (87 mm)

or 100°.

Ⓐ = 8-1/4" (210 mm)

Ⓑ = 2-13/16" (71 mm)

105°,

Ⓐ = 7-5/8" (194 mm)

Ⓑ = 2-3/16" (56 mm)

110°,

Ⓐ = 7" (178 mm)

Ⓑ = 1-9/16" (40 mm)

## 1450 CUSH / HCUSH / SCUSH / SHCUSH MOUNT

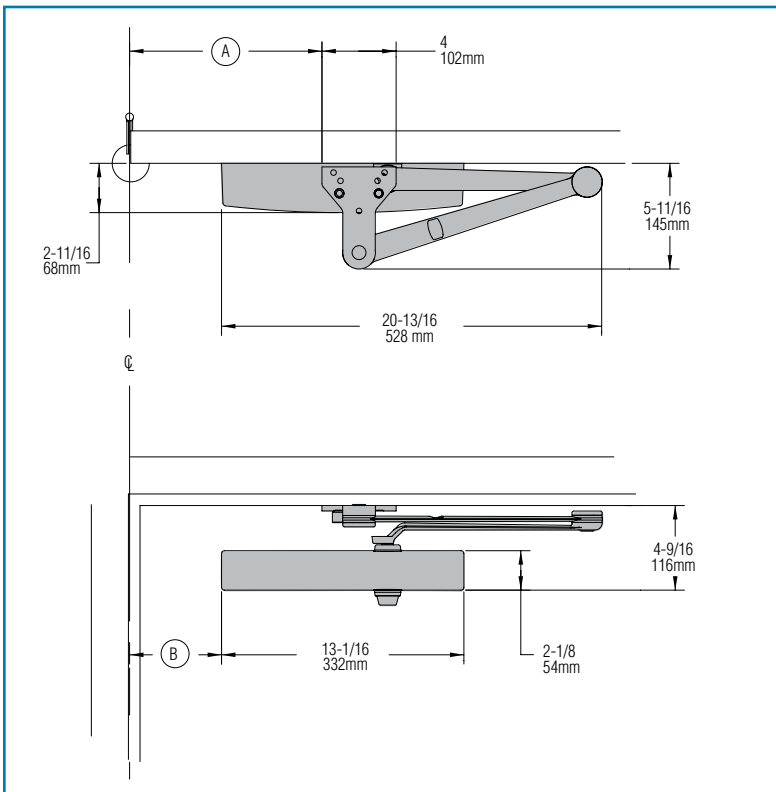

The 'A' dimension refers to the edge of the closer body to the center line of pivot or hinge.

The 'B' dimension refers to the edge of the closer shoe bracket to the center line of pivot or hinge.

- **Spring CUSH** hold open points are approximately 5° less than dead stop point.
- **Clearance** for 1450-62EDA or CUSH shoe is 5-11/16" (144 mm) from door face.
- **Head Frame** flush or rabbeted requires PA FLUSH PANEL ADAPTER, 1450-419.
- **EDA or CUSH ARM** requires SHOE SUPPORT, 1450-30 for fifth screw anchorage where reveal is less than 3-1/16" (78 mm).

# 1450 SERIES

## CYLINDERS

### CYLINDER, 1450-3071

Standard, non-handed cast aluminum cylinder assembly.

### CYLINDER, 1450-3071DEL

Cylinder used for delayed action options.

## ARMS

### REGULAR ARM, 1450-3077

Non-handed arm mounts hinge side or top jamb.

P1450 closer includes PA SHOE, 1450-62PA required for parallel arm mounting.

### PA SHOE, 1450-62PA

Required for parallel arm mounting.

### LONG ARM, 1450-3077L

Optional, non-handed arm includes LONG ROD AND SHOE, 1450-79LR for top jamb mount with deep reveals.

### HOLD-OPEN ARM, 1450-3049

Optional, non-handed arm mounts hinge side, top jamb or parallel arm (62PA required). Hold-open adjustable at shoe.

### LONG HOLD-OPEN ARM, 1450-3049L

Optional non-handed arm includes LONG HEAD AND TUBE, 1450-3048L for top jamb mount with deep reveals.

### EXTRA DUTY ARM, 1450-3077EDA, 1450-3077EDA/62G

Optional, non-handed parallel arm features solid forged steel main and forearm for potentially abusive installations. Optional 1450-3077EDA/62G for blade stop clearance.

### HEDA ARM, 1450-3049EDA

Optional handed arm, provides hold-open function adjustable at shoe.

### CUSH-N-STOP® ARM, 1450-3077CNS

Optional, non-handed parallel arm features solid forged steel main arm and forearm with stop in soffit shoe.

### HCUSH ARM, 1450-3049CNS

Optional non-handed arm, provides hold-open function with templated stop/hold-open points. Handle controls hold-open function.

### SPRING CUSH ARM, 1450-3077SCNS

Optional, non-handed parallel arm for abusive applications features solid forged steel main arm and forearm with spring loaded stop in the soffit shoe.

### SPRING HCUSH ARM, 1450-3049SCNS

Optional, non-handed parallel arm for abusive applications features solid forged steel main arm and forearm with spring loaded stop in the soffit shoe. Handle controls hold-open function.

3071

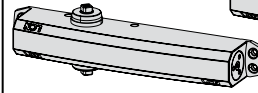

3071DEL

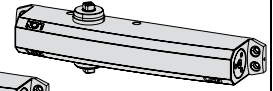

3077

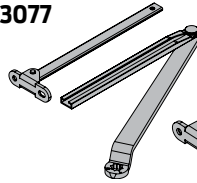

79LR

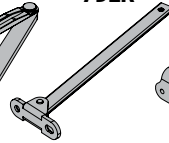

62PA

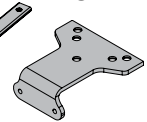

3049

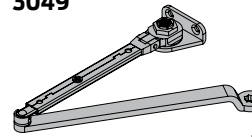

3048L

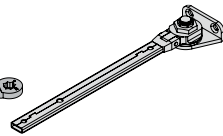
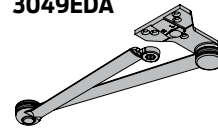
3077EDA  
3049EDA

3077EDA/62G

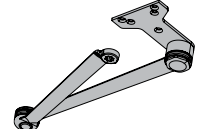

3077CNS

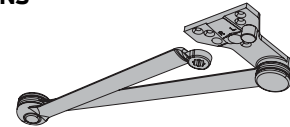

3049CNS

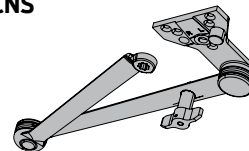

3077SCNS

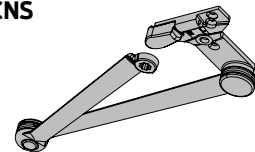

3049SCNS

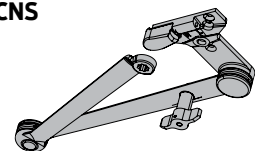



# 1450 SERIES

## COVERS

### COVER, 1450-72

Standard, non-handed, slim line plastic cover with feature strip.

### FULL METAL COVER, 1450-72MC

Optional, handed metal cover provides complete enclosure.

### FULL PLASTIC COVER, 1450-72FC

Optional, non-handed, full plastic cover.

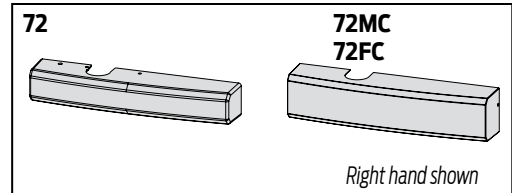

## INSTALLATION ACCESSORIES

### PLATE, 1450-18/1450-18FC

Required for hinge side mount where top rail is less than 2-1/2" (64 mm). Required for top jamb mounting where head frame is less than 1-3/4" (44 mm) or flush ceiling condition exists. Plate requires minimum 1-1/2" (38 mm) minimum top rail or 1-1/4" (32 mm) head frame. With full cover, use PLATE, 1450-18FC.

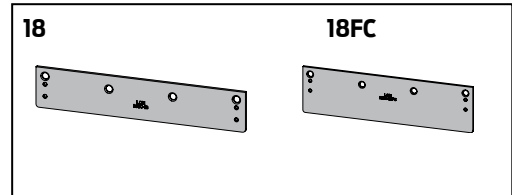

### PLATE, 1450-18PA/1450-18PAFC

Required for parallel arm mounting where top rail is less than 4-3/8" (111 mm), measured from the stop. Plate requires 1-3/4" (44 mm) minimum top rail. With full cover, use PLATE, 1450-18PAFC.

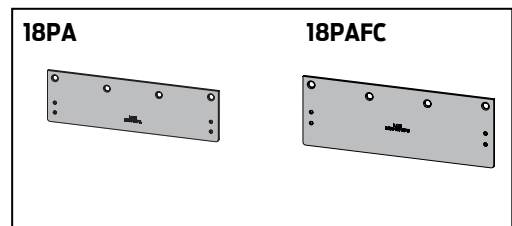

### CUSH SHOE SUPPORT, 1450-30

Provide anchorage for fifth screw used with CUSH arm where reveal is less than 3-1/16" (78 mm).

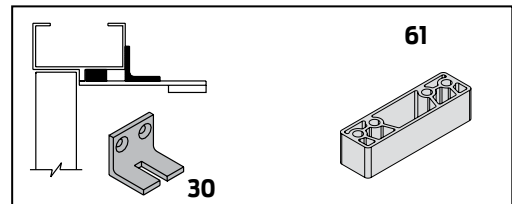

### BLADE STOP SPACER, 1450-61

Lowers parallel arm shoe to clear 1/2" (13 mm) blade stop.

### AUXILIARY SHOE, 1450-62A

Requires a top rail of 7" (178 mm). Optional shoe replaces -62PA for parallel arm mounting of regular arm with overhead holder/stop.

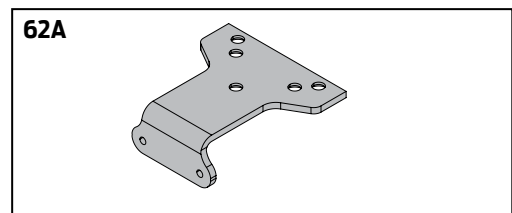

### FLUSH PANEL ADAPTER, 1450-419

Provides horizontal mounting surface for PA, EDA, or CUSH shoe on single rabbeted or flush frame.

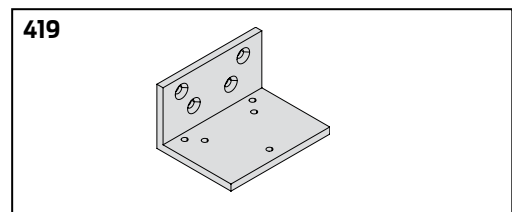

# 1450 SERIES

## TABLE OF SIZES

Select closer based on width of door.  
The spring power of a 1450 cylinder is field adjustable from size 1 through size 6 and is shipped adjusted to size 3.

### EXTERIOR (and VESTIBULE) DOOR WIDTH

	24"	30"	36"	42"	48"
	610mm	762mm	914mm	1067mm	1219mm
	size 3	size 4	size 5	size 6	
*1450	→				
Minimum Door Width					

### INTERIOR DOOR WIDTH

	24"	34"	38"	48"	54"	60"
	610mm	610mm	965mm	1219mm	1372mm	1524mm
	size 2	size 3	size 4	size 5	size 6	
*1450	→					
Minimum Door Width						

\* Adjustable Size 1 thru 6

→ Indicates recommended range of door width for closer size.

## REDUCED OPENING FORCE 1450 CLOSERS

**CAUTION!** Any manual door closer, including those certified by BHMA to conform to ANSI Standard A156.4, that is selected, installed and adjusted based on ADA or other reduced opening force requirements may not provide sufficient power to reliably close and latch a door.

Refer to POWER OPERATORS section for information on systems that meet reduced opening force requirements without affecting closing power.

	DOOR WIDTH	36"	42"	48"
	8.5* lbs.	1450	1450	1450
	5.0* lbs.	1450	1450	1450

\* Maximum opening force.

## HOW TO ORDER 1450 SERIES CLOSERS

### I. SELECT FINISH

- Standard Powder Coat \_\_\_\_\_  
Aluminum, Dark Bronze, Statuary,  
Light Bronze, Black, Brass.

### Closer will be shipped with:

- STANDARD CYLINDER
  - STANDARD COVER
  - TRI PACK ARM
  - UNIVERSAL SCREW PACK
- unless options listed below are selected.*

## CLOSER OPTIONS

### CYLINDER

- Delayed Action (DEL)

### COVER

- Full Metal cover (MC)
- Full Plastic cover (FC)

### FINISH

- Custom (RAL) \_\_\_\_\_  
(Metal cover required)
- Plated Finish, US \_\_\_\_\_  
(Metal cover required)
- SRI primer

### ARM

- Regular w/62PA (Rw/PA)
- Long (LONG)
- Regular w/62A (Rw/62A)
- Hold-Open w/62PA (Hw/PA)
- Long Hold-Open (HLONG)
- EDA (optional -62G)
- HEDA (specify right or left hand)
- Cush-N-Stop (CUSH)
- HCush (HCUSH)
- Spring Cush (SCUSH)
- Spring HCush (SHCUSH)

### OPTIONAL SCREW PACKS

- TORX Machine Screw (TORX)
  - TB\* & TORX Machine Screw (TBTORX)
- \* Specify door thickness if other than 1-3/4".

### SPECIAL TEMPLATE

- ST- \_\_\_\_\_

### MEETS BUY AMERICAN ACT

- BAA

### INSTALLATION ACCESSORIES

- Plate, 1450-18
- Plate, 1450-18FC
- Plate, 1450-18PA
- Plate, 1450-18PAFC
- CUSH Shoe Support, 1450-30
- Blade Stop Spacer, 1450-61
- Auxiliary Shoe, 1450-62A
- PA Flush Panel Adapter, 1450-419