

SDC Security Door Controls

801 Avenida Acaso, Camarillo, Ca. 93012 • (805) 494-0622 •
www.sdcsecurity.com • E-mail: service@sdsecurity.com

LRAR1R INSTALLATION INSTRUCTIONS REX SWITCH ASSEMBLY ADAMS RITE MODELS: 3100, 3600, 3700, 8100, 8200, 8500, 8600 & 8700

Use the existing screw located on front of the cover
to attach the LRA1R Switch Assembly where shown.

NOTE:

Remove E.L.R. Assy. from device for
proper installation

Existing E.L.R.
Cover Screw

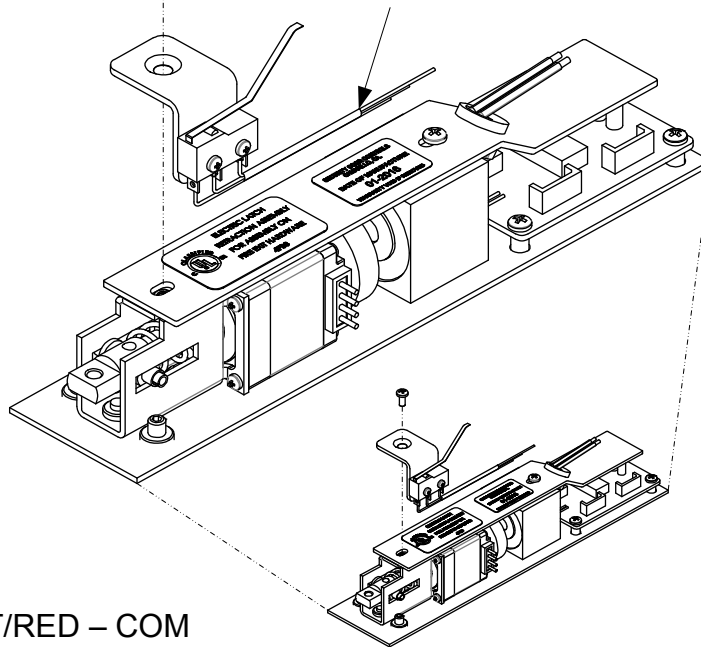

WHT/RED – COM
ORG/RED – N/O
YEL/RED – N/C
5 AMP @ 125 VAC
RESISTIVE

Any suggestions or comments to this instruction or
product are welcome. Please contact us through
our website or email engineer@sdsecurity.com