

MLRK1-CAL

INSERT INSTRUCTIONS

The Command Access MLRK1 is a field installable motorized latch-retraction kit for:

- MRLK1-CAL - Cal Royal 9800/2200 series devices

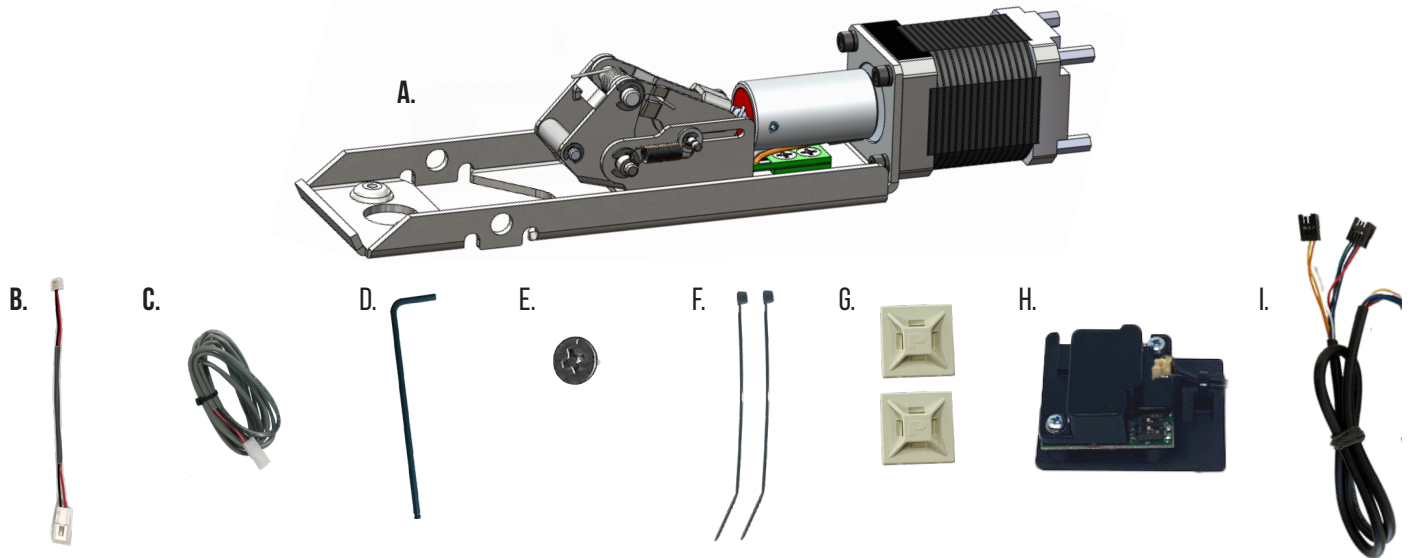

KIT INCLUDES

- | | |
|---------------------------------------|--|
| A. 1- MOTOR MOUNT | F. 2- 40060 - CABLE TIE |
| B. 1- 50944 - MOLEX PIGTAIL | G. 2- 40059 - MOUNTING PAD |
| C. 1- 50030 - 6' LEAD W/ VD CONNECTOR | H. 1- 60368/51186 - REMOTE MM4S MODULE |
| D. 1- 10017 5/64" ALLEN WRENCH | I. 1- 50741 - REMOTE MODULE CABLE |
| E. 2- 40064 - PHILLIPS SCREWS | |



INSTALLATION VIDEO

SPECIFICATIONS

- INPUT VOLTAGE: 24VDC +/- 10%
- AVERAGE **LOW** TORQUE LATCH RETRACTION CURRENT: 900 MA
- AVERAGE **HIGH** TORQUE LATCH RETRACTION CURRENT: 2A
- AVERAGE HOLDING CURRENT: 215 MA
- WIRE GAUGE: MINIMUM 18 GAUGE
- DIRECT WIRE RUN - NO RELAYS OR ACCESS CONTROL UNITS IN-BETWEEN POWER SUPPLY & MODULE

RECOMMENDED POWER SUPPLIES: USE A POWER LIMITED CLASS 2 POWER SUPPLY

ALL COMMAND ACCESS EXIT DEVICES & FIELD INSTALLABLE KITS HAVE BEEN THOROUGHLY CYCLE TESTED WITH COMMAND ACCESS POWER SUPPLIES AT OUR FACTORY. IF YOU PLAN ON USING A NON-COMMAND POWER SUPPLY IT MUST BE A FILTERED & REGULATED LINEAR POWER SUPPLY.

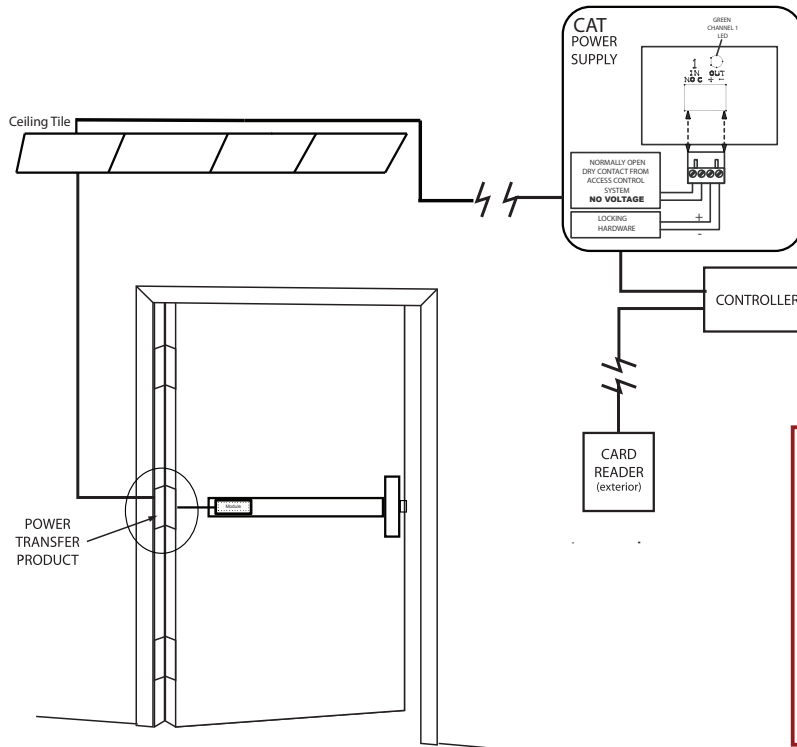

SETTING PTS

****IMPORTANT INFO****

MAKE SURE TO SET PTS BEFORE FINISHING INSTALLATION

- STEP 1-** SELECT YOUR PREFERRED TORQUE MODE (SHIPS IN STANDARD TORQUE) PRESS THE DEVICE PUSH PAD TO THE DESIRED SETTING. (RECOMMEND TO FULLY DEPRESS AND RELEASE 5%, GIVING THE DEVICE ROOM FOR CHANGING DOOR CONDITIONS.)
- STEP 2-** WHILE DEPRESSING THE PUSH PAD, APPLY POWER. (I.E. PRESENTING THE CREDENTIAL TO THE READER).
- STEP 3-** CONTINUE TO KEEP PAD DEPRESSED, THE DEVICE WILL BEEP 6 TIMES. AFTER THE BEEPS HAVE STOPPED, RELEASE THE PAD AND NOW THE ADJUSTMENT IS COMPLETE. IF NOT TO YOUR LIKING REPEAT THE 3 STEPS.
- STEP 4-** ONCE YOU FOUND THE CORRECT LOCATION, TURN PTS SWITCH TO OFF POSITION.

TROUBLESHOOTING & DIAGNOSTICS

BEEPS	EXPLANATION	SOLUTION
2 BEEPS	OVER VOLTAGE	> 30V UNIT WILL SHUT DOWN. CHECK VOLTAGE & ADJUST TO 24 V.
3 BEEPS	UNDER VOLTAGE	< 20V UNIT WILL SHUT DOWN. CHECK VOLTAGE & ADJUST TO 24 V.
4 BEEPS	FAILED SENSOR	VERIFY ALL 3 SENSOR WIRES ARE INSTALLED CORRECTLY. REPLACE SENSOR IF PROBLEM PERSISTS BY CONTACTING OFFICE.
5 BEEPS	RETRACTION OR DOGGING FAILURE	AFTER 1ST FAIL: 5 BEEPS THEN IMMEDIATELY ATTEMPTS TO RETRACT AGAIN. AFTER 2ND FAIL: 5 BEEPS WITH PAUSE IN-BETWEEN FOR 30 SECONDS THEN DEVICE ATTEMPTS TO RETRACT AGAIN. AFTER 3RD FAIL: 5 BEEPS EVERY 7 MINUTES, DEVICE WILL NOT ATTEMPT TO RETRACT. TO RESET: DEPRESS BAR FOR 5 SECONDS AT ANY TIME.
6 BEEPS	PUSH TO SET	DEVICE IS RECORDING IT'S NEW POSITION AND POWER MODE AFTER THE 6TH BEEP.

INSTALLATION INSTRUCTIONS

- 1.** Flip over device & remove (4) screws securing push pad assembly to housing.

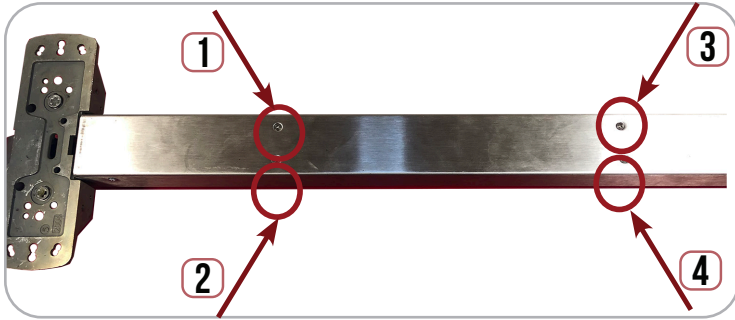

- 2.** Slide Push Pad off Exit Device Housing.

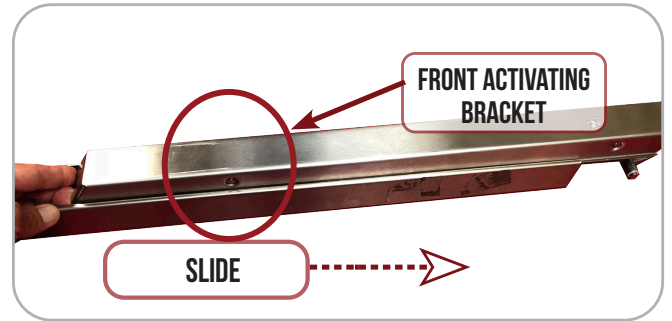

- 3.** Locate the FRONT Activating Bracket. Remove original mounting bracket by pushing out PIN.

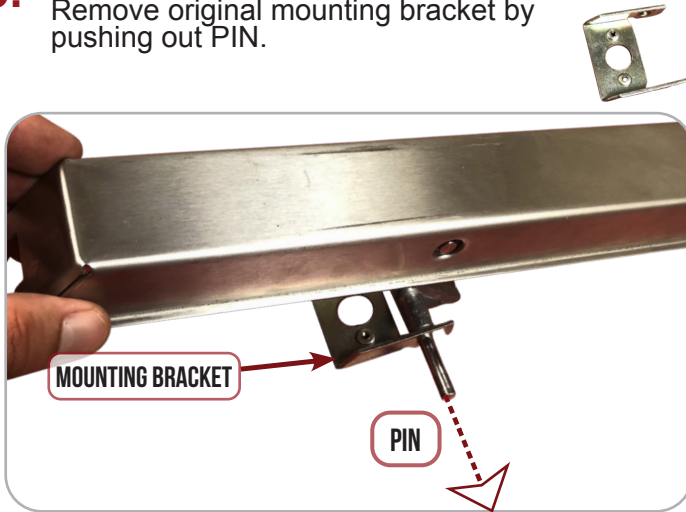

- 4.** Install Point of Front Activating bracket into opening of motor's attaching bracket. It should rest on top of the nylon roller.

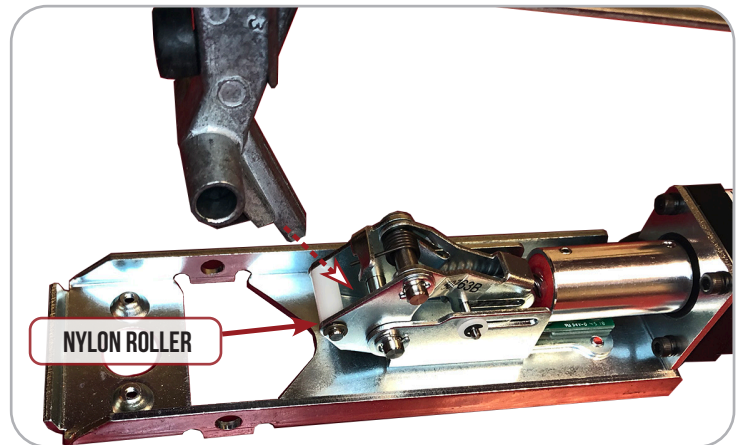

- 5.** Once the point is in the opening, depress the push pad until the holes on the activating bracket & motor mount line up. Re-install factory pin.

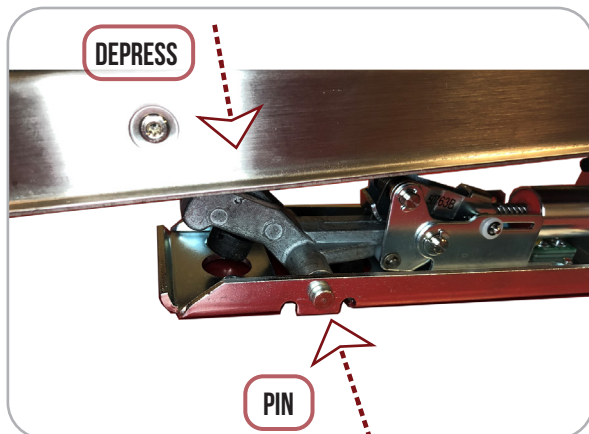

- 6.** Connect MM4S Cable to back of motor's (3) Pin & (4) Pin connectors.

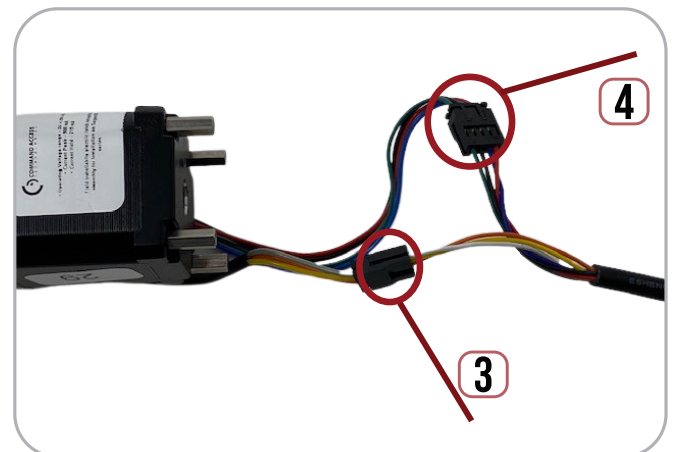

INSTALLATION INSTRUCTIONS

- 7.** Slide Push Pad & Motor Kit back into housing. Be cautious of MM4S cable wires.

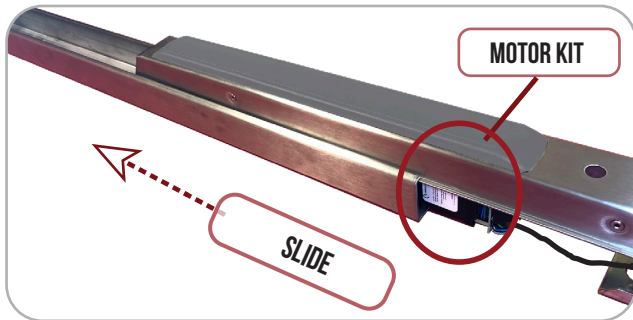

- 8.** Flip Baserail/Pushpad over, holding motor kit in place so it stays attached. **Secure** Motor Kit with (2) M4 Screw provided.

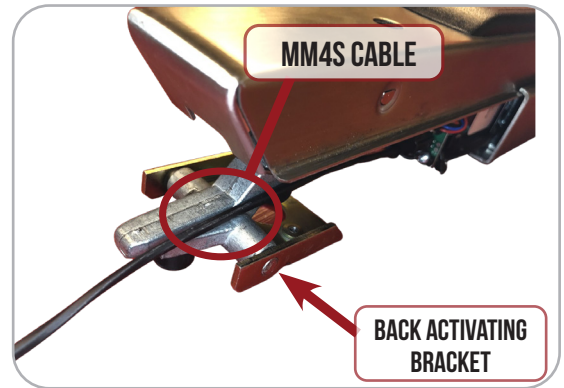

- 9.** Plug-in cable's (4) Pin TOP port & (3) Pin BOTTOM port into MM4S ports.

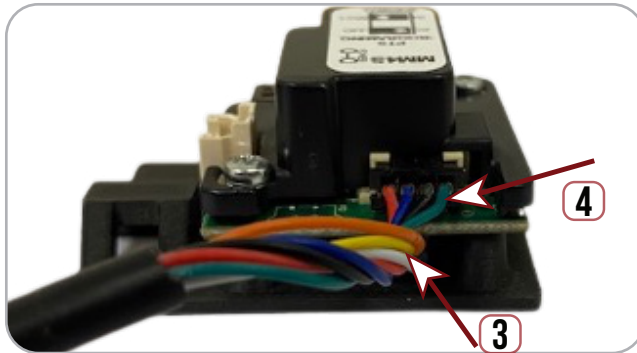

- 10.** Using double sided tape, **secure MM4S** to inside of the back of exit device housing. Connect Molex Pigtail. **Add Mounting Pad & cable tie** to secure cable wires.

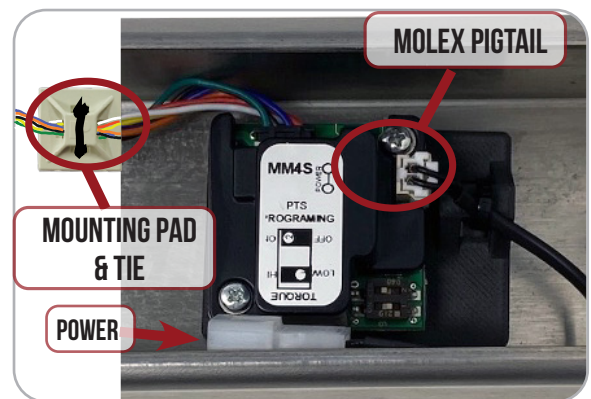

- 11.** Set the "Push to Set Adjustment" following the steps below.



SETTING PUSH TO SET (PTS)

MM4S SWITCHES	
1 OFF	STANDARD TORQUE
1 ON	HIGH TORQUE
2 ON	PTS PROGRAMMING ON
2 OFF	PTS PROGRAMMING OFF

- STEP 1-** SELECT YOUR PREFERRED TORQUE MODE (SHIPS IN STANDARD TORQUE) PRESS THE DEVICE PUSH PAD TO THE DESIRED SETTING. (RECOMMEND TO FULLY DEPRESS AND RELEASE 5%, GIVING THE DEVICE ROOM FOR CHANGING DOOR CONDITIONS.)
- STEP 2-** WHILE DEPRESSING THE PUSH PAD, APPLY POWER. (I.E. PRESENTING THE CREDENTIAL TO THE READER).
- STEP 3-** CONTINUE TO KEEP PAD DEPRESSED, THE DEVICE WILL BEEP 6 TIMES. AFTER THE BEEPS HAVE STOPPED, RELEASE THE PAD AND NOW THE ADJUSTMENT IS COMPLETE. IF NOT TO YOUR LIKING REPEAT THE 3 STEPS.
- STEP 4-** ONCE YOU FOUND THE CORRECT LOCATION, TURN PTS SWITCH TO OFF POSITION.