

# MLRK1-VD



## INSERT INSTRUCTIONS

The Command Access MLRK1 is a field installable motorized latch-retraction kit for:

- MLRK1-VD - Von Duprin 98/99 & 33/35 series devices
- MLRK1-VDAX - Von Duprin 98/99AX & 33/35AX series devices

A.



B.



C.



D.



E.



F.



G.



## KIT INCLUDES

- A. 1- MOTOR MOUNT W/MM5
- B. 2-40002 - 8/32 X 1/4" PHILLIPS HEAD SCREW
- C. 1-50030 - 8/ LEAD W/ VD CONNECTOR
- D. 1-50944 - MOLEX PIGTAIL
- E. 1-40144 - DOGGING HOLE CAP

## FIRE RATED DOGGING KIT

- F. 1-50991 - FIRE RATED DRILLING TEMPLATE (OLD BASERAILS)
- G. 1-REPLACEMENT DOGGING TAIL PIECE (40006 + 408000+ 50991)



INSTALLATION VIDEO

## SPECIFICATIONS

- INPUT VOLTAGE: 24VDC +/- 10%
- AVERAGE LATCH RETRACTION CURRENT: 900 MA
- AVERAGE HOLDING CURRENT: 215 MA
- WIRE GAUGE: MINIMUM 18 GAUGE
- DIRECT WIRE RUN - NO RELAYS OR ACCESS CONTROL UNITS IN-BETWEEN POWER SUPPLY & MODULE

## BUILT-IN REX

- SPDT - RATED .5A @24V
- GREEN= COMMON (C)
- BLUE = NORMALLY OPEN (NO)
- GREY = NORMALLY CLOSED (NC)

## RECOMMENDED POWER SUPPLIES: USE A POWER LIMITED CLASS 2 POWER SUPPLY

ALL COMMAND ACCESS EXIT DEVICES & FIELD INSTALLABLE KITS HAVE BEEN THOROUGHLY CYCLE TESTED WITH COMMAND ACCESS POWER SUPPLIES AT OUR FACTORY. IF YOU PLAN ON USING A NON-COMMAND POWER SUPPLY IT MUST BE A FILTERED & REGULATED LINEAR POWER SUPPLY.

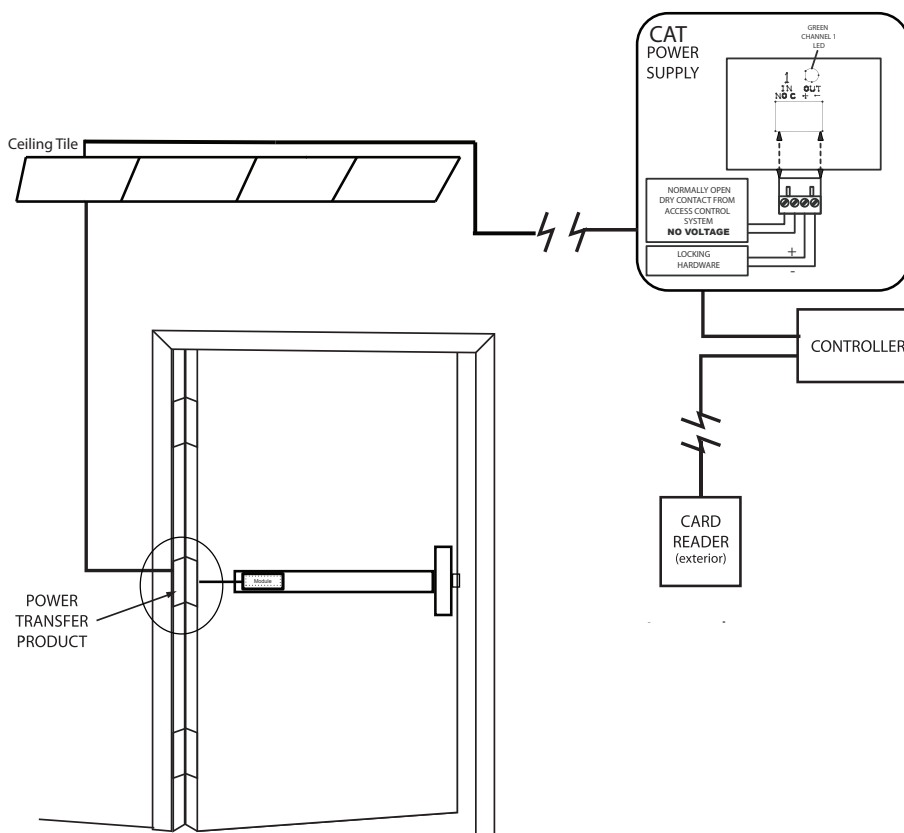

## SETTING PUSH TO SET (PTS)

→ **MAKE SURE TO SET PTS BEFORE FINISHING INSTALLATION** ←

- STEP 1 -** TO ENTER PTS MODE: DEPRESS MM5 BUTTON & APPLY POWER. THE DEVICE WILL EMIT 1 SHORT BEEP. THE DEVICE IS NOW IN PTS MODE.
- STEP 2 -** WHILE DEPRESSING THE PUSH PAD, APPLY POWER. (I.E. PRESENTING THE CREDENTIAL TO THE READER).
- STEP 3 -** CONTINUE TO KEEP PAD DEPRESSED, THE DEVICE WILL EMIT 1 LONG BEEP. AFTER THE BEEP HAS STOPPED, RELEASE THE PAD AND NOW THE ADJUSTMENT IS COMPLETE. TEST THE NEW LOCATION, IF NOT TO YOUR LIKING REPEAT THE 3 STEPS.

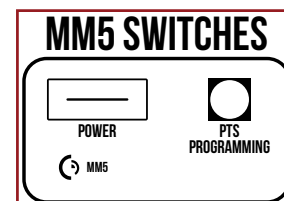

## TROUBLESHOOTING & DIAGNOSTICS

BEEPS	EXPLANATION	SOLUTION
2 BEEPS	OVER VOLTAGE	> 30V UNIT WILL SHUT DOWN. CHECK VOLTAGE & ADJUST TO 24 V.
3 BEEPS	UNDER VOLTAGE	< 20V UNIT WILL SHUT DOWN. CHECK VOLTAGE & ADJUST TO 24 V.
4 BEEPS	FAILED SENSOR	VERIFY ALL 3 SENSOR WIRES ARE INSTALLED CORRECTLY. REPLACE SENSOR IF PROBLEM PERSISTS BY CONTACTING OFFICE.
5 BEEPS	RETRACTION OR DOGGING FAILURE	<p>AFTER 1ST FAIL: 5 BEEPS THEN IMMEDIATELY ATTEMPTS TO RETRACT AGAIN.</p> <p>AFTER 2ND FAIL: 5 BEEPS WITH PAUSE IN-BETWEEN FOR 30 SECONDS THEN DEVICE ATTEMPTS TO RETRACT AGAIN.</p> <p>AFTER 3RD FAIL: 5 BEEPS EVERY 7 MINUTES, DEVICE WILL NOT ATTEMPT TO RETRACT.</p> <p>TO RESET: DEPRESS BAR FOR 5 SECONDS AT ANY TIME.</p>

1. Remove (4) screws from **Head Cover**.

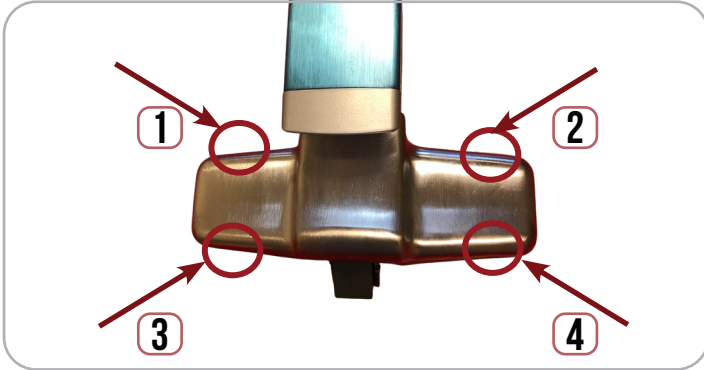

2. Remove (2) **Screws** securing mounting bracket to housing.

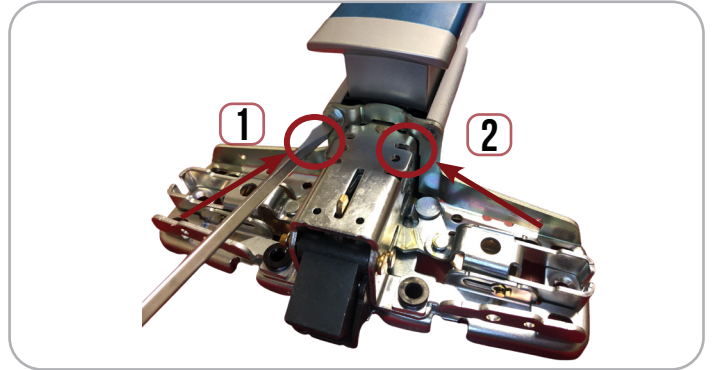

3. **Slide off (1) Housing** to expose Pushpad & Baserail Assembly. Next, (2) remove push pad.

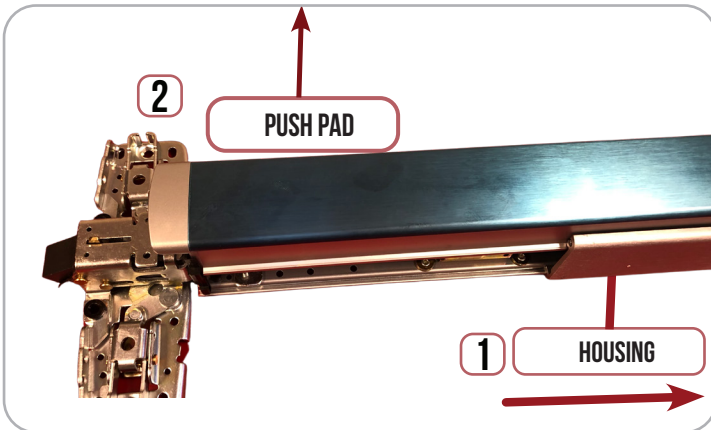

4. If your device has **Mechanical Dogging**, flip Baserail over & remove (2) **screws** securing dogging to Baserail. If you have rivets, you will need to drill or punch them out.

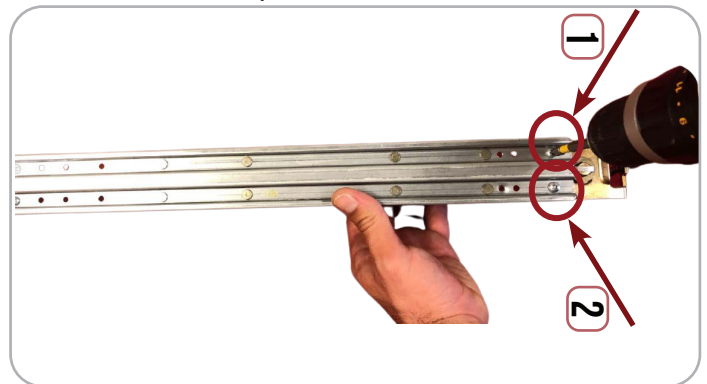

## FIRE RATED DEVICES ONLY - NON-RATED SKIP TO STEP 7

5. Use **Replacement Dogging Tail (50872)**, & insert into the connection rod.

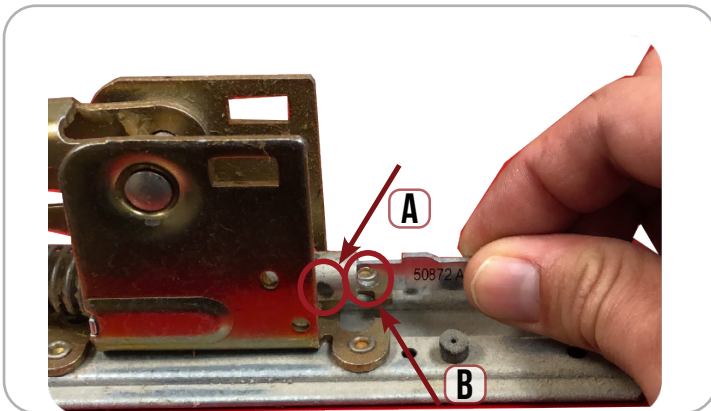

6. **Line up Holes A & B**, insert pin & secure it with the clip provided. If you have an older device without Hole B, please scan the QR code for a video how to use the provided dogging kit.

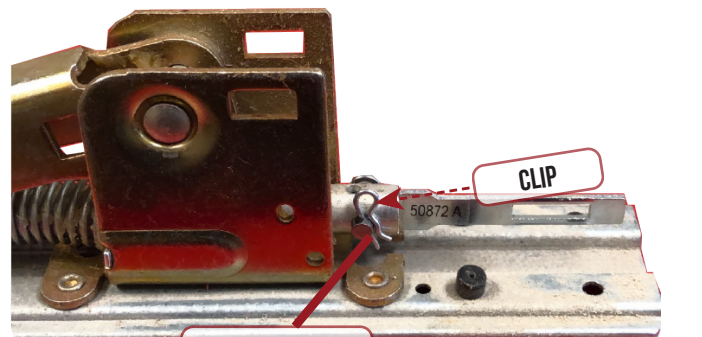

DRILL GUIDE VIDEO



7. The attaching bracket on your motor kit will slide into the dogging tail opening at a slight angle. Once the attaching bracket is inside the opening, straightening the motor kit.

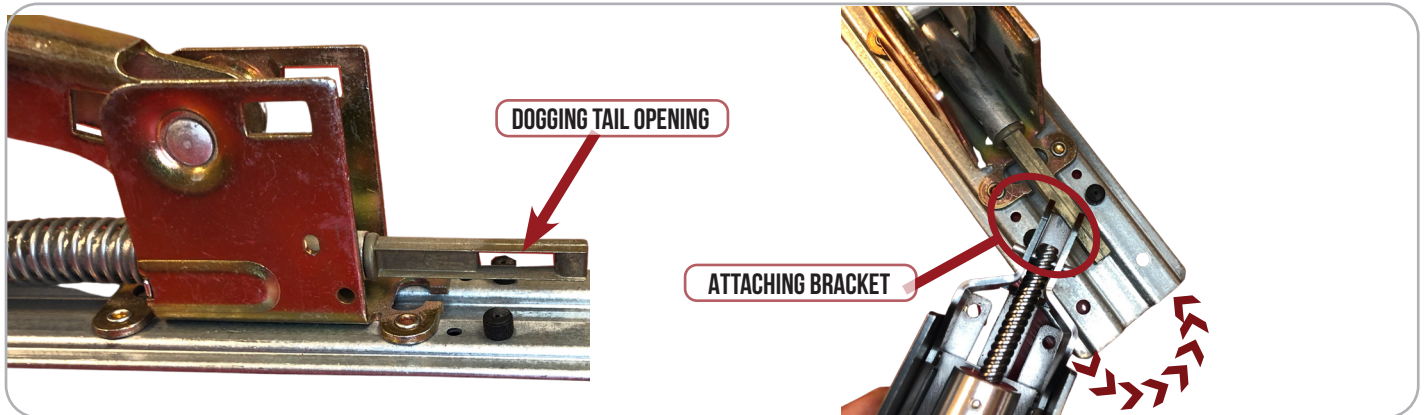

8. **Straighten Motor kit**, depress the back activating bracket & gently pull back on the motor kit to slide the mounting bracket **UNDERNEATH** the baserail.

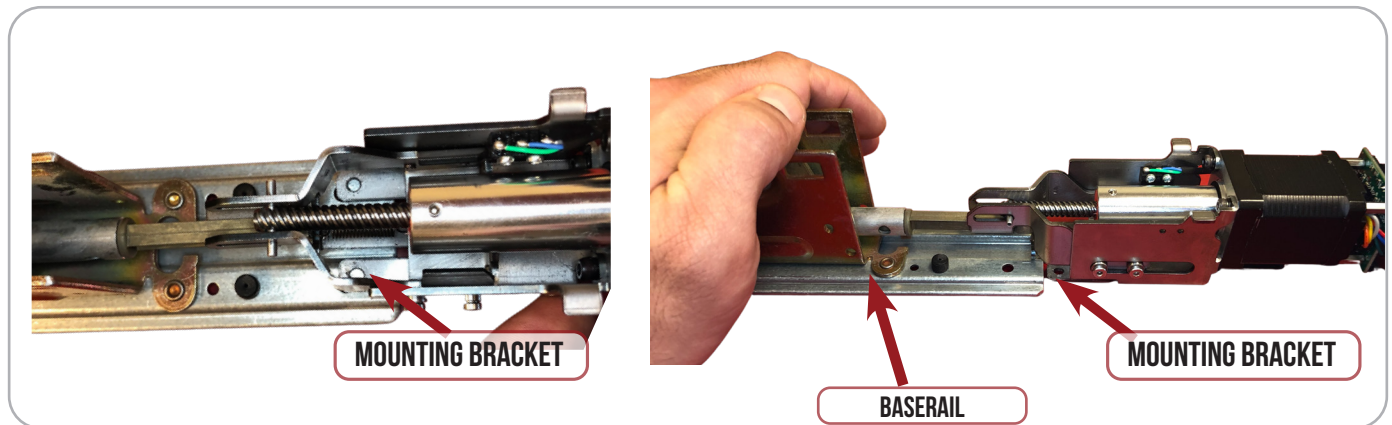

9. Line up mounting bracket holes with existing holes on baserail. **Secure Motor kit** to baserail by installing (2) screws provided from the top of the device, not from underneath.

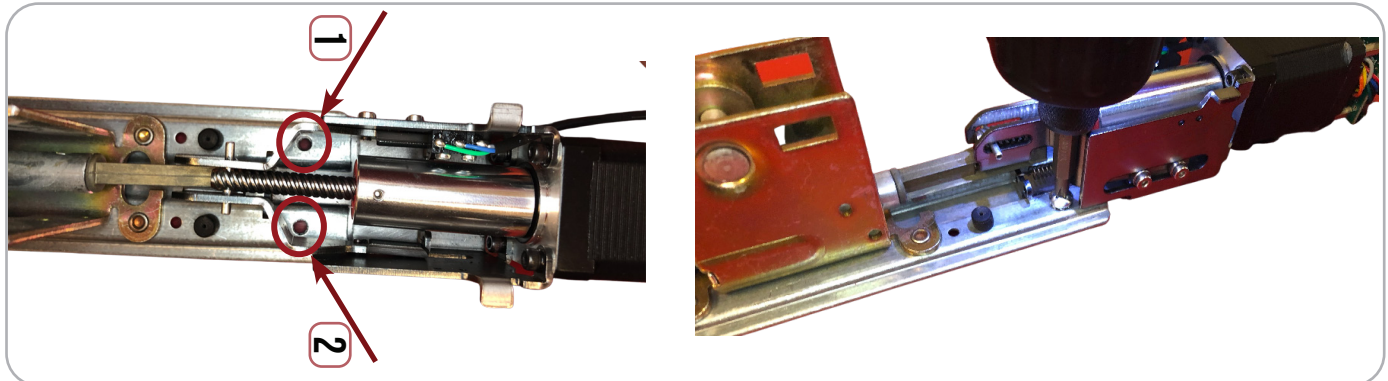



- 10. Test Motor kit** on baserail to confirm it is function properly.

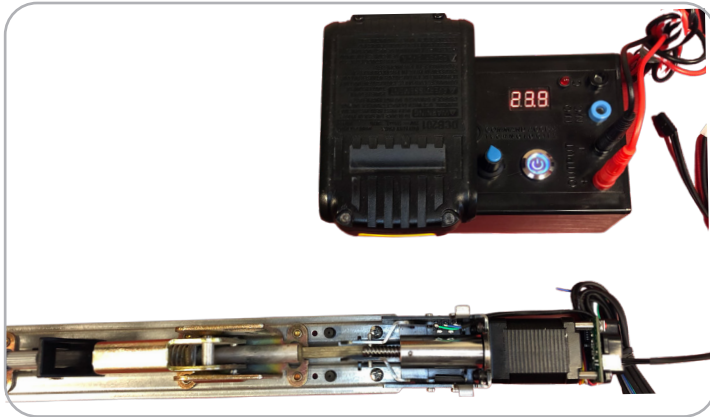

- 11. Re-install Push Pad (1)**, then slide the exit device housing back onto the device (2).

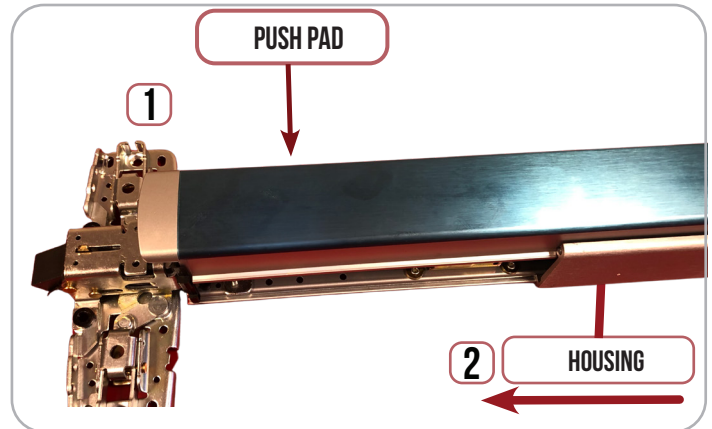

- 12. Re-install Mounting Bracket**, to secure the housing to the device.

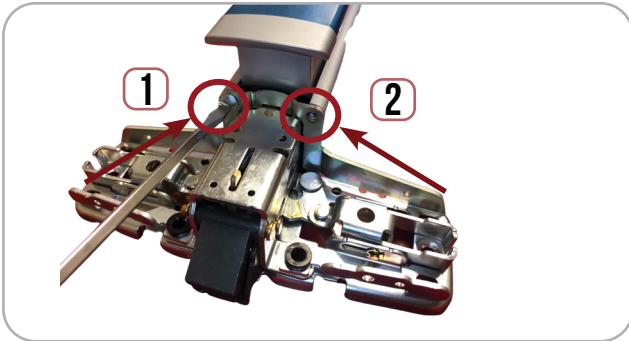

- 13. Now**, set the motor adjustment by following the Push to Set directions below.



## SETTING PUSH TO SET (PTS)

**\*\*IMPORTANT INFO\*\***

**MAKE SURE TO SET PTS BEFORE FINISHING INSTALLATION**

- STEP 1 -** To enter PTS mode: Depress MM5 button & apply power. The device will emit 1 SHORT beep. The device is now in PTS mode.
- STEP 2 -** While depressing the push pad, apply power. (i.e. presenting the credential to the reader).
- STEP 3 -** Continue to keep pad depressed, the device will emit 1 LONG Beep. After the beep has stopped, release the pad and now the adjustment is complete. test the new location, If not to your liking repeat the 3 steps.



INSTALLATION VIDEO

