

# Architectural Door Accessories

**ASSA ABLOY**

## McKinney 3<sup>1</sup>/<sub>2</sub> x 3<sup>1</sup>/<sub>2</sub>, 3<sup>1</sup>/<sub>2</sub> x 5, 3<sup>1</sup>/<sub>2</sub> x 6 Full Mortise Template Hinges

The global leader in  
door opening solutions

DO NOT SCALE  
DIMENSIONS: INCHES (MM)

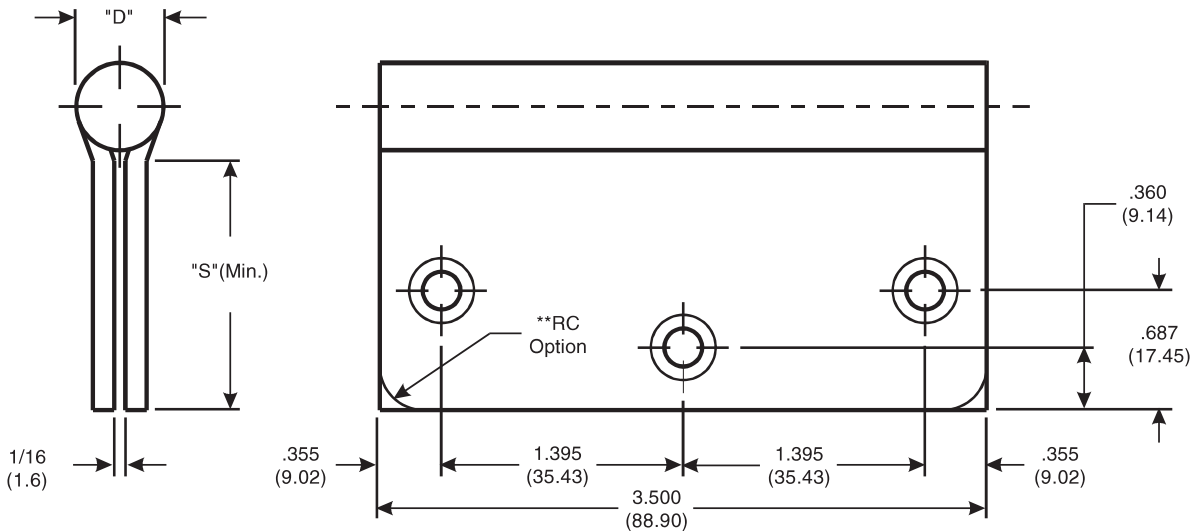

### Template 020-15

**Effective date:**  
September 1, 2015

**Supersedes:** All Previous

McKINNEY Template Hinges of the Catalog Numbers are made to conform to ANSI/BHMA 156.7.

Hospital Type Template Hinges conform to screw hole locations shown.

**Machine Screw Size:**  
1/2 x 10-24 F.H.

**Wood Screw Size:**  
1 x 10 F.H.

\*Check Catalog for Metals.

\*\*Round Corner Option is available with 1/4 (6.3) or 5/8 (15.9) radii. If none is specified 1/4 (6.3) will be supplied.

CATALOG NUMBER		GAUGE OF METAL	"D" OUTSIDE DIAMETER	"S" DISTANCE (SWAGE LINE)		
STEEL HINGES	*NON-FERROUS HINGES			HINGE WIDTH		
				3 <sup>1</sup> / <sub>2</sub> (88.9)	5 (127.0)	6 (152.4)
TA 714	TA 314	.123 (3.12)	.530 (13.46)	1-7/16 (36.5)	-	-
T 2714	T 2314	.123 (3.12)	.530 (13.46)	1-7/16 (36.5)	-	-
TA/TB 2714	TA/TB 2314	.123 (3.12)	.563 (14.29)	1-7/16 (36.5)	-	-
TA 2731	TA 3331	.123 (3.12)	.503 (12.78)	1-7/16 (36.5)	-	-
TA/TB 2798	-	.123 (3.12)	.563 (14.29)	-	2-3/16 (55.6)	2-11/16 (68.3)

225 Episcopal Road  
Berlin CT 060377  
P: 800.346.7707 | F: 800.541.1073  
www.mckinneyhinge.com | dss-orders@assaabloy.com

McKinney is a brand associated with Corbin Russwin, Inc., an ASSA ABLOY Group company. Copyright © 2017, Corbin Russwin, Inc. All rights reserved. Reproduction in whole or in part without the express written permission of Corbin Russwin, Inc. is prohibited.