

Architectural Door Accessories

ASSA ABLOY

McKinney 4 x 4, 4 x 6, 4 x 7 Full Mortise Template Hinges

The global leader in
door opening solutions

DO NOT SCALE
DIMENSIONS: INCHES (MM)

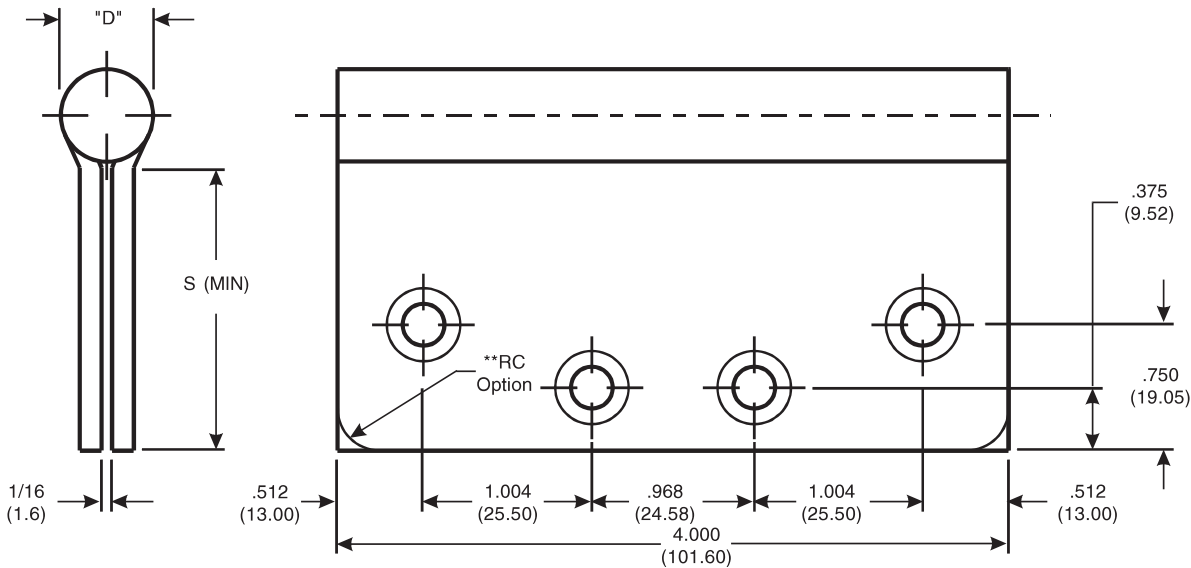

CATALOG NUMBER		GAUGE OF METAL	"D" OUTSIDE DIAMETER	"S" DISTANCE (SWAGE LINE)		
STEEL HINGES	*NON-FERROUS HINGES			HINGE WIDTH		
				4 (101.6)	6 (152.4)	7 (177.8)
TA 714	TA 314	.130 (3.30)	.550 (13.97)	1-11/16 (42.9)	-	-
T 2714	T 2314	.130 (3.30)	.550 (13.97)	1-11/16 (42.9)	-	-
TA/TB 2714	TA/TB 2314	.130 (3.30)	.563 (14.29)	1-11/16 (42.9)	-	-
TA 2731	TA 3331	.130 (3.30)	.525 (13.33)	1-11/16 (42.9)	-	-
TA/TB 2798	-	.130 (3.30)	.563 (14.29)	-	2-11/16 (68.3)	3-3/16 (80.9)

Template 025-15

Effective date:
September 1, 2015

Supersedes: All Previous

McKINNEY Template Hinges of the Catalog Numbers are made to conform to ANSI/BHMA 156.7.

Hospital Type Template Hinges conform to screw hole locations shown.

Machine Screw Size:
1/2 x 12-24 F.H.

Wood Screw Size:
1 1/4 x 12 F.H.

*Check Catalog for Metals.

**Round Corner Option is available with 1/4 (6.3) or 5/8 (15.9) radii. If none is specified 1/4 (6.3) will be supplied.

225 Episcopal Road
Berlin CT 060377
P: 800.346.7707 | F: 800.541.1073
www.mckinneyhinge.com | dss-orders@assaabloy.com

McKinney is a brand associated with Corbin Russwin, Inc., an ASSA ABLOY Group company. Copyright © 2017, Corbin Russwin, Inc. All rights reserved. Reproduction in whole or in part without the express written permission of Corbin Russwin, Inc. is prohibited.