

McKinney 4 1/2 x 4 1/2 Full Mortise Template Hinge

The global leader in
door opening solutions

DO NOT SCALE
DIMENSIONS: INCHES (MM)

MACPRO®

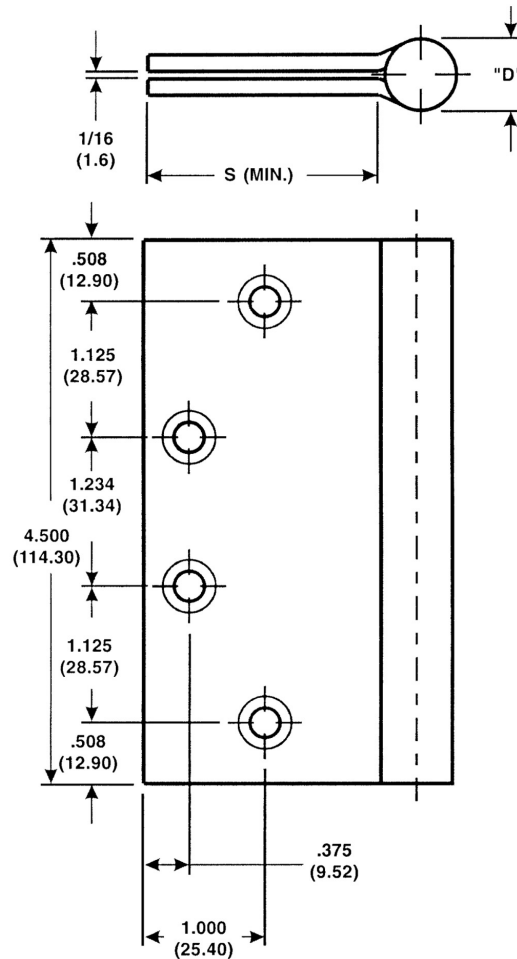

CATALOG NUMBER		GAUGE OF METAL	"D" OUTSIDE DIAMETER	"S" DISTANCE (SWAGE LINE)	
STEEL HINGES	STAINLESS STEEL HINGES			HINGE WIDTH	
				4 (101.6)	4 1/2 (114.3)
MP79	-	.134 (3.40)	.612 (15.53)	1-21/32 (42.1)	1-29/32 (48.4)
MPB79	MPB91	.134 (3.40)	.612 (15.53)	1-21/32 (42.1)	1-29/32 (48.4)
MPB68	MPB99	.180 (4.57)	.750 (19.03)	-	1-27/32 (46.8)

Template MP 030-12

Effective date:
May 15, 2012

Supersedes: All Previous

McKINNEY MacPro
Template Hinges of the
Catalog Numbers are made
to conform to ANSI/BHMA
156.7.

Machine Screw Size:
1/2 x 12-24 F.H.

Wood Screw Size:
1 1/4 x 12 F.H.

225 Episcopal Road
Berlin CT 060377
P: 800.346.7707 | F: 800.541.1073
www.mckinneyhinge.com | dss-orders@assaabloy.com

McKinney is a brand associated with Corbin Russwin, Inc., an ASSA ABLOY Group company. Copyright © 2017, Corbin Russwin, Inc. All rights reserved. Reproduction in whole or in part without the express written permission of Corbin Russwin, Inc. is prohibited.