

# Architectural Door Accessories

## McKinney 5" BP10 Backing Plate

The global leader in  
door opening solutions

DO NOT SCALE  
DIMENSIONS: INCHES (MM)

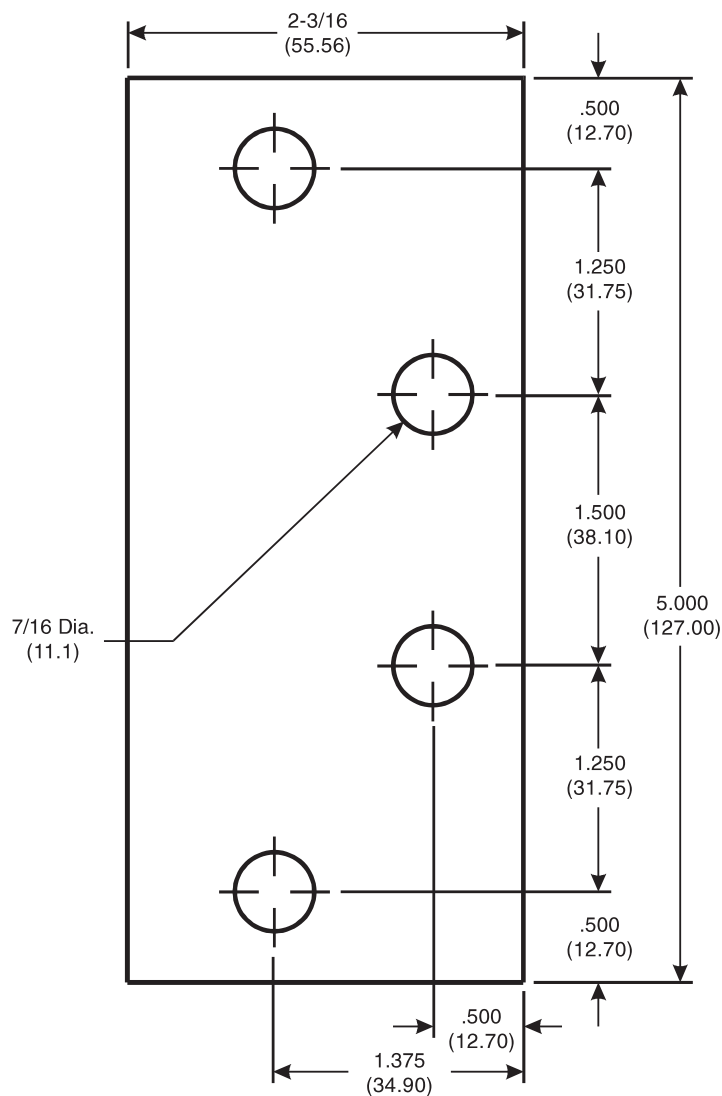

## Template 181-98

**Effective date:**  
March 30, 1998

**Supersedes:** All Previous

McKINNEY Template  
Backing Plate is made to  
conform to this drawing.

Machine Screw Size:  
1/4-20 O.H. with Grommet  
Nut (Provided with hinge.)

225 Episcopal Road  
Berlin CT 060377  
P: 800.346.7707 | F: 800.541.1073  
www.mckinneyhinge.com | dss-orders@assaabloy.com

McKinney is a brand associated with Corbin Russwin, Inc., an ASSA ABLOY Group company. Copyright © 2017, Corbin Russwin, Inc. All rights reserved. Reproduction in whole or in part without the express written permission of Corbin Russwin, Inc. is prohibited.