

# Architectural Door Accessories

## McKinney 5" Half Mortise Template Hinges

The global leader in  
door opening solutions

DO NOT SCALE  
DIMENSIONS: INCHES (MM)

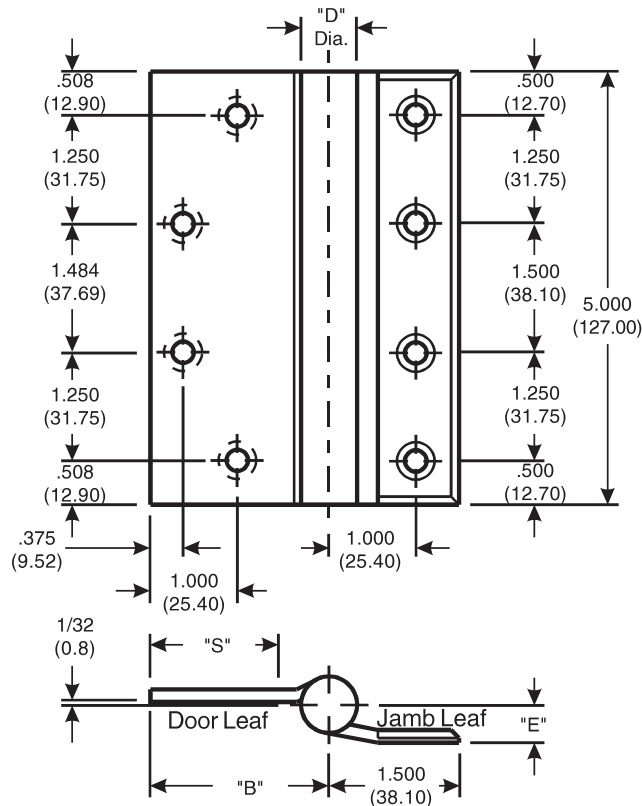

## Template 200-15

**Effective date:**  
September 2, 2015

**Supersedes:** All Previous

McKINNEY Template Half Mortise Hinges of the Catalog Numbers are made to conform to ANSI/BHMA 156.7.

Hospital Type Template Hinges conform to screw hole locations shown.

Machine Screw Size:  
Jamb Leaf: 1/2 x 12-24 F.H.  
Door Leaf: 1/2 x 12-24 F.H.

Hinges are reversible.

\*Check Catalog for Metals.

CATALOG NUMBER		GAUGE OF METAL	"D" OUTSIDE DIAMETER	DOOR LEAF		"E" JAMB LEAF OFFSET
STEEL HINGES	*NON-FERROUS OR STAINLESS STEEL HINGES			"B" TO CENTER LINE	"S" SWAGE LINE	
TA 774	TA 374	.146 (3.71)	.648 (14.86)	2-1/16 (52.4)	1-11/16 (42.9)	7/16 (11.1)
TA 784	TA 384	.190 (4.83)	.752 (19.10)	2-1/8 (53.9)	1-45/64 (43.3)	1/2 (12.7)
TA/TB 2774	TA/TB 3374	.146 (3.71)	.648 (14.86)	2-1/16 (52.4)	1-11/16 (42.9)	7/16 (11.1)
T4A/T4B 3784	T4A/T4B 3384	.190 (4.83)	.752 (19.10)	2-1/8 (53.9)	1-45/64 (43.3)	1/2 (12.7)

225 Episcopal Road  
Berlin CT 060377  
P: 800.346.7707 | F: 800.541.1073  
www.mckinneyhinge.com | dss-orders@assaabloy.com

McKinney is a brand associated with Corbin Russwin, Inc., an ASSA ABLOY Group company. Copyright © 2017, Corbin Russwin, Inc. All rights reserved. Reproduction in whole or in part without the express written permission of Corbin Russwin, Inc. is prohibited.