

**Notes:**

1. Do not scale drawing.
2. Right hand shown.
3. Suitable reinforcing by others.
4. Pivots drilled for 1/4-20 x 5/8 FHMS or #14 x 1-1/2 FHWS.
5. When jamb portion is installed on top of threshold allow for threshold height when preparing frame and door mortise depth.
6. All dimensions are in inches (mm).

**Pivot Set  
3/4" Offset, Handed**

**RIXSON**  
ASSA ABLOY

www.rixson.com

| NUMBER        | Rev      | DATE         |
|---------------|----------|--------------|
| <b>IS-195</b> | <b>3</b> | <b>05-24</b> |

# 195 Pivot Set

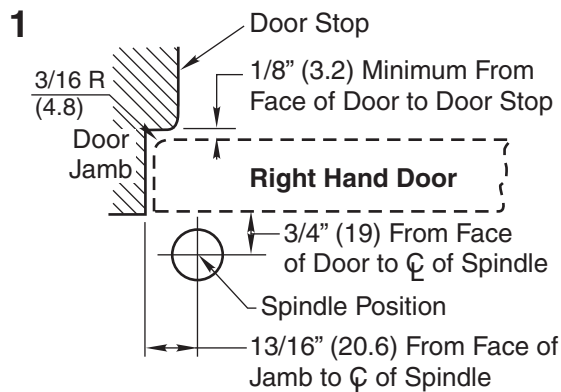

## 1. Install Pivot

- Measure 13/16" (20.6) out from door jamb.
- Allow 1/8" (3.2) min. clearance from door stop to door face. Measure door thickness. Add 3/4" (19).
- Where lines meet determines center line of closer.

## 2. Set Pivot Set

- Mortise jamb to receive jamb leaf as shown on reverse side.
- Care must be exercised to see that pivot end of jamb leaf is level. Place levels as per illustration.

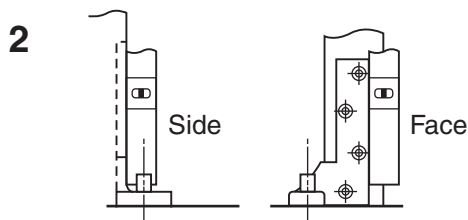

## 3. Install Top Pivot & Pivot Arm

- Install top pivot in door per template.
- Install top pivot in frame per template.
- Install arm in door per template.
- Center line of pivot should line up with center line of spindle. Use plumb line as illustrated.
- If side jamb pivot is used, see required template.

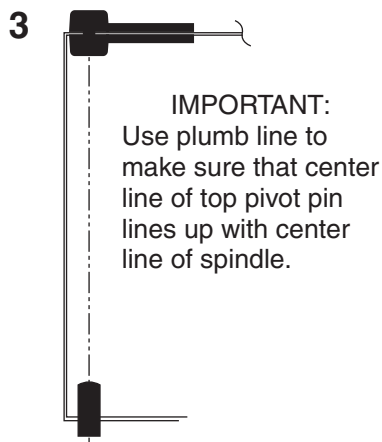

## 4. Hang Door

- Set door on pivot set spindle.
- Push Item 1 "top pivot pin" into place. Attach "cap" Item 2.
- If door drags at floor (or threshold, if used) loosen arm locking screw and raise door to desired clearance and insert one or more 1/16" (1.6) shims. Retighten arm locking screw securely.
- Put arm cap on arm and secure tightly with cap screw furnished.

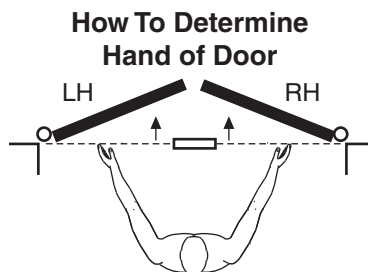
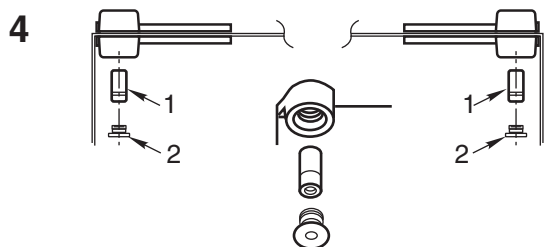

Face a door swinging open away from you.  
 If it opens to the right, it is right hand. If it opens to the left, it is left hand.

**Pivot Set**  
**3/4" Offset, Handed**

**RIXSON**  
**ASSA ABLOY**

www.rixon.com

NUMBER

**IS-195**

Rev

**3**

DATE

**05-24**