

- Notes:**
1. Do not scale drawing.
  2. Dimensions are given in inches (mm).
  3. Right Hand shown.
  4. Template drawing for reference only.

**280 Top Pivot  
3/4" Offset  
Half Surface**

**RIXSON**  
ASSA ABLOY  
www.rixson.com

TEMPLATE NUMBER	REV	DATE
<b>IS-280</b>	<b>3</b>	<b>05-24</b>

# 280 Top Pivot

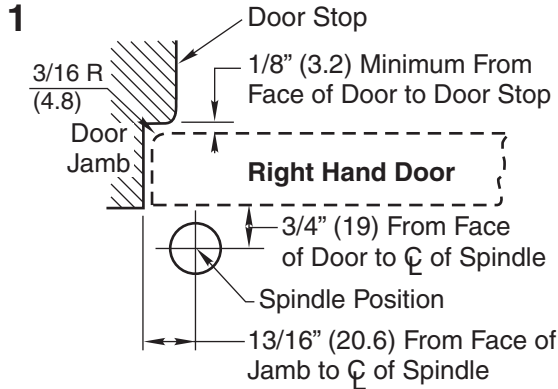

## 1. Install Pivot

- Measure 13/16" (20.6) out from door jamb.
- Allow 1/8" (3.2) min. clearance from door stop to door face. Measure door thickness. Add 3/4" (19).
- Where lines meet determines center line of closer/bottom pivot.
- Install top pivot in door per template.
- Install top pivot in frame per template.

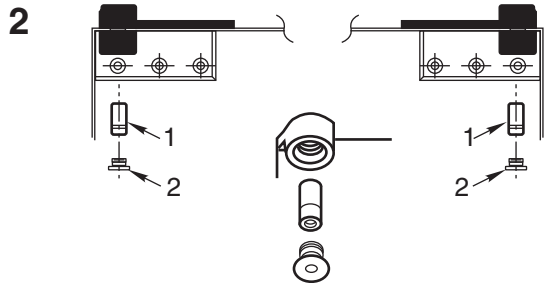
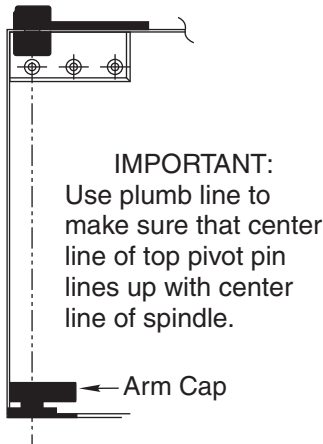

## 2. Hang Door

- Set door on bottom pivot/closer spindle.
- Push Item 1 "top pivot pin" into place. Attach "cap" Item 2. **CAP MUST BE TIGHTENED SECURELY**

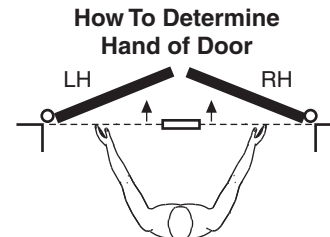

Face a door swinging open away from you. If it opens to the right, it is right hand. If it opens to the left, it is left hand.

**280 Top Pivot  
 3/4" Offset  
 Half Surface**

**RIXSON<sup>®</sup>**  
**ASSA ABLOY**

www.rixon.com

TEMPLATE NUMBER	REV	DATE
<b>IS-280</b>	<b>3</b>	<b>05-24</b>