

DOUBLE GANG

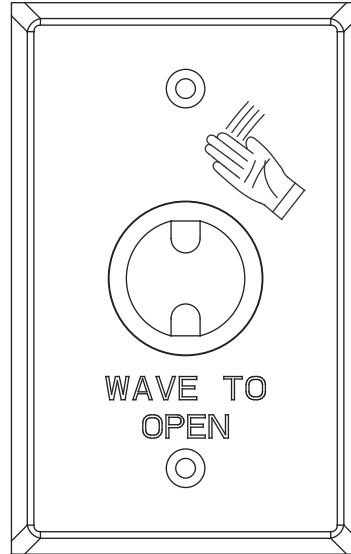

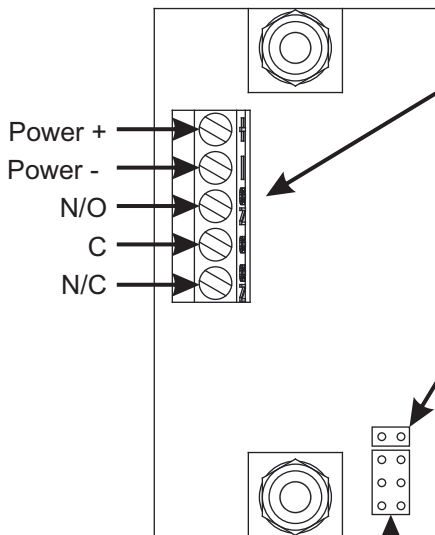









SINGLE GANG



To ensure proper wire connection, loosen the screws fully and note the silver contact is all the way down. Insert the wires and tighten the screws to secure the wires.

LED Jumper setting:

-  Jumper in Place -
 -  LED lights steady RED,
 -  flashes GREEN when relay is active.
 -  
-  NO Jumper in Place -
 -  LED lights steady GREEN,
 -  flashes RED when relay is active.
 -  

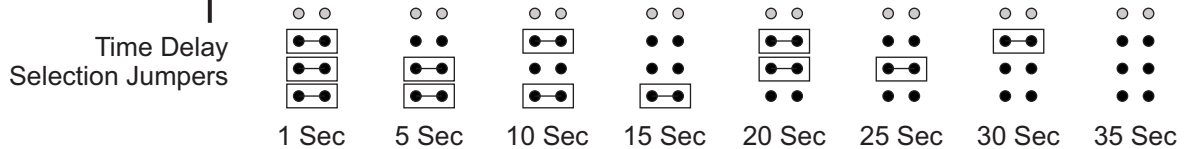

Operation:

To operate the switch, make a slow waving motion with your hand within 4 inches of the front of the plate. A tone will sound and the circle will flash to indicate that the relay has been activated. The relay will activate for the amount of time as set by the time delay jumpers.

To change plate from DOUBLE GANG to SINGLE GANG:

1. Remove the lock nut and washer from the back of the switch.
2. Remove the switch assembly and O-ring from the Double Gang plate.
3. Reassemble the O-ring and switch assembly on the Single Gang plate.
4. Reassemble the washer and lock nut to secure switch assembly to Single Gang plate.

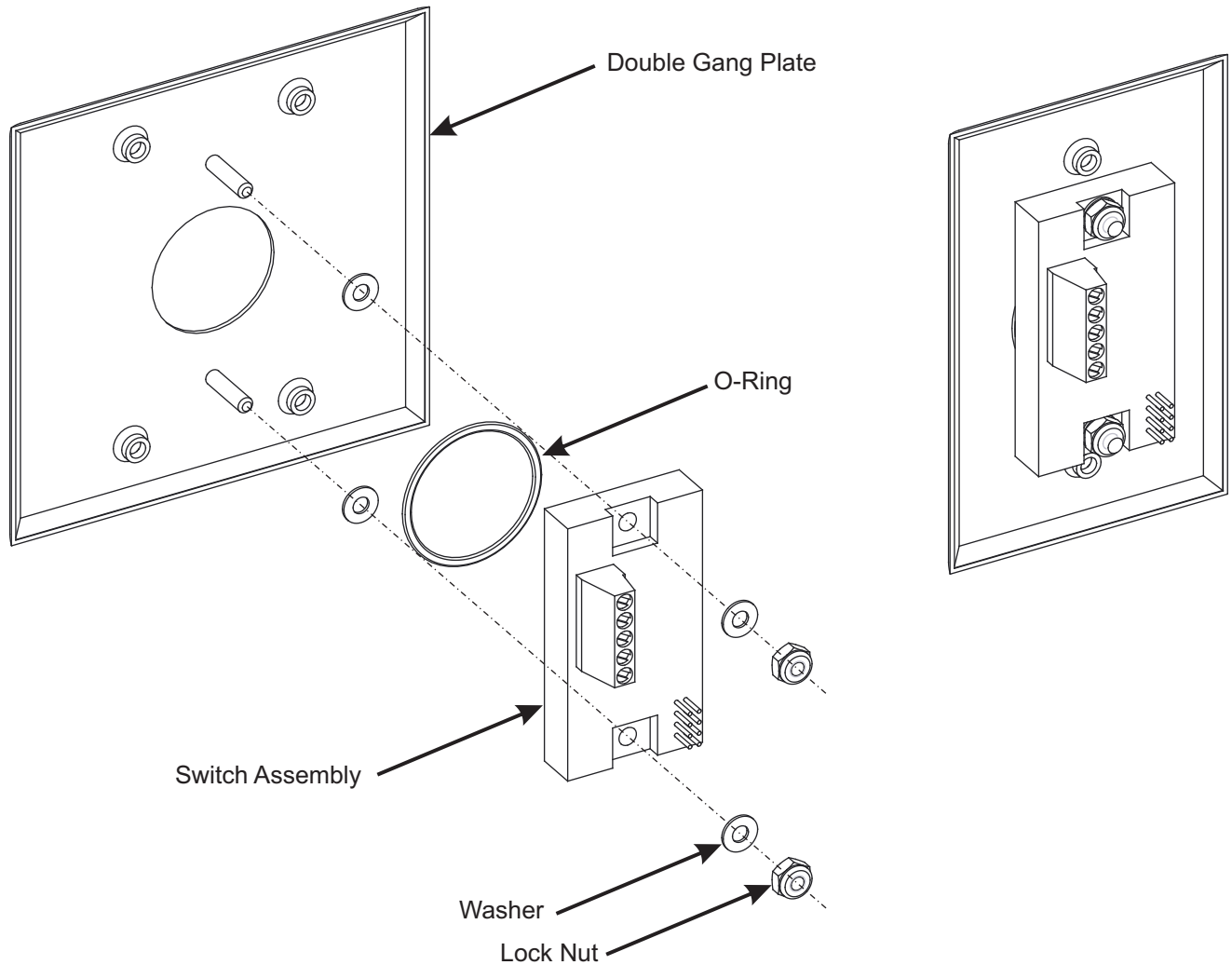

Specifications:

Input Voltage: 12-24 VDC
SPDT Contact Rating: 2A @30V AC or DC
Sensor Detection Range: Up to 4 inches
Operating Temperature: -25°C to 55°C
Current Draw: 50mA @12VDC, 65mA @24VDC

Contact Info:

Norton Rixson
3000 Highway 74 East
Monroe, NC 28112
Tel: 877.974.2255

5800 Series with 700 series Wave-to-Open activation switches AND RF Transmitters

System Description:

- Wave-to-Open switches used to activate Operator by RF activation

System Requirements:

- 5800 Series with 700 Series Wave-to-Open activation switches (p/n 5845xWTO)

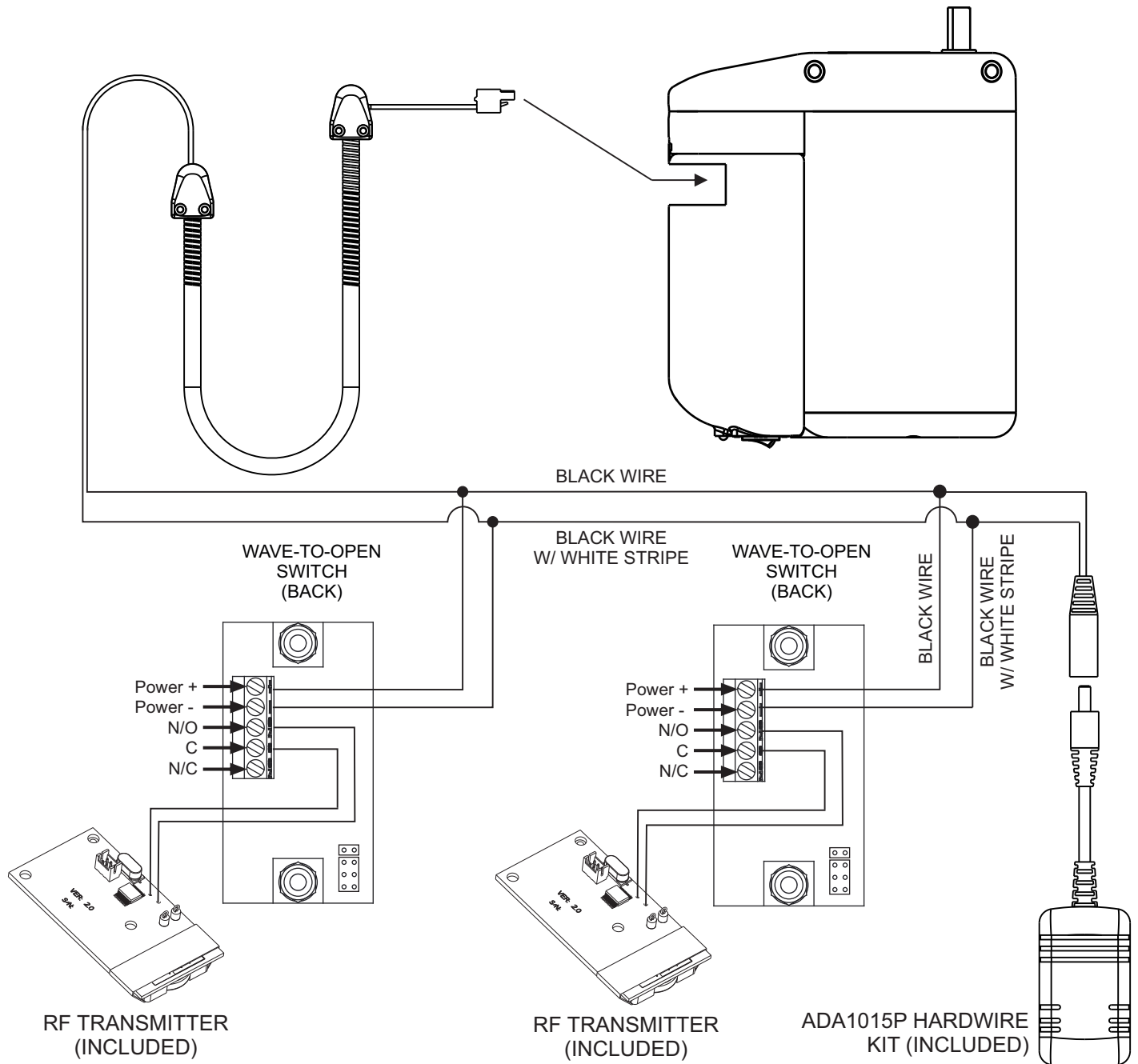

The ASSA ABLOY Group is the global leader in access solutions. Every day we help people feel safe, secure and experience a more open world.

5800 Series with 700 series Wave-to-Open activation switches AND Electric Lock

System Description:

- Operator is activated by Wave-to-Open Switch
- Wireless Interface Module unlocks electric lock
- Door initiates an automatic open cycle

System Requirements:

- 5800 Series with 700 Series Wave-to-Open switches (p/n 5845xWTO)
- ADA1028W Wireless Interface Module

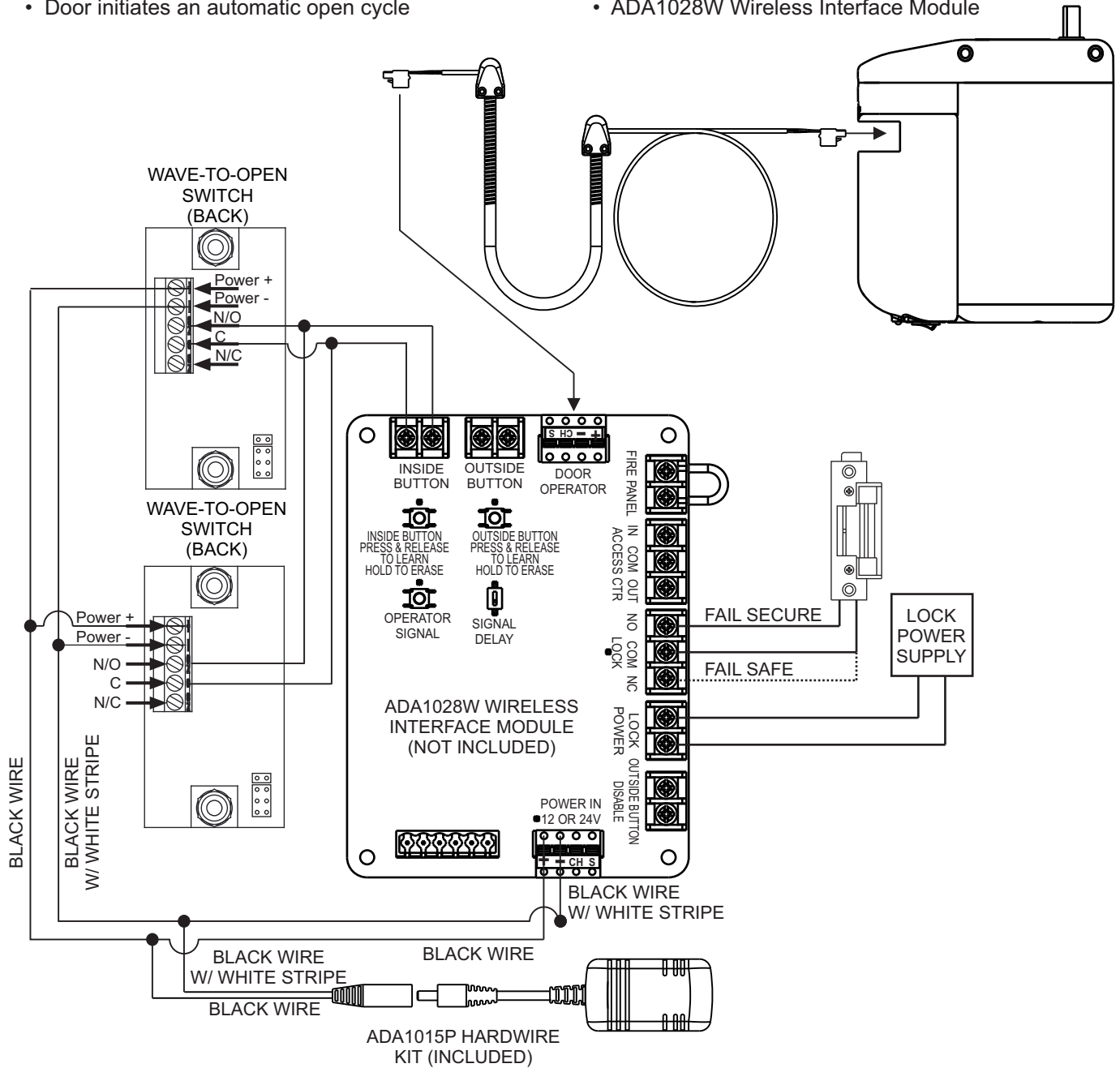

Technical Product Support:
Monroe, NC 28112 USA
Phone: 877.974.2255 ext: 2
Techsupport.NortonRixson@assaabloy.com
NortonRixson.com

Copyright © 2017, 2023, ASSA ABLOY Accessories and Door Controls Group, Inc. All rights reserved. Reproduction in whole or in part without the express written permission of ASSA ABLOY Accessories and Door Controls Group, Inc. is prohibited.
ADA700803 Rev D 10/23 4 of 4

Approved 2024-05-16

Experience a safer and more open world