

Installation Instructions

N078 - Door Lock

Typical Installation

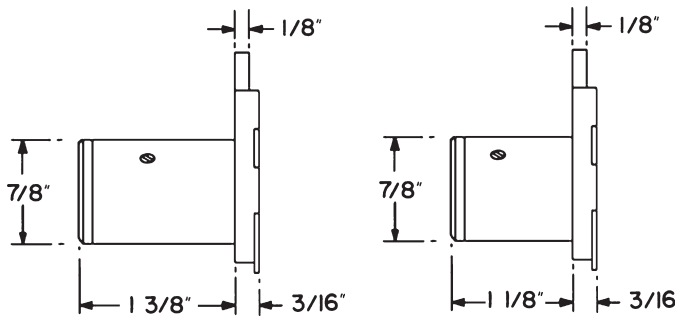
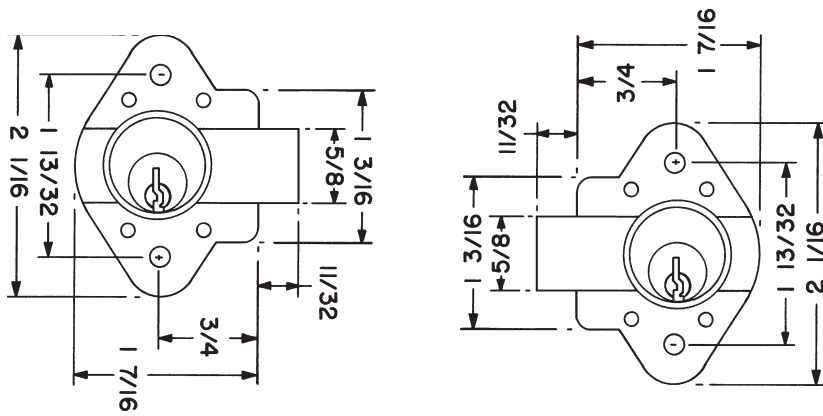
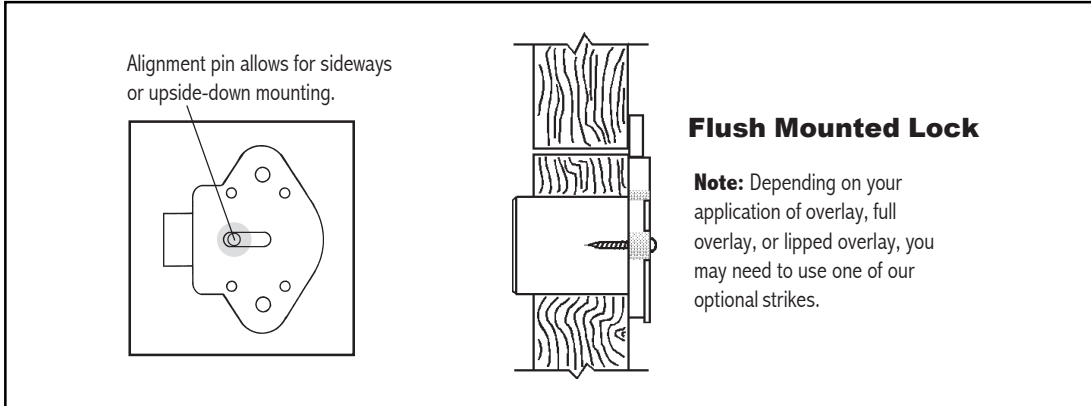

Use of spacers and strikes depends on application and material thickness.

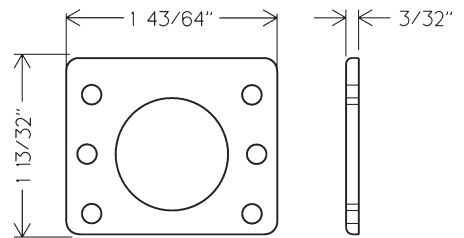

Optional WP21 - 3/32" spacer

| | | | | |
|---|--|------------------------------|----------------------------|---------------------------------|
| Title Installation instructions for N078 series cabinet drawer lock | | | | |
| Series N078 | Barrel Length 1-1/8" or 1-3/8" | Bolt type Deadbolt | Mounting Surface | Revision Date 06/2005 |

