

# SK-004 SERIES

## Parts & Accessories Sample & Service Kit

### GENERAL FEATURES

The SK-004 contains a sampling of our most popular parts and accessories. The kit comes in its own plastic, 2 level case with parts marked and separated by dividers. The top section provides additional room for extra locks and accessories.



Two level carrying case featuring our most popular parts and accessories.



Top level - empty space for additional locks, parts and accessories

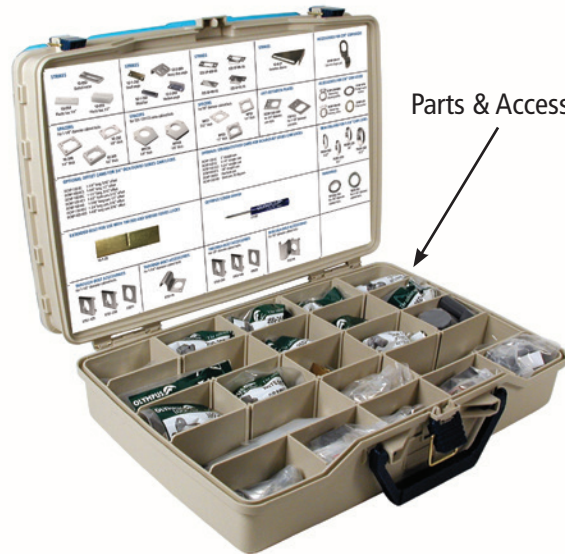

Parts & Accessories



**WARNING:** This product can expose you to chemicals including chromium, which is known to the State of California to cause cancer and birth defects or other reproductive harm. For more information go to [www.P65Warnings.ca.gov](http://www.P65Warnings.ca.gov).



**OLYMPUS  
LOCK** INC

# SK-004 Parts & Accessories Sample & Service Kit

## CONTENTS - TOP LAYER

### OTHER AVAILABLE PARTS & ACCESSORIES NOT INCLUDED IN THIS KIT

#### OPTIONAL CAMS FOR 1-1/8" DIAMETER CAM LOCKS

720-3-3	1-3/4" offset cam, inverted (0.422 offset)
720-3-4	3" straight cam, vertical
720-3-5	1-7/8" shallow offset cam, inverted (0.115 offset)

#### SWITCH ACCESSORY PACK

SW-1	Parts to convert 1-1/8" diameter cam locks into switch locks. (Note: does not include electronic switches)
------	---

#### PLASTIC THUMBURNS

725-PA	Works with SFIC and Corbin/Russwin IC
7788-PA-D	Works with Schlage full-size IC
931-PA	Works with Medeco/Yale IC

#### OPTIONAL CAMS FOR USE WITH DCP/DCP500

DCP-LC	1-1/4" straight cam
DCP-LC-112	1-1/2" straight cam
DCP-LC-134	1-3/4" straight cam
DCP-LC-225	2-1/4" straight cam
DCP-LC-250	2-1/2" straight cam
DCP-SC	7/8" straight cam
DCP-LBC	1-1/4 X 1/4 offset cam
DCP-LBC-138	1-3/8 X 3/8 offset cam
DCP-LBC-178	1-7/8 X 1/2 offset cam
DCP-112-14	1-1/2 X 1/4 offset cam
DCP-114-18	1-1/4 X 3/8 offset cam
DCP-114-38	1-1/4 X 3/8 offset cam
DCP-118-18	1-1/8 X 1/8 offset cam
DCP-1-14	1 X 1/4 offset cam
DCP-2-18	2 X 1/8 offset cam

#### BUMPER PLATES FOR USE WITH DCP/DCP500

DCP-SP1-US32	DCP strike plate 3 x 4 polished SS
DCP-SP1-26D	DCP strike plate 3 x 4 26D

#### T37 ACCESSORIES

T37-RC	Spring mounting clip
T37-NKIT	Number plate kit
T37-2	Long bolt (can be cut to length)
T37-3	Short bolt for 25/32 backset

#### N078/R078 OPTIONAL BOLTS

078-LB-DR	Longer bolt for doors (N078 only)
078-LB1-DW	Outbent bolt for drawers

#### PLASTIC SPACERS

WP24	1/8" thick for use with 996/997/998/999
10-351	1/8" thick for use with L78

#### 729R / 829R / 929R OPTIONAL STRAPS

729RS-2	Strap for 3/8" material thickness
729RS-3	Strap for up to 5/8" material thickness

#### STRIKES

L78ST-1	Lipped strike for 1-1/8" barrel length L78, L72 or L92 latch locks
L78ST-2	Lipped strike for 1-3/8" barrel length L78, L72 or L92 latch locks
999-STRIKE	Lipped strike for use with 996/997/998/999 latch locks
850-210	Lipped strike for use with 850 or 950 1-1/8" barrel length locks
850-211	Lipped strike for use with 850 or 950 1-3/8" barrel length locks
10-056	Notched metal bar strike
10-057	White plastic bar strike, .65" thick
10-058	White plastic bar strike, 3/8" thick
075	Metal slotted strike

#### TRIM COLLARS FOR DCN/DCR/B7 3/4" CAM LOCKS

TR87-18	Spacer collar, 1/8"
TR87-14	Spacer collar, 1/4"
TR87-12	Spacer collar, 1/2"

#### THROUGH-BOLT PLATES

ETS4	For use with 777 series locks
ETS5	For use with 888 series locks

#### 700/800 PARTS & ACCESSORIES

78-KABA-CONV	For use with KABA cylinders in 700/800 less cylinder products
10-360	Universal driver (fits in back of cylinder)
10-361	Tailpiece/driver bar for 1-1/8" barrel length locks
10-362	Tailpiece/driver bar for 1-3/8" barrel length locks
10-363	Medeco tailpiece/driver bar for 1-3/8" barrel length locks
10-364	ASSA tailpiece/driver bar for 1-3/8" barrel length locks

#### TOOLS

CL-HIT-25	Cabinet lock drill guide
CL-MP-118	Double-D metal punch for 1-1/8" diameter cam locks
FL1	Small pin follower tool

#### PIN KITS

N1	For N series (National Keyway) locks
R1	For R series (CCL keyway) locks



CL-HIT-25

CL-MP-118



N1 or R1 PIN KIT

## CONTENTS - BOTTOM LAYER

#### ANTI-ROTATION PLATES



DCNP-500-ARP  
For 3/4" diameter  
cam locks

720-PL3  
For 1-1/8" diameter  
cam locks

#### STRIKES



10-052  
Slotted metal

10-054  
Plastic bar, 1/4"

10-055  
Plastic bar, 1/2"

#### STRIKES



12-1-26D  
Small angle

12-2-26D  
Heavy duty angle

56-1-26D  
Metal bar

12-3-26D  
Medium angle

#### STRIKES



725-SP-MD-SS

725-SP-ML-SS

725-SP-RD-SS

725-SP-RL-SS

#### TRIM RINGS



TR1256-26D  
For 7/8" diameter  
cabinet locks

TR78-26D  
For 1-1/8" diameter  
cabinet locks

#### SPACERS



For 1-1/8" diameter cabinet locks

10-350  
1/8" thick

10-349  
1/2" thick

#### SPACERS



For 725 / CR1125 series cabinet locks

WP726  
1/4" thick

WP725  
1/8" thick

#### SPACERS



For 7/8" diameter cabinet locks

WP21  
3/32" thick

WP22  
1/4" thick

WP23  
1/2" thick

#### STRIKES



12-4-ZP  
Frameless drawer

#### OPTIONAL OFFSET CAMS FOR 3/4" DCN/DCR/B7 SERIES CAM LOCKS

DCNP-100-BC	1-1/4" long, 5/16" offset
DCNP-100-BC5	1-1/4" long, 1/2" offset
DCNP-100-LBC	1-1/2" long, 5/16" offset
DCNP-100-HC1	1-1/2" hook cam, 5/16" offset
DCNP-100-HD	1-7/16" long cam, 1/2" offset
DCNP-100-HD2	1-3/4" long cam, 5/16" offset
DCNP-100-HD3	1-1/8" long cam, 5/16" offset

#### OPTIONAL STRAIGHT/OTHER CAMS FOR DCN/DCR/B7 SERIES CAM LOCKS

DCNP-100-LC	3" straight cam
DCNP-100-SC	1-1/4" straight cam
DCNP-100-SC2	1-3/4" straight cam
DCNP-HD-875	7/8" straight cam
DCNP-100-83	Flat hook cam
DCNP-100-WB	Short cam, 90 deg arm

#### TRIM COLLARS FOR 1-1/8" CAM LOCKS



TR204-32D  
5/32"

TR202-32D  
1/4"

TR203-32D  
3/8"

#### EXTENDED BOLT FOR USE WITH 100/200 AND 500/600 SERIES LOCKS



15-1-35

#### OLYMPUS SCREW DRIVER



LIT-SD

#### ACCESSORIES FOR 3/4" CAM LOCKS



DCNP-200-KDR  
Drawer key-  
retaining shifter

DCNP-SPW  
Pronged wood  
washer

DCNP-200-KR  
Drawer key-  
retaining shifter

DCNP-GW  
Glass washer

#### THROUGH-BOLT ACCESSORIES



For 1-1/8" diameter cabinet locks

ETS1-125

ETS1-250

ETS1

#### THROUGH-BOLT ACCESSORIES



For 1-1/8" diameter cabinet locks

ETS1-PL

#### THROUGH-BOLT ACCESSORIES



For 7/8" diameter cabinet locks

ETS2-250

ETS2-125

ETS2

#### THROUGH-BOLT ACCESSORIES



For 7/8" diameter cabinet locks

ETS2-PL

#### ACCESSORIES FOR 3/4" CAM LOCKS



DCNP-300-FP  
Cam lock finger pull