



PD25-M-SVR

INSTALLATION INSTRUCTIONS



The PD25-M-SVR (PD26 Mechanical) is our architectural grade 1 exit device. Electrified it comes equipped with motorized latch retraction utilizing our PTS "Push to Set" technology.

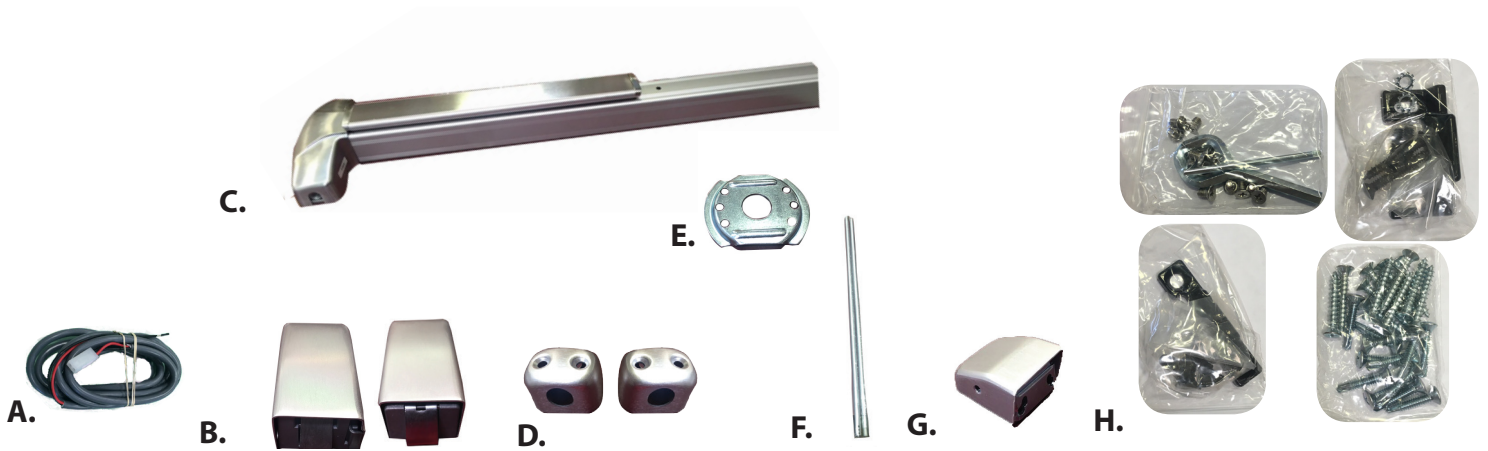

PD25 Includes

- A. 6' 2-Pin Power Lead (not included with PD26)
- B. Top & Bottom Latch
- C. PD25-M Device w/ MM module
- D. Rod Guides
- E. Strike
- F. SVR Rods
- G. End Cap
- H. 4 - Screw Pack

Tools Required

- Cordless Drill

TECHNICAL INFORMATION

SPECIFICATIONS

- Input Voltage: 24VDC +/- 10%
- Wire gauge: Minimum 18 gauge
- **Direct wire run - no relays or access control units in-between power supply & module**

Low Torque Mode

- Average Latch Retraction Current: 600 mA
- Average Holding Current: 150 mA

Standard Torque Mode- SHIPS STANDARD

- Average Latch Retraction Current: 900 mA
- Average Holding Current: 215 mA

High Torque Mode

- Average Latch Retraction Current: 2 Amp
- Average Holding Current: 250 mA

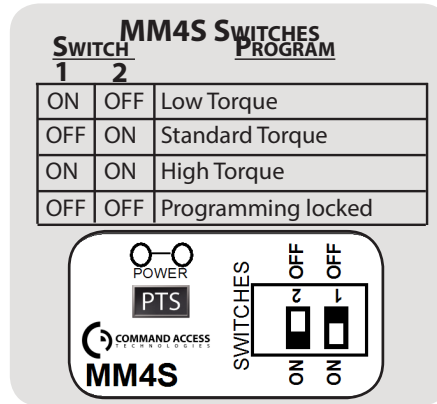

OPTIONAL

REX SWITCH
 Rating: .5A @24VAC
 Configuration:
 GREEN - COMMON (C)
 BLUE - NORMALLY OPEN (NO)
 GRAY - NORMALLY CLOSED (NC)

SETTING PTS

****Important Info****
 Make sure to set PTS before finishing installation!

- Step 1-** Select your preferred torque mode (ships in standard torque) Press the device push pad to the desired setting. (Recommend to fully depress and release 5%, giving the device a little room for changing door conditions.)
- Step 2-** While depressing the push pad, apply power. (i.e. presenting the credential to the reader).
- Step 3-** Continue to keep pad depressed, the device will beep 6 times. After the beeps have stopped, release the pad and now the adjustment is complete. If not to your liking repeat the three steps. That's all there is to it.
- Step 4-** Once you found the right location, switch the dip switches to off to lock in programming.

TROUBLESHOOTING & DIAGNOSTICS

BEEPS	EXPLANATION	SOLUTION
2 Beeps	Over Voltage	> 30V unit will shut down. Check voltage & adjust to 24 V.
3 Beeps	Under Voltage	< 20V unit will shut down. Check voltage & adjust to 24 V.
4 Beeps	Failed Sensor	Verify all 3 sensor wires are installed correctly. Replace sensor if problem persists by contacting office.
5 Beeps	Retraction or Dogging failure	Device physically binding during retraction or pulled from the dogged position. 1. After 1 st fail: 5 beeps then immediately attempts to retract again. 2. After 2 nd fail: 5 beeps with pause in-between for 30 seconds then device attempts to retract again. 3. After 3 rd fail: 5 beeps every 7 minutes, device will not attempt to retract. To Reset: Depress bar for 5 seconds at any time.
6 Beeps	Push to Set	Device is recording it's new position and power mode after the 6th beep.

ELECTRIFIED EXIT DEVICE

Installation Example

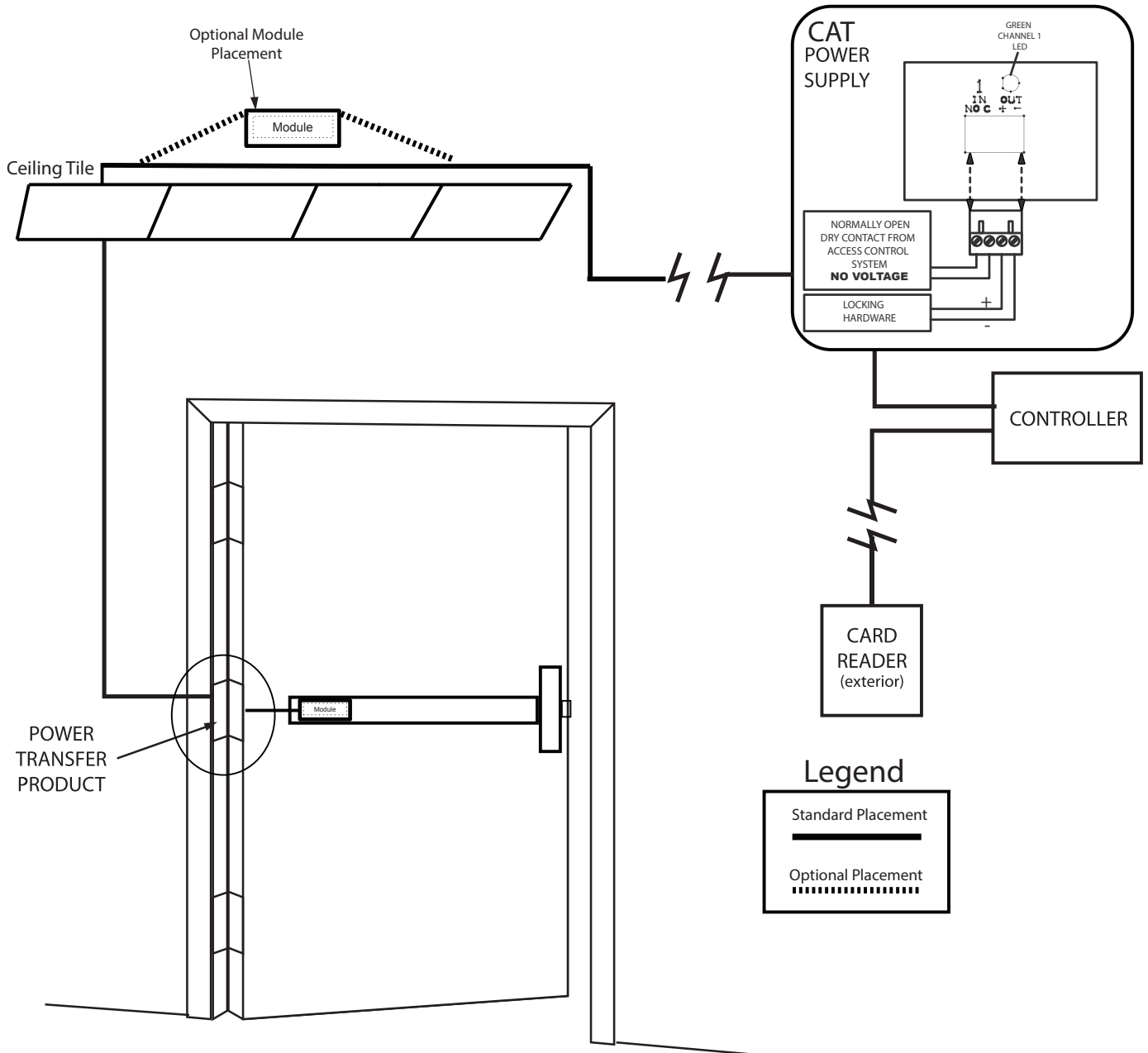

RECOMMEND POWER SUPPLIES:

All Command Access exit devices & field installable kits have been thoroughly cycle tested with Command Access power supplies at our factory.

- PS210
- PS440B
- PS1
- PS5-4
- PS220/220B
- PS480B
- PS2/2B
- PS5-6



For more information [click here](#) or go to our website

Electrified Exit Device

Installation Example

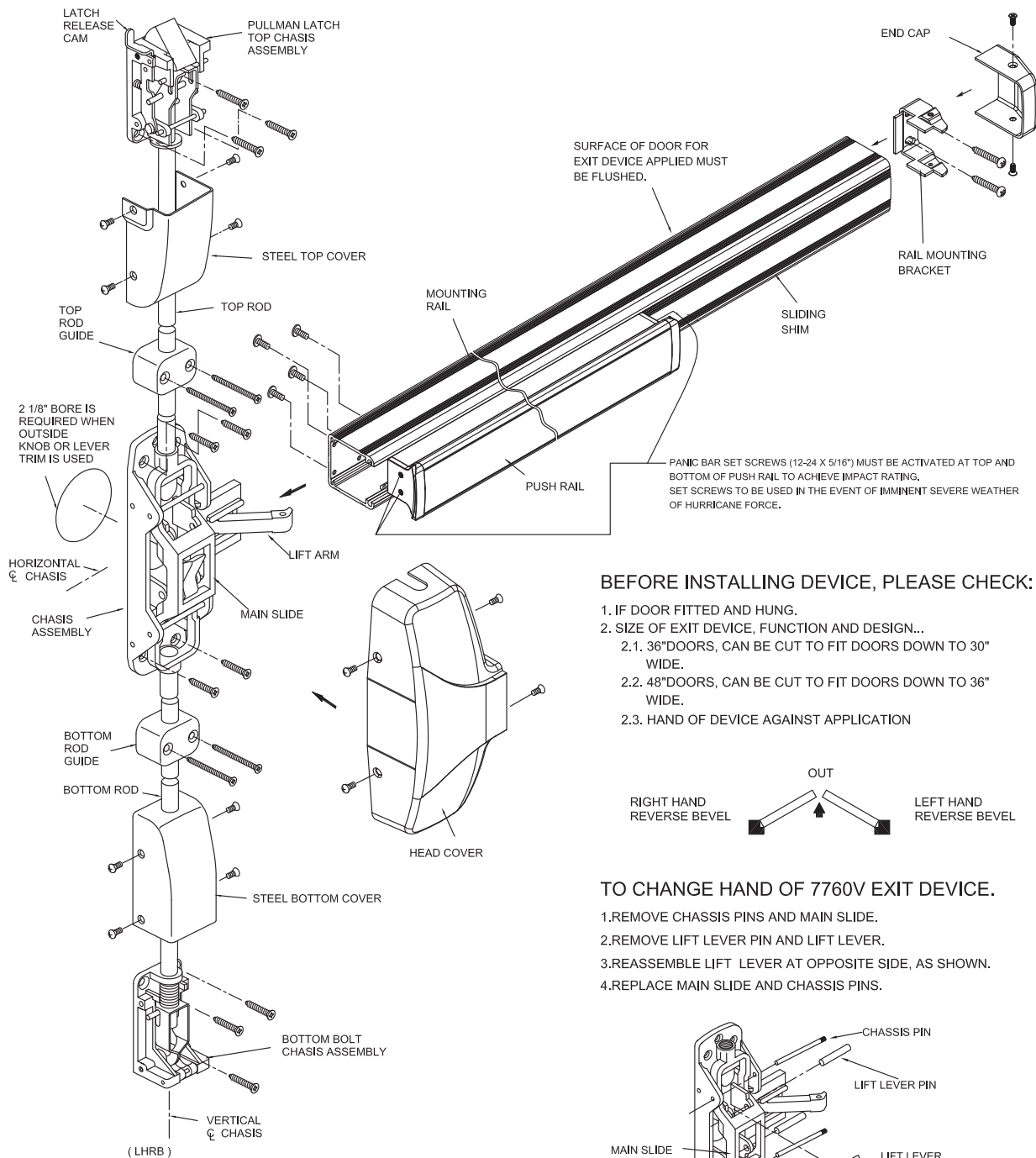

BEFORE INSTALLING DEVICE, PLEASE CHECK:

1. IF DOOR FITTED AND HUNG.
2. SIZE OF EXIT DEVICE, FUNCTION AND DESIGN...
 - 2.1. 36" DOORS, CAN BE CUT TO FIT DOORS DOWN TO 30" WIDE.
 - 2.2. 48" DOORS, CAN BE CUT TO FIT DOORS DOWN TO 36" WIDE.
 - 2.3. HAND OF DEVICE AGAINST APPLICATION

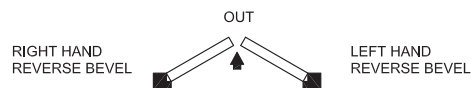

TO CHANGE HAND OF 7760V EXIT DEVICE.

1. REMOVE CHASSIS PINS AND MAIN SLIDE.
2. REMOVE LIFT LEVER PIN AND LIFT LEVER.
3. REASSEMBLE LIFT LEVER AT OPPOSITE SIDE, AS SHOWN.
4. REPLACE MAIN SLIDE AND CHASSIS PINS.

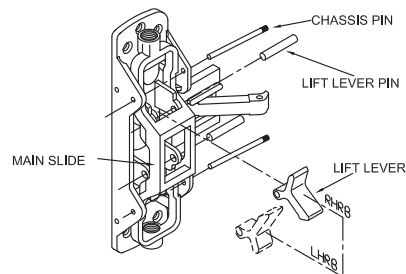

Electrified Exit Device

Installation Example

1. MARK VERTICAL AND HORIZONTAL REFERENCE LINE ON DOOR.

DETERMINE BACKSET TO LOCATE VERTICAL REFERENCE LINE.

1. IF LOCK STILE IS 4-1/2" WIDE OR WIDER, BACKSET IS 2-3/4".
2. IF LOCK STILE IS LESS THAN 4-1/2" WIDE, BACKSET IS HALF OF THE EXPOSED WIDTH OF LOCK STILE.

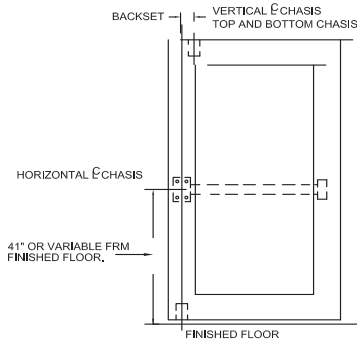

2. PREPARE DOOR

TAPE TEMPLATE ON INSIDE OF DOOR ALONG REFERENCE LINE SPOT AND DRILL HOLE.

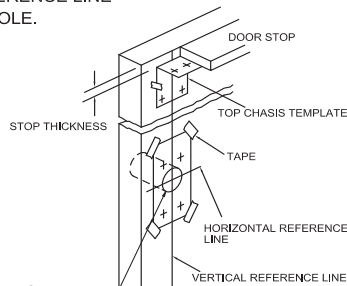

2-1/8" BORE WHEN KNOB AND LEVER TRIM IS USED.

3. APPLY HARDWARE

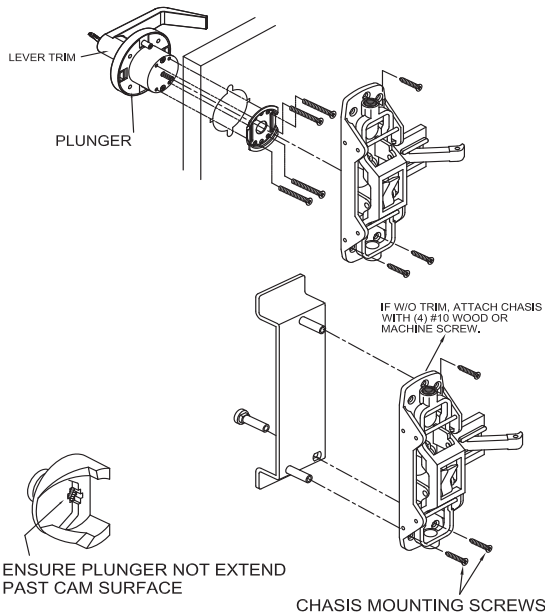

4. ATTACH TOP AND BOTTOM CHASIS

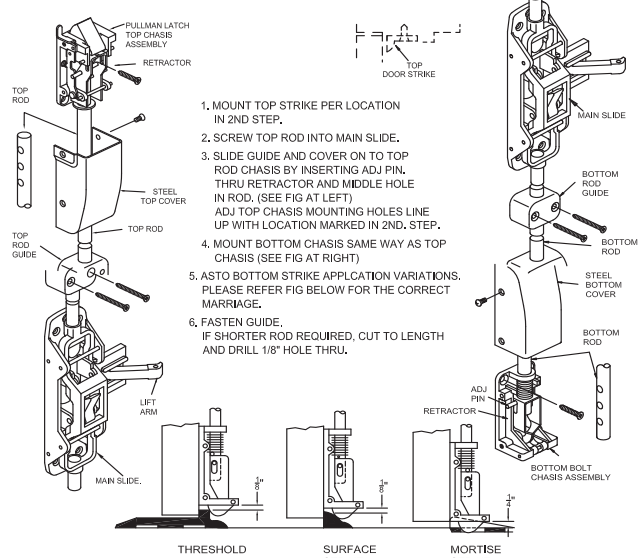

5. APPLY RAIL ASSEMBLY

1. CHECK THE SIZE OF DEVICE, IF CUTTING TO LENGTH IS REQUIRED.
2. DETERMINE CUT OFF LENGTH "X" BY SUBTRACTING 1-3/4" FROM "Y", MARK CUT OFF POINT ON MOUNTING RAIL.

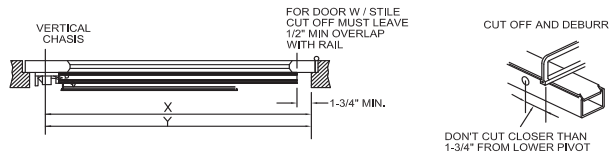

3. DEPRESS ARM INTO RAIL OPENING AND SLIDE RAIL ONTO CHASIS. LEVEL RAIL AND FASTEN CHASIS AND MOUNTING PLATE.

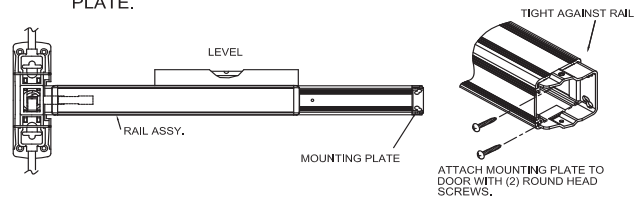

6. APPLY COVER

CHECK FINAL OPERATION OF DEVICE AND ADJUST, THEN FASTEN COVERS.

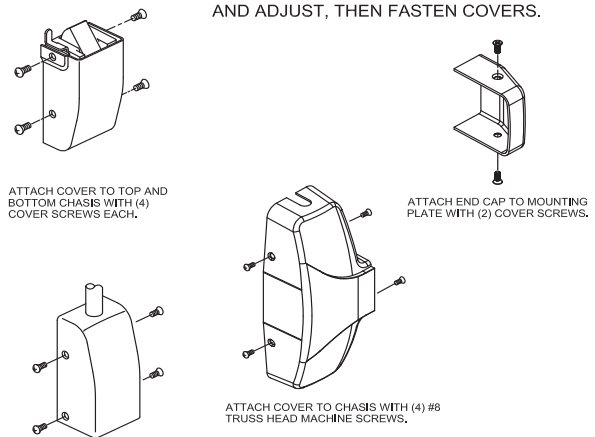

TEMPLATE FOR SVR EXIT DEVICE

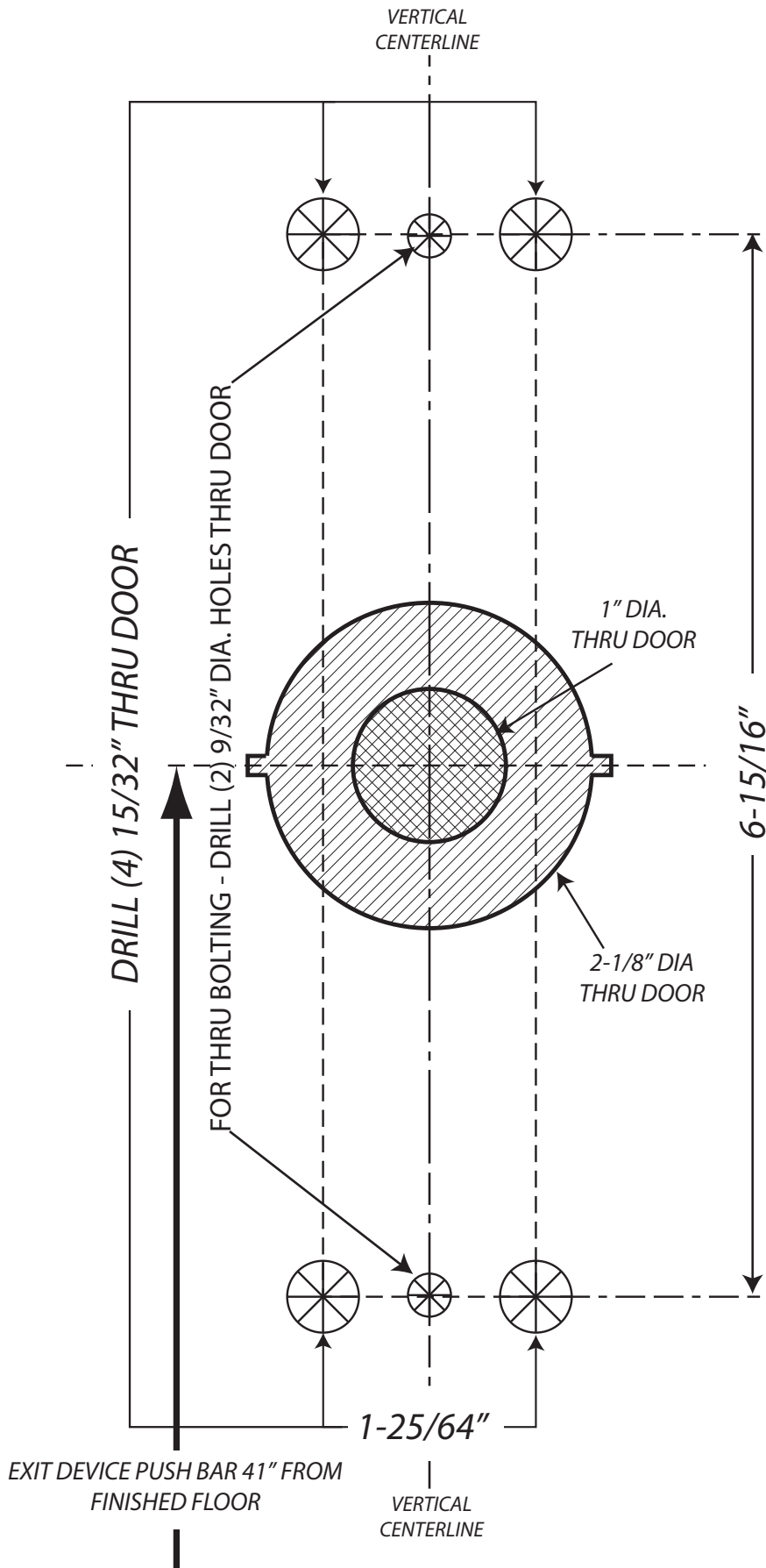

TEMPLATE FOR RIM EXIT DEVICES

TEMPLATE FOR SVR LATCHES

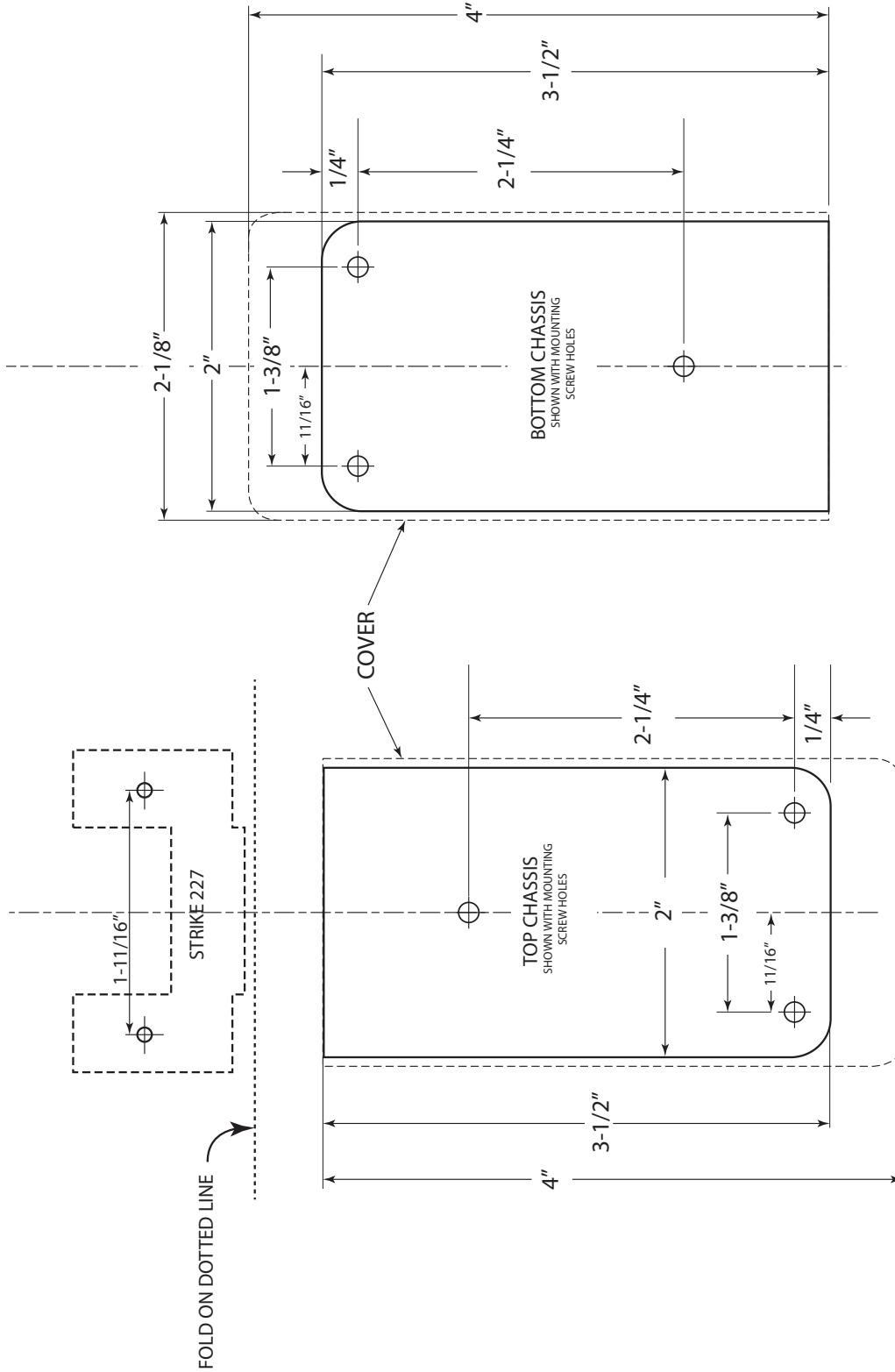

FOR LOCATION ON THE DOOR PLEASE REFER TO PANIC BAR TEMPLATE

<p>22901 La Palma Ave. Yorba Linda CA 92887 USA Tel: (888)622-2377 Fax: (888)622-2302 Web site: commandaccess.com Email: orders@commandaccess.com</p>	<p>DESCRIPTION TEMPLATE FOR NON-FIRE RATED TOP AND BOTTOM CHASSIS ASSEMBLY APPLICABLE FOR 2200, 7700 & 9800 SERIES</p>	<p>ANSI ---</p>	<p>SCALE 1 : 1 IF PRINTED TO SIZE PAGE 1 OF 1</p>	<p>UNIT inches</p>	<p>VERSION ver. 1.0 rev. 03/16</p>
--	---	----------------------------	--	-------------------------------	---

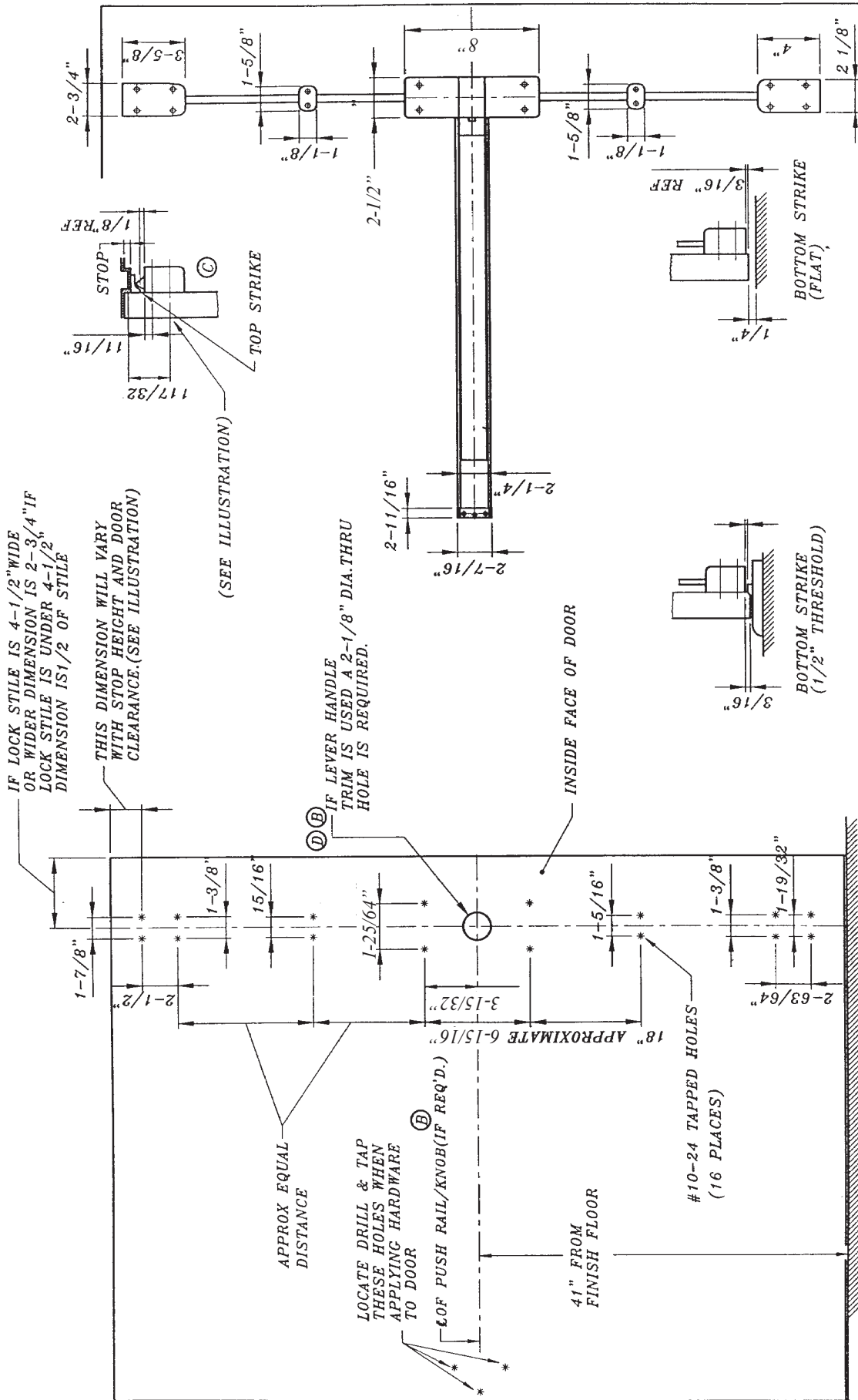

5. SURFACE OF DOOR WHERE EXIT DEVICE IS TO BE APPLIED MUST BE FLUSH
4. SEE MASTER SHEET FOR AREAS REQUIRING REINFORCEMENTS
3. SEE STRIKE TEMPLATE FOR TOP AND BOTTOM STRIKES.
2. WE RECOMMEND THAT ALL TAPPED HOLES BE DRILLED & TAPPED IN FIELD
1. TOLERANCE ON ALL DIMENSIONS ± 1/64"