

6300/6400C/CF EXIT INSTALLATION INSTRUCTION

CVR DEVICE – STEEL OR WOOD DOOR

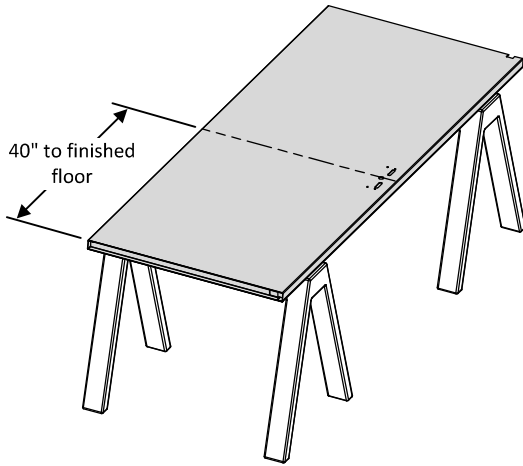

Phone: 833-2-PDQTEC | www.pdqlocks.com



1. PREPARE DOOR

- Prepare door according to template.
- Refer to trim template if installing trim.

2. ASSEMBLE LATCHES AND RODS

- Attach rod to top latch using spring pin.
- Thread CVR linkage into each rod.
- Orient bottom latchbolt with screw and washer pointing toward pull side of door.

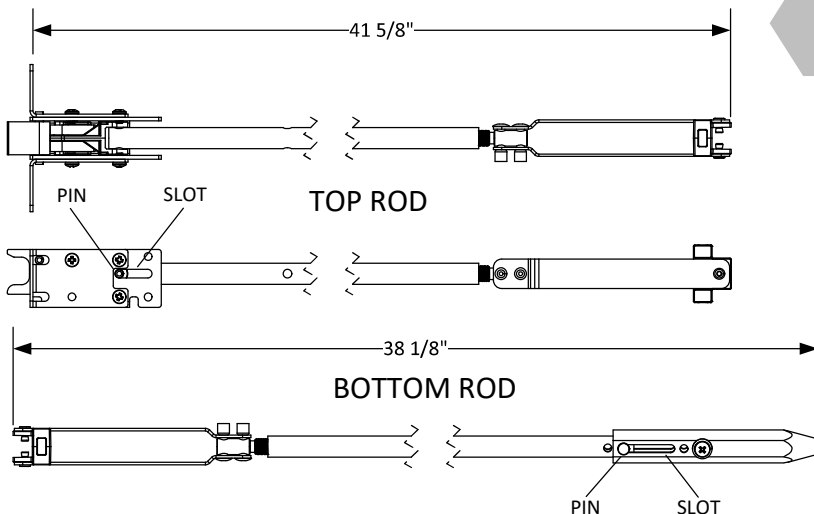
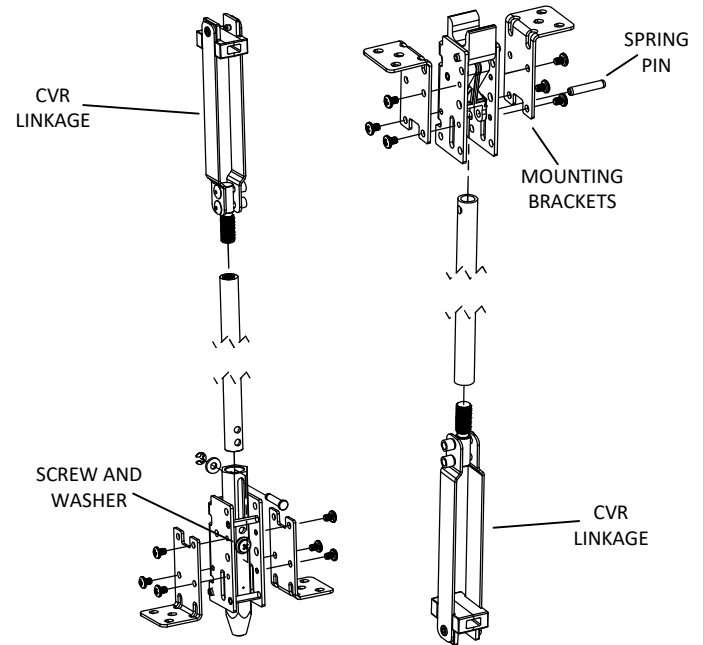

3. ADJUST RODS

- Top rod length, measure from top of door to device centerline. Subtract 2 1/4". This is the overall length with the pin in the up position of the slot as shown. Example: $43 \frac{7}{8}'' - 2 \frac{1}{4}'' = 41 \frac{5}{8}''$
- Bottom rod length should be set to 38 1/8" measuring end to end if the device is installed 40" above the finished floor. Be sure the pin is at the top of the slot in the bottom latch bolt as shown.

6300/6400C/CF EXIT INSTALLATION INSTRUCTION

CVR DEVICE – STEEL OR WOOD DOOR



4. INSTALL LATCHES IN DOOR

- Slide the assembled latches and rods into the door.
- Fasten with #10-24 screws.

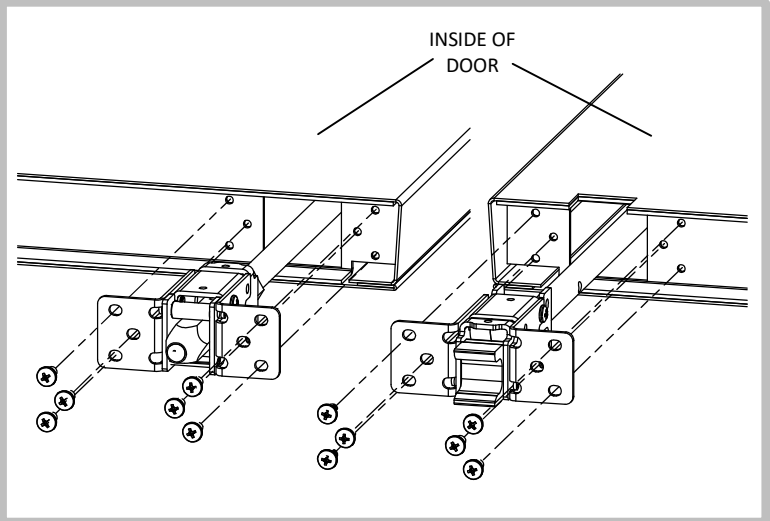

5. SIZE DEVICE

- Standard lengths are for 36" or 48" door. Device must be cut for other lengths.
- Mark length with tape – length equals device size minus desired door size (for 30" door = cut 6" off 36" device) ensuring a square cut.

Maximum cut off length:

	Panic	Fire	Alarm	MLR
36" Device	6"	8"	2"	3"
48" Device	12"	14"	8"	9"

6. INSTALL CVR LIFT BARS

- Adjusting screw and retainer are factory installed without the CVR lift bars for shipping.
- Remove CVR adjusting screw retainers and adjusting screws.
- Insert CVR lift bar into CVR carriage from bottom of device.
- Thread adjusting screw into CVR lift bar through the CVR carriage until the lift bar is centered on the threads.
- Insert the adjusting screw retainer into the notched area of the adjusting screw.
- Tighten #4-40 locking screw.

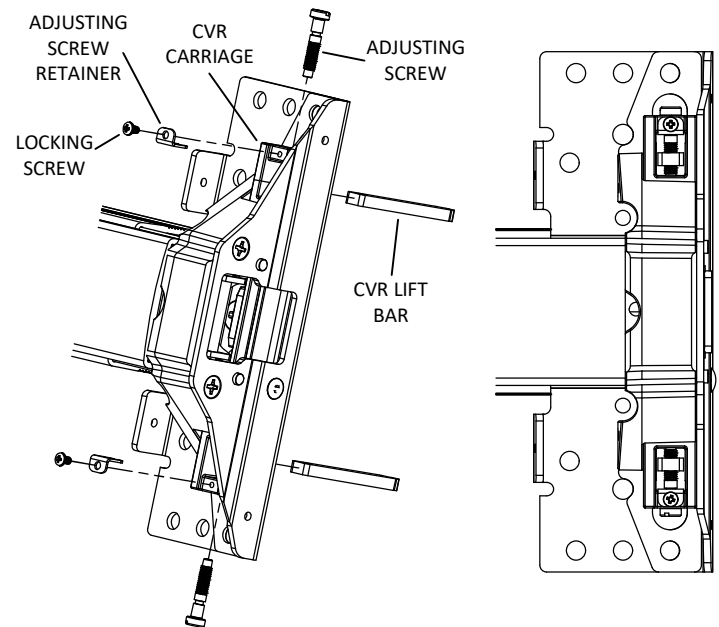

6300/6400C/CF EXIT INSTALLATION INSTRUCTION

CVR DEVICE – STEEL OR WOOD DOOR



Phone: 833-2-PDQTEC | www.pdqlocks.com

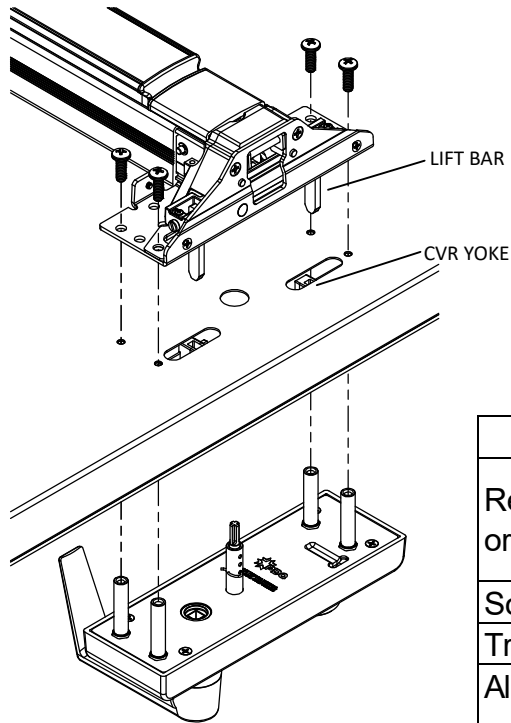

7. INSTALL DEVICE

- Install device and trim with 1/4-20 screws from pack #639043.
- Verify CVR lift bars engage into CVR yokes for both top and bottom latches.
- Device can be surface mounted to the door, optional sex nuts are available, device is through bolted if using trim.

Mounting Options:

Reinforced Steel or Aluminum Door	Surface mount: Drill/tap push side for 1/4-20
Solid Wood Door	Drill 1/8" pilot hole for #10 wood screw
Trim	Refer to template
All Others	Use optional Sex Bolts. Drill push side with 9/32" drill bit. Drill pull side with 3/8" drill bit.

8. INSTALL END CAP

- Slide end cap into rail. Ensure rail is square to door. Mark the centers of the slots.
- Remove end cap, drill holes using the chart from Step 7.
- Reinstall end cap and fasten with screws.
- Hang door on frame.

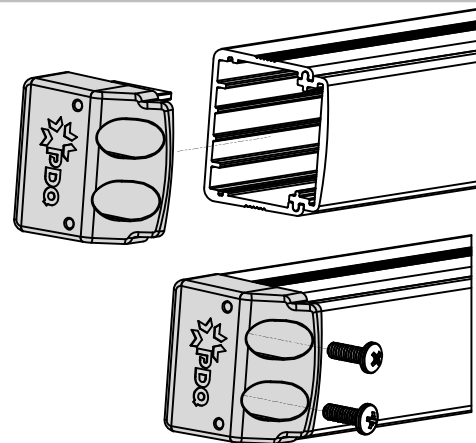

9. INSTALL TOP STRIKE

- Install strike using two #10-24 flat head screws from pack #639054.
- Adjust strike to secure door.
- Install third flat head locking screw by drilling and tapping for #10-24 after final adjustment is achieved.

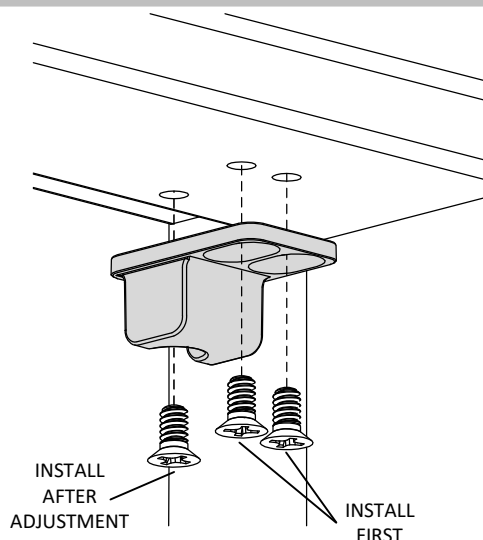

6300/6400C/CF EXIT INSTALLATION INSTRUCTION

CVR DEVICE – STEEL OR WOOD DOOR



10. INSTALL BOTTOM STRIKE

- Close door and mark center of bottom bolt on floor or use template.
- Center strike and mark location of screw holes.
- Drill strike hole and anchor holes according to template.
- Install plastic anchors into floor.
- Install strike using two flat head screws.

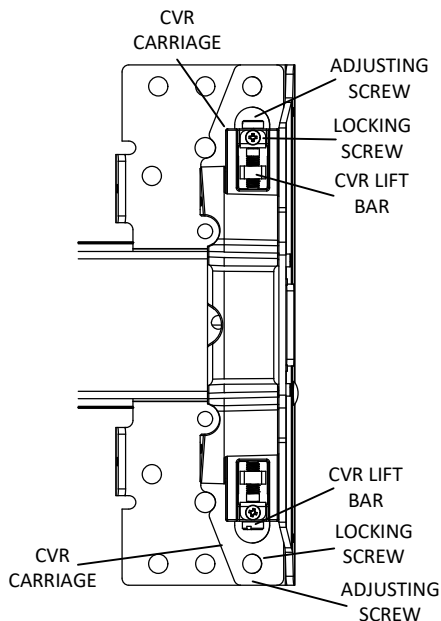
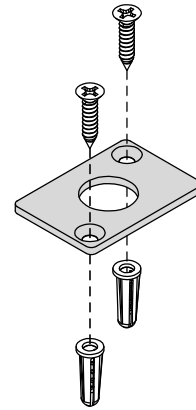

11. FINE ADJUST RODS

- Check top rod adjustment by opening the door, depressing pushbar then releasing. If CVR carriage drops more than 1/16" the top CVR lift bar must be adjusted downward. If door is difficult or unable to be opened the top CVR lift bar must be adjusted upwards.
- Check bottom rod adjustment by opening door. With door opened and pushbar released, lower bolt should be 1/16" above strike.
- To adjust the top or bottom CVR lift bar, first loosen the locking screw, then rotate the adjusting screw to raise or lower the CVR lift bar as need. Tighten locking screw when adjustment is completed.

12. INSTALL HEAD COVER

- Slide head cover onto exit device
- Install 4 mounting screws

