

Pemko Cushion Stop for Stainless Steel Sliding Track Hardware Systems

The innovative Cushion Stop is available with the Pemko Stainless Steel Sliding Track Hardware systems. The Cushion Stop gently catches the hanger and cushions the landing of the door, preventing racking of the system and bounce back into the opening.

The stop attaches to the track and is easy to install and adjust. It also provides hold open/close functionality eliminating door creep into the opening.

The Cushion Stop is available when ordering W60 and W100 Stainless Steel Sliding Track Hardware systems, or as a retrofit kit for existing Pemko W60 or W100 systems.

Applications:

- Hospitality
- Office Buildings
- Multi-Family
- Mixed Use

Features	Benefits
Cushion Stop gently catches the hanger and cushions the door landing	Prevents racking, extending the life of the track hardware
Prevents door from rebounding off stop when opening	Eliminates door bounce back
Provides hold open/closed door functionality	Prevents door creeping
In-house tested to meet strict performance standards	System meets performance requirements of ANSI/BHMA 156.14

Patent Pending.

© 2014-2017
Pemko Manufacturing Co.

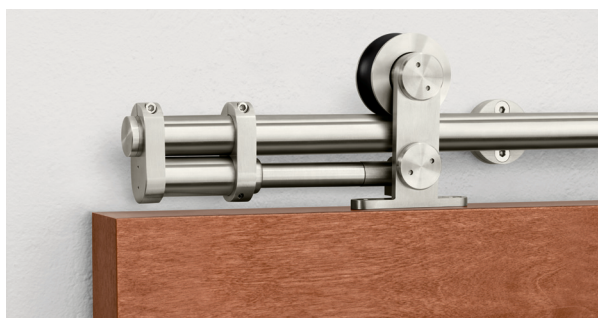

ASSA ABLOY is the global leader in door opening solutions, dedicated to satisfying end-user needs for security, safety and convenience

ASSA ABLOY

The Cushion Stop is available when ordering the following Sliding Track Systems or as retrofit kits.

W60 System with Cushion Stop (p/n CS-W60)

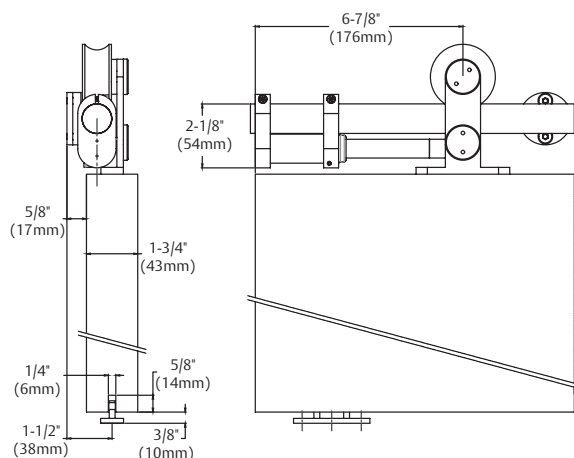

W100 System with Cushion Stop (p/n CS-W100)

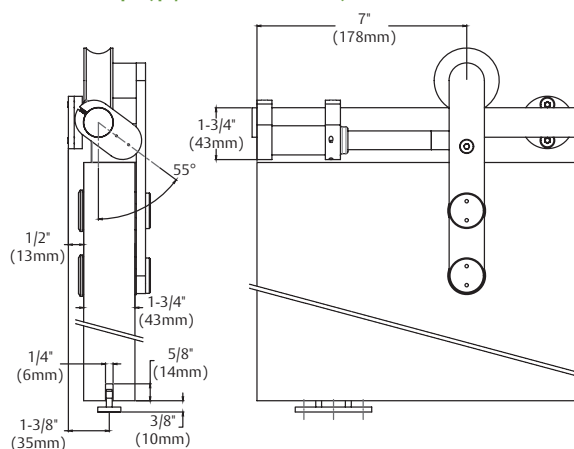

Technical Specifications:

Materials:

304 Stainless Steel Track and Hangers
Nylon coated rollers

System Includes:

Stainless Steel Track (6'6" or 8'2"*) with End Caps
2 Door Hangers
Wall Brackets
1 Door Bottom Guide
2 Cushion Stops
Mounting and Installation Hardware
*Custom track lengths are available

Retrofit Kits:

Cushion Stop Retrofit Kits are available for existing Pemko systems:
W60- Retrofit kit number CS-001
W100- Retrofit kit number CS-003

Finish Options:

Brushed Stainless Steel, Dark Bronze
Stainless Steel or Polished Stainless Steel

Standards:

Meets performance requirements of ANSI/BHMA 156.14 (Grade 1) for sliding doors by exceeding 100,000 cycles in operation

Door Specifications:

Door Weight up to 176 lbs (with CS-W60 kit) or 198 lbs (with CS-W100 kit)
Wood Doors 1 3/4" thick
Door Bottom 3/8" undercut
Can include lites or tinted glass

Patent Pending

ASSA ABLOY
5535 Distribution Drive
Memphis, TN 38141
websales@pemko.com • www.pemko.com

MEMPHIS, TN USA
P: 800 824-3018
F: 800 243-3656

VENTURA, CA USA
P: 800 283-9988
F: 800 283-4050

VANCOUVER, BC CA
P: 877 535-7888
F: 877 535-7444

TORONTO, ON CA
P: 877 535-7888
F: 877 535-7444