

9900 & 12-9900

Mortise Lock Exit Device

See Figure 1 for identification of parts.

Review the dimensions on the template to obtain the correct height from finished floor.

1. Locate and place template as follows:
 - a. Stick center case and lock front template on door as illustrated in Figure 2.
 - b. Using the cross bar hole centers for measuring, locate the vertical center line of bracket.

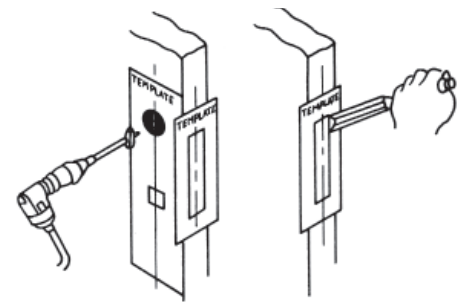
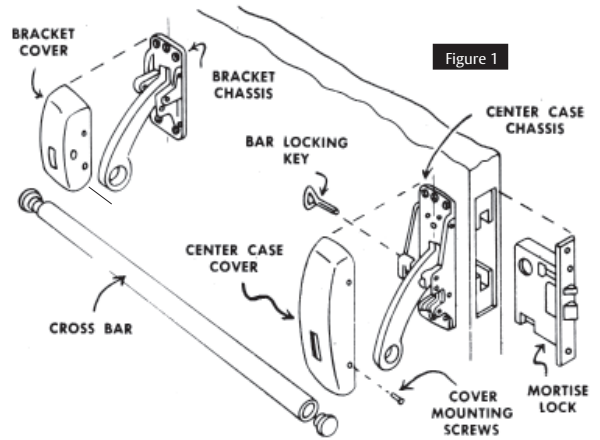
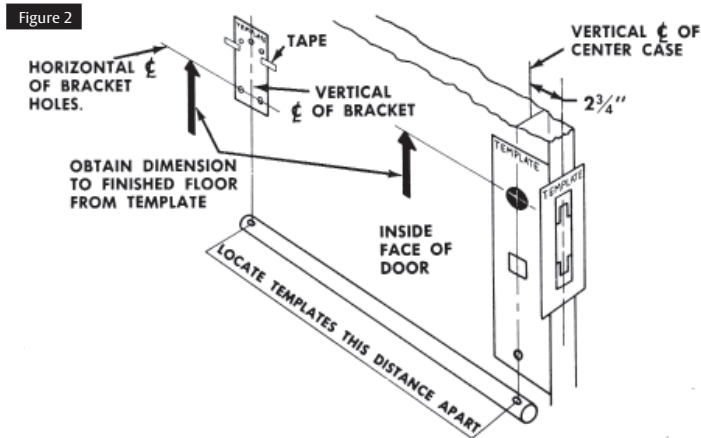

2. Drill holes and mortise for lock as directed by the templates. See Figure 3.
3. If screwless rose outside trim is used, see separate instruction sheet and install rose at this time. See Figure 4.
4. Fasten mortise lock in place. See Figure 5.

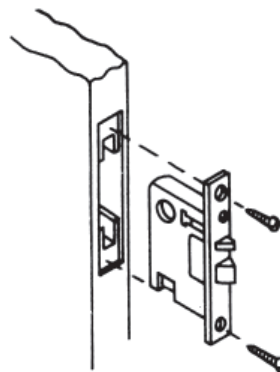

5. **IMPORTANT:** Mount the center case chassis as follows:
 - a. Remove cover from center case chassis. Lock down arm. (For exit devices less the cross bar lock down feature, hold arm in depressed position.) See Figure 6.
 - b. Position center case chassis against the door so that the center case lever is under the rear lever of the mortise lock.
 - c. Lift center case chassis upward until the latch bolt is completely retracted.
 - d. With chassis in this position, mark location of the screw holes.
 - e. Drill holes for screws and mount center case chassis to the door.

NOTE: If thru bolted trim is used, drill four 7/32" diameter holes through the door and counterbore outside of the door for lugs.

6. Attach outside trim when used.
 - a. Install cylinder and tighten cylinder set screw in lock front.
 - b. Attach center case cover to chassis.
7. Mount bracket chassis on door and attach bracket cover to chassis.
8. Assemble and secure cross bar to arms.
9. Mortise strike in position.

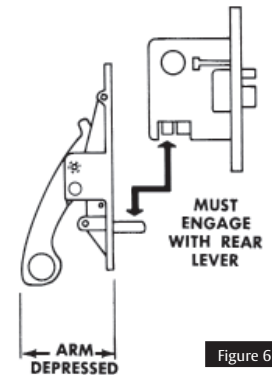

Figure 6

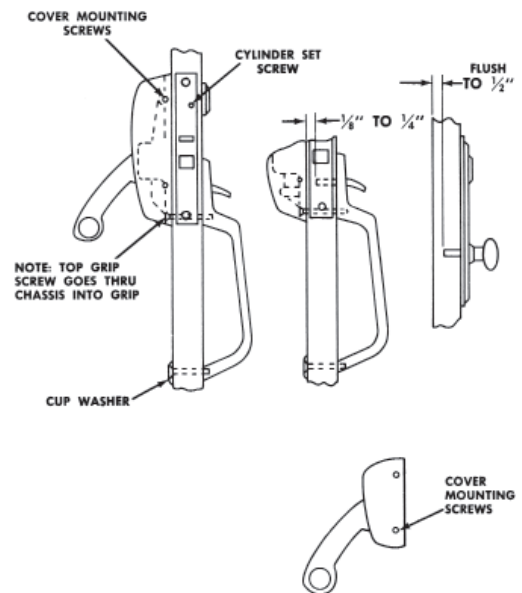

Figure 7

⚠ WARNING

This product can expose you to lead which is known to the state of California to cause cancer and birth defects or other reproductive harm. For more information go to www.P65warnings.ca.gov.

A5572F 4/21