



MB700-ID

Multi-biometric Access Control

Modern, accurate and affordable standalone fingerprint, facial and RFID reader



Multi-biometric technology:

Identify or verify users by their face, fingerprint, proximity card or PIN/password... or any combination, all conveniently from a single device. Built-in infrared light source enables operation in dimly lit rooms.



Communication:

MB700-ID installs easily on your network having both TCP/IP and RS232/485 serial ports. Its USB port allows for offline data backup and management when the network is unavailable.



Capacity:

Supports one to many (1: N) matching for up to 1,500 faces and 2,000 fingerprint templates and 10,000 cards/badges. Stores up to 100,000 transactions.



Options:

MB700-ID can be configured with optional internal modules which read HID Prox or 13.56 MHz Mifare cards.



Display/Audio:

Stunning 3-inch color TFT touch screen provides ease of use and rich user experience with intuitive and user friendly GUI. Includes both voice and visual prompts which indicate the acceptance or rejection of fingerprint, face, prox card or PIN/Password.



Access control:

Contact Relays for door locks, exit button, alarms & bell. Supports 50 time zones, 99 groups and 10 unlock combinations. Wiegand IN and OUT ports can be used to connect MB700-ID to any ZK or 3rd party access control panels and peripherals.



For Software Developers:

Free SDK and development tools are available for developers/partners who wish to integrate MB700-ID with any application which requires verifying people. Custom development is also available for OEM partners upon request.

Standalone Installation

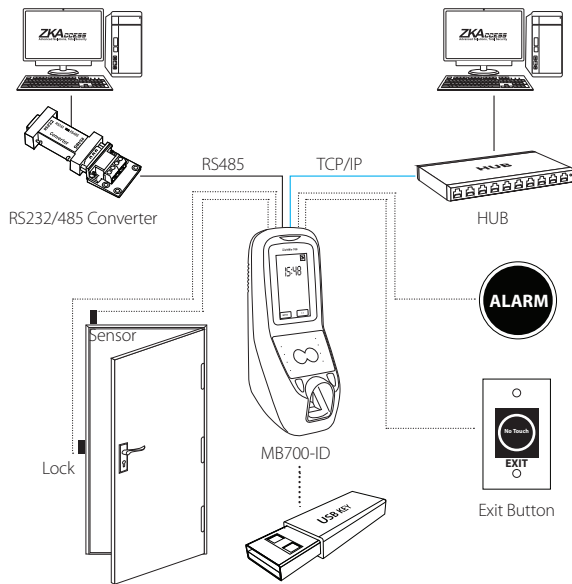

Installation with Access Control Panel

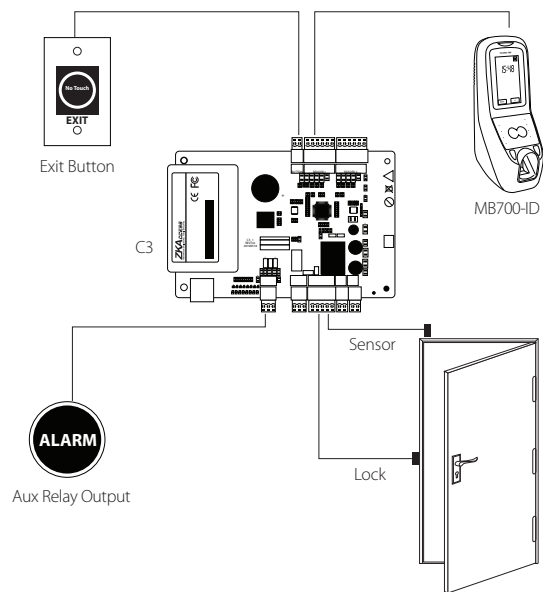

Specifications

Capacity

Face: 1,500
Fingerprint: 2,000
Cards: 10,000

Display

3 inch TFT Touch Screen Display

Camera and Light Source

640 x 480 pixel camera
Highly efficient infrared light source

Power

12V DC, 3A

Communication

Ethernet, RS 232, RS485,
Weigand Input and Output, USB Host

Environment

Operating Temperature:
32° to 113° F (0° to 45° C)
Operating Humidity: 20% to 80%

Dimensions

Depth: 7.7 in (19cm)
Width: 3.9 in (10cm)
Height: 10.8 in (27cm)
Weight: 3lbs (1.36kg)

Supported Card Formats

ZKAccess 125 kHz prox
HID 125 kHz prox
Mifare

Part Numbers

MB700-ID: with ZKAccess prox card reader
MB700-HID: with HID 125 kHz prox card reader
MB700-M: with Mifare card reader

What's in the Box

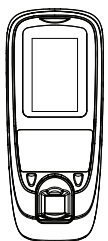

MB700-ID

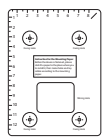

Installation Template

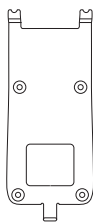

Back Plate

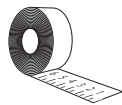

Measuring Tape



Network Cable



Screws

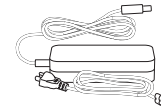

AC Power Adapter

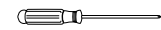

Screwdriver



Cables

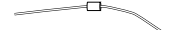

Diode

ZKTeco USA

6 Kingsbridge Road, Unit 8, Fairfield, NJ 07004
Phone: (862) 505-2101 • Fax: (862) 204-5906 • sales@zkaccess.com • www.zkaccess.com

© Copyright 2016. ZKTeco Inc. ZKTeco Logo and ZKAccess Logo are registered trademarks of ZKTeco or a related company. All other product and company names mentioned are used for identification purposes only and may be the trademarks of their respective owners. All specifications are subject to change without notice. All rights reserved.

