



PRO SERIES

ProBio-ID

Multi-Biometric Face & Fingerprint Access Control Reader

ProBio-ID is the first access control reader to apply the most advanced SilkID fingerprint and face recognition technology together. ProBio-ID can operate in both bright light and total darkness.



Multi-biometric technology:

Identify or verify users by their face, fingerprint, proximity card or PIN/password... or any combination, all conveniently from a single device. Built-in infrared light source enables operation in dimly lit rooms.



Communication:

ProBio-ID installs easily on your network having both TCP/IP and RS485 serial ports. Its USB port allows for offline data backup and management when the network is unavailable.



Display/Audio:

Stunning 3-inch color TFT touch screen provides ease of use and rich user experience with intuitive and user friendly GUI. Includes both voice and visual prompts which indicate the acceptance or rejection of fingerprint, face, prox card or PIN/Password.

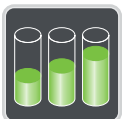

Capacity:

Supports one to many (1: N) matching for up to 2,000 faces and 4,000 fingerprint templates and 10,000 cards.



Options:

ProBio-ID can be configured with optional internal modules which read HID Prox, HID iclass or 13.56 MHz Mifare cards.



Access control:

Contact Relays for door locks, exit button, alarms & bell. Supports 50 time zones, 99 groups and 10 unlock combinations. Wiegand IN and OUT ports can be used to connect ProBio-ID to any ZK or 3rd party access control panels and peripherals.



For Software Developers:

Free SDK and development tools are available for developers/partners who wish to integrate ProBio-ID with any application which requires verifying people. Custom development is also available for OEM partners upon request.

Configuration

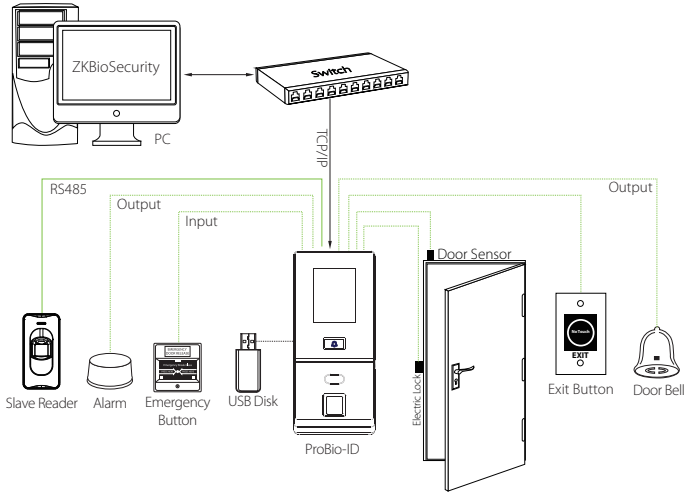

Dimensions

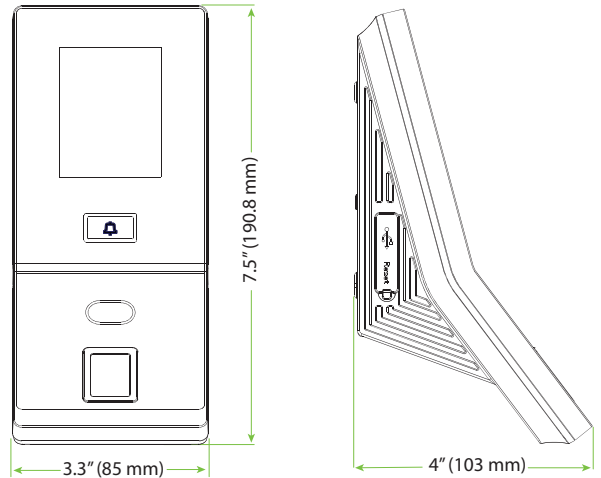

Specifications

Capacity

Faces: 2,000 (4,000 1:1)
 Fingerprints: 4,000
 Cards: 10,000

Access Control Interface

Lock Relay Output
 Alarm Output/Auxiliary Input
 Exit Button/Door Sensor
 Doorbell Output

Communication

TCP/IP, RS485 (for slave reader)
 USB Host
 Wiegand Input/Output

Hardware

SilkID Fingerprint Sensor
 2.8 Inch TFT-LCD Touch Screen
 125 kHz ZKAccess Card Reader
 Tamper Switch Alarm

Standard Functions

Access Levels/Groups/Holidays
 DST/Bell Schedule
 Duress Mode (Password)
 Anti-Passback
 Record Query
 Custom Wallpaper & Screen Saver

Software Compatibility

ZKBioSecurity

Additional Info

Working Temperature:
 14° F to 122° F (-10° C to 50° C)
 Dimensions: 7.5 x 3.3 x 4 inches
 Package Includes: 12V 3A Power Supply

Power

Operating Voltage 12V DC
 Current Draw < 500mA

Part Numbers

ProBio-ID

includes ZKAccess card reader

ProBio-HID

includes HID 125 kHz card reader

ProBio-Mifare

includes Mifare card reader

ProBio-iClass

includes HID iClass card reader

What's in the Box

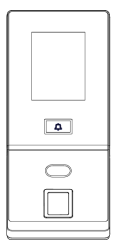

ProBio-ID



Installation Template

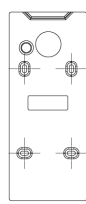

Back Plate

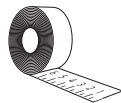

Measuring Tape



Network Cable



Screws

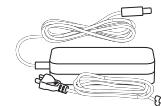

AC Power Adapter

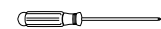

Screwdriver



Cables

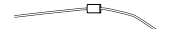

Diode

ZKTeco USA

6 Kingsbridge Road, Unit 8, Fairfield, NJ 07004
 Phone: (862) 505-2101 • Fax: (862) 204-5906 • sales@zkaccess.com • www.zkaccess.com

© Copyright 2016. ZKTeco Inc. ZKTeco Logo and ZKAccess Logo are registered trademarks of ZKTeco or a related company. All other product and company names mentioned are used for identification purposes only and may be the trademarks of their respective owners. All specifications are subject to change without notice. All rights reserved.

