

TownSteel e-Genius 2000 Series Programming Guide

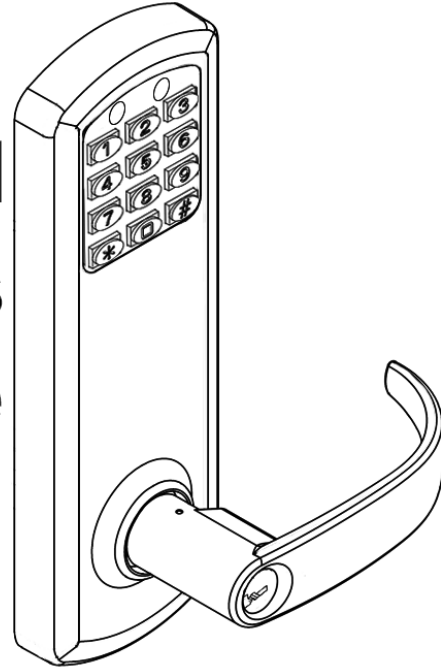

Index

Definitions.....	2
Factory Default Settings.....	3
Important Notes	3
Change Master Code.....	4
Add Codes.....	4
Add a User Code	
Add Multiple User Codes	
Add Service Code	
Delete Codes	5
Delete User Code	
Delete Service Code	
Delete All Service Codes	
Disable Codes	5
Disable all Codes	6
Passage Mode.....	6
Pass Time	7
Sound	7
Lock Status Indicator	7
Penalty Time	8
Identify User ID	8
Next Free User ID.....	9
Reset Lock to Factory Default Settings.....	9
Low Battery	10

Definitions

- **Code Length:** Length of Master Code defines the length of all other codes. Length of codes can be 4, 5, or 6 digits. Master Code and User Codes must be the same length.
- **LED Indicator:** LED indicators are located at the top outside of the lock. Lock flashes green LED and/or red LED dependent on inputs.
- **Master Code:** Code used to program the lock and unlock the lock. Factory Default Settings Master Code is 12345 - this must be changed before programming the lock. Each lock has only one Master Code. Multiple locks can have same Master Code.
- **User ID:** Two-digit identification numbers for User Codes. Each User Code must have a User ID (00-99).
- **User Code:** Codes used to unlock the lock. User Codes are programmed by Master Code. Lock can have a maximum of 100 User Codes. Program 02 programs User IDs and their User Codes.
- **Service Code (One-time User Code):** Code that allows one entry per code. Service Code is deleted after it has been used. Lock can have a maximum of 5 Service Codes active simultaneously.
- **Passage Mode:** Mode that keeps the lock unlocked until it is disabled. Factory Default Settings has this mode disabled. Program 40 enables Passage Mode and Program 41 disables Passage Mode.
- **Pass Time:** Period that a lock stays in unlocked position after a valid code is entered. Factory Default Settings Pass Time is 5 seconds. Program 42 adjusts Pass Time from 2 to 20 seconds. Stays in unlocked position. Turning inside or outside lever opens the lock.
- **Sound:** Keypad sound is enabled by Factory Default Settings. Disabling the sound does not affect general operation and programming of the lock. Program 73 disables sound and Program 71 enables Sound.
- **Lock Status Indicator:** LED indicator on lock to show whether it is locked (flashing red LED) or unlocked (flashing green LED). Program 91 enables or disables the lock status indicator.
- **Penalty Time (Keypad Anti-Tamper Lockout Time):** Period that a lock stays in locked position after it reached its max number of incorrect code entries. During Penalty Time, no other codes will be accepted. Factory Default Settings Penalty Time is 60 seconds after 3 invalid tries. Program 92 adjusts Penalty Time from 0 (disabled) to 90 seconds after 0 (disabled) to 9 tries. This is used to prevent unauthorized entry.

Factory Default Settings

Master Code: 12345

Passage Mode: Disabled

Pass Time: 5 seconds

Sound: Enabled

Lock Status Indicator: Disabled

Penalty Time (Keypad Anti-Tamper Lockout Time): 60 seconds after 3 Invalid Code Entries

Important Notes

- Factory Default Settings Master Code must be changed before programming any other codes.
- Manufacturer assumes no liability, direct or indirect, due to failure to change Master Code.
- Pressing the Star (*) key will cancel any on-going program sequence or code input.
- Pressing the Pound (#) key starts programming.
- Programming can be done only if the lock is locked.
- Replacing batteries does not change existing settings.
- During programming, green LED indicator indicates success and the red LED indicator indicates failure.
 - One green LED flash and 2 short beeps occurs after each program sequence. (●)
 - Two green LED flashes and 2 beeps (one short beep and one long beep) occur at the end of each successful program sequence (●●).
 - One red LED flash and 1 long beep indicates failure during program sequence.
- The red LED will flash 0.5 second (with one long beep) after an invalid code is entered.
- It is important to maintain track of user ID's and Codes used in the system to use certain features.
- The length of the Master Code defines the length of all other codes. It cannot be changed to other lengths unless factory default settings are restored.

Disclaimer - *The codes used in the following examples are not recommended for actual valid codes. Accepted protocol should be followed for secure codes. Repeated strings of numbers are not secure.*

Change Master Code

Key Sequence

[#] [Master Code] • [01] • [1-digit Code length] • [New Master Code] • [New Master Code] ••

- *For example*, to change Master Code to “5555”, Press: [#] [12345] • [01] • [4] • [5555] • [5555] ••
- The length of the Master Code defines the length of all other codes. It cannot be changed to other lengths unless factory default settings are restored.

Add Codes

Add a User Code

Key Sequence

[#] [Master Code] • [02] • [2-digit User ID] • [New User Code] ••

- *For example*, to add User Code of “2010” with User ID 01, Press: [#] [5555] • [02] • [01] • [2010] ••

Add Multiple User Codes

Key Sequence

[#] [Master Code] • [02] • [2-digit User ID] • [New User Code] •• [Second 2-digit User ID] • [Second New User Code] •• ... *And so forth*

- *For example*, to add User Codes “2020”, “2030” and “2040” with User ID 10, 11, and 12 respectively, Press: [#] [5555] • [02] • [10] • [2020] •• [11] • [2030] •• [12] • [2040] ••
- Input of additional User Codes must start before the green LED indicator stops flashing (8 Seconds), otherwise start process from beginning.

Add a Service Code

Key Sequence

[#] [Master Code] • [2] [1-digit Service Code ID] • [Enter Service Code] ••

- *For example*, to add Service Code 1 “9999”, Press [#] [5555] • [2] [1] • [9999] ••
- Up to 5 Service Codes can be programmed. Use Service Codes ID’s 1, 2, 3, 4, or 5.

Delete Codes

Delete a Code

Key Sequence

[#] [Master Code] • [03] • [2-digit User ID] ••

- *For example, to delete User Code “2040” with User ID “04”, Press: [#] [5555] • [03] • [04] ••*

Delete a Service Code

Key Sequence

[#] [Master Code] • [3] [1-digit Service Code ID] ••

- *For example, to delete Service Code 1, Press [#] [5555] • [3] [1] ••*

Delete All Service Codes

Key Sequence

[#] [Master Code] • [30] • [30] ••

- *For example, to delete all Service Codes, Press [#] [5555] • [30] • [30] ••*

Disable a Code

Disable a User Code

Key Sequence

[#] [Master Code] • [04] • [2-digit User ID] ••

- *For example, to disable User Code “2030” with User ID “03”, Press [#] [5555] • [04] • [03] ••*

Enable a User Code

Key Sequence

[#] [Master Code] • [05] • [2-digit User ID] ••

- *For example, to enable User Code “2030” with User ID “03”, Press [#] [5555] • [05] • [03] ••*

Disable all User Codes

Disable all User Codes

Key Sequence

[#] [Master Code] • [06] ●●

- *For example*, to disable all User Codes, Press [#] [5555] • [06] ●●
- All User Codes are disabled, and Service Codes are deleted.

Enable all User Codes

Key Sequence

[#] [Master Code] • [08] ●●

- *For example*, to enable all User Codes, Press [#] [5555] • [08] ●●
- All User Codes are enabled, and Service Codes must be re-programmed.
- If Codes are disabled using Program 06 and a new User Code is subsequently added (or an existing Code changed), the new (or changed) User Code will automatically become enabled.

Passage Mode

Enable Passage Mode

Key Sequence

[#] [Master Code] • [40] ●●

Disable Passage Mode

A valid code will be required to unlock the door.

Key Sequence

[#] [Master Code] • [41] ●●

- Lock will stay in unlocked position until Passage Mode is disabled.
- Only the Master Code can enable or disable Passage Mode.

Pass Time

Key Sequence

[#] [Master Code] • [42] • [2-digit XX seconds] ••

- Pass Time changes to XX seconds and XX is programmable from 2 seconds to 20 seconds.

Sound

Disable Keypad Sound – Sound Off

Key Sequence

[#] [Master Code] • [73] ••

Enable Keypad Sound – Sound On

Key Sequence

[#] [Master Code] • [71] ••

Lock Status Indicator

Enable Lock Status Indicator – Status Locked (Red LED)

Key Sequence

[#] [Master Code] • [91] • [2] ••

Enable Lock Status Indicator – Status Unlocked (Green LED)

Key Sequence

[#] [Master Code] • [91] • [3] ••

- Red LED flashes when door is locked; Green Led flashes when door is unlocked or in Passage Mode

Disable Lock Status Indicator – No Flashing LED indicator

Key Sequence

[#] [Master Code] • [91] • [1] ••

Penalty Time (Keypad Anti-Tamper Lockout Time)

Adjust Penalty Time

Key Sequence

- [#] [Master Code] • [92] • [1-digit invalid codes entry] • [1-digit X0 seconds] ••
- *For example*, to adjust Penalty Time for 70 seconds after 5 invalid entries, press
[#] [5555] • [92] • [5] • [7] ••

Disable Penalty Time

Key Sequence

- [#] [Master Code] • [92] • [0] • [0] ••
- Number of invalid User Codes can be programmed from 0 (disable) to 9.
 - Penalty Time can be programmed from 10 seconds to 90 seconds, incremental in 10s (i.e. 9 = 90 seconds).

Identify User ID

Key Sequence

- [#] [Master Code] • [09] • [Enter Code to be located] ••

If the code entered is recognized, the following sequence will occur:

- At the start of the Code Location Function, the lock will flash both the green and red LEDs and emit 2 beeps.
- The lock will identify the first digit by flashing the green LED and beeping 0 – 9 times.
- To signify the end of the first digit sequence, the lock will flash both the green and red LEDs and will emit 2 beeps.
- The lock will identify the second digit by flashing the green LED and beeping 0 – 9 times.
- To signify the end of the second digit sequence, the lock will flash both the green and red LEDs and will emit 2 beeps.

Should the code not be recognized, the lock will sound one long beep (0.5 sec) with a red LED.

Next Free User ID

Key Sequence

[#] [Master Code] • [10] ••

If a free user ID is recognized, the following sequence will occur:

- At the start of the Next Free User Location function, the lock will flash both the green and red LEDs and will emit 2 beeps.
- The lock will identify the first digit by flashing the green LED and beeping 0 -9 times.
- To signify the end of the first digit sequence, the lock will flash both the green and red LEDs and will emit 2 beeps.
- The lock will identify the second digit by flashing the green LED and beeping 0 -9 times.
- To signify the end of the Next Free User, the lock will flash both the green and red LEDs and will emit 2 beeps. If no free address is found, then the lock will emit one long beep (0.5 sec) with a red LED.

Should a Free User ID not be found, the lock will sound one long beep (0.5 sec) with a red LED.

Reset to Factory Default Settings

Reset to Factory Default Settings with a Master Code

Key Sequence

[#] [Master Code] • [99] • [99] ••

Reset to Factory Default Settings without a Master Code

1. Remove one battery.
2. Press and hold the “0” button, then replace the battery.
3. Release the “0” button after green LED flashes twice and lock beeps twice.
4. Within 3 seconds, press the star * key 3 times.
 - The green LED will light for 7 seconds and 2 beeps will sound.
 - The lock is reset to the Factory Default Settings. All programming is deleted. Master Code is 12345.

Low Battery Warning

- When the battery voltage is low, the red LED will flash 5 times before the green LED flashes to signal acceptance of the code. Batteries should be changed as soon as this happens. Only 200 operations are allowed under low battery condition. After 200 operations, User Codes will be disabled under low battery condition. Then, only Master Code can be used to unlock the lock, and LED indicator will flash red 10 times before the lock is unlocked.

Visit ***www.TownSteel.com*** for more.

17901 Railroad Street
City of Industry, CA 91748
Toll Free: 877-858-0888
Tel: 626-965-8917
Fax: 626-965-8919

TownSteel e-Genius 4000 Series Programming Guide

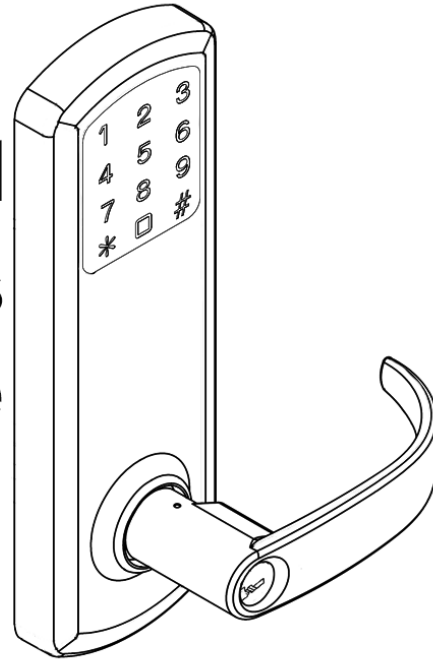

Index

Definitions.....	2
Factory Default Settings.....	2
Important Notes	3
Change Master Code.....	4
Add Credentials.....	4
Add a User Code	
Add Multiple User Codes	
Add User Keycards	
Delete Credentials.....	6
Delete User Code	
Delete User Keycard	
Reset to Factory Default Settings	
System Settings.....	7
Passage Mode	
Verification Mode	
Sound	
Reset to Factory Default Settings w/o Master Code.....	8
Low Battery.....	8

Definitions

- **Credential:** The lock requires a valid credential to operate. A credential can be a Master Code, User Code, or Keycard/Fob.
- **LED Indicator:** The LED indicators are located around the keypad of the lock. Lock flashes **green** LED and/or **red** LED dependent on inputs. While unlocking, a **red** LED followed by a **green** LED means the lock is not programmed and can be unlocked with any 6-10 digit code or Keycard/Fobs.
- **Master Code:** The Master Code programs all User Codes, Keycards/Fobs (Credentials), and System Settings. The Factory Default Setting's Master Code is 123456. This must be changed before programming the lock. Each lock has one Master Code. Master Code cannot be deleted.
- **User Code:** User Codes are used to operate the lock. User Codes are programmed by the Master Code. The lock can have a maximum of 397 User Codes (interchangeable with Keycards/Fobs).
- **User Keycard/Fob:** Keycards or Fobs can be used to operate the lock. Master Code is used to program User Keycards/Fobs. Swipe the touch keypad with a Keycard/Fob to operate the lock. The lock can have a maximum of 397 Keycards/Fobs (interchangeable with User Codes). Any standard Keycard/Fob can be programmed into the lock.
- **Passage Mode:** Door will remain actively unlocked until the Master Code or the Passage Credential is re-entered.
- **Dual Verification Mode:** Two valid credentials are needed to unlock the door.
- **Sound:** Keypad sound is enabled by Factory Default Settings. Disabling the sound only affects general operation, not during programming of the lock. During programming mode, lock will temporarily re-enable sound.

Factory Default Settings

Master Code: 123456

Penalty Time: 1 minute 30 seconds after 5 invalid entries



Passage Mode: Disabled

Dual Verification Mode: Disabled

Sound: Enabled

Important Notes

- To wake up the touch keypad from idle mode, gently swipe or tap the keypad.
- While in Factory Default Settings any credential will open the lock until a Master Code is programmed into the lock. When any credential is presented the lock will flash **red** and then **green** and unlock.
- The Factory Default Setting's Master Code must be changed before programming any other codes or system settings.
- A Master Code or User Code can be 6-10 digits (they do not need to be the same code length).
- To open the lock using a valid credential – enter a User Code or Master Code followed by Pound (#) or swipe a Keycard/Fob. This will be followed by a **green** LED and the lock will open for 5 seconds before automatically re-locking.
- Pressing the Asterisk (*) key will cancel any on-going code input or programming sequence. Pressing Asterisk (*) two times will set the lock on idle.
- Pressing the Asterisk (*) key followed by Pound (#) and entering the Master Code opens programming.
- During programming, allow for the lock's sounds to end before pressing any keys to make sure the system recognizes the programming sequence.
- During programming, the **green** LED indicates success and the **red** LED indicates failure.
- Outside of programming, the **green** LED indicates unlocked and the **red** LED indicates locked.
- To prevent unauthorized entry, the lockout feature is activated for 1 minute 30 seconds after 5 invalid entries. During lockout, no credential will be accepted. Penalty time is 1 minute and 30 seconds, and the **red** LED and alarm will operate repeatedly for the duration of the penalty.
- This lock features anti-pry cryptographic functions. Users can add random digits before and/or after a valid code. Enter a valid code in the following method: "XXXXCODEXXX" (15 random digits are the limit) followed by Pound (#).
- Replacing batteries does not change existing settings.

The symbols  and  are used in this programming guide to represent the audio and visual cues the lock uses to show successful progression during the programming process.

Disclaimer: The codes used in the following examples are not recommended for actual valid codes - accepted protocol should be followed for secure codes - repeated strings of numbers are not secure.

Change Master Code

Key Sequence



For example, to change Master Code to “555555”, press:



Notes

- Factory Default Setting’s Master Code is 123456. It must be changed with the user’s own Master Code immediately.
- Manufacturer assumes no liability, direct or indirect, due to failure to change Master Code.
- No other programming will be accepted until Factory Default Setting’s Master Code has been changed.
- Master Code can be changed at any time. Changing the Master Code does not affect other lock settings.
- A lock has only one Master Code. Multiple locks can have the same Master Code.

Add Credentials

Add a User Code

Key Sequence



For example, to add User Code of “202020”, press:



Add Multiple User Codes

Key Sequence

1st User Code Key Sequence



Additional User Codes Key Sequence:



For example, to add User Codes “202020”, “303030”, and “404040”, press:

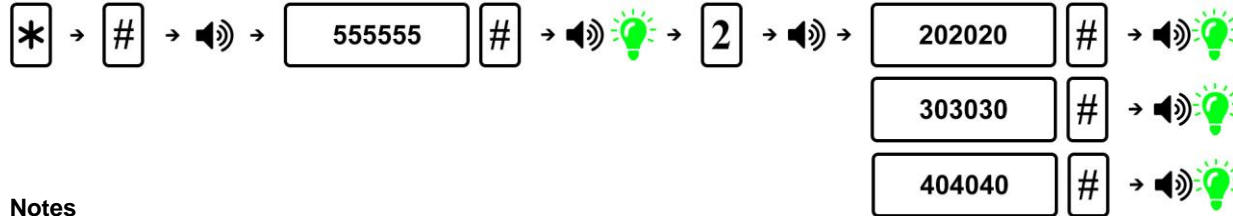

Notes

- The input of additional credentials must start before lock goes into Idle Mode (12 seconds). If the lock goes into Idle Mode, start the key sequence from the beginning.
- Same User Code cannot be added twice.
- To exit, press asterisk (*) or wait until the lock goes into Idle Mode (12 seconds).

Add Keycard or Key Fob

Key Sequence



Notes

- Keycards/Fobs can be added interchangeably with User Codes.
- Multiple Keycards/Fobs can be added during the same programming sequence (like Additional User Codes Key Sequence).
- Same Keycard/Fob cannot be programmed twice.
- To exit, press asterisk (*) or wait until the lock goes into Idle Mode (12 seconds).

Delete Credentials

Delete User Codes

Key Sequence



For example, to delete User Code “202020”, assuming the Master Code is “555555”, press:



Delete User Key Cards

Key Sequence



Notes

- The Master Code cannot be deleted.
- Multiple Keycards/Fobs can be deleted during the same programming sequence (like Additional User Codes Key Sequence).
- To exit, press the asterisk (*) or wait until the lock goes into Idle Mode (12 seconds).

Reset Lock to Factory Default Settings

Key Sequence



Notes

- All credentials will be deleted, and the lock will reset to Factory Default Settings.

System Settings

Passage Mode

Key Sequence



Notes

- After creating a Passage Code, entering it will activate the Passage Mode function.
- The lock will remain actively unlocked until the Passage Code or Master Code is entered to deactivate (or Disable) the function.
- Passage Mode and Dual Verification Mode cannot be programmed simultaneously.

Dual Verification Mode

Key Sequence



Notes

- Dual Verification Mode, when enabled, requires 2 valid credentials to operate the lock.
- A credential can be a Master Code, User Code, or Keycard/Fob.
- The Factory Default Settings is set to one credential.
- Dual Verification Mode and Passage Mode cannot be programmed simultaneously.

Adjust Keypad Sound

Key Sequence



Notes

- Disabling the sound only affects general operation, not during programming of the lock.
- During programming mode, lock will temporarily re-enable sound.

Reset Lock to Factory Default Settings without a Master Code

Steps

1. Unscrew the back cover.
2. Locate the reset button on the battery holder.
3. Press and hold the reset button. After approximately 4 seconds, the lock will beep 2 times, and you can release the reset button.
4. The **green** LED indicator will light up and it will beep 1 time indicating lock is reset.

Result

Lock is reset to Factory Default Settings.
All codes are deleted and Master Code changes to 123456.

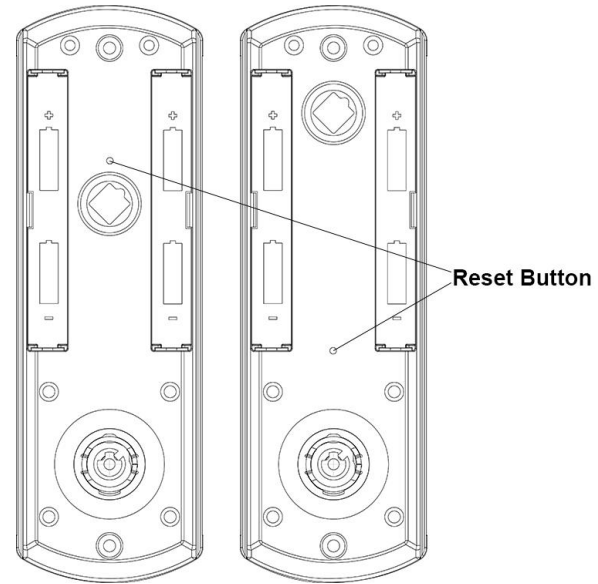

Low Battery Warning

When the battery voltage is low, unlocking the lock will display a green LED with an alarm followed by a red LED, then followed by a yellow LED with an alarm to indicate low power. Batteries should be changed as soon as this happens.



When locking under low battery voltage condition, the lock will only use the warning sound to indicate low power.
Only 200 operations are allowed under low battery condition - must change batteries to ensure lock operates properly.

Visit ***www.TownSteel.com*** for more.

17901 Railroad Street
City of Industry, CA 91748
Toll Free: 877-858-0888
Tel: 626-965-8917
Fax: 626-965-8919